



# Converse Consultants

Geotechnical Engineering, Environmental & Groundwater Science, Inspection & Testing Services

January 17, 2025

Liliana Aubert  
Project Manager II  
Project & Facilities Management  
San Bernardino County  
[Liliana.Aubert@pfm.sbcounty.gov](mailto:Liliana.Aubert@pfm.sbcounty.gov)

Subject: **SUPPLEMENTAL ASBESTOS SURVEY REPORT**  
303 West 5th Street  
San Bernardino, California  
Converse Project No. 22-16-180-01

Ms. Aubert:

Provided is our report of the *Supplemental Asbestos Survey* completed on January 9, 2025, for the referenced site. Our work was completed in general accordance with our proposal dated January 10, 2025. This survey was to supplement our September 8, 2023, survey report for the referenced site.

The following materials were reviewed/included in this supplemental survey:

- Grout/underlayment to ceramic tiles
- Potential mirror mastic
- Potential fire doors
- Vibration gaskets on HVAC equipment
- Floor tile in Room 125 (2nd layer found)
- Fireproofing in Room 142
- Plaster at the northeast corner of the building
- Plaster in the 1st Floor Lobby

The Scope of Services was completed by, or under the supervision, of the following Converse employees:

Name	Asbestos Cert. No.	Project Responsibility	Contact Number
Norman Eke (NSE)	CAC #96-2093	Project Management Report QA/QC	626-930-1260
Kaspar Wittlinger (KW)	CSST #22-7016	Inspection & Sampling Report Generation	714-932-2154

All bulk asbestos samples were submitted and analyzed by the following laboratory.

MAILING ADDRESS: 717 South Myrtle Avenue, Monrovia, California 91016

8333 Foothill Boulevard, Suite 128, Rancho Cucamonga, California 91730  
Telephone: (909) 474-2843 ♦ [www.converseconsultants.com](http://www.converseconsultants.com)

- Eurofins Built Environment Testing (800-651-4802)  
931 Corporate Center Drive  
Pomona, CA 91768  
NVLAP #600282-0

Copies of applicable staff and laboratory certifications have been attached to this letter.

### **SUMMARY OF FINDINGS**

Prior to sampling, Converse visually surveyed the interior of the structure for suspect asbestos-containing materials (ACMs) and homogeneous areas (areas that have uniform color, texture, and appearance). Suspect materials were divided into friable (crushable to dust) and non-friable materials, and placed in one of the following Environmental Protection Agency (EPA) categories:

- Surfacing Materials (sprayed or troweled-on materials)
- Thermal Systems Insulations (materials generally applied to various mechanical systems)
- Miscellaneous Materials (any materials which do not fit in the above categories)

The strategy for the collection of asbestos samples was in general accordance with the EPA guidance document “*Asbestos in Buildings: Simplified Sampling Scheme for Friable Surfacing Materials*”, EPA 560/5-85-030a, October 1985, 40 CFR 763 (AHERA); *National Exposure Standards for Hazardous Air Pollutants (NESHAP)*, 40 CFR Part 61; and South Coast Air Quality Management District, *Rule 1403, Asbestos Emissions From Demolition/Renovation Activities*, Amended October 5, 2007.

Bulk samples were collected of the following types of materials:

- Ceramic tile grout & underlayment
- Vinyl floor tile and associated mastic
- Vapor barrier paper
- Mirror mastic

The bulk samples were analyzed by Polarized Light Microscopy (PLM) in accordance with EPA Test Method 600/R-93/116. A summary of the types of suspect materials sampled along with the analytical results is presented in the following table.

Note: Sample numbers start with #81 to supplement our September 8, 2023, survey report.



**Table 1 – Suspect Materials Sampled & Analytical Results**

Sample No.	Suspect Material	% Asbestos Detected	Fri or NF Material	I or D Condition	SF
81-83	Vapor barrier paper in perimeter wall cavity	ND	NF	I	4,000
	<b>Comments:</b> Over stucco or concrete.				
84-86	<i>Black mirror mastic</i>	<i>6% Chrysotile</i>	<i>NF</i>	<i>I</i>	
	<b>Comments:</b> <i>Individual restrooms only. Large restrooms' mirrors on the southern 2<sup>nd</sup> Floor have brackets.</i>				
87-89	Brown grout & yellow underlayment to ceramic tile	ND	NF	I	800
	<b>Comments:</b> Sampled into the northeast corner restroom by Room 101. Over smooth drywall.				
90-92	Brown grout & grey underlayment to ceramic tile	ND	NF	I	1,000
	<b>Comments:</b> Sampled into the northeast corner restroom by Room 101, and in the southeast (Main) Women's Restroom. Over concrete.				
93-95	White grout & white underlayment to ceramic tile	ND	NF	I	1,400
	<b>Comments:</b> Sampled into the southeast (Main) Men's Restroom. Over plaster.				
96-98	HVAC vibration gasket	ND	NF	I	60
	<b>Comments:</b> On equipment in the HVAC Mezzanine.				
99-101	Grey, black dotted 12x12 vinyl floor tile (VFT) & mastic	ND	NF	I	3
	<b>Comments:</b> Over concrete in Room 125. Under previously sampled blue/gray mottled 12x12 VFT & mastic, which tested negative for asbestos as well. Three square feet exposed.				
102-104	White grout & gray underlayment to ceramic tile	ND	NF	I	600
	<b>Comments:</b> Sampled into the north Women's Testing Restroom (Room 161). Over smooth drywall.				
105-107	Gray grout & gray/white underlayment to ceramic tile	ND	NF	I	600
	<b>Comments:</b> Sampled into the north Women's Testing Restroom (Room 161). Over concrete.				
<p><b>Additional Comments:</b>  The laboratory may have identified additional layers or compounds within a sample under microscopic analysis that were not observed by the naked eye when the material was sampled in the field.</p> <p>All materials were generally in good condition at the time of the survey. No obvious vandalism, fire, renovation, demolition or structural damage was observed.</p> <p style="text-align: right;"><b>LEGEND</b>  <b>Fri: Friable Material</b>  <b>ND: None Detected</b>  <b>NF: Non-Friable Material</b>  <b>I: Intact Condition</b>  <b>D: Damaged Condition</b>  <b>SF: Square Footage</b></p>					

Black mirror mastic was found to contain asbestos and is considered an ACM. The mastic will need to be abated prior to any renovation activities that may impact it.

The following materials were reviewed/included in this supplemental survey:

- Grout/underlayment to ceramic tiles (sampled; ND)
- Potential mirror mastic (sampled; ACM)
- Potential fire doors (not deemed suspect; see notes below)
- Vibration gaskets on HVAC equipment (sampled; ND)
- Floor tile in Room 125 (2nd layer found; sampled; ND)
- Fireproofing in Room 142 (previously sampled and negative; see notes below)
- Plaster at the northeast corner of the building (previously sampled; see notes below)
- Plaster in the 1st Floor Lobby (previously sampled; see notes below)

We have confirmed the fireproofing at the northwest corner on the 2nd floor (Room 142) is the same material as was previously sampled and found to be negative for asbestos.

The smooth plaster material at the 2nd floor northeast corner and lobby area are also the same as was previously sampled. This material required supplemental point count analysis and was found to be less than 0.1% asbestos. This is below levels that would require abatement. But waste materials should go to a landfill that can accept them, and safety precautions may be preferred for workers impacting the materials (personal protective equipment-PPE).

Potential fire doors were inspected and representative doors of each type were cored with a ¼-inch drill bit. The doors had wood cores or they were hollow metal doors. Elevator doors were inaccessible.

In the event that other suspect ACMs are uncovered during renovation activities, those suspect materials should be inspected, sampled, and analyzed for asbestos content. If not sampled and analyzed, these new suspect materials will need to be assumed positive for asbestos.

The analytical report and chain of custody documentation are attached to this letter report. A sample location map is also attached to this letter report.

## **CLOSURE**

This report is for the sole benefit and exclusive use of the County of San Bernardino (herein referred to as Client) in accordance with the terms and conditions of our contract under which these services have been provided. Its preparation has been in accordance with generally accepted environmental practices. No other warranty, either express or implied, is made. The Scope of Services associated with the report was designed solely in accordance with the objectives, schedule, budget, and risk-management preferences of Client.

This letter report should not be regarded as a guarantee that no further ACMs beyond that which could be detected within the scope of this survey, are present at the property.



Converse makes no warranties or guarantees as to the accuracy or completeness of information provided or compiled by others. It is not possible to absolutely confirm that no ACMs exist at the property. If none are identified as part of a limited scope of work, such a conclusion should not be construed as a guaranteed absence of such materials, but merely the results of the evaluation of the property at the time of the survey. Also, events may occur after the survey, which may result in contamination of the property. Additional information, which was not found or available to Converse at the time of report preparation, may result in a modification of the conclusions and recommendations presented.

Any reliance on this report by Third Parties shall be at the Third Party's sole risk.

We appreciate the opportunity to be of service to you. If you should have any questions or comments regarding the results, please contact Norman Eke at (626) 930-1260.

### CONVERSE CONSULTANTS

  
Kaspar Wittlinger  
CSST #22-7016  
Senior Staff Environmental Scientist

  
Norman S. Eke  
Certified Asbestos Consultant, #96-2093  
Managing Officer/COB

Attached:       Certifications  
                  Asbestos - Analytical Report & Sample Location Maps

# Certifications

---

## Converse Staff & Laboratory



DEPARTMENT OF INDUSTRIAL RELATIONS

**Division of Occupational Safety and Health-Asbestos Certification**

1750 Howe Avenue, Suite 460

Sacramento, CA 95825

(916) 574-2993 Office <http://www.dir.ca.gov/dosh/asbestos.html> [actu@dir.ca.gov](mailto:actu@dir.ca.gov)



612162093C

138

**Converse Consultants  
Norman S Eke  
717 S. Myrtle Avenue  
Monrovia CA 91016**

**January 10, 2024**

Dear Certified Asbestos Consultant or Technician:

Enclosed is your certification card. **To maintain your certification, you must abide by the rules printed on the back of the certification card.**

Your certification is valid for a period of one year. If you wish to renew your certification, you must apply for renewal at least 60 days before the expiration date shown on your card. [8 CCR 341.15(h)(1)].

Please hold and do not send copies of your required AHERA refresher renewal certificates to our office until you apply for renewal of your certification.

Certificates must be kept current if you are actively working as a CAC or CSST. The grace period is only for those who are not actively working as an asbestos consultant or site surveillance technician.

Please contact our office at the above address or email w any changes in your contact/mailling information within 15 days of the change.

Sincerely,

Kevin Graulich  
Principal Safety Engineer

Attachment: Certification Card

cc: File



Renewal – Card Attached

State of California  
Division of Occupational Safety and Health  
**Certified Site Surveillance Technician**

**Kaspar Wittlinger**

Name



Certification No. **22-7016**

Expires on **03/18/25**

This certification was issued by the Division of Occupational Safety and Health as authorized by Sections 7180 et seq. of the Business and Professions Code.

United States Department of Commerce  
National Institute of Standards and Technology

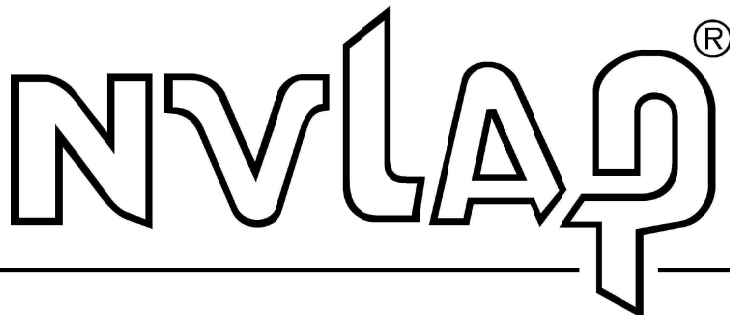

---

**Certificate of Accreditation to ISO/IEC 17025:2017**

---

NVLAP LAB CODE: 600282-0

**Eurofins EmLab P&K or Eurofins EPK Built Environment Testing Pomona, CA**  
Pomona, CA

*is accredited by the National Voluntary Laboratory Accreditation Program for specific services,  
listed on the Scope of Accreditation, for:*

**Asbestos Fiber Analysis**

*This laboratory is accredited in accordance with the recognized International Standard ISO/IEC 17025:2017.  
This accreditation demonstrates technical competence for a defined scope and the operation of a laboratory quality  
management system (refer to joint ISO-ILAC-IAF Communique on ISO/IEC 17025).*

---

2024-07-01 through 2025-06-30

*Effective Dates*



A handwritten signature in blue ink, appearing to read 'Dana S. Laman'.

---

*For the National Voluntary Laboratory Accreditation Program*

**SCOPE OF ACCREDITATION TO ISO/IEC 17025:2017**

**Eurofins EmLab P&K or Eurofins EPK Built Environment Testing Pomona, CA**

931 Corporate Center Drive

Pomona, CA 91768

Quynh Nguyen

Phone: 800-651-4802

Email: [quynh.nguyen@et.eurofinsus.com](mailto:quynh.nguyen@et.eurofinsus.com)

<https://www.eurofinsus.com/environment-testing/built-environment>

**ASBESTOS FIBER ANALYSIS**

**NVLAP LAB CODE 600282-0**

**Bulk Asbestos Analysis**

**Code**

**Description**

18/A01

EPA -- 40 CFR Appendix E to Subpart E of Part 763, Interim Method of the Determination of Asbestos in Bulk Insulation Samples

18/A03

EPA 600/R-93/116: Method for the Determination of Asbestos in Bulk Building Materials

**Airborne Asbestos Analysis**

**Code**

**Description**

18/A02

U.S. EPA's "Interim Transmission Electron Microscopy Analytical Methods-Mandatory and Nonmandatory-and Mandatory Section to Determine Completion of Response Actions" as found in 40 CFR, Part 763, Subpart E, Appendix A.

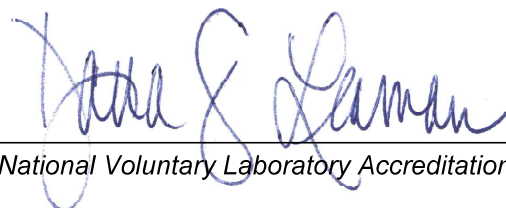

For the National Voluntary Laboratory Accreditation Program

# Asbestos

---

## Analytical Report & Chain of Custody Sample Location Map(s)



Report for:

**Mr. Norman Eke**  
**Converse Consultants, Monrovia & Costa Mesa**  
717 S. Myrtle Avenue  
Monrovia, CA 91016

---

Regarding: Eurofins Built Environment Testing West, LLC  
Project: 22-16-180-01; San Bernardino Co / 303 W. 5th St.  
EML ID: 3907742

Approved by:

Dates of Analysis:  
Asbestos PLM: 01-16-2025



Approved Signatory  
Peter Mai

Service SOPs: Asbestos PLM (EPA 40CFR App E to Sub E of Part 763 & EPA METHOD 600/R-93-116, SOP EM-AS-S-1267)  
NVLAP Lab Code 600282-0

---

All samples were received in acceptable condition unless noted in the Report Comments portion in the body of the report. The results relate only to the samples as received and tested. The results include an inherent uncertainty of measurement associated with estimating percentages by polarized light microscopy. Measurement uncertainty data for sample results with >1% asbestos concentration can be provided when requested.

Eurofins Built Environment Testing West, LLC ("the Company"), a member of the Eurofins Built Environment Testing group of companies, shall have no liability to the client or the client's customer with respect to decisions or recommendations made, actions taken or courses of conduct implemented by either the client or the client's customer as a result of or based upon the Test Results. In no event shall the Company be liable to the client with respect to the Test Results except for the Company's own willful misconduct or gross negligence nor shall the Company be liable for incidental or consequential damages or lost profits or revenues to the fullest extent such liability may be disclaimed by law, even if the Company has been advised of the possibility of such damages, lost profits or lost revenues. In no event shall the Company's liability with respect to the Test Results exceed the amount paid to the Company by the client therefor.

Client: Converse Consultants, Monrovia & Costa  
 Mesa  
 C/O: Mr. Norman Eke  
 Re: 22-16-180-01; San Bernardino Co / 303 W. 5th  
 St.

Date of Sampling: 01-09-2025  
 Date of Receipt: 01-09-2025  
 Date of Report: 01-16-2025

**ASBESTOS PLM REPORT**

**Total Samples Submitted:** 27

**Total Samples Analyzed:** 27

**Total Samples with Layer Asbestos Content > 1%:** 3

**Location: 81, 2nd Floor, NEC - Vapor Barrier Paper in Perimeter Wall Cavity**

Lab ID-Version‡: 19374228-1

Sample Layers	Asbestos Content
Black/Yellow Vapor Barrier	ND
<b>Composite Non-Asbestos Content:</b>	70% Cellulose
<b>Sample Composite Homogeneity:</b>	Good

**Location: 82, 2nd Floor, NEC - Vapor Barrier Paper in Perimeter Wall Cavity**

Lab ID-Version‡: 19374348-1

Sample Layers	Asbestos Content
Black/Yellow Vapor Barrier	ND
<b>Composite Non-Asbestos Content:</b>	70% Cellulose
<b>Sample Composite Homogeneity:</b>	Good

**Location: 83, 2nd Floor, NEC - Vapor Barrier Paper in Perimeter Wall Cavity**

Lab ID-Version‡: 19374349-1

Sample Layers	Asbestos Content
Black/Yellow Vapor Barrier	ND
<b>Composite Non-Asbestos Content:</b>	70% Cellulose
<b>Sample Composite Homogeneity:</b>	Good

**Location: 84, NEC Restroom by Room 101 - Black Mirror Mastic**

Lab ID-Version‡: 19374350-1

Sample Layers	Asbestos Content
Black Mastic	6% Chrysotile
<b>Sample Composite Homogeneity:</b>	Moderate

The test report shall not be reproduced except in full, without written approval of the laboratory. The report must not be used by the client to claim product certification, approval, or endorsement by NVLAP, NIST, or any agency of the federal government. The Company reserves the right to dispose of all samples after a period of thirty (30) days, according to all state and federal guidelines, unless otherwise specified.

All components not quantified as asbestos content and non-asbestos content are considered to be non-fibrous matrix components. Matrix components may include, but are not limited to, gypsum, paint, silicate minerals, vinyl, binder, calcium carbonate, tar, and foam.

Inhomogeneous samples are separated into homogeneous subsamples and analyzed individually. ND means no fibers were detected. When detected, the minimum detection and reporting limit is less than 1% unless point counting is performed. Floor tile samples may contain large amounts of interference material and it is recommended that the sample be analyzed by gravimetric point count analysis to lower the detection limit and to aid in asbestos identification.

‡ A "Version" indicated by "-x" after the Lab ID# with a value greater than 1 indicates a sample with amended data. The revision number is reflected by the value of "x".

Client: Converse Consultants, Monrovia & Costa  
 Mesa  
 C/O: Mr. Norman Eke  
 Re: 22-16-180-01; San Bernardino Co / 303 W. 5th  
 St.

Date of Sampling: 01-09-2025  
 Date of Receipt: 01-09-2025  
 Date of Report: 01-16-2025

**ASBESTOS PLM REPORT**

**Location: 85, N Women's Testing Restroom (Rm 161) - Black Mirror Mastic**

Lab ID-Version‡: 19374351-1

Sample Layers	Asbestos Content
Black Mastic	6% Chrysotile
<b>Sample Composite Homogeneity:</b> Moderate	

**Location: 86, N Women's Testing Restroom (Rm 161) - Black Mirror Mastic**

Lab ID-Version‡: 19374352-1

Sample Layers	Asbestos Content
Black Mastic	6% Chrysotile
<b>Sample Composite Homogeneity:</b> Moderate	

**Location: 87, NEC Restroom by Room 101 - Brown Grout & Yellow Underlayment to Ceramic Tile**

Lab ID-Version‡: 19374353-1

Sample Layers	Asbestos Content
White Ceramic Tile	ND
Brown Grout	ND
Yellow Non-Fibrous Material (Underlayment)	ND
<b>Sample Composite Homogeneity:</b> Good	

**Location: 88, NEC Restroom by Room 101 - Brown Grout & Yellow Underlayment to Ceramic Tile**

Lab ID-Version‡: 19374354-1

Sample Layers	Asbestos Content
White Ceramic Tile	ND
Brown Grout	ND
Yellow Non-Fibrous Material (Underlayment)	ND
<b>Sample Composite Homogeneity:</b> Good	

The test report shall not be reproduced except in full, without written approval of the laboratory. The report must not be used by the client to claim product certification, approval, or endorsement by NVLAP, NIST, or any agency of the federal government. The Company reserves the right to dispose of all samples after a period of thirty (30) days, according to all state and federal guidelines, unless otherwise specified.

All components not quantified as asbestos content and non-asbestos content are considered to be non-fibrous matrix components. Matrix components may include, but are not limited to, gypsum, paint, silicate minerals, vinyl, binder, calcium carbonate, tar, and foam.

Inhomogeneous samples are separated into homogeneous subsamples and analyzed individually. ND means no fibers were detected. When detected, the minimum detection and reporting limit is less than 1% unless point counting is performed. Floor tile samples may contain large amounts of interference material and it is recommended that the sample be analyzed by gravimetric point count analysis to lower the detection limit and to aid in asbestos identification.

‡ A "Version" indicated by "-x" after the Lab ID# with a value greater than 1 indicates a sample with amended data. The revision number is reflected by the value of "x".

**Eurofins Built Environment Testing West, LLC**

931 Corporate Center Drive, Pomona, CA 91768

(833) 465-5857 www.eurofinsus.com/Built

Client: Converse Consultants, Monrovia & Costa Mesa

C/O: Mr. Norman Eke

Re: 22-16-180-01; San Bernardino Co / 303 W. 5th St.

Date of Sampling: 01-09-2025

Date of Receipt: 01-09-2025

Date of Report: 01-16-2025

**ASBESTOS PLM REPORT**

**Location: 89, NEC Restroom by Room 101 - Brown Grout & Yellow Underlayment to Ceramic Tile**

Lab ID-Version‡: 19374355-1

Sample Layers	Asbestos Content
White Ceramic Tile	ND
Brown Grout	ND
Yellow Non-Fibrous Material (Underlayment)	ND
<b>Sample Composite Homogeneity:</b> Good	

**Location: 90, NEC Restroom by Room 101 - Brown Grout & Grey Underlayment to Ceramic Tile**

Lab ID-Version‡: 19374356-1

Sample Layers	Asbestos Content
Brown Grout	ND
Gray Non-Fibrous Material (Underlayment)	ND
<b>Sample Composite Homogeneity:</b> Good	

**Location: 91, SE Women's Restroom - Brown Grout & Grey Underlayment to Ceramic Tile**

Lab ID-Version‡: 19374357-1

Sample Layers	Asbestos Content
Brown Grout	ND
Gray Non-Fibrous Material (Underlayment)	ND
<b>Sample Composite Homogeneity:</b> Good	

**Location: 92, SE Women's Restroom - Brown Grout & Grey Underlayment to Ceramic Tile**

Lab ID-Version‡: 19374358-1

Sample Layers	Asbestos Content
Brown Grout	ND
Gray Non-Fibrous Material (Underlayment)	ND
<b>Sample Composite Homogeneity:</b> Good	

The test report shall not be reproduced except in full, without written approval of the laboratory. The report must not be used by the client to claim product certification, approval, or endorsement by NVLAP, NIST, or any agency of the federal government. The Company reserves the right to dispose of all samples after a period of thirty (30) days, according to all state and federal guidelines, unless otherwise specified.

All components not quantified as asbestos content and non-asbestos content are considered to be non-fibrous matrix components. Matrix components may include, but are not limited to, gypsum, paint, silicate minerals, vinyl, binder, calcium carbonate, tar, and foam.

Inhomogeneous samples are separated into homogeneous subsamples and analyzed individually. ND means no fibers were detected. When detected, the minimum detection and reporting limit is less than 1% unless point counting is performed. Floor tile samples may contain large amounts of interference material and it is recommended that the sample be analyzed by gravimetric point count analysis to lower the detection limit and to aid in asbestos identification.

‡ A "Version" indicated by "-x" after the Lab ID# with a value greater than 1 indicates a sample with amended data. The revision number is reflected by the value of "x".

Client: Converse Consultants, Monrovia & Costa  
 Mesa  
 C/O: Mr. Norman Eke  
 Re: 22-16-180-01; San Bernardino Co / 303 W. 5th  
 St.

Date of Sampling: 01-09-2025  
 Date of Receipt: 01-09-2025  
 Date of Report: 01-16-2025

**ASBESTOS PLM REPORT**

**Location: 93, SE Men's Restroom - White Grout & White Underlayment to Ceramic Tile**

Lab ID-Version‡: 19374359-1

Sample Layers	Asbestos Content
White Grout	ND
White Non-Fibrous Material (Underlayment)	ND
<b>Sample Composite Homogeneity:</b> Good	

**Location: 94, SE Men's Restroom - White Grout & White Underlayment to Ceramic Tile**

Lab ID-Version‡: 19374360-1

Sample Layers	Asbestos Content
White Grout	ND
White Non-Fibrous Material (Underlayment)	ND
<b>Sample Composite Homogeneity:</b> Good	

**Location: 95, SE Men's Restroom - White Grout & White Underlayment to Ceramic Tile**

Lab ID-Version‡: 19374361-1

Sample Layers	Asbestos Content
White Grout	ND
White Non-Fibrous Material (Underlayment)	ND
<b>Sample Composite Homogeneity:</b> Good	

**Location: 96, HVAC Mezzanine - HVAC Vibration Gasket**

Lab ID-Version‡: 19374362-1

Sample Layers	Asbestos Content
Tan Gasket	ND
<b>Composite Non-Asbestos Content:</b>	80% Glass Fibers
<b>Sample Composite Homogeneity:</b> Good	

The test report shall not be reproduced except in full, without written approval of the laboratory. The report must not be used by the client to claim product certification, approval, or endorsement by NVLAP, NIST, or any agency of the federal government. The Company reserves the right to dispose of all samples after a period of thirty (30) days, according to all state and federal guidelines, unless otherwise specified.

All components not quantified as asbestos content and non-asbestos content are considered to be non-fibrous matrix components. Matrix components may include, but are not limited to, gypsum, paint, silicate minerals, vinyl, binder, calcium carbonate, tar, and foam.

Inhomogeneous samples are separated into homogeneous subsamples and analyzed individually. ND means no fibers were detected. When detected, the minimum detection and reporting limit is less than 1% unless point counting is performed. Floor tile samples may contain large amounts of interference material and it is recommended that the sample be analyzed by gravimetric point count analysis to lower the detection limit and to aid in asbestos identification.

‡ A "Version" indicated by "-x" after the Lab ID# with a value greater than 1 indicates a sample with amended data. The revision number is reflected by the value of "x".

Client: Converse Consultants, Monrovia & Costa  
 Mesa  
 C/O: Mr. Norman Eke  
 Re: 22-16-180-01; San Bernardino Co / 303 W. 5th  
 St.

Date of Sampling: 01-09-2025  
 Date of Receipt: 01-09-2025  
 Date of Report: 01-16-2025

**ASBESTOS PLM REPORT**

**Location: 97, HVAC Mezzanine - HVAC Vibration Gasket**

Lab ID-Version‡: 19374363-1

Sample Layers	Asbestos Content
Tan Gasket	ND
<b>Composite Non-Asbestos Content:</b>	80% Glass Fibers
<b>Sample Composite Homogeneity:</b>	Good

**Location: 98, HVAC Mezzanine - HVAC Vibration Gasket**

Lab ID-Version‡: 19374364-1

Sample Layers	Asbestos Content
Tan Gasket	ND
<b>Composite Non-Asbestos Content:</b>	80% Glass Fibers
<b>Sample Composite Homogeneity:</b>	Good

**Location: 99, Room 125 - Grey, Black-Dotted 12x12 Vinyl Floor Tile & Mastic**

Lab ID-Version‡: 19374365-1

Sample Layers	Asbestos Content
Gold Floor Tile (Black-Dotted)	ND
Yellow Mastic	ND
<b>Sample Composite Homogeneity:</b>	Good

**Location: 100, Room 125 - Grey, Black-Dotted 12x12 Vinyl Floor Tile & Mastic**

Lab ID-Version‡: 19374366-1

Sample Layers	Asbestos Content
Gold Floor Tile (Black-Dotted)	ND
Yellow Mastic	ND
<b>Sample Composite Homogeneity:</b>	Good

The test report shall not be reproduced except in full, without written approval of the laboratory. The report must not be used by the client to claim product certification, approval, or endorsement by NVLAP, NIST, or any agency of the federal government. The Company reserves the right to dispose of all samples after a period of thirty (30) days, according to all state and federal guidelines, unless otherwise specified.

All components not quantified as asbestos content and non-asbestos content are considered to be non-fibrous matrix components. Matrix components may include, but are not limited to, gypsum, paint, silicate minerals, vinyl, binder, calcium carbonate, tar, and foam.

Inhomogeneous samples are separated into homogeneous subsamples and analyzed individually. ND means no fibers were detected. When detected, the minimum detection and reporting limit is less than 1% unless point counting is performed. Floor tile samples may contain large amounts of interference material and it is recommended that the sample be analyzed by gravimetric point count analysis to lower the detection limit and to aid in asbestos identification.

‡ A "Version" indicated by "-x" after the Lab ID# with a value greater than 1 indicates a sample with amended data. The revision number is reflected by the value of "x".

Client: Converse Consultants, Monrovia & Costa  
 Mesa  
 C/O: Mr. Norman Eke  
 Re: 22-16-180-01; San Bernardino Co / 303 W. 5th  
 St.

Date of Sampling: 01-09-2025  
 Date of Receipt: 01-09-2025  
 Date of Report: 01-16-2025

**ASBESTOS PLM REPORT**

**Location: 101, Room 125 - Grey, Black-Dotted 12x12 Vinyl Floor Tile & Mastic**

Lab ID-Version‡: 19374367-1

Sample Layers	Asbestos Content
Gold Floor Tile (Black-Dotted)	ND
Yellow Mastic	ND
<b>Sample Composite Homogeneity:</b> Good	

**Location: 102, N Women's Testing Restroom (Rm 161) - White Grout & Grey Underlayment to Ceramic Tile**

Lab ID-Version‡: 19374368-1

Sample Layers	Asbestos Content
White Ceramic Tile	ND
White Grout	ND
Gray Non-Fibrous Material (Underlayment)	ND
<b>Sample Composite Homogeneity:</b> Good	

**Location: 103, N Women's Testing Restroom (Rm 161) - White Grout & Grey Underlayment to Ceramic Tile**

Lab ID-Version‡: 19374369-1

Sample Layers	Asbestos Content
White Ceramic Tile	ND
White Grout	ND
Gray Non-Fibrous Material (Underlayment)	ND
<b>Sample Composite Homogeneity:</b> Good	

The test report shall not be reproduced except in full, without written approval of the laboratory. The report must not be used by the client to claim product certification, approval, or endorsement by NVLAP, NIST, or any agency of the federal government. The Company reserves the right to dispose of all samples after a period of thirty (30) days, according to all state and federal guidelines, unless otherwise specified.

All components not quantified as asbestos content and non-asbestos content are considered to be non-fibrous matrix components. Matrix components may include, but are not limited to, gypsum, paint, silicate minerals, vinyl, binder, calcium carbonate, tar, and foam.

Inhomogeneous samples are separated into homogeneous subsamples and analyzed individually. ND means no fibers were detected. When detected, the minimum detection and reporting limit is less than 1% unless point counting is performed. Floor tile samples may contain large amounts of interference material and it is recommended that the sample be analyzed by gravimetric point count analysis to lower the detection limit and to aid in asbestos identification.

‡ A "Version" indicated by "-x" after the Lab ID# with a value greater than 1 indicates a sample with amended data. The revision number is reflected by the value of "x".

Client: Converse Consultants, Monrovia & Costa  
 Mesa  
 C/O: Mr. Norman Eke  
 Re: 22-16-180-01; San Bernardino Co / 303 W. 5th  
 St.

Date of Sampling: 01-09-2025  
 Date of Receipt: 01-09-2025  
 Date of Report: 01-16-2025

**ASBESTOS PLM REPORT**

**Location: 104, N Women's Testing Restroom (Rm 161) - White Grout & Grey  
 Underlayment to Ceramic Tile**

Lab ID-Version‡: 19374370-1

Sample Layers	Asbestos Content
White Ceramic Tile	ND
White Grout	ND
Gray Non-Fibrous Material (Underlayment)	ND
<b>Sample Composite Homogeneity:</b>	Good

The test report shall not be reproduced except in full, without written approval of the laboratory. The report must not be used by the client to claim product certification, approval, or endorsement by NVLAP, NIST, or any agency of the federal government. The Company reserves the right to dispose of all samples after a period of thirty (30) days, according to all state and federal guidelines, unless otherwise specified.

All components not quantified as asbestos content and non-asbestos content are considered to be non-fibrous matrix components. Matrix components may include, but are not limited to, gypsum, paint, silicate minerals, vinyl, binder, calcium carbonate, tar, and foam.

Inhomogeneous samples are separated into homogeneous subsamples and analyzed individually. ND means no fibers were detected. When detected, the minimum detection and reporting limit is less than 1% unless point counting is performed. Floor tile samples may contain large amounts of interference material and it is recommended that the sample be analyzed by gravimetric point count analysis to lower the detection limit and to aid in asbestos identification.

‡ A "Version" indicated by "-x" after the Lab ID# with a value greater than 1 indicates a sample with amended data. The revision number is reflected by the value of "x".

Client: Converse Consultants, Monrovia & Costa  
 Mesa  
 C/O: Mr. Norman Eke  
 Re: 22-16-180-01; San Bernardino Co / 303 W. 5th  
 St.

Date of Sampling: 01-09-2025  
 Date of Receipt: 01-09-2025  
 Date of Report: 01-16-2025

**ASBESTOS PLM REPORT**

**Location: 105, N Women's Testing Restroom (Rm 161) - Grey Grout & Grey/White Underlayment to Ceramic Tile**

Lab ID-Version‡: 19374371-1

Sample Layers	Asbestos Content
White Ceramic Tile	ND
Gray/White Non-Fibrous Material (Underlayment)	ND
Gray Grout	ND
<b>Sample Composite Homogeneity:</b>	Good

**Location: 106, N Women's Testing Restroom (Rm 161) - Grey Grout & Grey/White Underlayment to Ceramic Tile**

Lab ID-Version‡: 19374372-1

Sample Layers	Asbestos Content
White Ceramic Tile	ND
Gray/White Non-Fibrous Material (Underlayment)	ND
Gray Grout	ND
<b>Sample Composite Homogeneity:</b>	Good

**Location: 107, N Women's Testing Restroom (Rm 161) - Grey Grout & Grey/White Underlayment to Ceramic Tile**

Lab ID-Version‡: 19374373-1

Sample Layers	Asbestos Content
White Ceramic Tile	ND
Gray/White Non-Fibrous Material (Underlayment)	ND
Gray Grout	ND
<b>Sample Composite Homogeneity:</b>	Good

The test report shall not be reproduced except in full, without written approval of the laboratory. The report must not be used by the client to claim product certification, approval, or endorsement by NVLAP, NIST, or any agency of the federal government. The Company reserves the right to dispose of all samples after a period of thirty (30) days, according to all state and federal guidelines, unless otherwise specified.

All components not quantified as asbestos content and non-asbestos content are considered to be non-fibrous matrix components. Matrix components may include, but are not limited to, gypsum, paint, silicate minerals, vinyl, binder, calcium carbonate, tar, and foam.

Inhomogeneous samples are separated into homogeneous subsamples and analyzed individually. ND means no fibers were detected. When detected, the minimum detection and reporting limit is less than 1% unless point counting is performed. Floor tile samples may contain large amounts of interference material and it is recommended that the sample be analyzed by gravimetric point count analysis to lower the detection limit and to aid in asbestos identification.

‡ A "Version" indicated by "-x" after the Lab ID# with a value greater than 1 indicates a sample with amended data. The revision number is reflected by the value of "x".

Client: Converse Consultants, Monrovia & Costa  
Mesa  
C/O: Mr. Norman Eke  
Re: 22-16-180-01; San Bernardino Co / 303 W. 5th  
St.

**Eurofins Built Environment Testing West, LLC**  
931 Corporate Center Drive, Pomona, CA 91768  
(833) 465-5857 www.eurofinsus.com/Built

Date of Sampling: 01-09-2025  
Date of Receipt: 01-09-2025  
Date of Report: 01-16-2025

**ASBESTOS PLM REPORT**

**PROJECT ANALYST AND SIGNATORY REPORT**

**Project Analyst**



**Analyst:** Peter Mai

The test report shall not be reproduced except in full, without written approval of the laboratory. The report must not be used by the client to claim product certification, approval, or endorsement by NVLAP, NIST, or any agency of the federal government. The Company reserves the right to dispose of all samples after a period of thirty (30) days, according to all state and federal guidelines, unless otherwise specified.

‡ A "Version" indicated by "-x" after the Lab ID# with a value greater than 1 indicates a sample with amended data. The revision number is reflected by the value of "x".



East: (866) 871-1984  
Central: (800) 651-4802  
West: (866) 888-8653



**ASBESTOS ANAL**

003907742

REQUESTED SERVICES (Check boxes below)

PCM Air	PLM						Rock & Soil	Other Requests	
	Bulk								
Fiber Count (NIOSH 7400)	Asbestos Bulk PLM	EPA Point Count (200 Point Count)	EPA Point Count (400 Point Count)	EPA Point Count (1000 Point Count)	Gravimetric Point Count (400 Pt Count)	Gravimetric Point Count (1000 Pt Count)	CARB 435 Method (400 Point Count)	CARB 435 Method (1000 Point Count)	Lead Analysis - Flame AA
<input type="checkbox"/>	<input checked="" type="checkbox"/>	<input type="checkbox"/>	<input type="checkbox"/>	<input type="checkbox"/>	<input type="checkbox"/>	<input type="checkbox"/>	<input type="checkbox"/>	<input type="checkbox"/>	<input type="checkbox"/>
<input type="checkbox"/>	<input type="checkbox"/>	<input type="checkbox"/>	<input type="checkbox"/>	<input type="checkbox"/>	<input type="checkbox"/>	<input type="checkbox"/>	<input type="checkbox"/>	<input type="checkbox"/>	<input type="checkbox"/>
<input type="checkbox"/>	<input type="checkbox"/>	<input type="checkbox"/>	<input type="checkbox"/>	<input type="checkbox"/>	<input type="checkbox"/>	<input type="checkbox"/>	<input type="checkbox"/>	<input type="checkbox"/>	<input type="checkbox"/>
<input type="checkbox"/>	<input type="checkbox"/>	<input type="checkbox"/>	<input type="checkbox"/>	<input type="checkbox"/>	<input type="checkbox"/>	<input type="checkbox"/>	<input type="checkbox"/>	<input type="checkbox"/>	<input type="checkbox"/>
<input type="checkbox"/>	<input type="checkbox"/>	<input type="checkbox"/>	<input type="checkbox"/>	<input type="checkbox"/>	<input type="checkbox"/>	<input type="checkbox"/>	<input type="checkbox"/>	<input type="checkbox"/>	<input type="checkbox"/>
<input type="checkbox"/>	<input type="checkbox"/>	<input type="checkbox"/>	<input type="checkbox"/>	<input type="checkbox"/>	<input type="checkbox"/>	<input type="checkbox"/>	<input type="checkbox"/>	<input type="checkbox"/>	<input type="checkbox"/>
<input type="checkbox"/>	<input type="checkbox"/>	<input type="checkbox"/>	<input type="checkbox"/>	<input type="checkbox"/>	<input type="checkbox"/>	<input type="checkbox"/>	<input type="checkbox"/>	<input type="checkbox"/>	<input type="checkbox"/>
<input type="checkbox"/>	<input type="checkbox"/>	<input type="checkbox"/>	<input type="checkbox"/>	<input type="checkbox"/>	<input type="checkbox"/>	<input type="checkbox"/>	<input type="checkbox"/>	<input type="checkbox"/>	<input type="checkbox"/>
<input type="checkbox"/>	<input type="checkbox"/>	<input type="checkbox"/>	<input type="checkbox"/>	<input type="checkbox"/>	<input type="checkbox"/>	<input type="checkbox"/>	<input type="checkbox"/>	<input type="checkbox"/>	<input type="checkbox"/>
<input type="checkbox"/>	<input type="checkbox"/>	<input type="checkbox"/>	<input type="checkbox"/>	<input type="checkbox"/>	<input type="checkbox"/>	<input type="checkbox"/>	<input type="checkbox"/>	<input type="checkbox"/>	<input type="checkbox"/>
<input type="checkbox"/>	<input type="checkbox"/>	<input type="checkbox"/>	<input type="checkbox"/>	<input type="checkbox"/>	<input type="checkbox"/>	<input type="checkbox"/>	<input type="checkbox"/>	<input type="checkbox"/>	<input type="checkbox"/>
<input type="checkbox"/>	<input type="checkbox"/>	<input type="checkbox"/>	<input type="checkbox"/>	<input type="checkbox"/>	<input type="checkbox"/>	<input type="checkbox"/>	<input type="checkbox"/>	<input type="checkbox"/>	<input type="checkbox"/>

CONTACT INFORMATION					
Company:	Converse Consultants		Address: 717 S. Myrtle Ave, Monrovia, CA 91016		
Contact:	Monner Fike		Special Instructions: 5-day TAT		
Phone:	626-930-1260		neke@converseconsultants.com		
PROJECT INFORMATION			TURN AROUND TIME CODES (TAT)		
Project ID:	22-16-180-01		STD - Standard (DEFAULT)		
Project Description:	San Bernardino Co/303 W. 5th St.		ND - Next Business Day		
Project Zip Code:	Sampling Date & Time:	1/21/25 9am	SD - Same Business Day Rush*		
PO Number:	Sampled By: Kaspar Wittlinger		*Please call Client Services for locations with Rush services		
Rushes received after 2pm or on weekends, will be considered received the next business day. Please alert us in advance of weekend analysis needs.					
Sample ID	Description	Sample Type (Below)	TAT (Below)	Total Volume (Air Samples only)	Notes
81-107	Please see attached.	B	5-day		

SAMPLE TYPE CODES		RELINQUISHED BY	DATE & TIME	RECEIVED BY	DATE & TIME
A - Air	W - Wipe	Kaspar Wittlinger	1/21/25 1455	Brenda Fuerte AA	1/21/25 3:00 PM
B - Bulk	T - Tape				
D - Dust	R - Rock				
SO - Soil	O - Other				

By submitting this Chain of Custody, you agree to be bound by the terms and conditions set forth at: <https://www.eurofinsus.com/environment-testing/built-environment/resources/sampling-guides-and-forms/>  
Copyright © 2022 Eurofins EPK Built Environment Testing, LLC



003907742

**Consultants**

Monrovia Office  
717 S. Myrtle Avenue  
Monrovia, CA 91016  
(626) 930-1200

Costa Mesa Office  
3176 Pullman St., Suite 108  
Costa Mesa, CA 92626  
(714) 444-9660

Rancho Office  
8333 Foothill Blvd. Suite 104  
Rancho Cuca, CA 91730  
(909) 796-0544

**BULK SAMPLE LOG**

Project Name: San Bernardino County / W 5th Street  
CCD Inc / SEC of Schaefer and Euclid Avenue

Collected By: Kaspar Wittlinger

Project No.: ~~22-16-121-05~~ 22-16-180-01

Date: January 8<sup>9</sup>, 2025

HOMOGENEOUS MATERIAL: Vapor barrier paper in perimeter wall cavity

Sample Number	Sample Location/Description	Friable or Non-Friable	Intact or Damaged	Approx. Area (Sq. Ft or LF)
81	2nd Floor, MEC	MF	I	~4,000
82	↓ ↓	↓	↓	↓
83	↓ ↓	↓	↓	↓

Additional Comments: over stucco.

---

---

---

---

---

---

---

---

---

---



003907742

**Consultants**

Monrovia Office  
717 S. Myrtle Avenue  
Monrovia, CA 91016  
(626) 930-1200

Costa Mesa Office  
3176 Pullman St., Suite 108  
Costa Mesa, CA 92626  
(714) 444-9660

Rancho Office  
8333 Foothill Blvd. Suite 104  
Rancho Cuca, CA 91730  
(909) 796-0544

**BULK SAMPLE LOG**

Project Name: San Bernardino Co / 303 W 5th St  
SCD Inc / SEC of Schaefer and Euclid Avenues

Collected By: Kaspar Wittlinger

Project No.: ~~22-16-121-05~~ 22-16-180-01

Date: January 8, 2025

HOMOGENEOUS MATERIAL: Black mirror wastefic

Sample Number	Sample Location/Description	Friable or Non-Friable	Intact or Damaged	Approx. Area (Sq. Ft or LF)
84	NEC Restroom by Room 101	NF	I	~30
85	N Women's Restroom (Rm 161)	↓	↓	↓
86	↓	↓	↓	↓

**Additional Comments:** Individual restrooms only - Large Restrooms (on Southern 2nd Floor) mirrors have brackets.



onsultants

Monrovia Office  
717 S. Myrtle Avenue  
Monrovia, CA 91016  
(626) 930-1200

Costa Mesa Office  
3176 Pullman St., Suite 108  
Costa Mesa, CA 92626  
(714) 444-9660

Rancho Office  
8333 Foothill Blvd. Suite 104  
Rancho Cuca, CA 91730  
(909) 796-0544

### BULK SAMPLE LOG

Project Name: San Bernardino Co / 302 W SR St  
~~CCD Inc / SEC of Schaefer and Euclid Avenues~~

Collected By: Kaspar Wittlinger

Project No.: ~~21-16-121-05~~ 22-16-180-01

Date: January 9, 2025

HOMOGENEOUS MATERIAL: Brown gravel & yellow underlayment to ceramic tile

Sample Number	Sample Location/Description	Friable or Non-Friable	Intact or Damaged	Approx. Area (Sq. Ft or LF)
87	NEC Restroom by Room 101	MF	I	~800
88	↓ ↓	↓	↓	↓
89	↓ ↓	↓	↓	↓

Additional Comments: Over smooth drywall.

---

---

---

---

---

---

---

---

---

---





Monrovia Office  
717 S. Myrtle Avenue  
Monrovia, CA 91016  
(626) 930-1200

Costa Mesa Office  
3176 Pullman St., Suite 108  
Costa Mesa, CA 92626  
(714) 444-9660

Rancho Office  
8333 Foothill Blvd. Suite 104  
Rancho Cuca, CA 91730  
(909) 796-0544

### BULK SAMPLE LOG

Project Name: San Bernardino Co / 303 W 5th St  
~~SCOD Inc / SEC of Schaefer and Euclid Avenues~~ Collected By: Kaspar Wittlinger

Project No.: ~~21-16-121-05~~ 22-16-180-01 Date: January 8<sup>9</sup>, 2025

HOMOGENEOUS MATERIAL: White grout & white underlayment to ceramic tile

Sample Number	Sample Location/Description	Friable or Non-Friable	Intact or Damaged	Approx. Area (Sq. Ft or LF)
93	SE Men's Restroom	NF	I	~1,400
94	↓	↓	↓	↓
95	↓	↓	↓	↓

Additional Comments: Over plaster.

---

---

---

---

---

---

---

---

---

---





003907742

nsultants

Monrovia Office  
717 S. Myrtle Avenue  
Monrovia, CA 91016  
(626) 930-1200

Costa Mesa Office  
3176 Pullman St., Suite 108  
Costa Mesa, CA 92626  
(714) 444-9660

Rancho Office  
8333 Foothill Blvd. Suite 104  
Rancho Cucu, CA 91730  
(909) 796-0544

### BULK SAMPLE LOG

Project Name: San Bernardino Co - 303 W 5th St  
RCCB Inc./SEC of Schaefer and Euclid Avenues Collected By: Kaspar Wittlinger

Project No.: 21-16-121-05 22-16-180-01 Date: January 8, 2025

HOMOGENEOUS MATERIAL: Grey, black dotted 12x12 vinyl floor tile & mastic

Sample Number	Sample Location/Description	Friable or Non-Friable	Intact or Damaged	Approx. Area (Sq. Ft or LF)
99	Room 125	NF	I	3
100	↓	↓	↓	↓
101	↓	↓	↓	↓

Additional Comments: Over concrete. Under previously sampled blue/gray mottled 12x12 VFF & mastic. 3 square feet exposed



sultants

Monrovia Office  
717 S. Myrtle Avenue  
Monrovia, CA 91016  
(626) 930-1200

Costa Mesa Office  
3176 Pullman St., Suite 108  
Costa Mesa, CA 92626  
(714) 444-9660

Rancho Office  
8333 Foothill Blvd. Suite 104  
Rancho Cuca, CA 91730  
(909) 796-0544

### BULK SAMPLE LOG

Project Name: San Bernardino Co / 303 W 5th St  
RCCD Inc / SEC of Schaefer and Euclid Avenues Collected By: Kaspar Wittlinger

Project No.: 21-16-121-05 22-16-180-01 Date: January 8, 2025

HOMOGENEOUS MATERIAL: White gravel & gray underlayment to ceramic tile

Sample Number	Sample Location/Description	Friable or Non-Friable	Intact or Damaged	Approx. Area (Sq. Ft or LF)
102	N. Women's testing restroom (Rm 161)	MF	F	~600
103	↓	↓	↓	↓
104	↓	↓	↓	↓

Additional Comments: over smooth drywall.



Consultants

Monrovia Office  
717 S. Myrtle Avenue  
Monrovia, CA 91016  
(626) 930-1200

Costa Mesa Office  
3176 Pullman St., Suite 108  
Costa Mesa, CA 92626  
(714) 444-9660

Rancho Office  
8333 Foothill Blvd. Suite 104  
Rancho Cuca, CA 91730  
(909) 796-0544

### BULK SAMPLE LOG

Project Name: San Bernardino Co / 303 W 5th St  
CCD Inc / SEC of Schaefer and Euclid Avenue

Collected By: Kaspar Wittlinger

Project No.: ~~21-16-121-05~~ 22-16-180-01

Date: January 8, 2025

HOMOGENEOUS MATERIAL: Grey grout of grey / white underlayment to ceramic tile

Sample Number	Sample Location/Description	Friable or Non-Friable	Intact or Damaged	Approx. Area (Sq. Ft or LF)
105	N. Women's Testing restroen (Rm 1611)	NF	F	~600
106	↓ ↓	↓	↓	↓
107	↓ ↓	↓	↓	↓

Additional Comments: One concrete.

---

---

---

---

---

---

---

---

---

---



Bulk Sample Location Map - HVAC Mezzanine  
303 W. 5th St., San Bernardino, CA

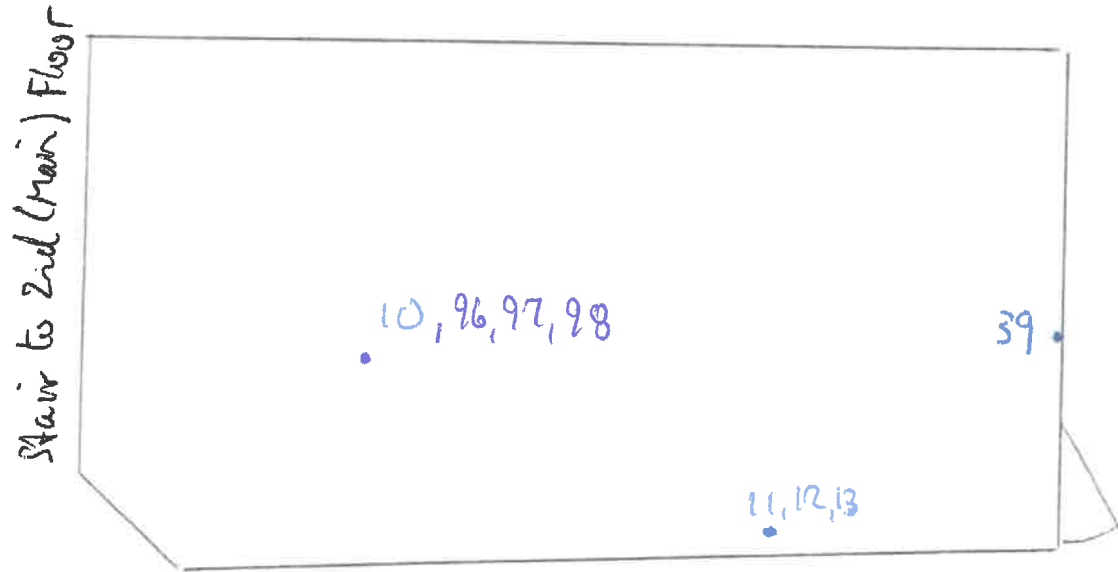

key:

• 11 - Bulk Sample Location

