

WARNING: ALL INDIVIDUALS INTERESTED IN BIDDING ON THIS PROJECT MUST OBTAIN THE FINAL PLANS AND SPECIFICATIONS FROM THE DEPARTMENT MANAGING THE PROJECT OR AS OTHERWISE STATED IN THE ADVERTISEMENT FOR BIDS FOR THE PROJECT. DO NOT USE THE PLANS AND SPECIFICATIONS POSTED ON THE CLERK OF THE BOARD'S WEBSITE FOR BIDDING ON THIS PROJECT.

SAN BERNARDINO COUNTY DEPARTMENT OF PUBLIC WORKS



TRANSPORTATION PLANS FOR CONSTRUCTION ON **BAKER BOULEVARD AND OTHER ROADS** VARIOUS LOCATIONS **BAKER AREA**

WORK ORDER NO. TX1814 ROAD NO. 150500-010 & 640175-010
LENGTH = 2.85 MILES

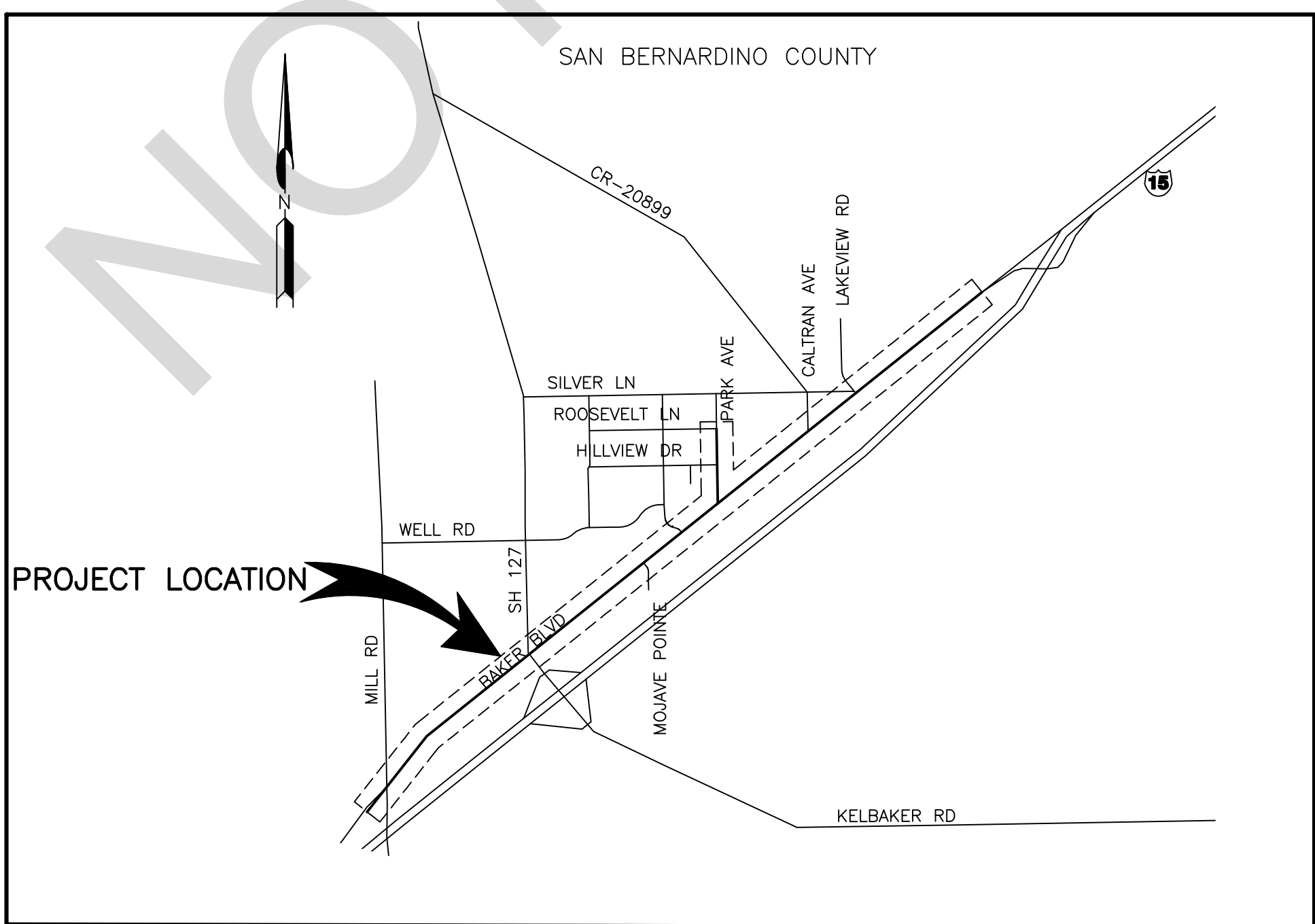

LOCATION MAP
NOT TO SCALE

SAN BERNARDINO COUNTY

APPROVED BY: BRENDON P. BIGGS, M.S., P.E., DIRECTOR OF PUBLIC WORKS R.C.E. 57127 DATE

APPROVED BY: NOEL CASTILLO, P.E., ASSISTANT DIRECTOR OF PUBLIC WORKS R.C.E. 78044 DATE

FILE NO. 150500-010 & 640175-010

REVISIONS	DATE
MARK	
REVISIONS	DATE
MARK	

FILE NO. 150500-010 & 640175-010-XXX

MARK	CHANGES	RESIDENT ENGINEER	DATE
	NO CHANGES		
FIELD CHANGES		SHT. NO.	TOT. SH'T'S.
		1	8

INDEX OF SHEETS

- 1 TITLE SHEET
- 2 PROJECT NOTES, LEGENDS, INDEX MAP, INDEX OF SHEETS
- 3-4 TYPICAL SECTIONS AND MISCELLANEOUS DETAILS
- 5-6 PLAN AND PROFILE ROAD
- 7 PLAN AND PROFILE RAMPS
- 8 TRAFFIC SIGNAL MODIFICATION PLAN

THE FOLLOWING SPECIAL DRAWINGS AND COUNTY STANDARDS ARE ATTACHED TO THE SPECIAL PROVISIONS:

- 115 (M) 303 303 (b) 305 (a)
- 119 303 (a) 305

TO BE SUPPLEMENTED BY THE FOLLOWING CALTRANS STANDARD PLANS DATED 2018:

- A20A A24F RSP ES-1B P10
- A20B A88A RSP ES-1C T9
- A20C ES-7P RSP ES-2E T10
- A20D ES-7R RSP ES-5C T11
- A24A ES-3B RSP ES-7A T13
- A24C ES-4E RSP ES-7N
- A24D ES-2C RSP ES-8A
- A2E RSP ES-1A RSP ES-8B

TO BE SUPPLEMENTED BY THE FOLLOWING MUTCD STANDARD PLANS DATED 2014:

- FIGURE 2A-2(CA) FIGURE 6H-29
- FIGURE 2C-13(CA) SECTION 6D.01
- FIGURE 3B-102(CA) SECTION 6D.02
- FIGURE 6H-28

THIS PROJECT REQUIRES A CONTRACTOR'S LICENSE CLASS "A"

GENERAL NOTES

U. THE FACT THAT ANY UTILITY FACILITY IS SHOWN OR NOT SHOWN UPON THE PLANS SHALL NOT RELIEVE THE CONTRACTOR OF THE RESPONSIBILITY UNDER SECTION 5-1.36 C "NON-HIGHWAY FACILITIES" OF THE CALTRANS STANDARD SPECIFICATIONS. IT SHALL BE THE CONTRACTOR'S RESPONSIBILITY, PURSUANT THERETO, TO ASCERTAIN THE LOCATION OF ANY UTILITY FACILITY WHICH MAY BE SUBJECT TO DAMAGE BY REASON OF THE CONTRACTOR'S OPERATIONS.

1. ALL STATIONING NOTES ON PLAN REFER TO THE CL IMP XXXXX ROAD OR SIDE STREET.
2. DIMENSIONS ARE SUBJECT TO TOLERANCES SPECIFIED IN THE CALTRANS STANDARD SPECIFICATIONS.
3. ALL PAVEMENT WIDTH DIMENSIONS SHOWN ON THE PLANS ARE TO THE EDGE OF PAVEMENT OR TO THE TOP OF CURB, UNLESS OTHERWISE NOTED.
4. TRANSITIONS AND WARPING SHALL BE AS SHOWN AND AS DETERMINED BY THE ENGINEER.
5. ASPHALT CONCRETE OVERLAYS SHALL BE FEATHERED TO MEET EXISTING AS SHOWN ON THE PLANS OR AS DETERMINED BY THE ENGINEER.
6. ALL TREES & VEGETATION OUTSIDE THE LIMITS OF EXCAVATION AND EMBANKMENT SLOPE LINES, SHALL BE PROTECTED IN PLACE.

BASIS OF BEARINGS:

CENTERLINE OF BAKER BLVD AS SHOWN ON PM 185/61-62 BEING N52°24'12"E. TRANSLATE PROJECT AT POINT #2:
 10000 2289917.083542
 from 10000 to 7138456.441561
 SCALE PROJECT AT Pt #2 (0.99992222) (-1°05'41.199099") TO OBTAIN RECORD BASIS OF BEARING AND GRID COORDINATES.

BENCH MARK:

FOUND 1"IP w/SBCo TAG, FLUSH(Pt#6)@ INTX CL BAKER BLVD & EAST LINE SW 1/4 SECTION 30, T14N, R9E, SBM BEING Pt #13 PER CSFB 4454/64. NGVD-29 ELEVATION = 957.44'

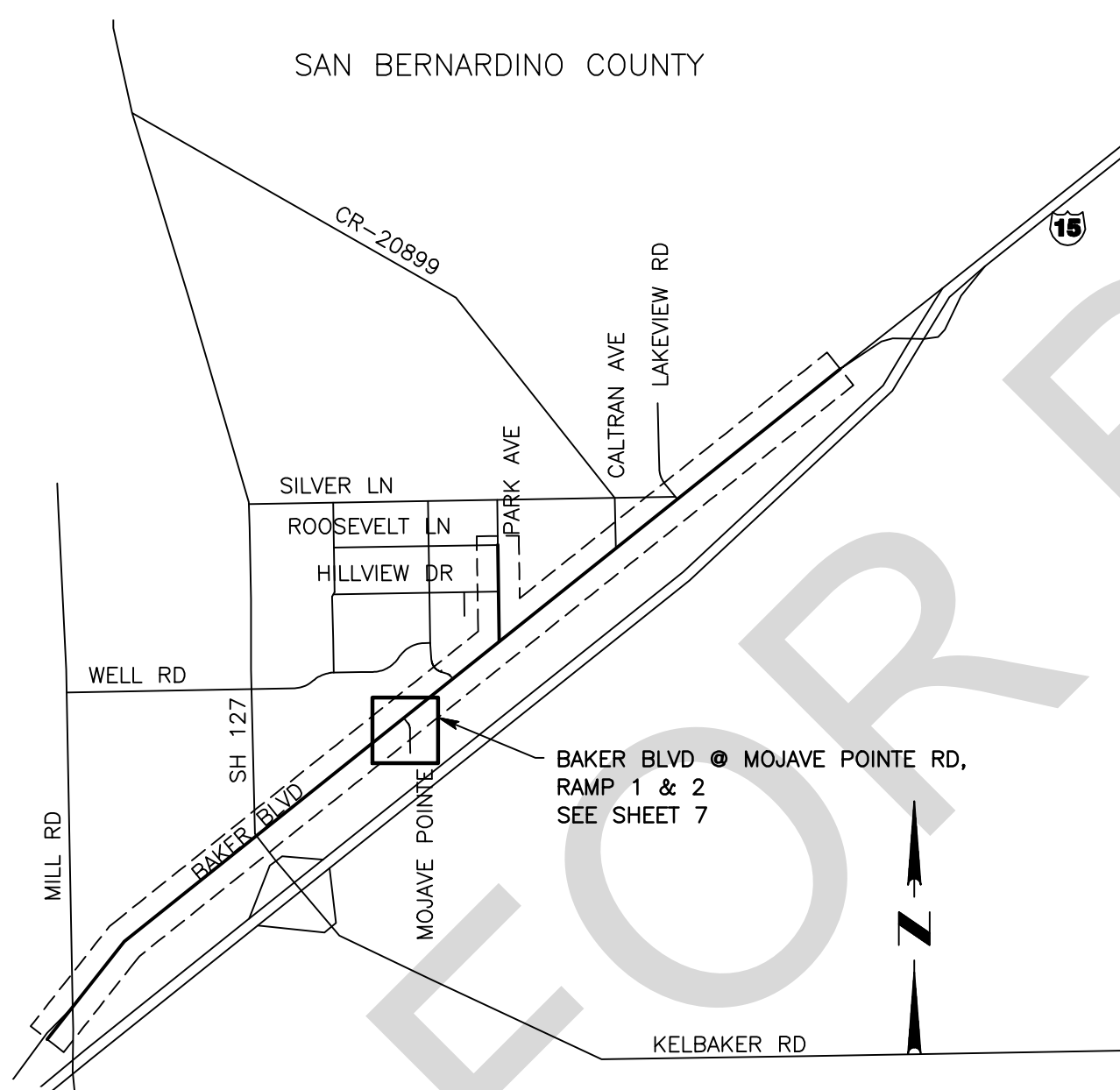

INDEX MAP
NTS

ABBREVIATIONS LEGEND:

- AC = ASPHALT CONCRETE
- ADA = AMERICAN WITH DISABILITY ACT
- AG = AGGREGATE GRADATION
- AVE = AVENUE
- BCR = BEGIN CURB RETURN
- CL = CENTER LINE
- C & G = CURB AND GUTTER
- DWG = DRAWING
- ECR = END OF CURB RETURN
- EP = EDGE OF PAVEMENT
- EXIST = EXISTING
- FL = FLOW LINE
- GB = GRADE BREAK
- HMA = HOT MIX ASPHALT
- LIP = GUTTER LIP
- LT = LEFT
- M = MODIFY
- N/O = NORTH OF
- NTS = NOT TO SCALE
- THK = THICKNESS
- RT = RIGHT
- R/W = RIGHT OF WAY
- SBC = SAN BERNARDINO COUNTY
- SHT = SHEET
- S/O = SOUTH OF
- ST = STREET
- STA = STATION
- STD = STANDARD
- TC = TOP CURB

CONSTRUCTION MATERIALS

- PLAN
- ASPHALT CONCRETE OVERLAY
 - ASPHALT CONCRETE PAVEMENT
 - COLD PLANE/MILL AND OVERLAY
 - PORTLAND CEMENT CONCRETE
- SECTION
- ASPHALT CONCRETE OVERLAY
 - ASPHALT CONCRETE PAVEMENT
 - NATURAL GROUND
 - AGGREGATE BASE

UNDERGROUND UTILITY LEGEND

- GAS LINE G
- SEWER MAIN LINE S
- WATER LINE W
- ELECTRIC LINE E
- TELEPHONE LINE T
- DATA/CABLE LINE TF

CONSTRUCTION NOTES:

- 1 PROTECT IN PLACE
- 2 PLACE TREATMENT PER STRUCTURAL SECTION, SEE SHEET 4 PER DETAILS
- 3 REMOVE EXISTING SIDEWALK, CURB & GUTTER OR ASPHALT CONCRETE DIKE
- 4 SAWCUT AND REMOVE EXISTING AC SURFACING TO FULL DEPTH
- 5 PLACE 0.67" THICK AC (TYPE A 3/4" AG) OVER COMPACTED NATIVE SOIL
- 6 CONSTRUCT ADA RAMP PER CALTRANS STD AB8A, CASE PER PLAN
- 7 REMOVE OR RESET ROAD SIGN PER TRAFFIC PLAN
- 8 PLACE DETECTABLE WARNING SURFACE, SEE SPECIAL PROVISIONS
- 9 PLACE SHOULDER BACKING AS NEEDED
- 10 PLACE 8" CURB OR CURB AND GUTTER PER SB COUNTY STD 115 (M)
- 11 PLACE CROSS GUTTER PER SB COUNTY STD DWG 119
- 12 COLD PLANE 0.10" AND PLACE 0.10" ASPHALT CONCRETE (TYPE A, 3/4" AG)
- 13 TRAFFIC SIGNAL POLES PER TRAFFIC SIGNAL PLAN
- 14 REMOVE OR RELOCATED CONCRETE BLOCK OUTSIDE OF THE ROAD R/W BY OTHER
- 15 SAWCUT AND REMOVE EXISTING ASPHALT CONCRETE SURFACING
- 16 PLACE STRUCTURAL SECTION PER TYPICAL SECTION AND DETAILS 1A

FILE NO. 150500-010 & 640175-010-XXX

FILE NO.150500-010 & 640175-010

		SAN BERNARDINO COUNTY DEPARTMENT OF PUBLIC WORKS				BAKER BLVD & OTHERS PROJECT NOT, INDEX MAP, LEGENDS AND INDEX OF SHEETS BAKER AREA				
		DESIGNED BY: HV	DRAWN BY: HV	CHECKED BY: NM	RECOMMENDED BY: CHRIS NGUYEN, P.E. ENGINEERING MANAGER	DATE: _____				
FIELD CHANGES MARK CHANGES RESIDENT ENGINEER DATE		APPROVED BY: NOEL MONDRAGON, P.E. SUPERVISING ENGINEER DATE: _____ MERVAT N. MIKHAIL, P.E. DEPUTY DIRECTOR DATE: _____				J.L. REF.	W.O. NO.	PLAN SCALE	SHT. NO.	TOT. SH'TS.
						JL12042	TX1814	AS SHOWN	2	8

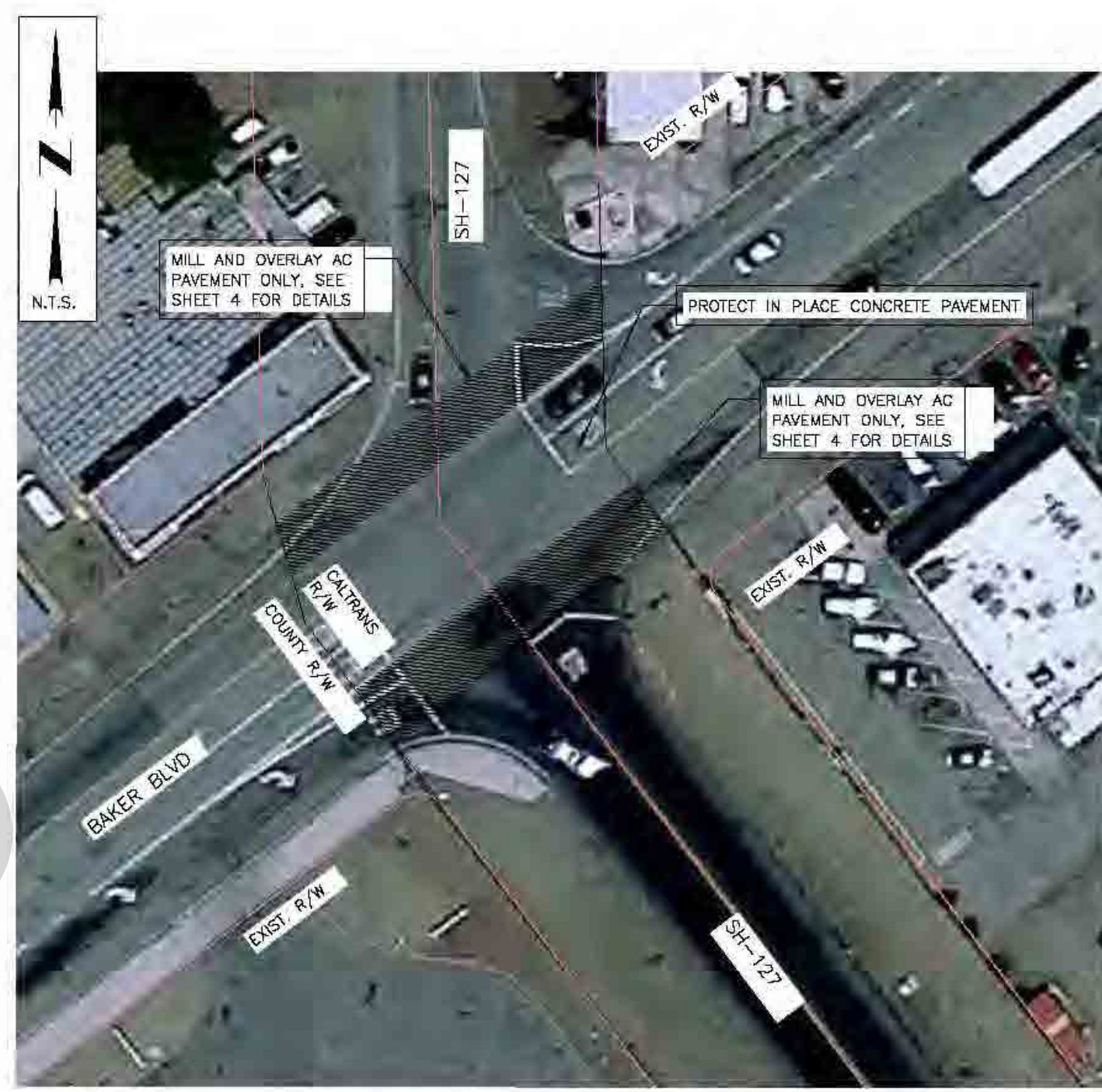
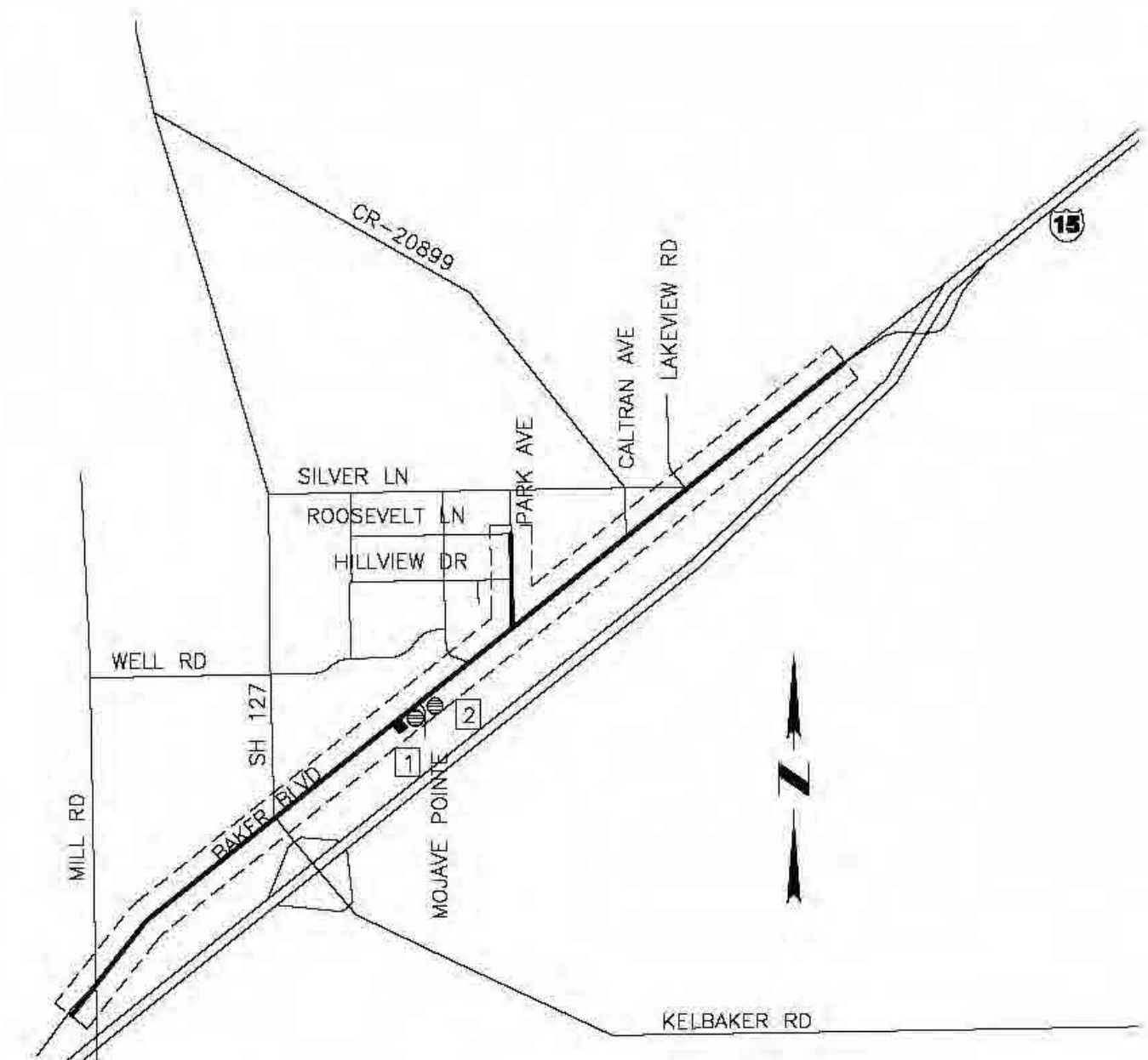

LEGEND AND SYMBOL

	ADA RAMP
	RAMP NUMBER
	SIDEWALK REPAIR

**SIDEWALK REPAIR
BAKER BLVD**
NTS

**CALTRANS R/W AREA
BAKER BLVD AND SH-127**
NTS

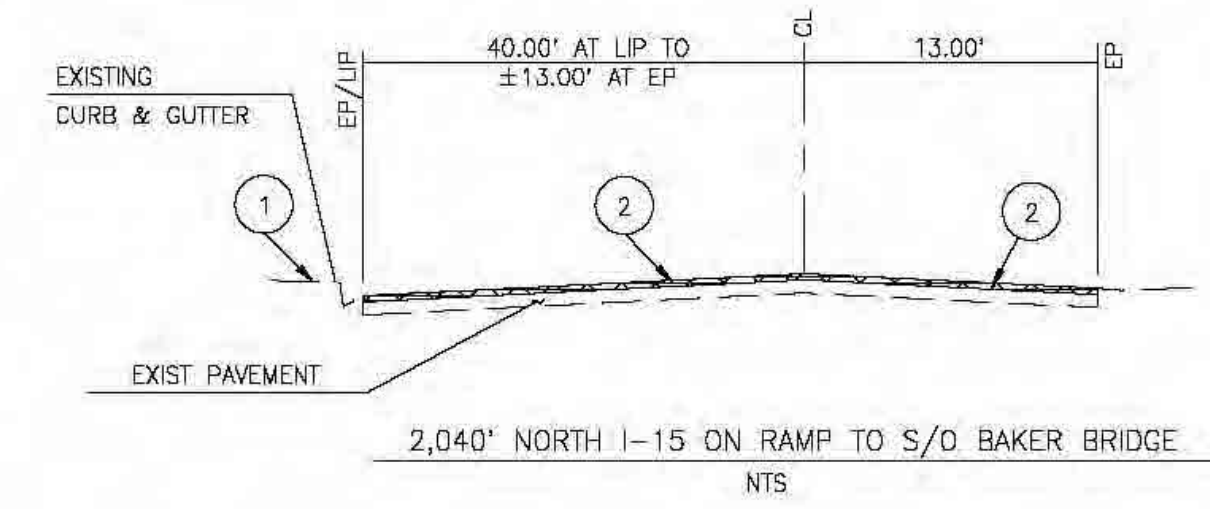
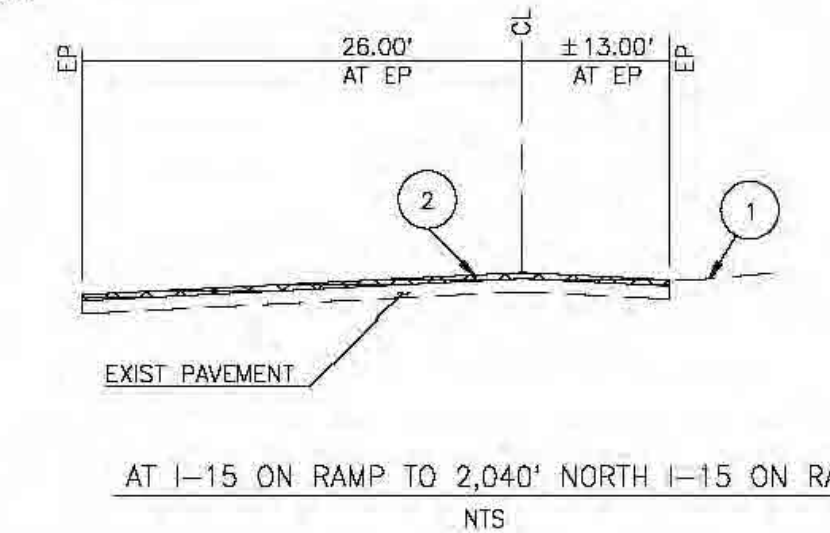
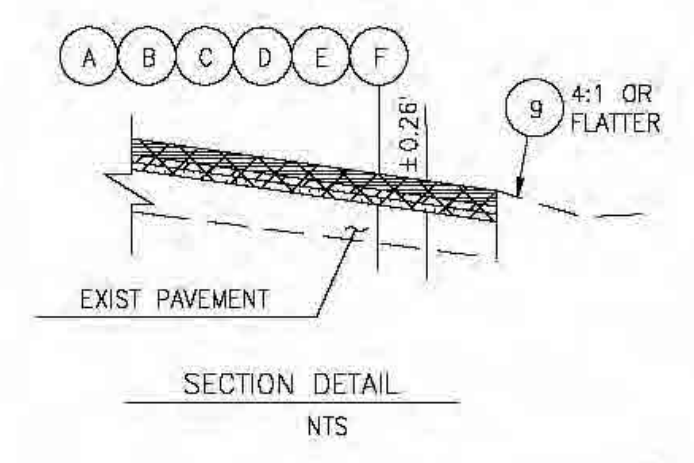

**TYPICAL SECTIONS
BAKER BLVD**
NTS

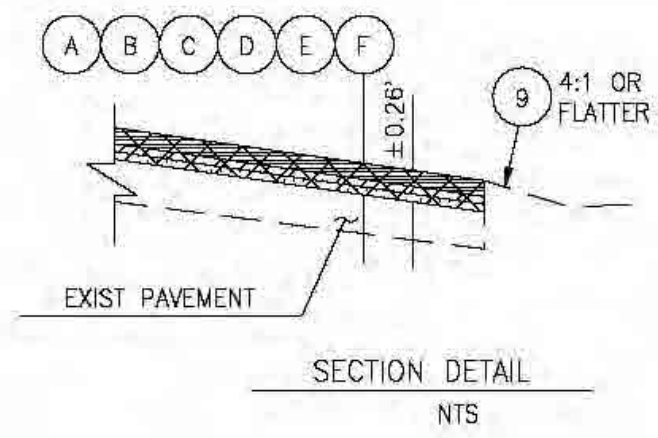
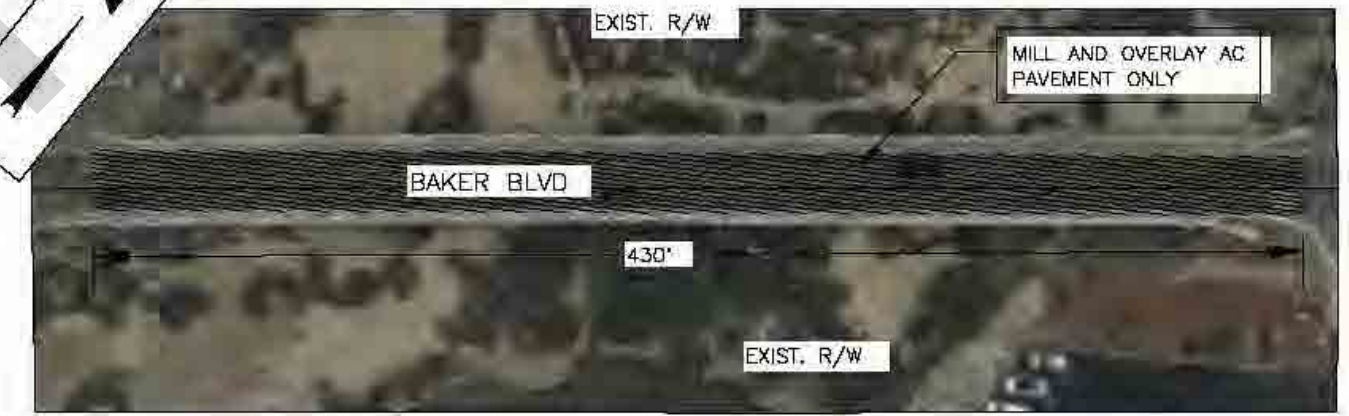
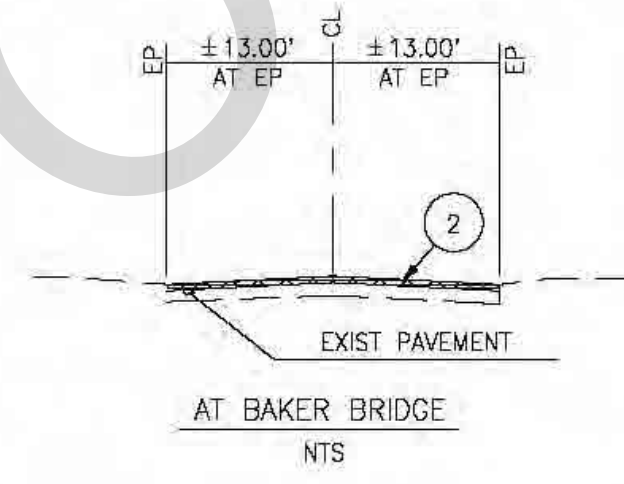

**BAKER BRIDGE
BAKER BLVD**
NTS

- CONSTRUCTION NOTES
1. PROTECT IN PLACE
 2. PLACE TREATMENT PER STRUCTURAL SECTION DETAIL AS SHOWN ON THIS SHEET
 9. PLACE SHOULDER BACKING AS NEEDED SEE SPECIAL PROVISIONS

- STRUCTURAL SECTION DETAIL NOTES
- A. COLD PLANE THE ROAD SURFACE TO A DEPTH OF 0.26'
 - B. APPLY TACK COAT
 - C. PLACE 0.06' LEVELING COURSE (TYPE A 3/8" AGGREGATE GRADATION, PG 70-10 HMA)
 - D. APPLY BINDER PER MANUFACTURER'S RECOMMENDATIONS
 - E. APPLY PAVEMENT REINFORCEMENT FABRIC
 - F. PLACE 0.20' THK ASPHALT CONCRETE (TYPE A 3/4" AGGREGATE GRADATION) PG 64-28 PM, HMA. TAPER DOWN TO MEET THE LIP OF GUTTER

FILE NO. 150500-010 & 640175-010-XXX

MARK	CHANGES	RESIDENT ENGINEER	DATE
	NO CHANGES		

FIELD CHANGES

MARK	CHANGES	RESIDENT ENGINEER	DATE
	NO CHANGES		



SAN BERNARDINO COUNTY
DEPARTMENT OF PUBLIC WORKS

DESIGNED BY:	DRAWN BY:	CHECKED BY:	RECOMMENDED BY:
HV	HV	NM	CHRIS NGUYEN, P.E. ENGINEERING MANAGER
APPROVED BY:			
NOEL MONDRAGON, P.E. SUPERVISING ENGINEER			MERVAT N. MIKHAIL, P.E. DEPUTY DIRECTOR

BAKER BLVD & OTHERS
TYPICAL SECTIONS AND DETAILS
BAKER AREA

J.L. REF.	W.G. NO.	PLAN SCALE	SHT. NO.	TOT. SHTS.
JL12042	TX1814	AS SHOWN	3	8

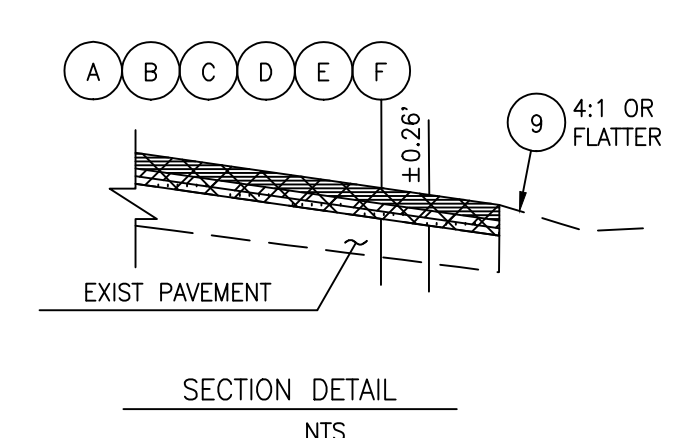
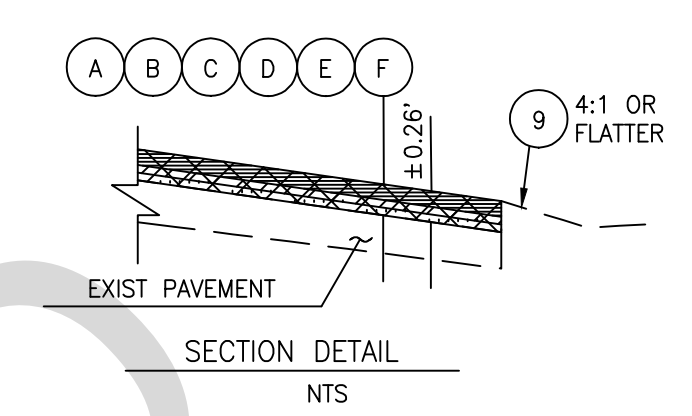
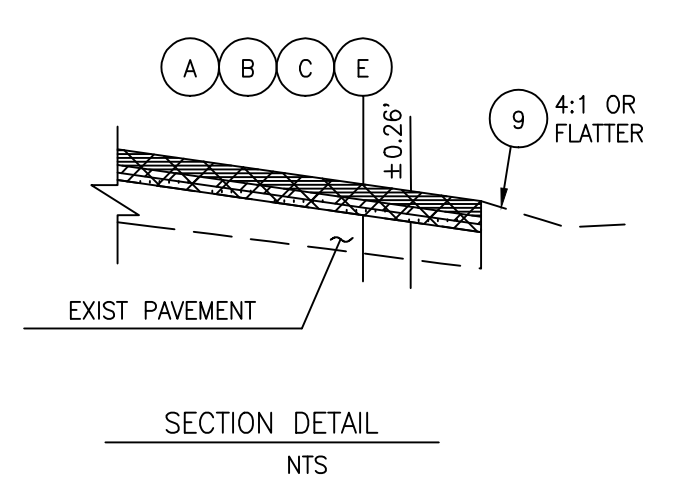
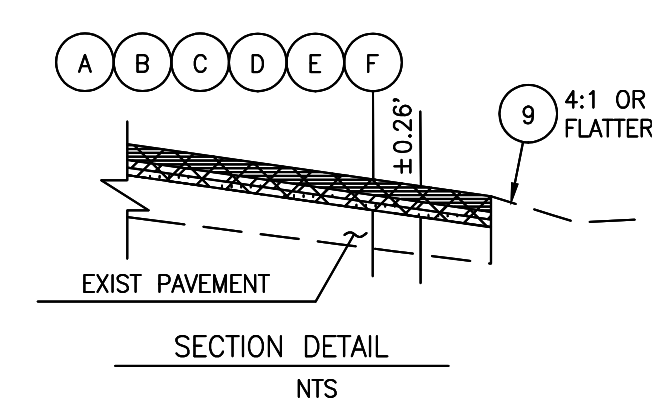
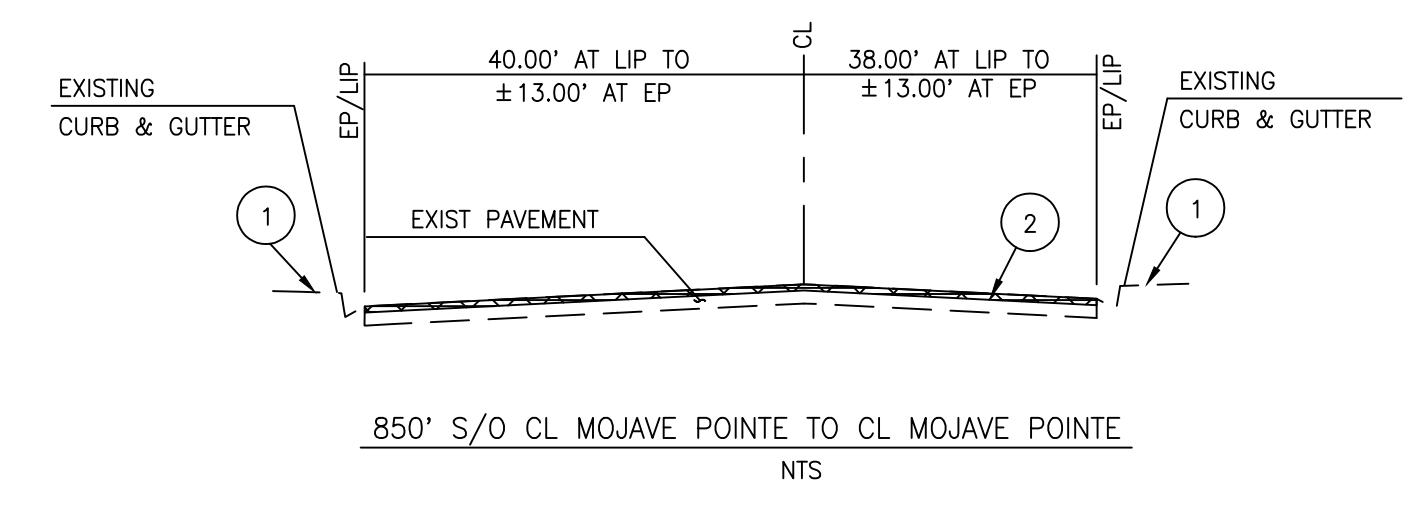
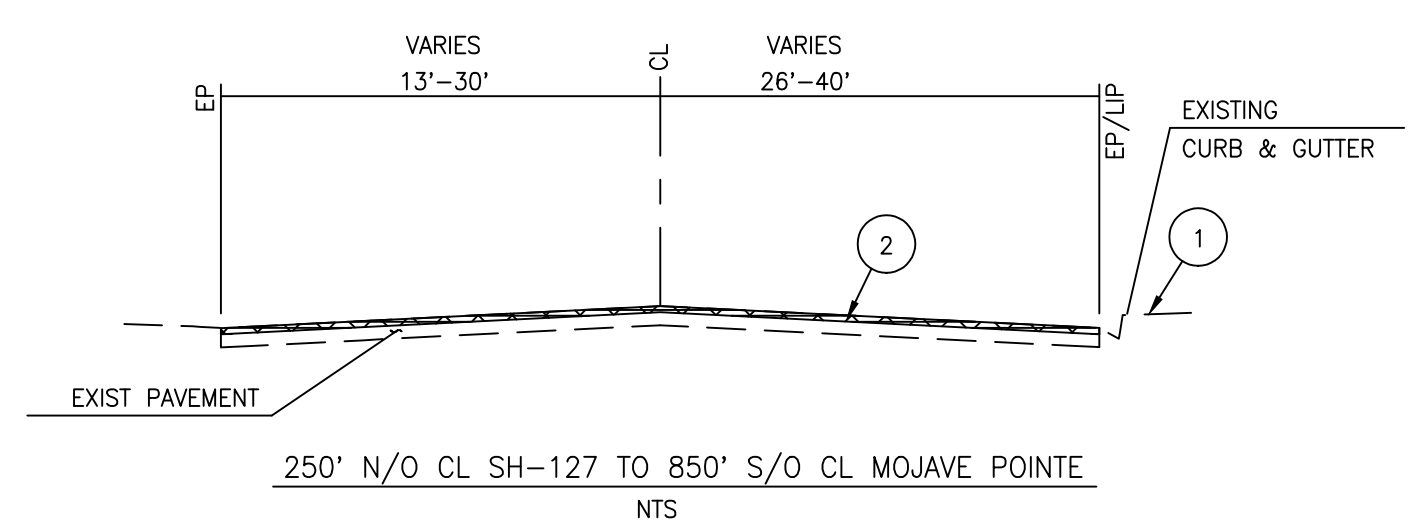
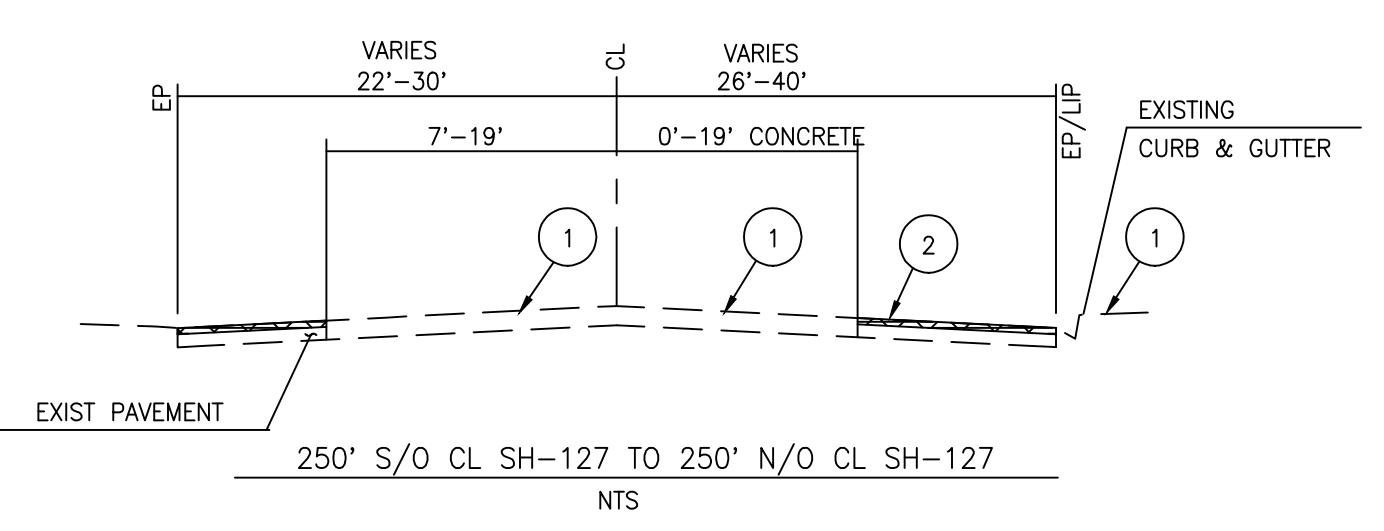
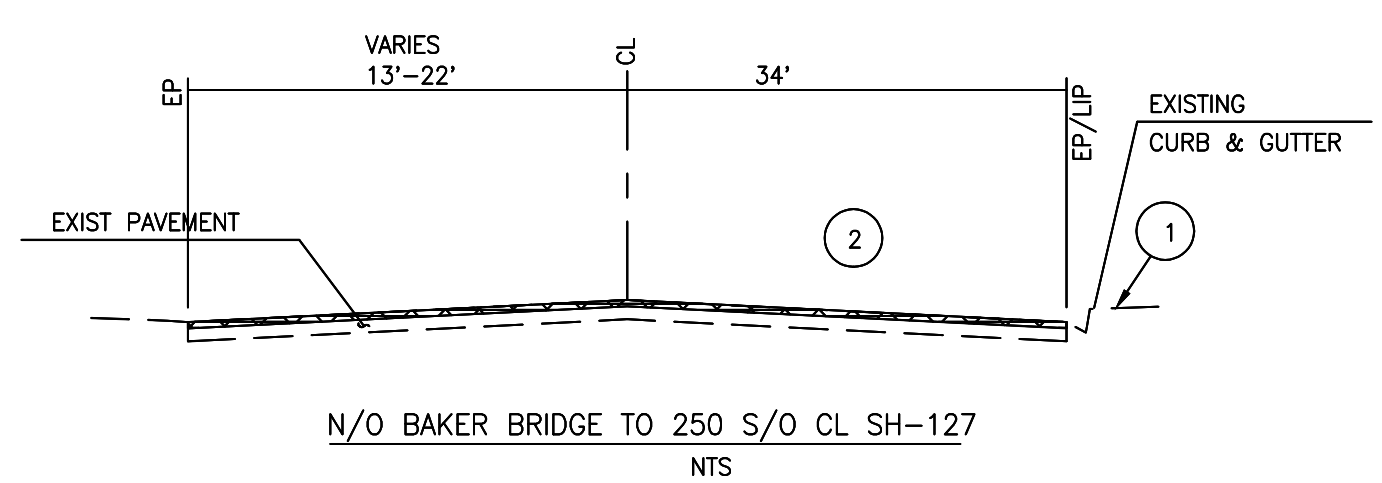

TYPICAL SECTIONS
BAKER BLVD
NTS

TYPICAL SECTIONS
BAKER BLVD
NTS

TYPICAL SECTIONS
BAKER BLVD
NTS

TYPICAL SECTIONS
BAKER BLVD
NTS

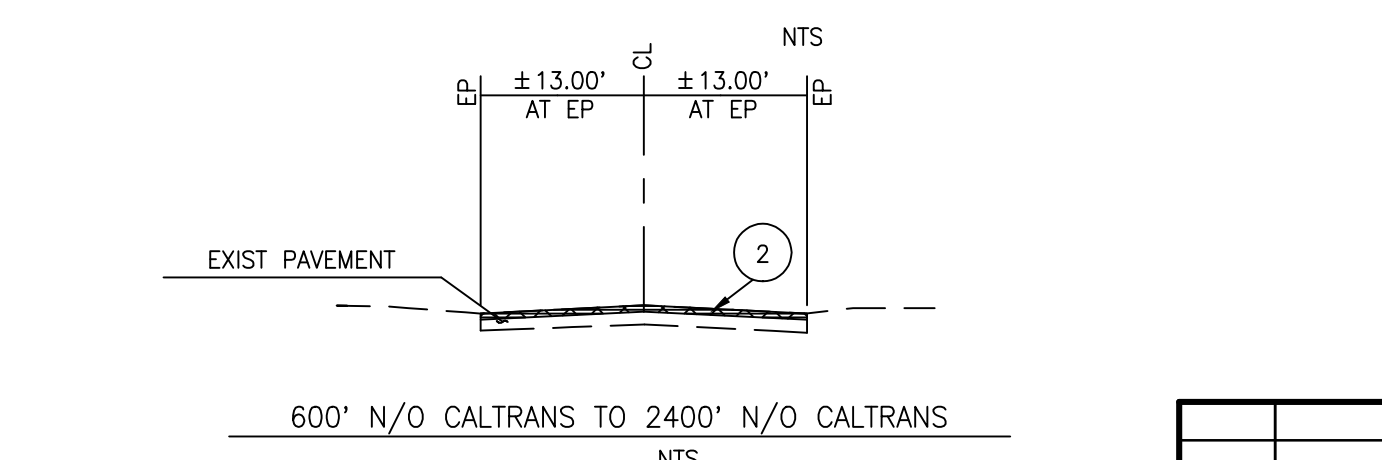
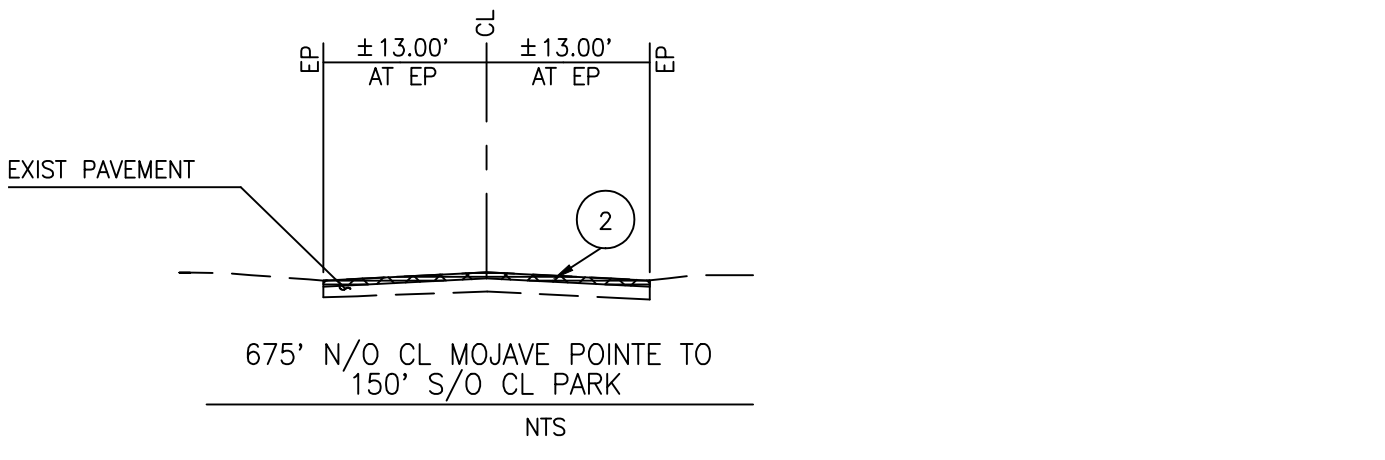
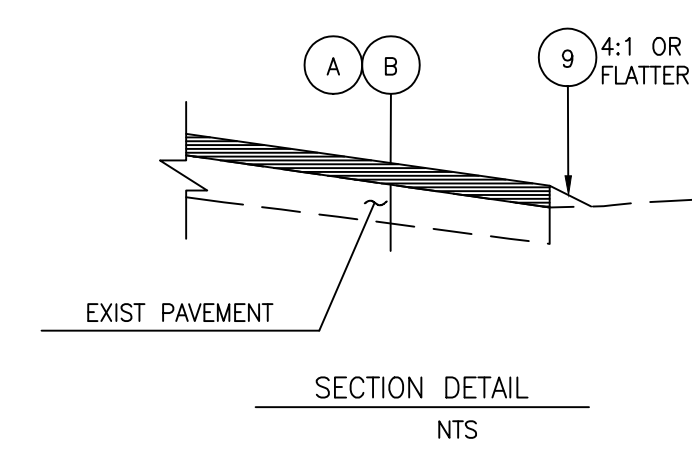
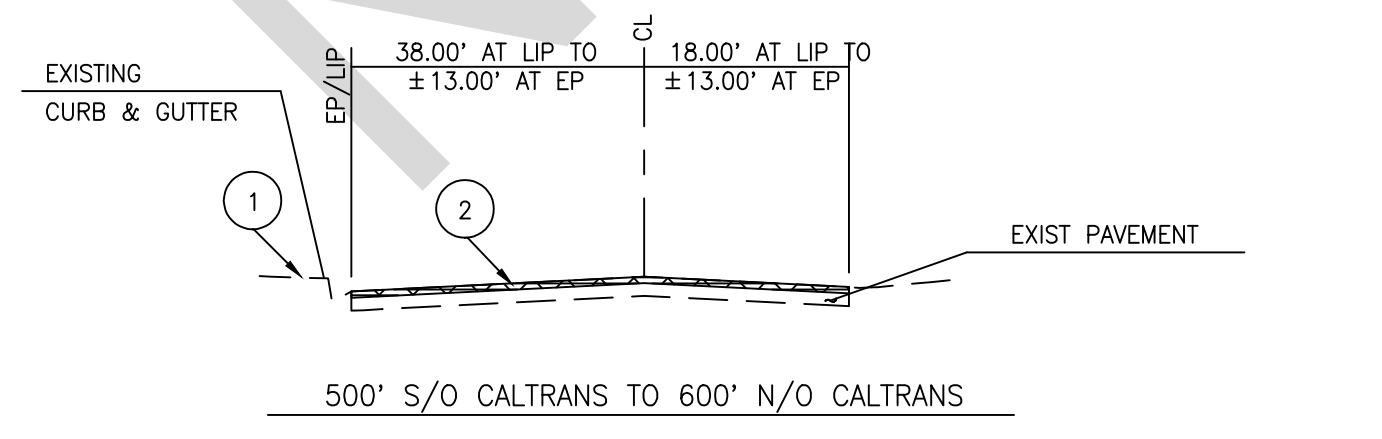
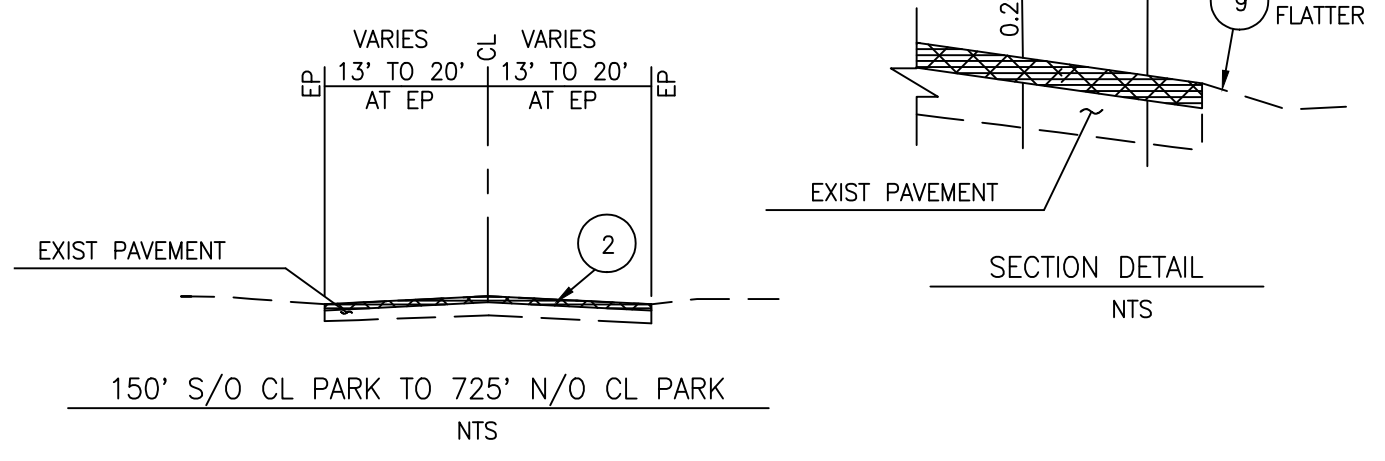
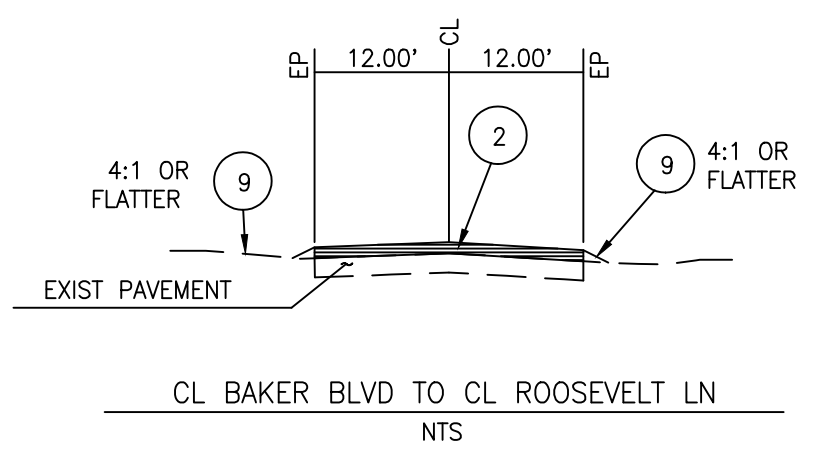
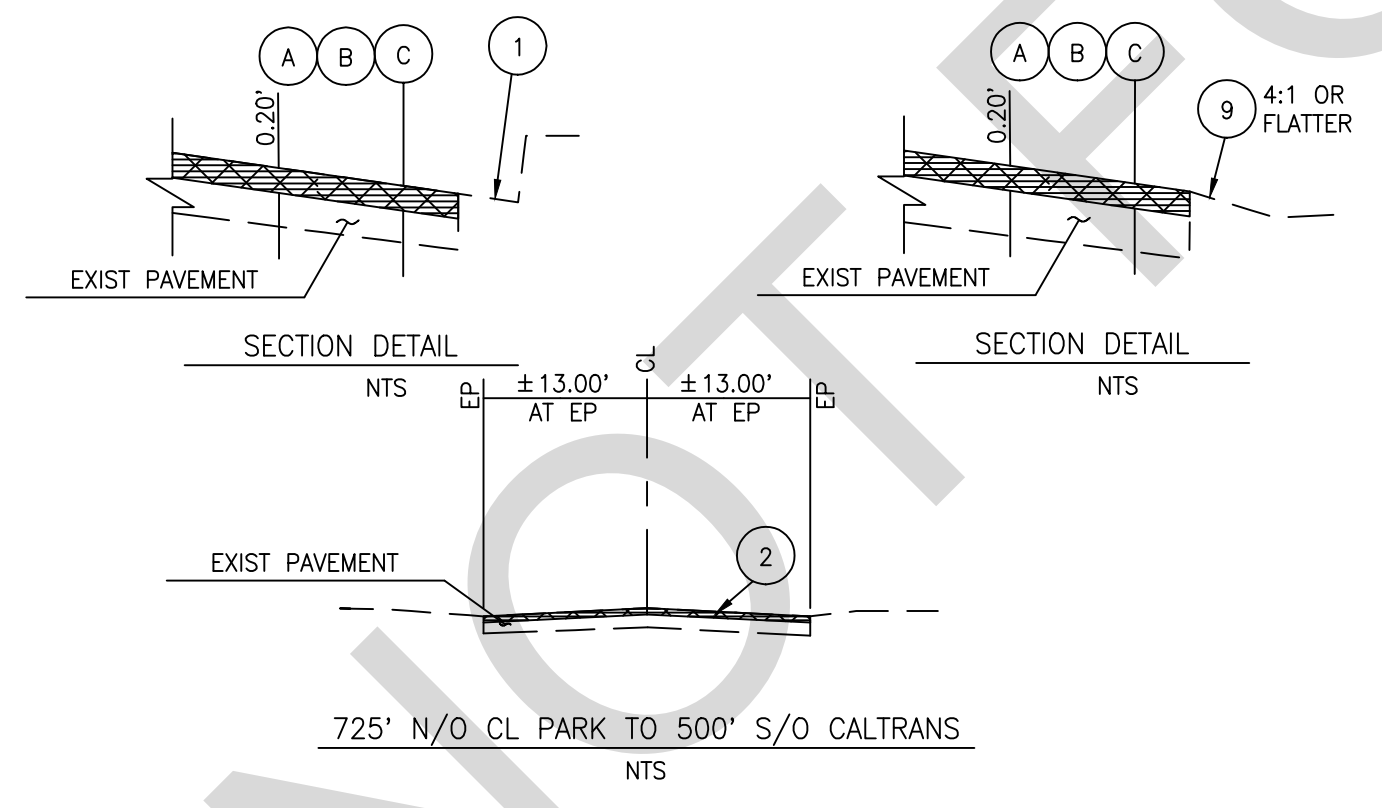
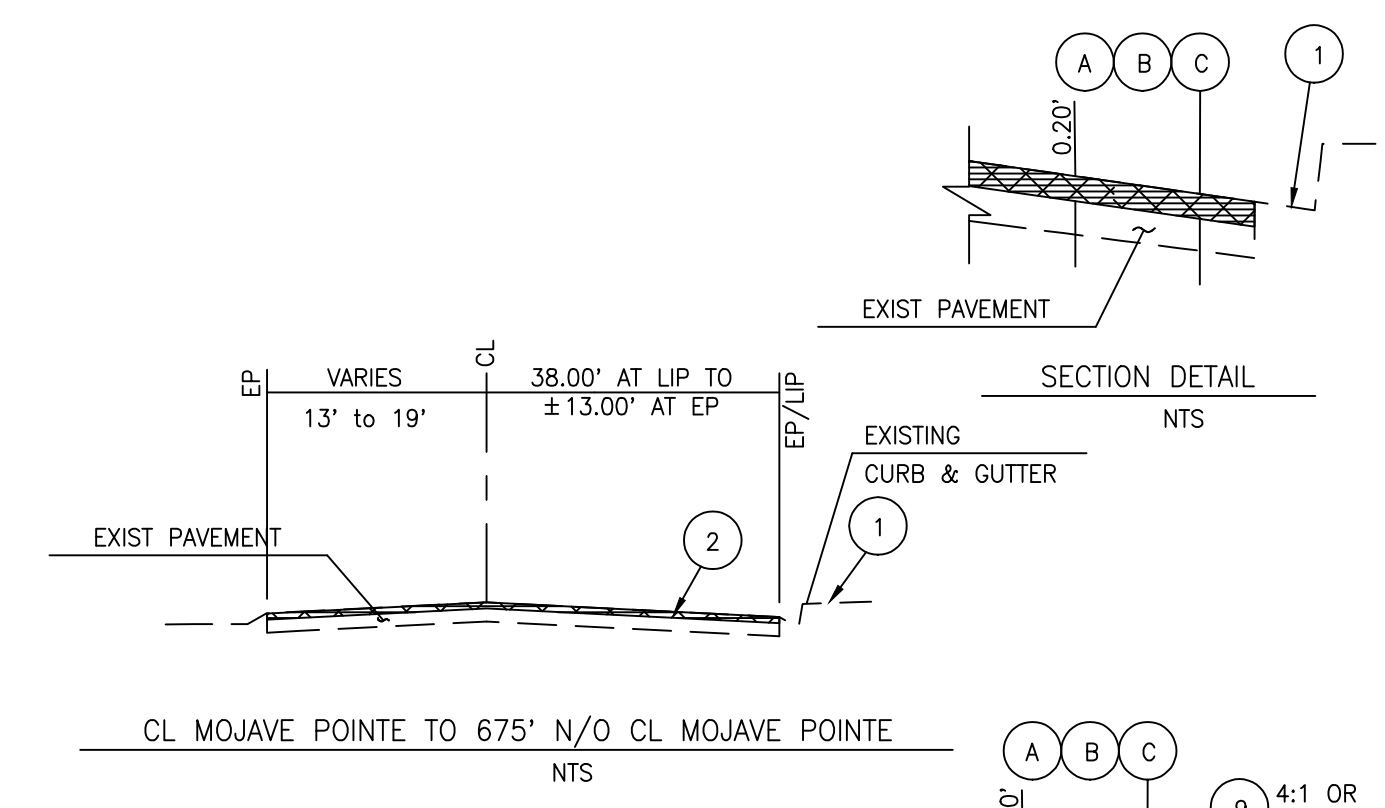

TYPICAL SECTIONS
PARK AVE
NTS

- CONSTRUCTION NOTES
1 PROTECT IN PLACE
2 PLACE TREATMENT PER STRUCTURAL SECTION DETAIL AS SHOWN ON THIS SHEET
9 PLACE SHOULDER BACKING AS NEEDED SEE SPECIAL PROVISIONS

- STRUCTURAL SECTION DETAIL NOTES
A COLD PLANE THE ROAD SURFACE TO A DEPTH OF 0.26'
B APPLY TACK COAT
C PLACE 0.06' LEVELING COURSE (TYPE A 3/8" AGGREGATE GRADATION, PG 70-10 HMA)
D APPLY BINDER PER MANUFACTURER'S RECOMMENDATIONS
E APPLY PAVEMENT REINFORCEMENT FABRIC
F PLACE 0.20" THK ASPHALT CONCRETE (TYPE A 3/4" AGGREGATE GRADATION) PG 64-28 PM, HMA. TAPER DOWN TO MEET THE LIP OF GUTTER

TYPICAL SECTIONS
BAKER BLVD
NTS

TYPICAL SECTIONS
BAKER BLVD
NTS

Table with 2 columns: MARK, CHANGES. Includes 'FIELD CHANGES' section.

Professional Engineer seal for Chris Nguyen, No. 063582, State of California. Includes project details and signatures.

Project information table including J.L. REF. (JL12042), W.O. NO. (TX1814), PLAN SCALE (AS SHOWN), SHT. NO. (4), and TOT. SHT'S. (8).

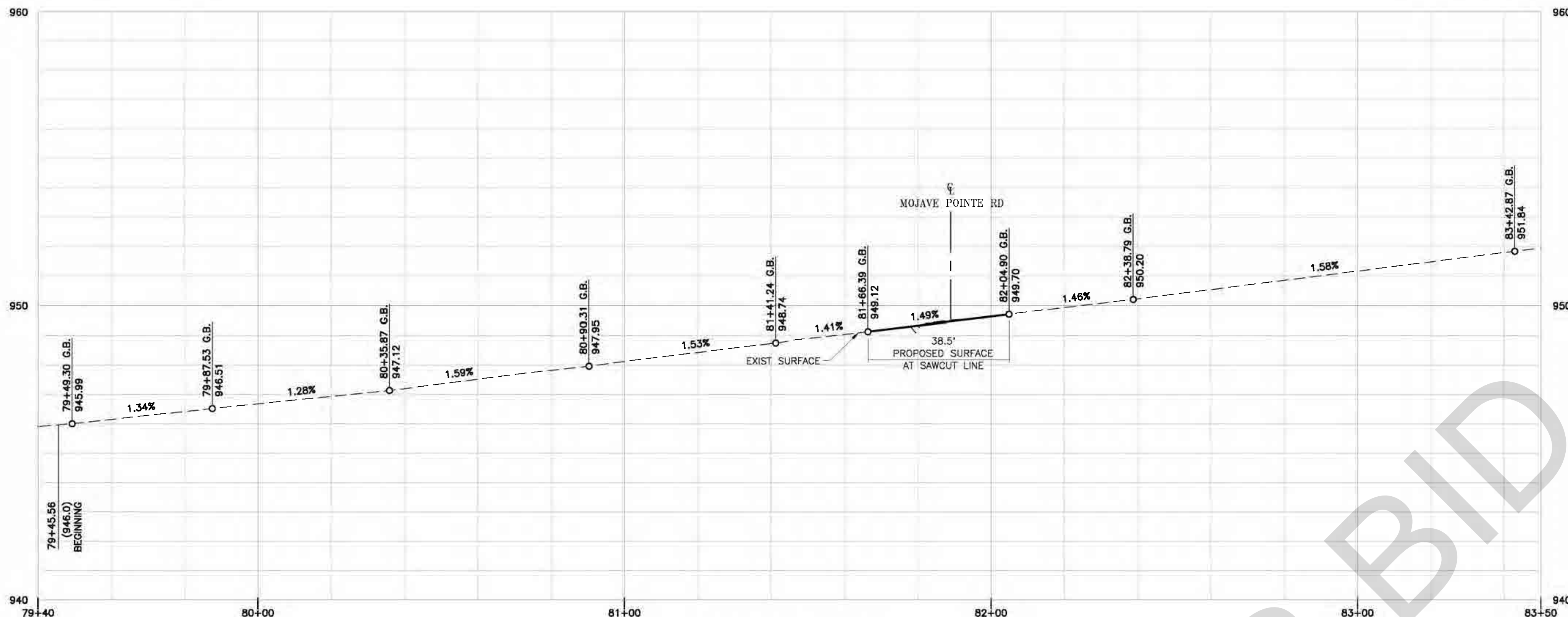

PROFILE VIEW
AT SAW CUT LINE
HOR. SCALE: 1"=20'
VER. SCALE: 1"=2'

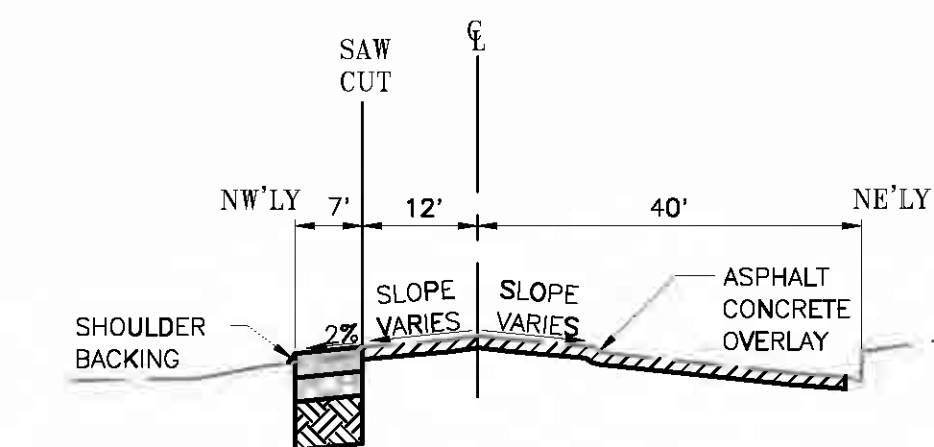

TYPICAL SECTION
STA 79+45.56 TO 83+50.00
(NTS)

- CONSTRUCTION NOTES:**
- 14 REMOVE OR RELOCATED CONCRETE BLOCK OUTSIDE OF THE ROAD R/W BY OTHER
 - 15 SAWCUT AND REMOVE EXISTING ASPHALT CONCRETE SURFACING
 - 16 PLACE STRUCTURAL SECTION PER TYPICAL SECTION AND DETAILS 1A

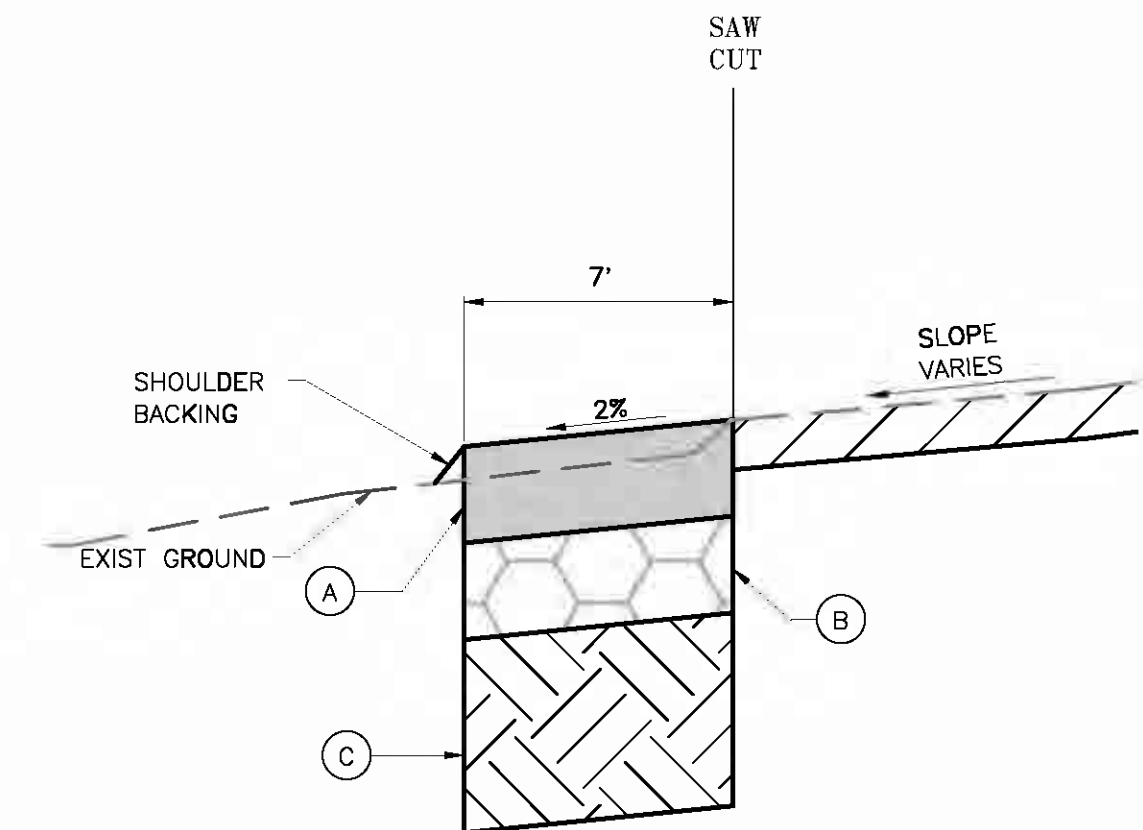
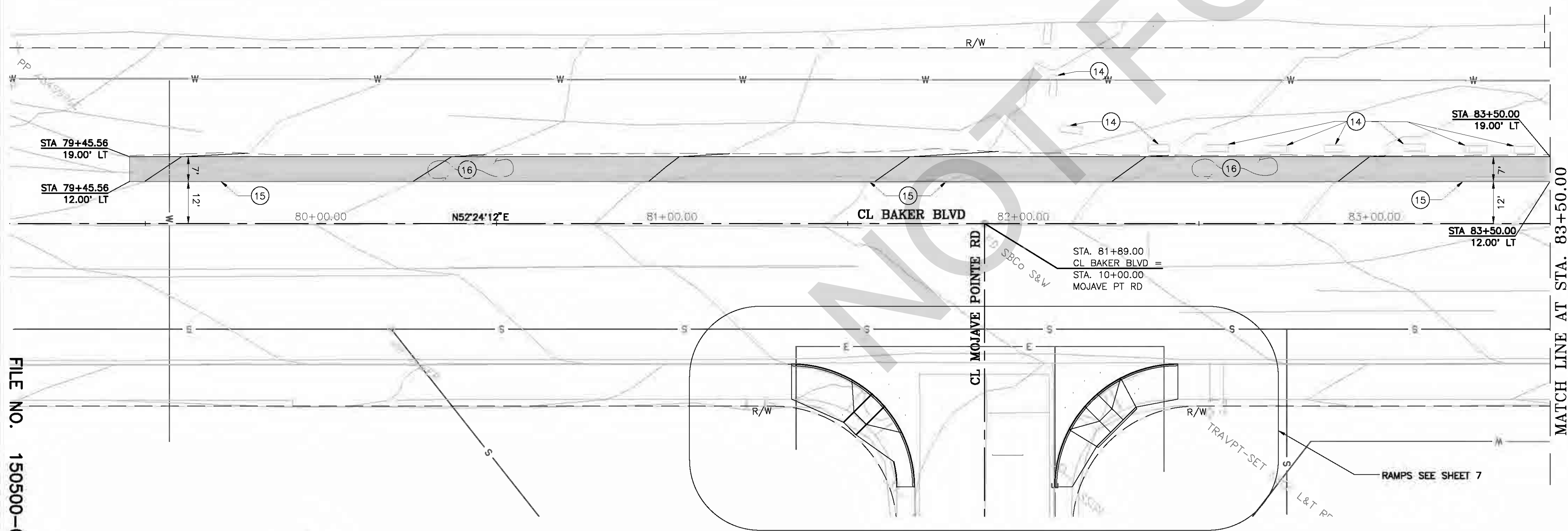

1A STRUCTURAL SECTION DETAIL
STA 79+45.56 TO 83+50.00
(NTS)

- STRUCTURAL SECTION DETAIL NOTES**
- A PLACE 0.50' OF TYPE A, 3/4" AGGREGATE GRADATION, PG 64-28 PM, HMA
 - B PLACE 0.50' CLASS II AGGREGATE BASE at 95% RELATIVE COMPACTION
 - C NATIVE SOIL at 95% RELATIVE COMPACTION

FILE NO. 150500-010 & 640175-010-XXX

REVISIONS	DATE	DESCRIPTION

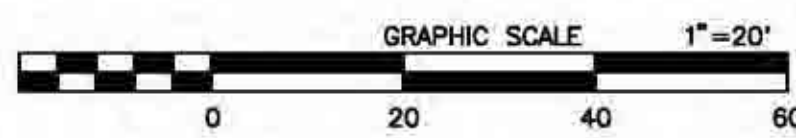

MARK	CHANGES	RESIDENT ENGINEER	DATE

FIELD CHANGES



SAN BERNARDINO COUNTY DEPARTMENT OF PUBLIC WORKS			
DESIGNED BY: HV	DRAWN BY: HV	CHECKED BY: NM	RECOMMENDED BY: CHRIS NGUYEN, P.E. ENGINEERING MANAGER
DATE		DATE	
NOEL MONDRAGON, P.E. DESIGN ENGINEER		MERVAT N. MIKHAIL, P.E. DEPUTY DIRECTOR	
DATE		DATE	

BAKER BLVD & OTHERS PLAN AND PROFILE BAKER AREA STA 79+45.56 TO 83+50				
J.L. REF.	W.O. NO.	PLAN SCALE	SHT. NO.	TOT. SHT'S.
JL12042	TX1814	1"=20'	5	8

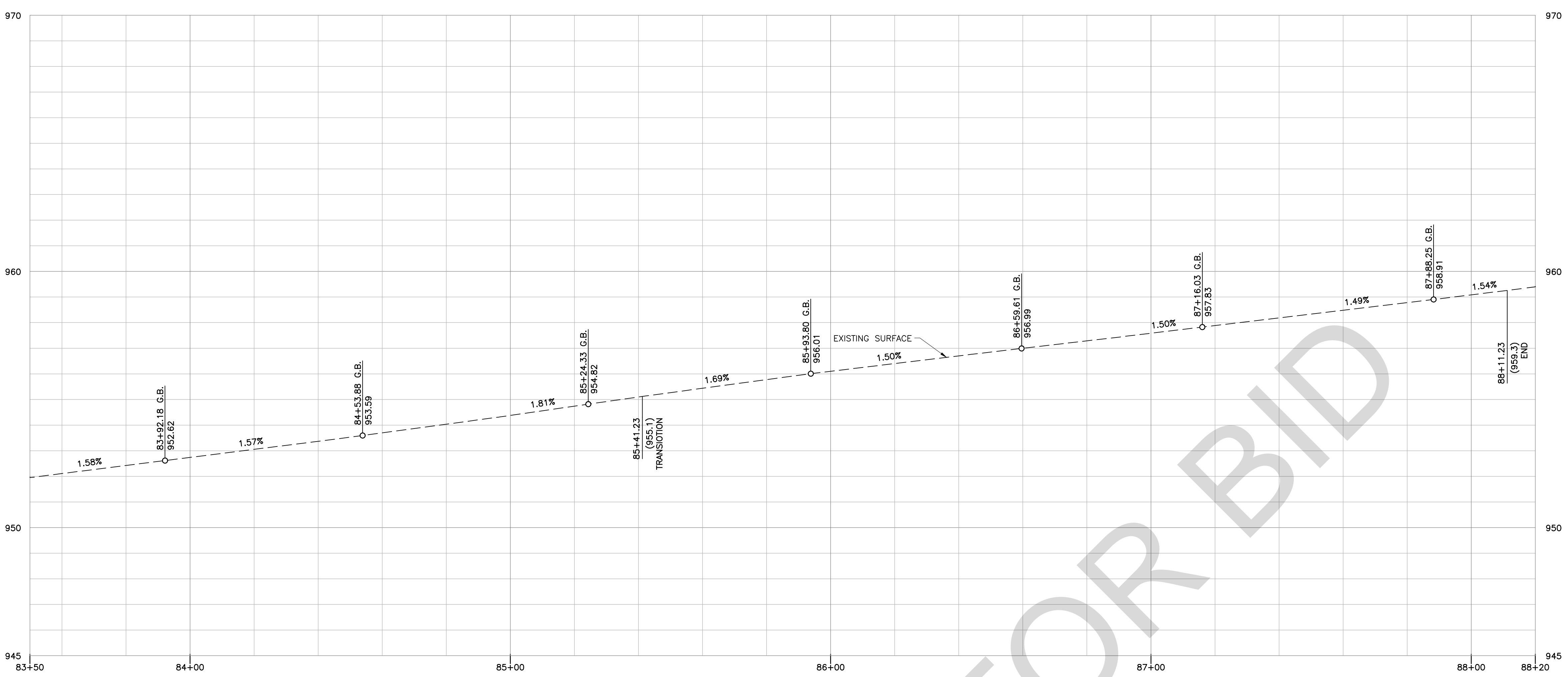

PROFILE VIEW

AT SAW CUT LINE
HOR. SCALE: 1"=20'
VER. SCALE: 1"=2'

STRUCTURAL SECTION DETAIL NOTES	
A	PLACE IS 0.50' OF TYPE A, 3/4" AGGREGATE GRADATION, PG 64-28 PM, HMA
B	PLACE 0.50' CLASS II AGGREGATE BASE at 95% RELATIVE COMPACTION
C	NATIVE SOIL AT 95% RELATIVE COMPACTION

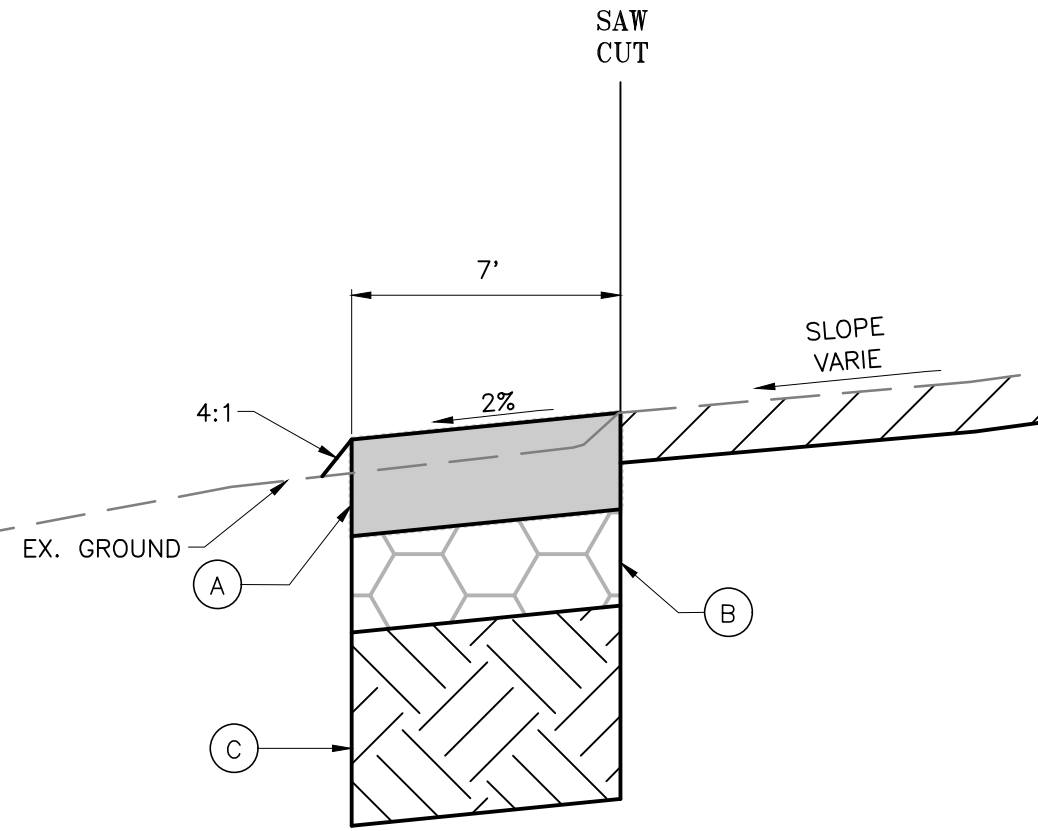

1A STRUCTURAL SECTION DETAIL
STA 83+50.00 TO 88+11.23
(NTS)

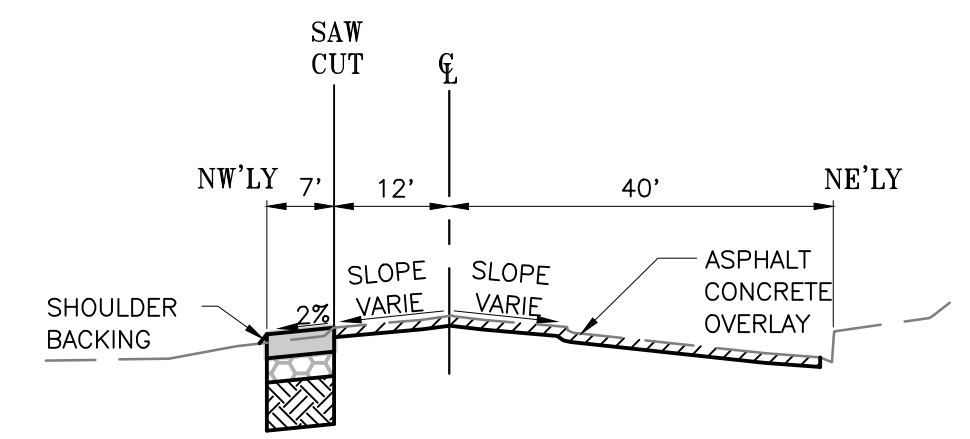

TYPICAL SECTION
STA 83+500 TO 85+41.23
(NTS)

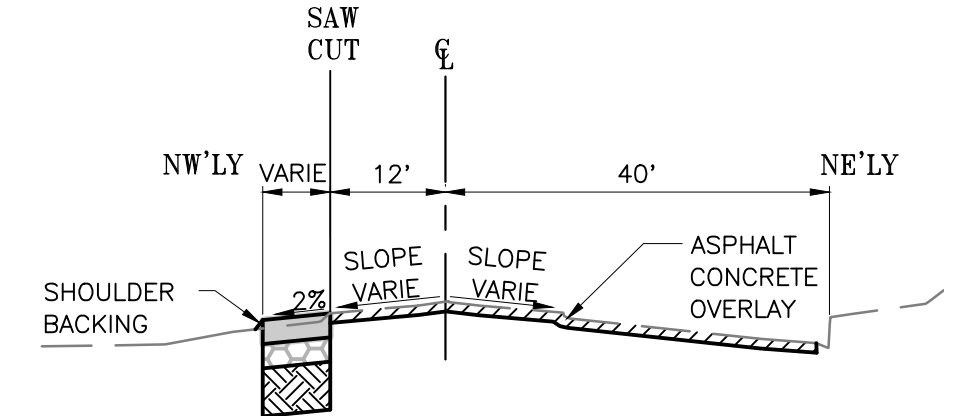

TYPICAL SECTION
STA 85+41.23 TO 86+46.63
(NTS)

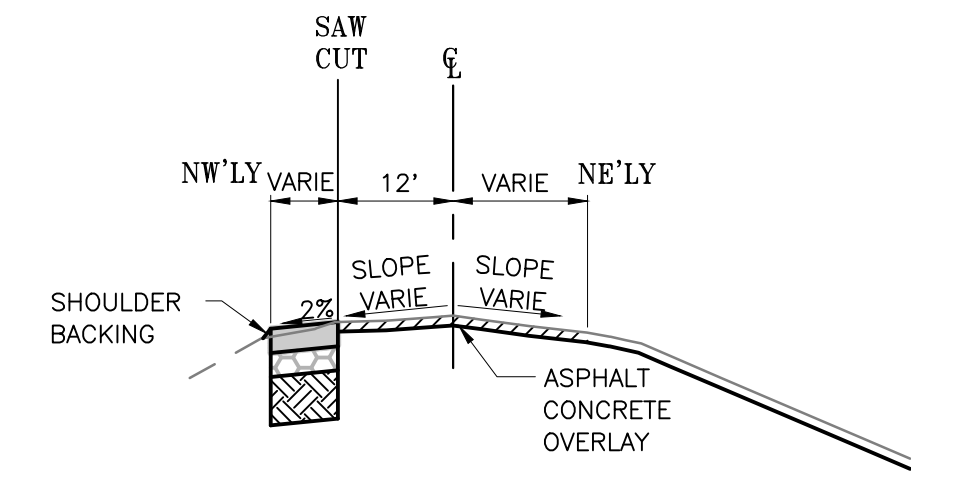

TYPICAL SECTION
STA 86+46.63 TO 88+11.23
(NTS)

CONSTRUCTION NOTES:	
14	REMOVE OR RELOCATED CONCRETE BLOCK OUTSIDE OF THE ROAD R/W BY OTHER
15	SAWCUT AND REMOVE EXISTING ASPHALT CONCRETE SURFACING
16	PLACE STRUCTURAL SECTION PER TYPICAL SECTION AND DETAILS 1A

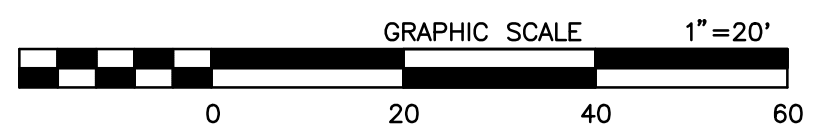
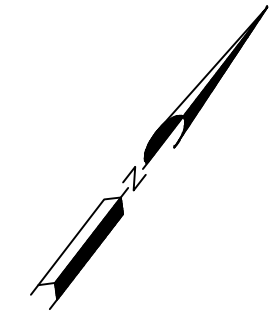
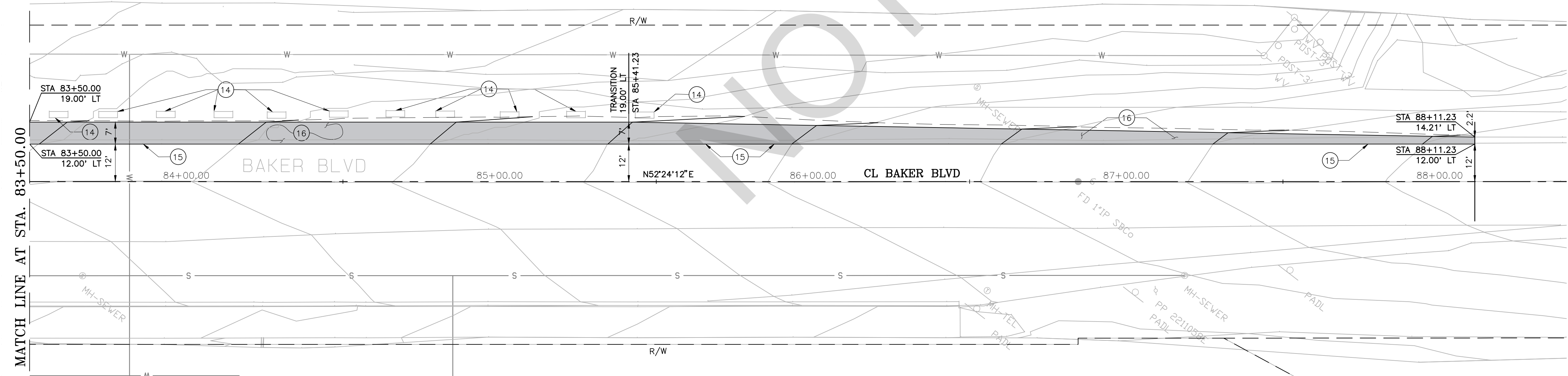

FIELD CHANGES		
MARK	CHANGES	DATE
	NO CHANGES	RESIDENT ENGINEER

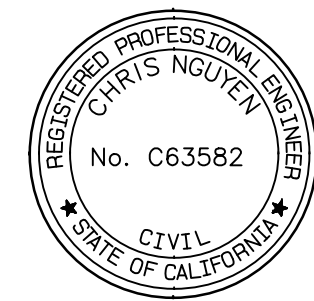

SAN BERNARDINO COUNTY DEPARTMENT OF PUBLIC WORKS			
DESIGNED BY: HV	DRAWN BY: HV	CHECKED BY: NM	RECOMMENDED BY: CHRIS NGUYEN, P.E. ENGINEERING MANAGER
APPROVED BY: NOEL MONDRAGON, P.E. DESIGN ENGINEER		DATE	

BAKER BLVD & OTHERS PLAN AND PROFILE BAKER AREA STA 83+50 TO 88+11.23				
J.L. REF.	W.D. NO.	PLAN SCALE	SHT. NO.	TOT. SHT'S.
JL12042	TX1814	1"=20'	6	8

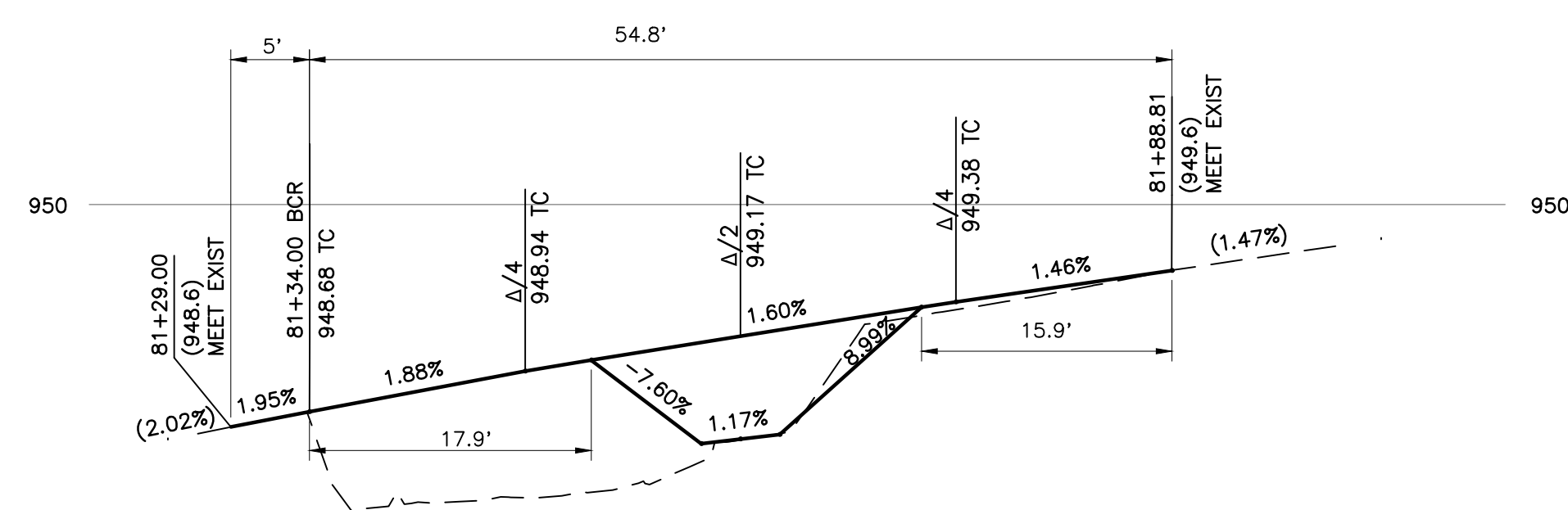

PROFILE VIEW

RAMP 1
HOR. SCALE: 1"=10'
VER. SCALE: 1"=1'

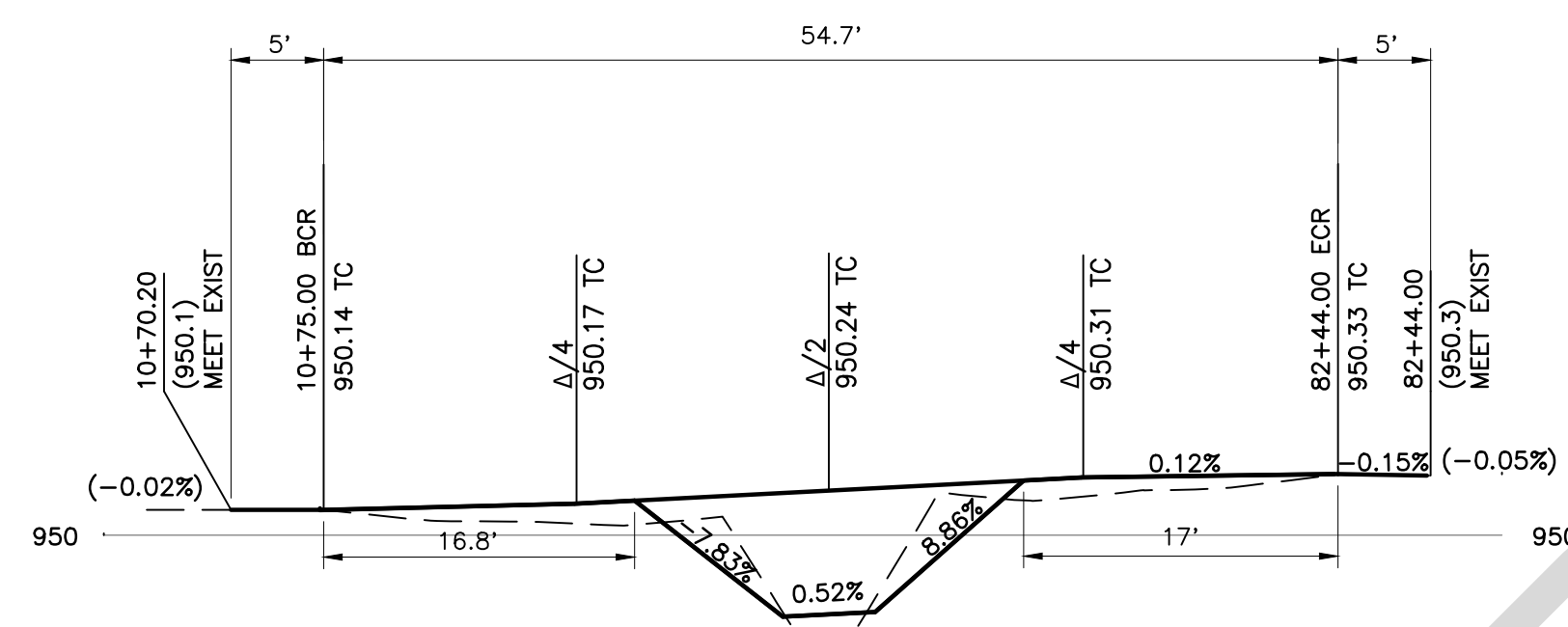

PROFILE VIEW

RAMP 2
HOR. SCALE: 1"=10'
VER. SCALE: 1"=1'

- CONSTRUCTION NOTES:**
- 1 PROTECT IN PLACE
 - 2 PLACE TREATMENT PER STRUCTURAL SECTION
 - 3 REMOVE EXISTING SIDEWALK, CURB & GUTTER OR ASPHALT CONCRETE DIKE
 - 4 SAWCUT AND REMOVE EXISTING AC SURFACING TO FULL DEPTH
 - 5 PLACE 0.67' THICK AC (TYPE A 3/4" AG) OVER COMPACTED NATIVE SOIL
 - 6 CONSTRUCT ADA RAMP CALTRANS STD AB8A, CASE PER PLAN
 - 7 REMOVE OR RESET ROAD SIGN PER TRAFFIC PLAN
 - 8 PLACE DETECTABLE WARNING SURFACE, SEE SPECIAL PROVISIONS
 - 10 PLACE 8" CURB OR CURB AND GUTTER PER SB COUNTY STD 115 (M)
 - 11 PLACE CROSS GUTTER PER SB COUNTY STD DWG 119
 - 12 COLD PLANE 0.10' AND PLACE 0.10' ASPHALT CONCRETE (TYPE A, 3/4" AG)
 - 13 TRAFFIC SIGNAL POLES PER TRAFFIC SIGNAL PLAN

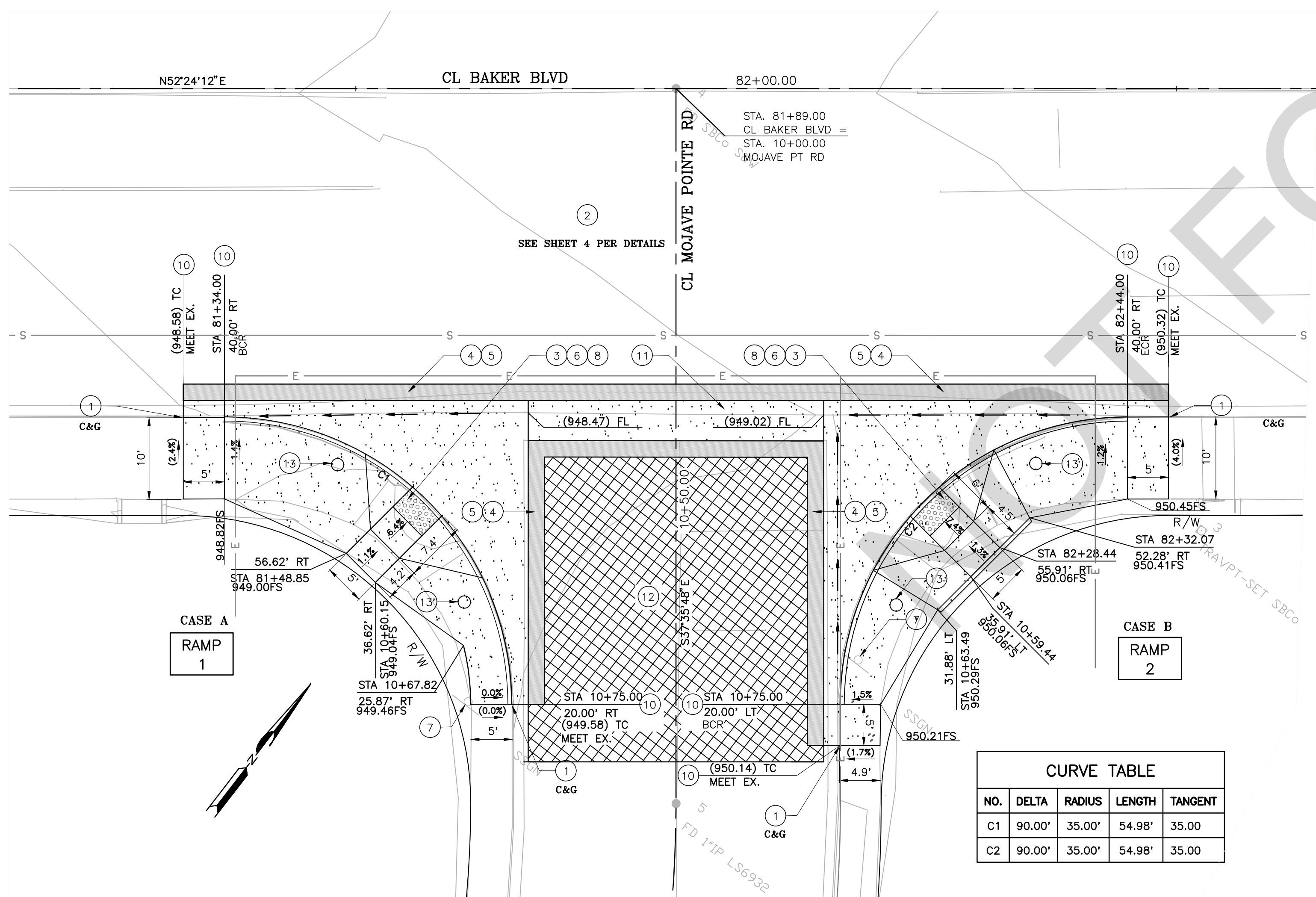

CURVE TABLE

NO.	DELTA	RADIUS	LENGTH	TANGENT
C1	90.00'	35.00'	54.98'	35.00
C2	90.00'	35.00'	54.98'	35.00

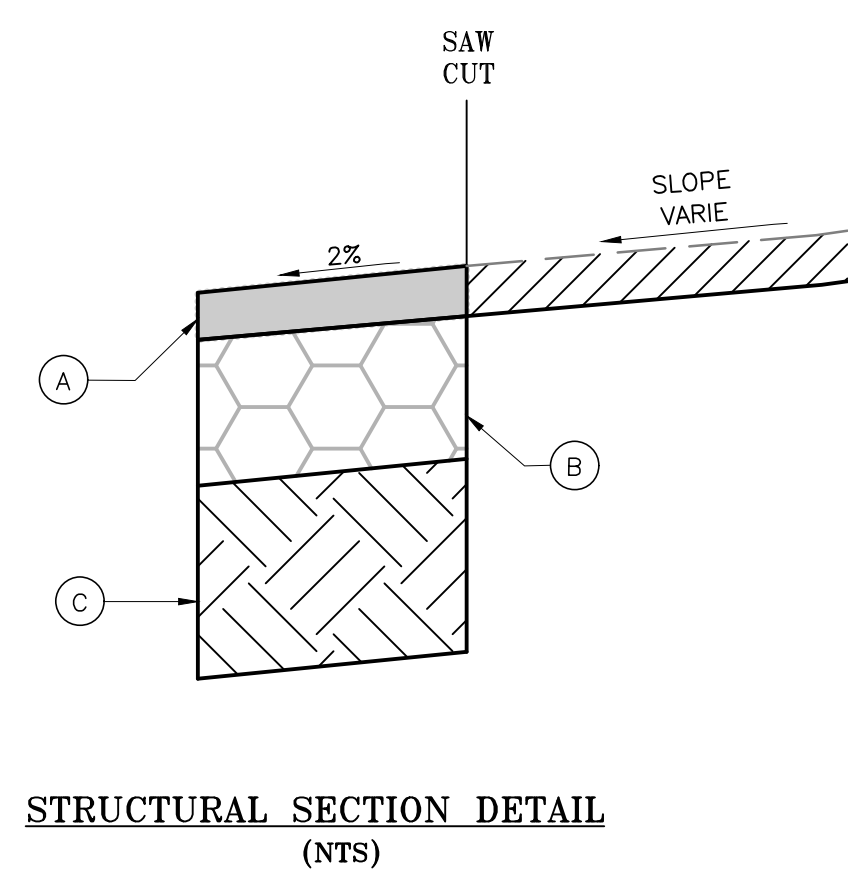
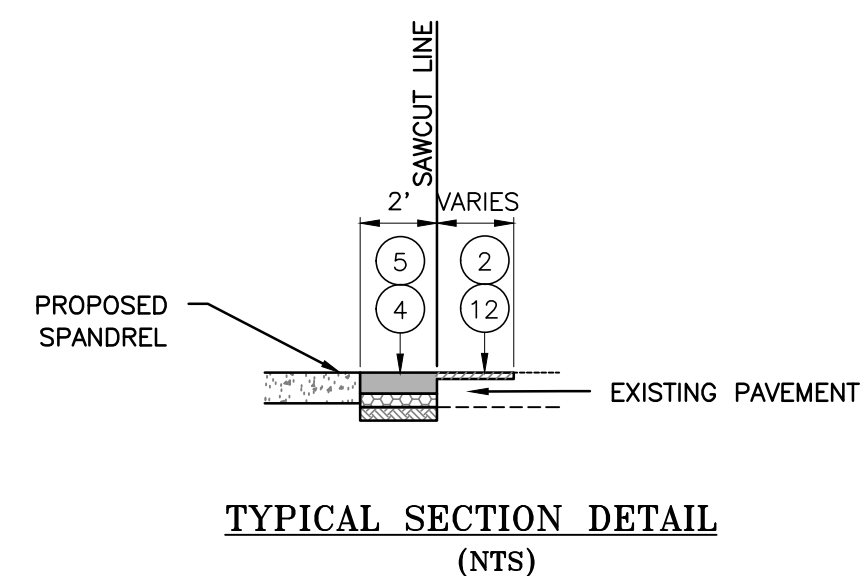

- STRUCTURAL SECTION DETAIL NOTES**
- 1 PLACE IS 0.26' OF TYPE A, 3/4" AGGREGATE GRADATION, PG 64-28 PM, HMA
 - 2 PLACE 0.67' CLASS II AGGREGATE BASE AT 95% RELATIVE COMPACTION
 - 3 NATIVE SOIL AT 95% RELATIVE COMPACTION

NOTES:

- EXPANSION JOINT WITH SLIP DOWELS AT 12" ON CENTER AT SPANDRELS AND SIDEWALKS AT THE TWO RAMP LOCATIONS PER CALTRANS STD P10.
- EXISTING LANDSCAPE ROCK AT ADA RAMPS SHALL BE RELOCATED OR REPLACED DIRECTED BY THE ENGINEER.

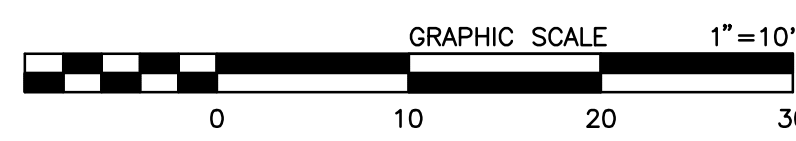

FIELD CHANGES

MARK	CHANGES	RESIDENT ENGINEER	DATE
	NO CHANGES		

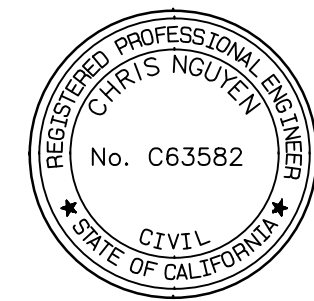

SAN BERNARDINO COUNTY
DEPARTMENT OF PUBLIC WORKS

DESIGNED BY: HV DRAWN BY: HV CHECKED BY: NM RECOMMENDED BY: CHRIS NGUYEN, P.E. ENGINEERING MANAGER

APPROVED BY: MERVAT N. MIKHAIL, P.E. DEPUTY DIRECTOR

BAKER BLVD & OTHERS
PLAN AND PROFILE
BAKER AREA
RAMPS

J.L. REF.	W.O. NO.	PLAN SCALE	SHT. NO.	TOT. SHT'S.
JL12042	TX1814	1"=10'	7	8

CONDUCTOR AND CONDUIT TABLE

Table with columns for POLE, PHASE, and CONDUIT RUN. Rows include Signal Cable (A-F) and AWG Size (#6, #10, #8).

Table with columns for AWG SIZE, CIRCUIT, and CONDUIT RUN. Rows include #6 SERVICE, #10 LUMINAIRE, and #8 SIGNAL COMMON WIRE.

Table with columns for VIDEO DETECTION and LEGEND. Rows include VIDEO CABLE and EMERGENCY VEHICLE DETECTOR.

Table with columns for PREEMPTION CABLE and LEGEND. Rows include EMERGENCY VEHICLE DETECTOR.

Table with columns for CONDUIT SIZE (INCHES) and PERCENT FILLED. Rows include 4, 4, 4, 4, 4, (2)4, (2)4.

CONDUIT SCHEDULE 80 ELECTRICAL GRADE PVC AT A MINIMUM 36INCH DEPTH INCLUDING A 12INCH SAND ZONE COVERING.

ALL CABLES AND CONDUCTORS SHALL BE NEW UNLESS SPECIFIED OTHERWISE.

PEDESTRIAN SIGNAL MOUNTINGS ON POLE A, B, D, E & F FOR FUTURE USE.

CONDUIT SCHEDULE 80 ELECTRICAL GRADE PVC AT A MINIMUM 4INCH DEPTH INCLUDING A 12INCH SAND ZONE COVERING.

POLE AND EQUIPMENT SCHEDULE

Table with columns for POLE NO., STANDARD, POLE LOCATION, VEHICLE SIGNAL MOUNTING, PEDESTRIAN SIGNAL, PEDESTRIAN PUSH BUTTON, L.E.D. LUMINAIRE, and RETRO-REFLECTIVE STREET NAME SIGN.

PUSH BUTTONS ON POLES A, B, C & F SHOWN SHALL BE FOR FUTURE USE, ANY HOLES FOR WIRING SHALL BE PLATED.

INSTALL PEDESTRIAN SIGNAL MOUNTINGS ON POLE A, B, D, E & F FOR FUTURE USE.

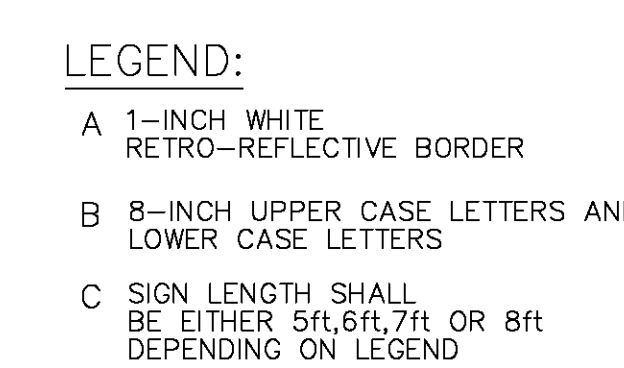
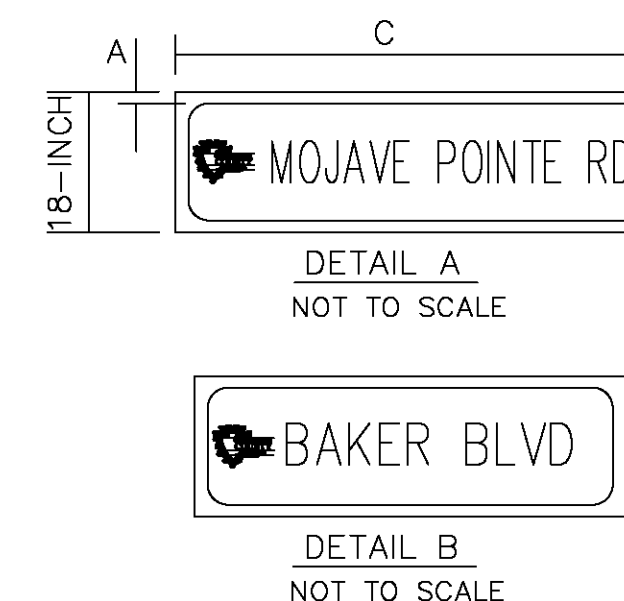
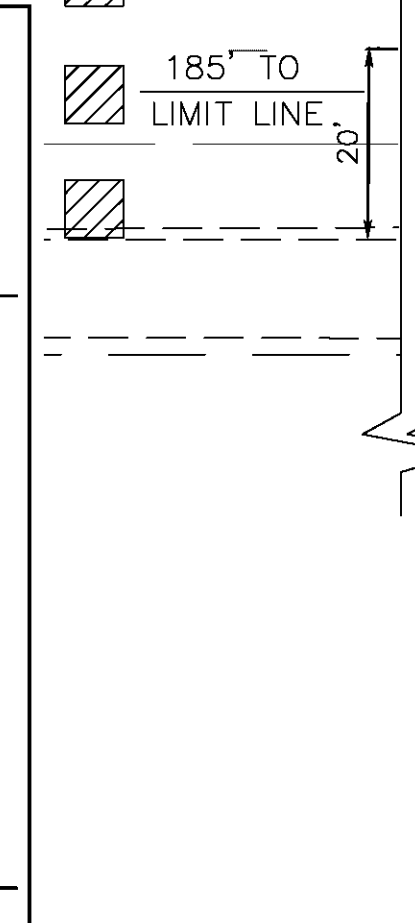
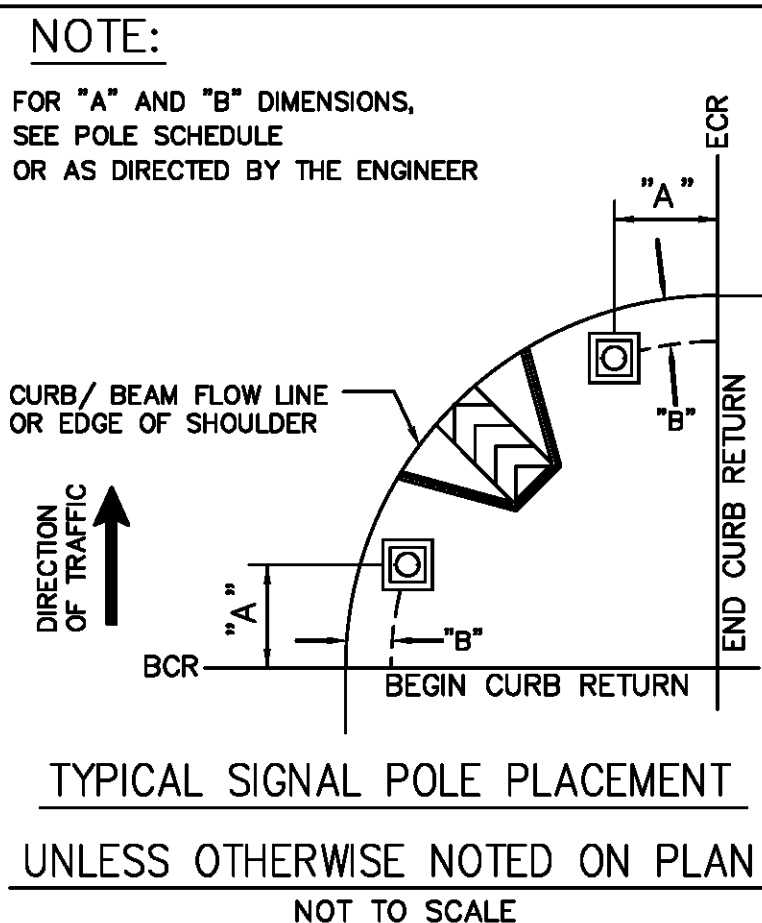
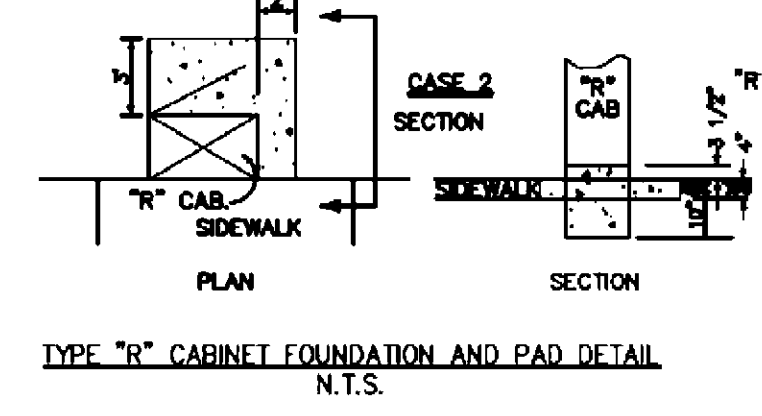
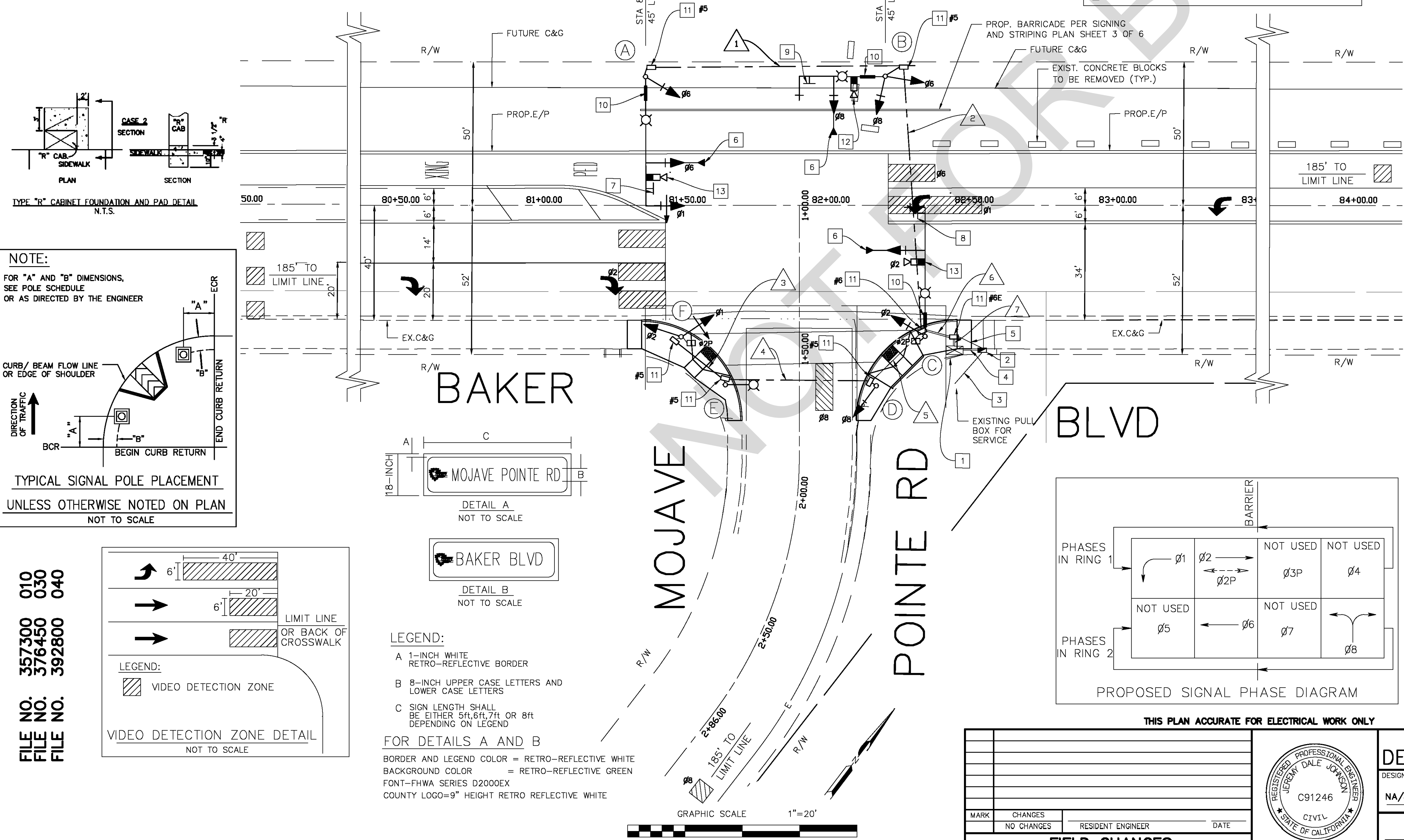
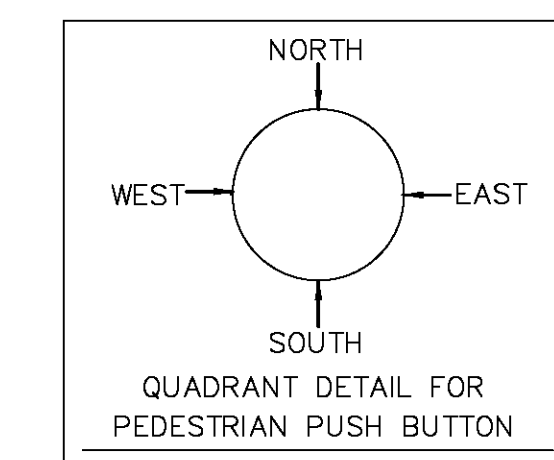
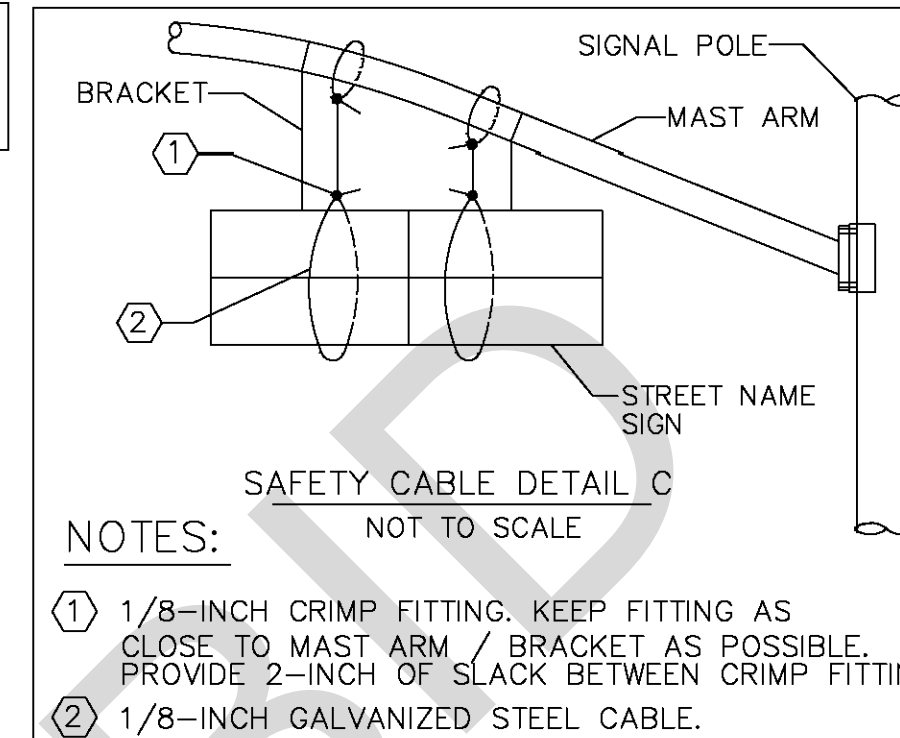

SAN BERNARDINO COUNTY TRAFFIC SIGNAL GENERAL NOTES:

- 1. TRAFFIC SIGNAL AND LIGHTING SHALL CONFORM TO THE STATE OF CALIFORNIA 2018 REVISED STANDARD SPECIFICATIONS (DATED 2018) SECTIONS 86(ELECTRICAL WORK) AND 87(ELECTRICAL SYSTEMS) INCLUDING LATEST 2018 REVISED STANDARD SPECIFICATIONS AND STANDARD PLANS DATED 2018.
- 2. ALL VEHICLE SIGNAL INDICATIONS SHALL BE 12-INCH AND SHALL BE INSTALLED WITH "LED" SIGNAL MODULES.
- 3. ALL PEDESTRIAN SIGNAL INDICATIONS SHALL BE INSTALLED WITH "LED" PEDESTRIAN MODULES. PEDESTRIAN MODULES SHALL BE EQUIPPED WITH COUNTDOWN TIMERS PER THE CALTRANS 2018 STANDARD PLAN RSP ES-4B DETAIL B.
- 4. SIGNAL POLE LOCATIONS ARE APPROXIMATE.
- 5. ALL BACK PLATES SHALL BE LOUVERED.
- 6. ALL BACK PLATES AND VISORS SHALL BE METAL, NO PLASTIC PARTS WILL BE ALLOWED.
- 7. ALL PULL BOXES SHALL BE NUMBER 5 UNLESS OTHERWISE NOTED. THE TOP OF THE PULL BOXES SHALL BE FLUSH WITH FINISHED GRADE AS SHOWN ON THE CALTRANS 2018 STANDARD PLAN RSP ES-8A.
- 8. PULL BOXES SHALL BE INSTALLED PER THE CALTRANS 2018 STANDARD PLAN RSP ES-8A. AND SHALL NOT BE INSTALLED IN OR WITHIN A CURB ACCESS RAMP.
- 9. PULL BOXES LOCATED IN ROADWAYS OR SHOULDER AREAS SUBJECT TO TRAFFIC, SHALL BE TRAFFIC TYPE PER THE CALTRANS 2018 STANDARD PLAN RSP ES-7B.
- 10. COUPLING NUTS SHALL BE USED FOR ALL TYPE (1-A) POLES PER THE CALTRANS 2018 STANDARD PLAN RSP ES-7B.
- 11. PEDESTRIAN PUSH BUTTON SHALL BE WITH PLACARD R10-3 SIZE 9"x12" AND PER THE CALTRANS 2018 STANDARD PLANS RSP ES-7A AND RSP ES-5C (TYPE B).
- 12. ALL SIGNAL AND LIGHTING STANDARD FOUNDATIONS SHALL BE ADJUSTED TO PROPOSED FINISHED GRADE.
- 13. ALL UNUSED TENONS SHALL BE CAPPED.
- 14. ALL WIRING AND CABLES SHALL BE NEW UNLESS OTHERWISE NOTED.
- 15. ALL NEW CONDUIT SHALL BE MINIMUM 4-INCH SCHEDULE 80 ELECTRICAL GRADE PVC AT A MINIMUM 36-INCH DEPTH INCLUDING A 12-INCH SAND ZONE COVERING.
- 16. LOCATION OF ALL UNDERGROUND FACILITIES ARE APPROXIMATE. THE CONTRACTOR SHALL POITHOLE TO DETERMINE THE EXACT LOCATIONS AND VERIFY ALL CONDITIONS ON THE JOB SITE. HAND DIG FOUNDATIONS UNTIL CLEAR OF ANY OBSTRUCTIONS. PHONE THE UNDERGROUND SERVICE ALERT AT (800) 227-2600, TWO WORKING DAYS BEFORE DIGGING.
- 17. THE CONTRACTOR SHALL NOTIFY THE COUNTY REPRESENTATIVE TO SCHEDULE A FIELD REVIEW WITH TRAFFIC DIVISION TO VERIFY THE LOCATION OF SIGNAL POLES, CONTROLLER CABINET, AND SERVICE.

TRAFFIC SIGNAL CONSTRUCTION NOTES:

- 1- INSTALL COUNTY FURNISHED TYPE NEMA TS2-1-R77 ASSEMBLY INCLUDING COBALT CONTROLLER WITH TOUCH SCREEN OPTION, TYPE "R" CABINET WITH 16-CHANNEL MMU, UNINTERRUPTIBLE POWER SUPPLY (UPS), NICKEL-ZINC BATTERIES, 1000 WATT MINIMUM BATTERY STORAGE, GPS RECEIVER FOR TIME REFERENCE AND APPURTENANT EQUIPMENT. THE INTERNAL CABINET WILL INCLUDE SLIDE OUT DRAWER AND LED LIGHTING. INSTALL COUNTY FURNISHED EMERGENCY VEHICLE PRE-EMPTION SYSTEM PER SPECIAL PROVISIONS. THE CONTROLLER CABINET, FOUNDATION AND PAD SHALL BE INSTALLED PER CALTRANS 2018 STANDARD PLAN ES-3B AND TYPE R FOUNDATION AND PAD DETAIL. FURNISH AND INSTALL GROUND ROD (8ft. MINIMUM) INTO EARTH EXCLUDING CONCRETE FOUNDATION. CONTRACTOR SHALL FURNISH AND INSTALL ANY ADDITIONAL ELECTRONIC EQUIPMENT REQUIRED TO PROVIDE THE DESIRED SIGNAL OPERATION AS SHOWN ON THE PLAN. REFER TO SPECIFICATIONS FOR ADDITIONAL EQUIPMENT CRITERIA AND DETAILS.
- 2- FURNISH AND INSTALL 120/240V TYPE III-BF SERVICE EQUIPMENT ENCLOSURE PER CALTRANS 2018 STANDARD PLANS ES-2C AND RSP ES-2E. FURNISH AND INSTALL TIME DELAY PHOTO CELL FOR LUMINAIRES. THE BOTTOM OF SERVICE CABINET SHALL FLUSH ABOVE THE SIDEWALK FINISH GRADE.
- 3- FURNISH AND INSTALL SCHEDULE 80 ELECTRICAL GRADE PVC CONDUIT WITH PULL-ROPE FROM EXISTING UNDERGROUND SEE HAND HOLE TO THE SERVICE PEDESTAL PER SCE APPROVED DRAWINGS. AT LEAST 2 WEEKS ADVANCE NOTICE SHALL BE GIVEN TO THE SOUTHERN CALIFORNIA EDISON COMPANY BY CONTACTING THE CUSTOMER SERVICE PLANNER, HANNIBAL SHERMAN AT (760)668-6700. EXACT LOCATIONS SHALL BE DETERMINED BY SCE IN THE FIELD.
- 4- FURNISH AND INSTALL 4INCH SCHEDULE 80 ELECTRICAL GRADE PVC CONDUIT WITH 2#6 CONDUCTORS FOR THE SIGNAL SERVICE AND 1#8 BARE FOR GROUND.
- 5- FURNISH AND INSTALL 4INCH SCHEDULE 80 ELECTRICAL GRADE PVC CONDUIT WITH 2#10 CONDUCTORS FOR THE LUMINAIRES.
- 6- INSTALL COUNTY FURNISHED EMERGENCY VEHICLE PREEMPTION DETECTOR WITH INFRARED DETECTION AT MINIMUM. THE DETECTOR SHALL BE INSTALLED PER THE MANUFACTURER'S SPECIFICATIONS AND CALTRANS 2018 STANDARD PLAN ES-4E.
- 7- FURNISH AND INSTALL R73-3(CA) (36INCHx36INCH) SIGN ON SIGNAL MAST ARM PER CALTRANS 2018 STANDARD PLAN RSP ES-7N, DETAIL U.
- 8- FURNISH AND INSTALL R3-18 (36INCHx36INCH) SIGN ON SIGNAL MAST ARM PER CALTRANS 2018 STANDARD PLAN RSP ES-7N, DETAIL U.
- 9- FURNISH AND INSTALL R61-19(CA) (36INCH x 36INCH) SIGN ON SIGNAL MAST ARM PER CALTRANS 2018 STANDARD PLAN RSP ES-7N, DETAIL U.
- 10- FURNISH AND INSTALL DOUBLE SIDED RETRO-REFLECTIVE STREET NAME SIGN PER DETAILS A OR B SHOWN ON PLAN. THE SIGN PANEL SHALL BE ALUMINUM BASE METAL SURFACED WITH RETRO-REFLECTIVE SHEETING DIAMOND GRADE (VP). THE STREET NAME SIGN SHALL BE INSTALLED ON THE SIGNAL MAST ARM PER CALTRANS 2018 STANDARD PLAN ES-7P WITH A SAFETY CABLE PER DETAIL C AS SHOWN ON PLAN. SEE PROJECT SPECIAL PROVISIONS.
- 11- FURNISH AND INSTALL NEW PULL BOX AS SHOWN ON PLAN AND PER THE CALTRANS 2018 STANDARD PLAN RSP ES-8A.
- 12- INSTALL COUNTY FURNISHED AUTOSCOPE VISION VIDEO VEHICLE DETECTION SYSTEM OR AS APPROVED BY THE TRAFFIC DIVISION. THE CAMERA SHALL BE INSTALLED ON THE LUMINAIRE MAST ARM AS SHOWN ON PLAN AND THE CALTRANS 2018 STANDARD PLAN ES-7R PER THE MANUFACTURER'S SPECIFICATIONS. SEE PROJECT SPECIAL PROVISIONS. THE VIDEO DETECTION DATA PROCESSING SHALL BE WITHIN THE CAMERA TO MAXIMIZE CABINET SPACE.
- 13- INSTALL COUNTY FURNISHED AUTOSCOPE VISION VIDEO VEHICLE DETECTION SYSTEM OR AS APPROVED BY THE TRAFFIC DIVISION. THE CAMERA SHALL BE INSTALLED ON THE SIGNAL MAST ARM AS SHOWN ON PLAN AND THE CALTRANS 2018 STANDARD PLAN ES-7R ON 72-INCH PELCO OR SIMILAR RISER PER THE MANUFACTURER'S SPECIFICATIONS. SEE PROJECT SPECIAL PROVISIONS. THE VIDEO DETECTION DATA PROCESSING SHALL BE WITHIN THE CAMERA TO MAXIMIZE CABINET SPACE.

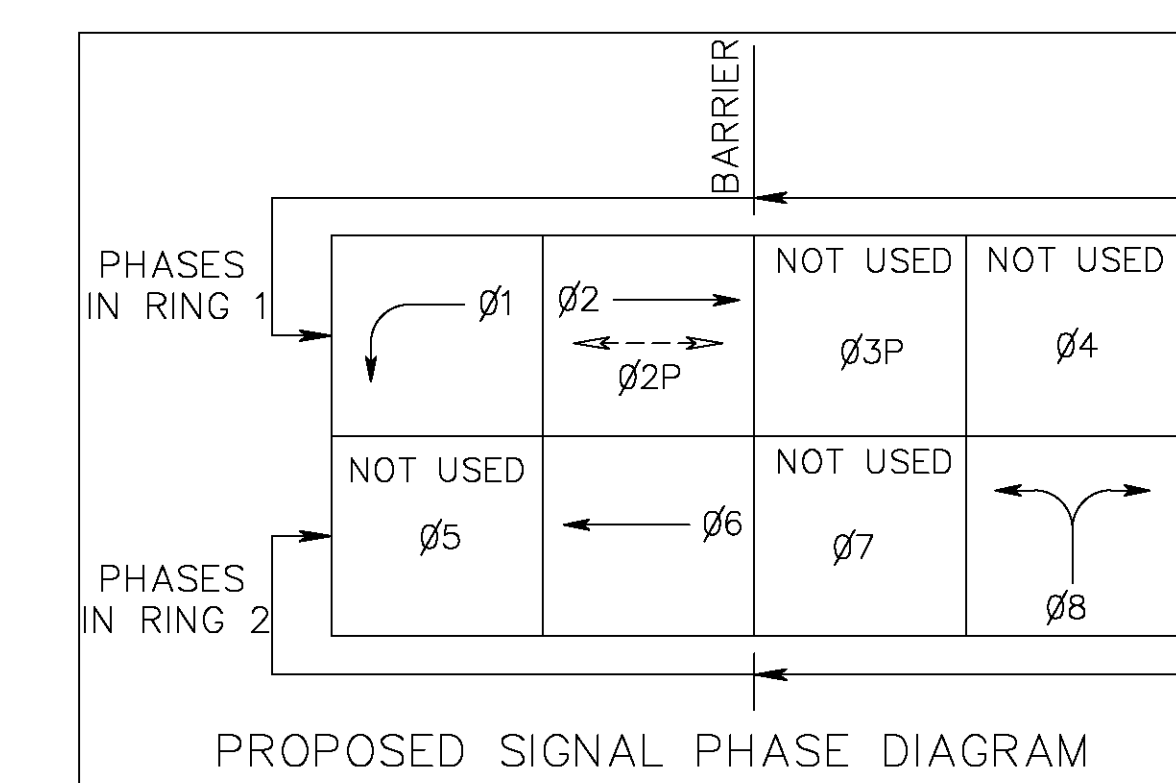

SERVICE ADDRESS: 72463 BAKER BLVD, TEMP BAKER, CA92309

010 FILE NO. 357300
030 FILE NO. 376450
040 FILE NO. 392800

APPR. DATE
REVISIONS
MARK

Professional Engineer Seal for C91246, CIVIL, STATE OF CALIFORNIA. SAN BERNARDINO COUNTY DEPARTMENT OF PUBLIC WORKS. BAKER BLVD & MOJAVE POINTE RD TRAFFIC SIGNAL & LIGHTING PLAN BAKER AREA. Includes design, check, and approval fields.