

THE INFORMATION IN THIS BOX IS NOT A PART OF THE CONTRACT AND IS FOR COUNTY USE ONLY



Contract Number

10-53 A-5

SAP Number

San Bernardino County Flood Control District

Department Contract Representative	Melissa Walker
Telephone Number	(909) 387-7995
Contractor	City of Rancho Cucamonga
Contractor Representative	Gianfranco Laurie
Telephone Number	(909) 774-7037
Contract Term	January 26, 2010 – January 30, 2030
Original Contract Amount	Non-Financial CUA
Amendment Amount	Non-Financial CUA
Total Contract Amount	Non-Financial CUA
Cost Center	Non-Financial CUA

IT IS HEREBY AGREED AS FOLLOWS:

City of Rancho Cucamonga CONTRACT NUMBER 10-53
--

CITY OF RANCHO CUCAMONGA

MULTI-USE TRAIL - COMMON USE AGREEMENT - AMENDMENT NO. 5

WHEREAS, on January 11, 1993, the San Bernardino County Flood Control District (**DISTRICT**) and the City of Rancho Cucamonga (**CITY**) executed a Memorandum of Understanding (**MOU**), Contract No. 93-20, under which the parties agreed to cooperate in the development of a multi-use trail system within portions of **DISTRICT** right-of-way in the **CITY**, and

WHEREAS, the **MOU** stipulates that "individual portions of the approved conceptual plan shall be accomplished under a separate agreement," and

WHEREAS, **DISTRICT** and **CITY** on January 26, 2010, executed a Common Use Agreement (**AGREEMENT**), Contract No. 10-53, for a recreational multi-use community trail along portions of Day Creek and Deer Creek Channels, and

WHEREAS, DISTRICT and CITY subsequently entered into the following amendments to the **AGREEMENT**:

- Amendment No. 1 to the **AGREEMENT**, on June 28, 2011, to add a segment of a recreational multi-use community trail system along **DISTRICT's** Cucamonga Channel, from the previous alignment of the Southern Pacific Railroad to Red Hill Country Club Drive (**Area of Common Use No. 2**), and
- Amendment No. 2 to the **AGREEMENT**, on May 21, 2013, to add a segment of a recreational multi-use community trail system along **DISTRICT's** Cucamonga Channel, From Foothill Blvd. to Baseline Road (**Area of Common Use No. 3**), and
- Amendment No. 3 to the **AGREEMENT**, on November 04, 2014, to add a segment of a recreational multi-use community trail system along **DISTRICT's** Deer Creek Channel, from Church Street to Baseline Road (**Area of Common Use No. 4**), and
- Amendment No. 4 to the **AGREEMENT**, on December 10, 2019, to add segments of a recreational multi-use community trail system along **DISTRICT's** Deer Creek Channel, from Church Street to 4th street (**Area of Common Use No. 5**), and a segment along **DISTRICT's** Cucamonga Creek Channel, from Foothill boulevard to 4th street (**Area of Common Use No. 6**), and

WHEREAS, DISTRICT is currently processing construction permit No. P-12019078 to the City of Fontana to add a segment of the multi-use trail along **DISTRICT's** East Etiwanda Creek Channel from Baseline Avenue in the City of Fontana's jurisdiction, crossing underneath the I-15 freeway, northerly to Banyan street in **CITY's** jurisdiction, and

WHEREAS, DISTRICT, and CITY desire to amend the existing **AGREEMENT**, to add the additional stretch of multi-use trail.

NOW, THEREFORE, IT IS UNDERSTOOD AND MUTUALLY AGREED AS FOLLOWS:

1. **DISTRICT and CITY** hereby amend the **AGREEMENT** to add a segment of the multi-use trail along **DISTRICT's** East Etiwanda Creek Channel from underneath the I-15 freeway to Banyan Street, "**CITY IMPROVEMENTS NO. 7**", the location of which is shown as **AREA OF COMMON USE NO. 7** on the attached map marked as "**Exhibit L**" and which improvements are also shown on attached plans, marked "**Exhibit M**". The **AGREEMENT** is hereby amended to attach **Exhibit L** and **Exhibit M** as if originally set forth therein.
2. **DISTRICT and CITY** agree that all terms and conditions of the **AGREEMENT** shall also apply to **CITY IMPROVEMENTS NO. 7** located in **AREA OF COMMON USE NO. 7**.
3. The definitions of **CITY IMPROVEMENTS** and **AREA OF COMMON USE** set forth in the **AGREEMENT** are hereby amended to include **CITY IMPROVEMENTS NO. 7** and **AREA OF COMMON USE NO. 7**, defined herein.
4. The Parties agree that this Amendment No. 5 may be executed in counterparts, each of which shall be deemed to be an original, but both of which together shall constitute one and the same instrument, and that a photocopy or facsimile may serve as an original. If this Amendment No. 5 is executed in counterparts, no signatory hereto shall be bound until both the parties have fully executed a counterpart of this Amendment No. 5. The Parties shall be entitled to sign and transmit an electronic signature of this Amendment No. 5 (whether by facsimile, PDF, or other email transmission), which signature shall be binding on the party whose name is contained therein. Each Party providing an electronic signature agrees to promptly execute and deliver to the other party an original signed Amendment No. 5 upon request.

5. Unless amended as set forth herein, all terms and conditions of the **AGREEMENT**, as previously amended, shall remain unchanged and in full force and effect.
6. This Amendment No. 5 shall take effect on the date it is signed by both parties.

IN WITNESS WHEREOF, this Amendment No. 5 has been fully executed on behalf of DISTRICT and CITY by their duly authorized representatives.

**SAN BERNARDINO COUNTY
FLOOD CONTROL DISTRICT**

By 
Curt Hagman, Board Chairman

Dated: APR 06 2021

SIGNED AND CERTIFIED THAT A COPY OF THIS DOCUMENT HAS BEEN DELIVERED TO THE CHAIRMAN OF THE BOARD

Lynna Monell, Clerk of the Board

By 

Deputy

City of Rancho Cucamonga
(Print or type name of corporation, company, contractor, etc.)

By 
(Authorized signature - sign in blue ink)

Name L. Dennis Michael
(Print or type name of person signing contract)

Title Mayor
(Print or Type)

Dated: 12/16/2020

Address 10500 Civic Center Dr.
Rancho Cucamonga CA 91730

FOR COUNTY USE ONLY

Approved as to Legal Form
By 
Sophie A. Akins, Deputy County Counsel
Date _____

Reviewed for Contract Compliance
By 
Andy Silao, P.E.
Date 3-30-21

Reviewed/Approved by District
By 
Brendon Biggs, Chief Flood Control Engineer
Date 7-30-21

IN WITNESS WHEREOF, this Amendment No. 5 has been fully executed on behalf of DISTRICT and CITY by their duly authorized representatives.

**SAN BERNARDINO COUNTY
FLOOD CONTROL DISTRICT**

By Curt Hagman, Board Chairman

Dated: _____
SIGNED AND CERTIFIED THAT A COPY OF THIS
DOCUMENT HAS BEEN DELIVERED TO THE
CHAIRMAN OF THE BOARD
Lynna Monell, Clerk of the Board

By _____
Deputy

City of Rancho Cucamonga
(Print or type name of corporation, company, contractor, etc.)

By [Signature]
(Authorized signature - sign in blue ink)

Name L. Dennis Michael
(Print or type name of person signing contract)

Title Mayor
(Print or Type)

Dated: 12/16/2020

Address 10500 Civic Center Dr.
Rancho Cucamonga, CA 91730

FOR COUNTY USE ONLY

Approved as to Legal Form
[Signature]
Sophie A. Akins, Deputy County Counsel
Date March 29, 2021

Reviewed for Contract Compliance
[Signature]
Andy Silao, P.E.
Date _____

Reviewed/Approved by District
[Signature]
Brendon Biggs, Chief Flood Control Engineer
Date _____

EXHIBIT L



EXHIBIT M

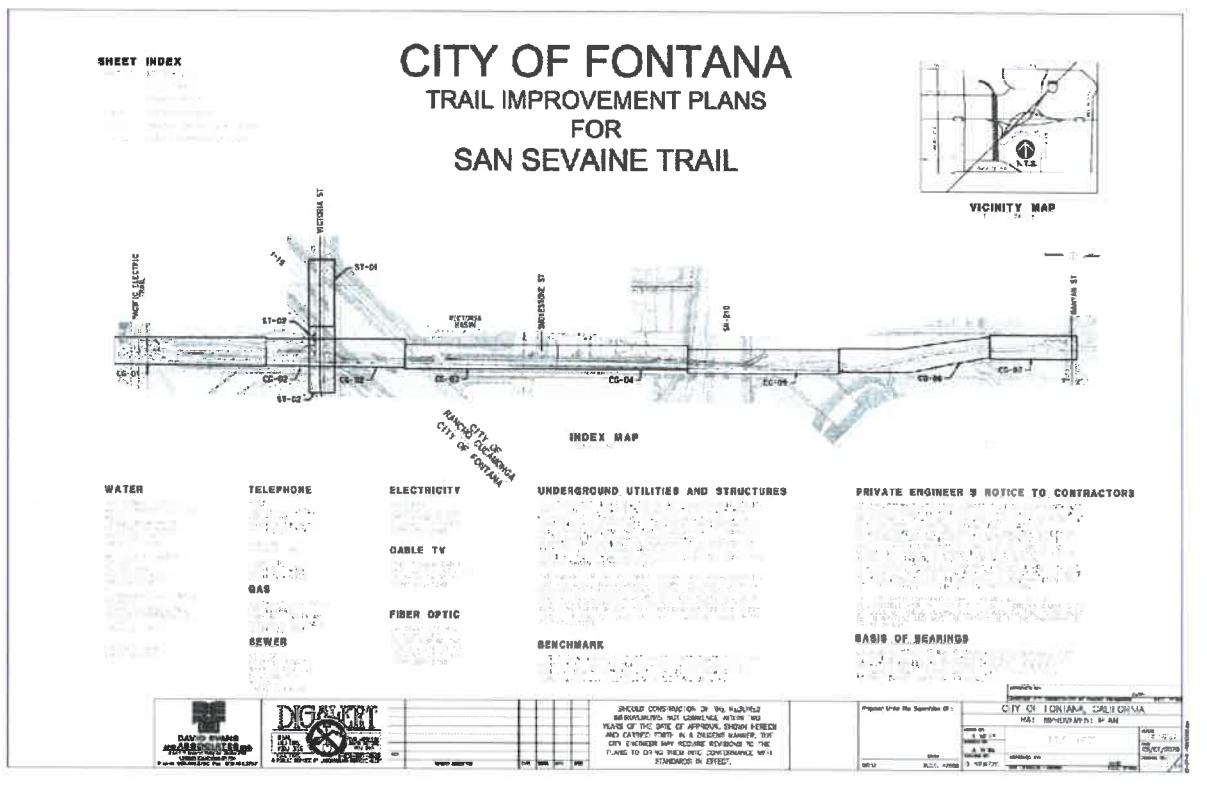
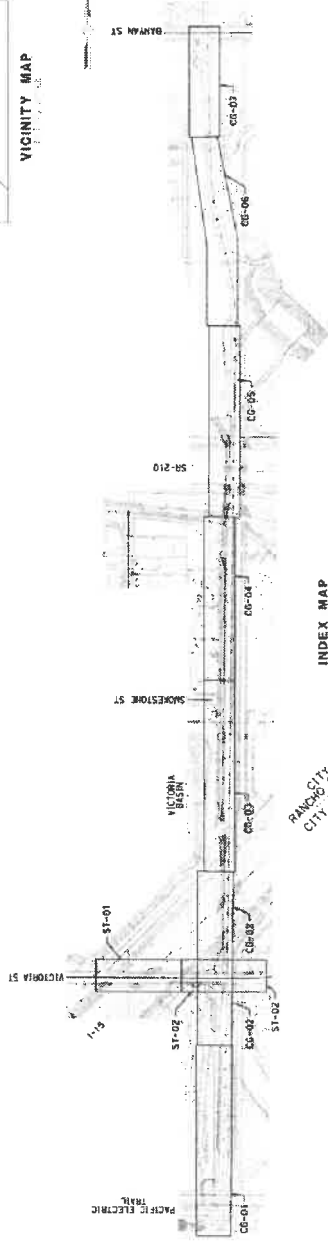
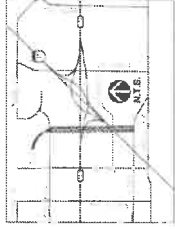

EXHIBIT M

CITY OF FONTANA
 TRAIL IMPROVEMENT PLANS
 FOR
 SAN SEVAINE TRAIL

SHEET INDEX

1. CITY OF FONTANA
 2. SAN SEVAINE TRAIL IMPROVEMENT PLANS
 3. SAN SEVAINE TRAIL IMPROVEMENT PLANS
 4. SAN SEVAINE TRAIL IMPROVEMENT PLANS
 5. SAN SEVAINE TRAIL IMPROVEMENT PLANS



INDEX MAP

WATER
 TELEPHONE
 ELECTRICITY
 CABLE TV
 GAS
 FIBER OPTIC
 SEWER

UNDERGROUND UTILITIES AND STRUCTURES

PRIVATE ENGINEER'S NOTICE TO CONTRACTORS

BASIS OF BEARINGS

BENCHMARK

		DAVID EDWARDS ENGINEER 1000 N. CALIFORNIA STREET FONTANA, CA 92331 PHONE: 951-837-7100 FAX: 951-837-7101	
		PROJECT NO. 15-0000 SHEET NO. 15-0000-01	
PROJECT NAME: TRAIL IMPROVEMENT PLAN CITY OF FONTANA, CALIFORNIA		DATE: 11/15/19 SCALE: AS SHOWN	
SHOULD CONSIDERATION OF THE REQUIRED IMPROVEMENTS NOT COME WITHIN TWO FEET OF ANY EXISTING STRUCTURE OR UNDERGROUND UTILITY. THE CITY ENGINEER MAY REQUIRE REVISIONS TO THE PLANS TO BRING THEM INTO CONFORMANCE WITH STANDARDS AS APPLICABLE.			

GENERAL NOTES

CITY OF FONTANA AND RANCHO CUCAMONGA

REMOVAL NOTES

- 1) REMOVE AS INDICATED
- 2) REMOVE EXISTING CURB
- 3) REMOVE EXISTING SIDEWALK
- 4) REMOVE EXISTING DRIVE
- 5) REMOVE EXISTING DRIVE
- 6) REMOVE EXISTING DRIVE
- 7) REMOVE EXISTING DRIVE
- 8) REMOVE EXISTING DRIVE
- 9) REMOVE EXISTING DRIVE
- 10) REMOVE EXISTING DRIVE
- 11) REMOVE EXISTING DRIVE
- 12) REMOVE EXISTING DRIVE
- 13) REMOVE EXISTING DRIVE
- 14) REMOVE EXISTING DRIVE
- 15) REMOVE EXISTING DRIVE
- 16) REMOVE EXISTING DRIVE
- 17) REMOVE EXISTING DRIVE
- 18) REMOVE EXISTING DRIVE
- 19) REMOVE EXISTING DRIVE
- 20) REMOVE EXISTING DRIVE
- 21) REMOVE EXISTING DRIVE
- 22) REMOVE EXISTING DRIVE
- 23) REMOVE EXISTING DRIVE
- 24) REMOVE EXISTING DRIVE
- 25) REMOVE EXISTING DRIVE
- 26) REMOVE EXISTING DRIVE
- 27) REMOVE EXISTING DRIVE
- 28) REMOVE EXISTING DRIVE
- 29) REMOVE EXISTING DRIVE
- 30) REMOVE EXISTING DRIVE
- 31) REMOVE EXISTING DRIVE
- 32) REMOVE EXISTING DRIVE
- 33) REMOVE EXISTING DRIVE
- 34) REMOVE EXISTING DRIVE
- 35) REMOVE EXISTING DRIVE
- 36) REMOVE EXISTING DRIVE
- 37) REMOVE EXISTING DRIVE
- 38) REMOVE EXISTING DRIVE
- 39) REMOVE EXISTING DRIVE
- 40) REMOVE EXISTING DRIVE
- 41) REMOVE EXISTING DRIVE
- 42) REMOVE EXISTING DRIVE
- 43) REMOVE EXISTING DRIVE
- 44) REMOVE EXISTING DRIVE
- 45) REMOVE EXISTING DRIVE
- 46) REMOVE EXISTING DRIVE
- 47) REMOVE EXISTING DRIVE
- 48) REMOVE EXISTING DRIVE
- 49) REMOVE EXISTING DRIVE
- 50) REMOVE EXISTING DRIVE
- 51) REMOVE EXISTING DRIVE
- 52) REMOVE EXISTING DRIVE
- 53) REMOVE EXISTING DRIVE
- 54) REMOVE EXISTING DRIVE
- 55) REMOVE EXISTING DRIVE
- 56) REMOVE EXISTING DRIVE
- 57) REMOVE EXISTING DRIVE
- 58) REMOVE EXISTING DRIVE
- 59) REMOVE EXISTING DRIVE
- 60) REMOVE EXISTING DRIVE
- 61) REMOVE EXISTING DRIVE
- 62) REMOVE EXISTING DRIVE
- 63) REMOVE EXISTING DRIVE
- 64) REMOVE EXISTING DRIVE
- 65) REMOVE EXISTING DRIVE
- 66) REMOVE EXISTING DRIVE
- 67) REMOVE EXISTING DRIVE
- 68) REMOVE EXISTING DRIVE
- 69) REMOVE EXISTING DRIVE
- 70) REMOVE EXISTING DRIVE
- 71) REMOVE EXISTING DRIVE
- 72) REMOVE EXISTING DRIVE
- 73) REMOVE EXISTING DRIVE
- 74) REMOVE EXISTING DRIVE
- 75) REMOVE EXISTING DRIVE
- 76) REMOVE EXISTING DRIVE
- 77) REMOVE EXISTING DRIVE
- 78) REMOVE EXISTING DRIVE
- 79) REMOVE EXISTING DRIVE
- 80) REMOVE EXISTING DRIVE
- 81) REMOVE EXISTING DRIVE
- 82) REMOVE EXISTING DRIVE
- 83) REMOVE EXISTING DRIVE
- 84) REMOVE EXISTING DRIVE
- 85) REMOVE EXISTING DRIVE
- 86) REMOVE EXISTING DRIVE
- 87) REMOVE EXISTING DRIVE
- 88) REMOVE EXISTING DRIVE
- 89) REMOVE EXISTING DRIVE
- 90) REMOVE EXISTING DRIVE
- 91) REMOVE EXISTING DRIVE
- 92) REMOVE EXISTING DRIVE
- 93) REMOVE EXISTING DRIVE
- 94) REMOVE EXISTING DRIVE
- 95) REMOVE EXISTING DRIVE
- 96) REMOVE EXISTING DRIVE
- 97) REMOVE EXISTING DRIVE
- 98) REMOVE EXISTING DRIVE
- 99) REMOVE EXISTING DRIVE
- 100) REMOVE EXISTING DRIVE

APPROVED BY: _____

CITY OF FONTANA, CALIFORNIA

TITLE: GENERAL NOTES

DATE: _____

SCALE: _____

PROJECT NO: _____

DATE: _____

BY: _____

FOR: _____

SHOULD CONSIDERATION OF THE REQUIRED CONSTRUCTION OF THE REQUIRED CURB AND SIDEWALKS BE GIVEN YEARS OF THE LIFE OF THE PROJECT AND CARRIED FORTH IN A DETAILED MANNER. THE CITY ENGINEER MAY REQUIRE REVISIONS TO THE PLANS TO BE SUBMITTED IN WRITING.



RANCHO CUCAMONGA
CALIFORNIA
PROFESSIONAL ENGINEER
No. _____
Exp. _____

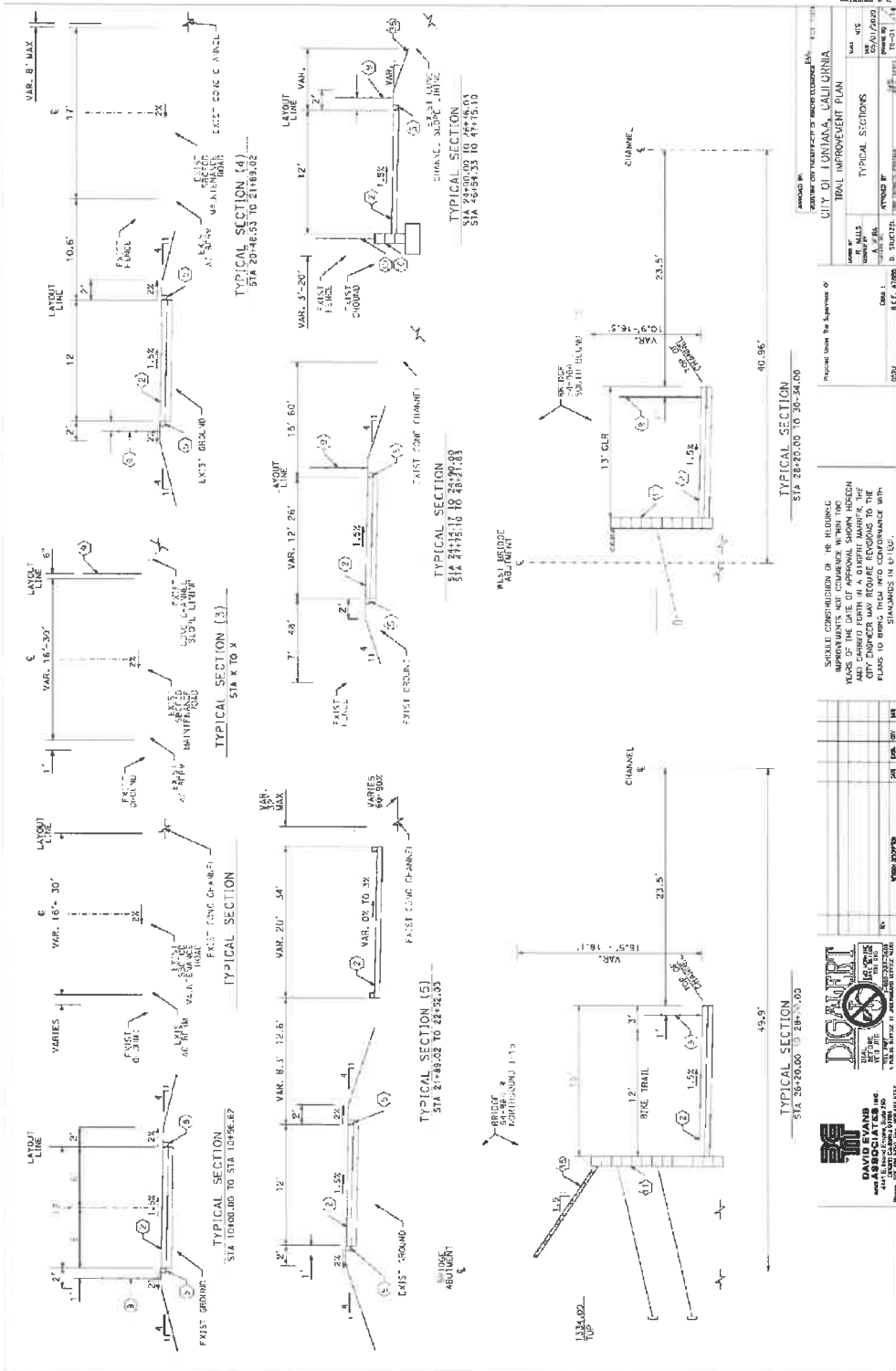

APPROVED BY: [Signature]
 PROJECT: TRAIL IMPROVEMENT PLAN
 CITY OF FONTANA, CALIFORNIA
 DRAWN BY: A. J. [Name]
 CHECKED BY: D. [Name]
 DATE: 8/17/2010

SHOULD BE USED FOR THE FOLLOWING PURPOSES:
 TO BE USED FOR THE DESIGN AND CONSTRUCTION OF THE PROJECT.
 THIS PLAN IS NOT TO BE USED FOR ANY OTHER PURPOSES WITHOUT THE WRITTEN CONSENT OF THE ENGINEER.

STATIONING: STA 10+00.00 TO STA 10+96.67
 STA 14+00.00 TO STA 14+96.67
 STA 18+30.00 TO STA 19+26.67
 STA 24+00.00 TO STA 24+96.67
 STA 28+00.00 TO STA 28+96.67

SCALE: AS SHOWN
 DATE: 8/17/2010
 DRAWN BY: A. J. [Name]
 CHECKED BY: D. [Name]

DISCLAIMER
 THIS PLAN IS NOT TO BE USED FOR ANY OTHER PURPOSES WITHOUT THE WRITTEN CONSENT OF THE ENGINEER.
 THE ENGINEER HAS NOT CONDUCTED A VISUAL INSPECTION OF THE PROJECT SITE.
 THE ENGINEER HAS NOT CONDUCTED A VISUAL INSPECTION OF THE PROJECT SITE.
 THE ENGINEER HAS NOT CONDUCTED A VISUAL INSPECTION OF THE PROJECT SITE.

STATIONING: STA 10+00.00 TO STA 10+96.67
 STA 14+00.00 TO STA 14+96.67
 STA 18+30.00 TO STA 19+26.67
 STA 24+00.00 TO STA 24+96.67
 STA 28+00.00 TO STA 28+96.67

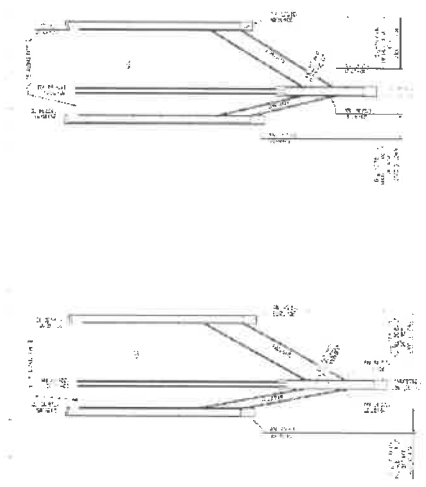
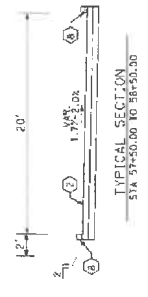
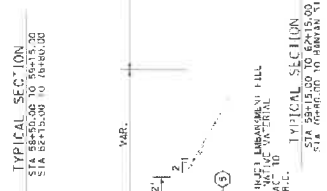
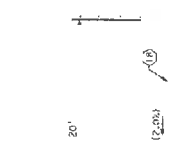
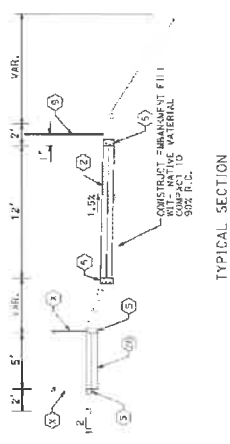

APPROVED BY:	PROJECT NUMBER:	ISSUE NO.:
SUBJECT: IMPROVEMENTS TO STORM DRAINAGE ALONG VICTORIA STREET	CITY OF FONTANA, CALIFORNIA	100
DATE:	PROJECT TITLE:	DATE:
10/15/19	STORM DRAIN IMPROVEMENTS ALONG VICTORIA STREET	10/15/19
DESIGNED BY:	CHECKED BY:	DATE:
AMAR, J.	WANG, S.	10/15/19
DRAWN BY:	SCALE:	DATE:
MORAN, J.	AS SHOWN	10/15/19
FILE NO.:	PROJECT NO.:	DATE:
313-12	50210	10/15/19

STORM DRAIN PROFILES - VICTORIA STREET

CONSTRUCTION OF THE REQUIRED IMPROVEMENTS SHALL BE IN ACCORDANCE WITH THE STANDARD SPECIFICATIONS FOR HIGHWAY CONSTRUCTION, LATEST EDITION, AND THE CALIFORNIA STANDARD SPECIFICATIONS FOR HIGHWAY MATERIALS, LATEST EDITION. THE CONTRACTOR SHALL BE RESPONSIBLE FOR THE PROTECTION OF EXISTING UTILITIES AND FOR THE PROTECTION OF THE PUBLIC. THE CONTRACTOR SHALL BE RESPONSIBLE FOR THE PROTECTION OF THE PUBLIC AND FOR THE PROTECTION OF THE ENVIRONMENT. THE CONTRACTOR SHALL BE RESPONSIBLE FOR THE PROTECTION OF THE PUBLIC AND FOR THE PROTECTION OF THE ENVIRONMENT.

GSI
GEOGRAPHIC SYSTEMS INTERNATIONAL

DIGITAL PLAN
DIGITAL PLAN

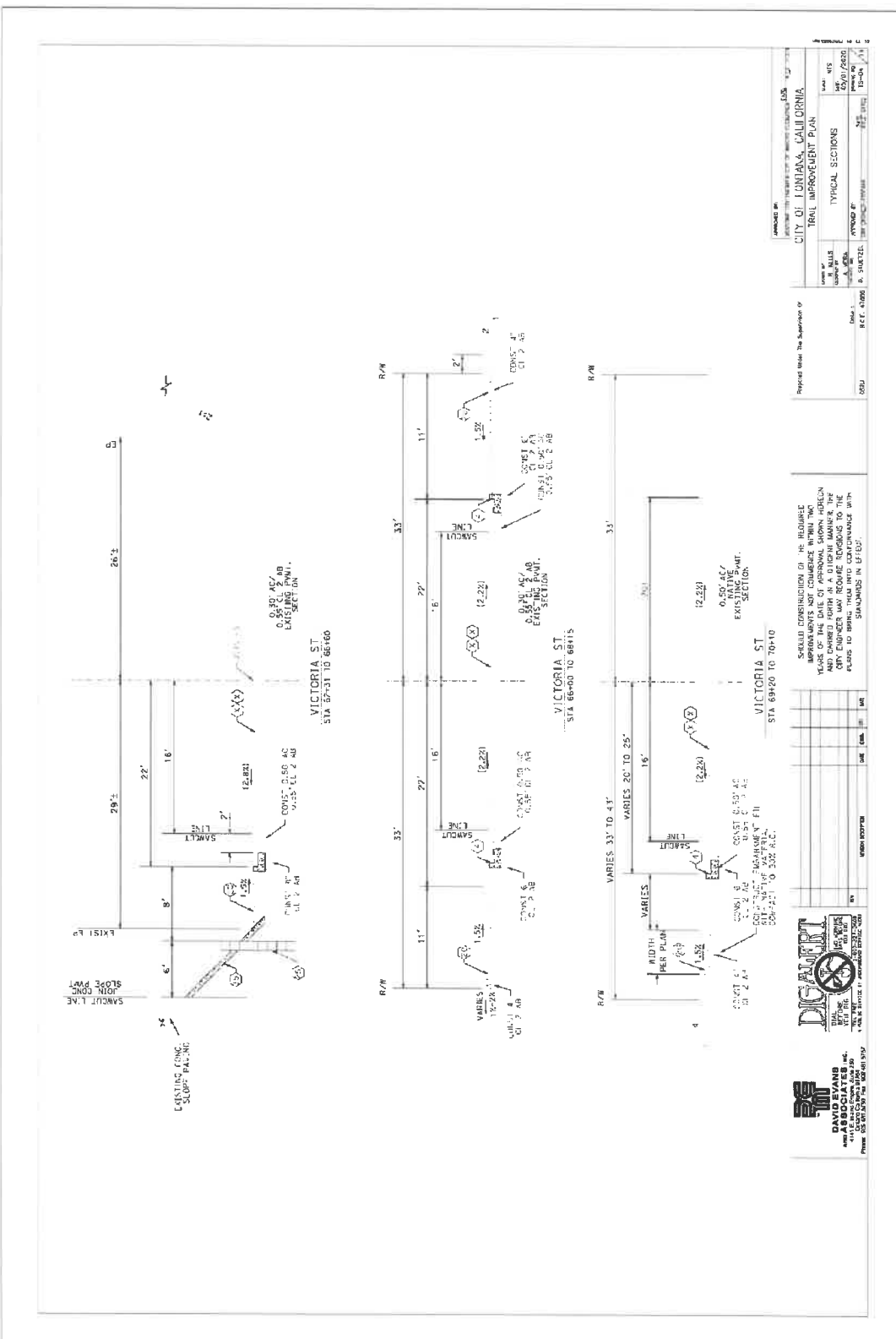

PROJECT NO. 150-0115-01
 CITY OF LUNDA, CALIFORNIA
 TRAIL IMPROVEMENT PLAN
 TYPICAL SECTIONS
 DATE 02/01/2019
 DRAWN BY JLM
 CHECKED BY JLM
 APPROVED BY JLM

Project under the supervision of
 R.C.T. ALBINO
 (R/C) (S) (M) (E) (C)

SHOULD CONTRIBUTION OF THE REQUIRED APPROXIMATIONS NOT COMPARE WITH THE VALUE OF THE CONTRIBUTION OF THE VALUE AND CHARGES FOR A DESIGN MARKER THE CITY ENGINEER MAY REQUIRE REVISIONS TO THE PLANS TO BE CONFORMANT WITH THE STANDARDS IN EFFECT.

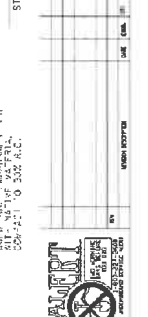
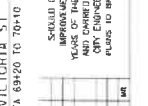

DONALD J. LUCAS
 REGISTERED PROFESSIONAL ENGINEER
 CIVIL ENGINEERING
 STATE OF CALIFORNIA
 LICENSE NO. 20607

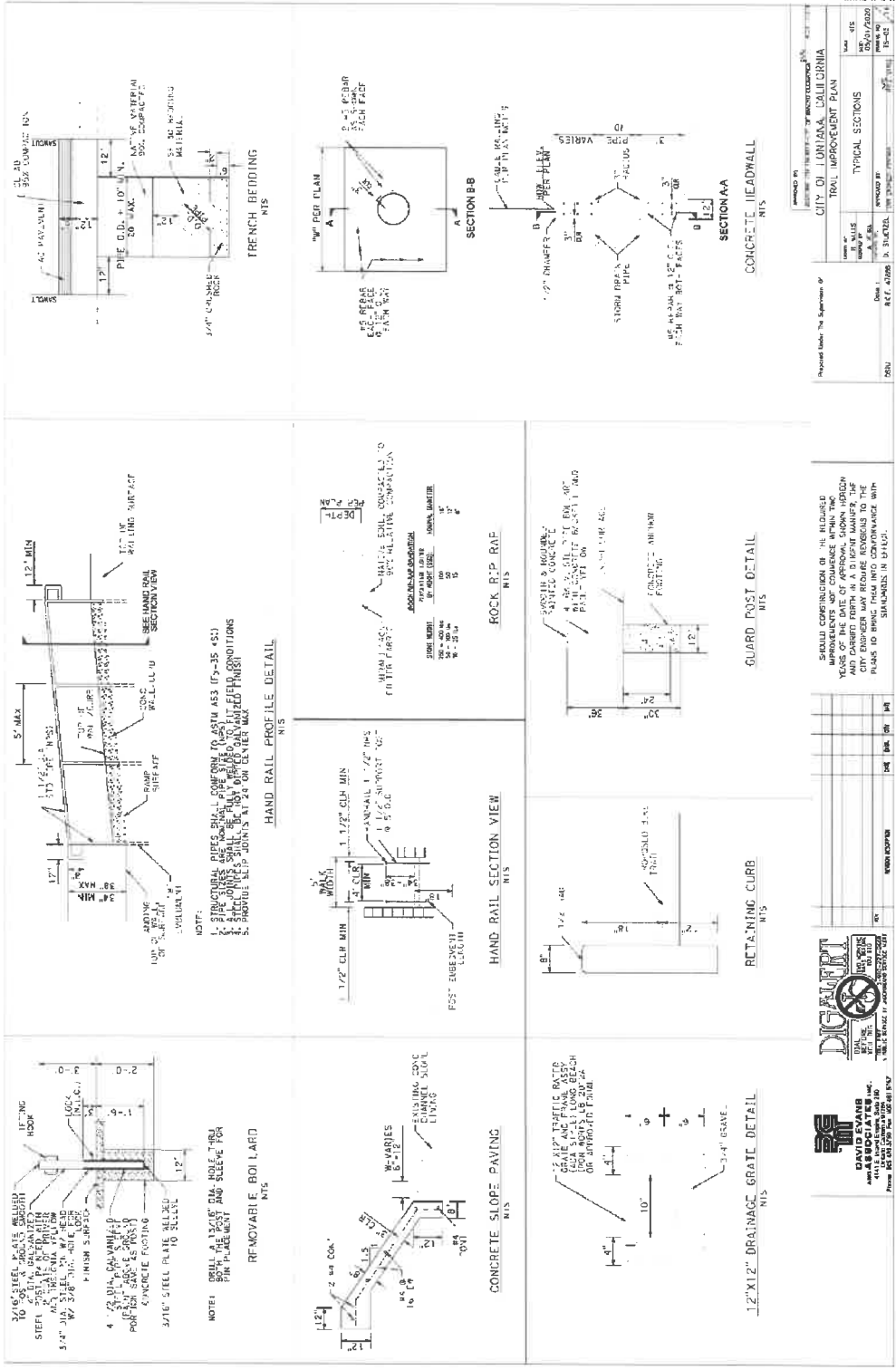

NO.	DATE	BY	CHKD.	APP.	REV.
1	05/01/2020	W. BOI LARD			
2	05/01/2020	W. BOI LARD			
3	05/01/2020	W. BOI LARD			
4	05/01/2020	W. BOI LARD			
5	05/01/2020	W. BOI LARD			

APPROVED BY: [Signature]
 PROJECT TITLE: ROAD IMPROVEMENT PLAN
 CITY OF LUNIANA, LALIBERIA

DATE: 05/01/2020
 DRAWN BY: W. BOI LARD
 CHECKED BY: [Blank]
 APPROVED BY: [Blank]

REVISIONS:
 1. REVISION 1
 2. REVISION 2
 3. REVISION 3
 4. REVISION 4
 5. REVISION 5

REVISIONS:

NO.	DATE	BY	CHKD.	APP.	REV.
1	05/01/2020	W. BOI LARD			

SHALL CONSTRUCTION OF THE ROADWORK BE COMPLETED WITHIN THE PERIOD OF 90 DAYS FROM THE DATE OF COMMENCEMENT OF WORK. ANY DELAY BEYOND THIS PERIOD SHALL BE AT THE RISK OF THE CONTRACTOR. THE CITY ENGINEER MAY REQUIRE REVISIONS TO THE PLAN TO BE SUBMITTED TO THE CITY ENGINEER WITHIN THE PERIOD OF 15 DAYS FROM THE DATE OF ISSUANCE OF THE PLAN.

DIGITAL
 DIGITAL PLOTTING
 4113 N. UNIVERSITY BLVD. SUITE 100
 FARMERSVILLE, LA 71409
 PHONE: (504) 835-8888 FAX: (504) 835-8889

CONSTRUCTION NOTES

- (1) PROTECT IN PLACE
- (2) CONSTRUCT 3.5' AC OVER 1.5'
- (3) CONSTRUCT 4" CONCRETE WEAR SURFACE OVER EXISTING ASPHALT PER CITY OF RANCHO CUCUMONGA STD PLAN 534
- (4) CONSTRUCT AC BEAM PER PLAN 534, WEAR SURFACE PER TYPE 4, MINIMUM 18" RISE PER TYPE 4, MINIMUM 18" RISE PER TYPE 4
- (5) CONSTRUCT 6" HIGH CHAIN LINK FENCE PER CITY OF RANCHO CUCUMONGA DEPARTMENT STD PLAN 800
- (6) CONSTRUCT MASSING RETAINING WALL PER CALTRANS STD PLAN B57A TYPE 6A
- (7) CONSTRUCT CONCRETE TYPED STRUCTURE PER PLAN R-2
- (8) CONSTRUCT 4" METAL BOLLARD PER CITY OF RANCHO CUCUMONGA STD PLAN DETAIL XXX ON SHEET XX
- (9) CONSTRUCT 6" WIDE DOUBLE DRIVE PAVEMENT PER SUBSECTION SPECIAL TUNE NO.
- (10) CONSTRUCT TYPE 1 SILVER SEAL PER CITY OF RANCHO CUCUMONGA STD PLAN 1000
- (11) CONSTRUCT CABLE RAIL FENCE PER CA, TRANS STD PLAN R11-47
- (12) CONSTRUCT 24" RCP 20000 PER CITY OF RANCHO CUCUMONGA STD PLAN DETAIL XXX ON SHEET XX
- (13) CONSTRUCT ROCK RIP RAP 4" OR PROTECTION PER DETAIL XX ON SHEET XX
- (14) CONSTRUCT CONCRETE CURB PER CITY OF RANCHO CUCUMONGA STD PLAN DETAIL XX ON SHEET XX
- (15) CONSTRUCT DRAINAGE CULVERT PER CITY OF RANCHO CUCUMONGA STD PLAN DETAIL XX ON SHEET XX

REMOVAL NOTES

- 1. REMOVE AC BEHN
- 2. REMOVE EXISTING FFNCF

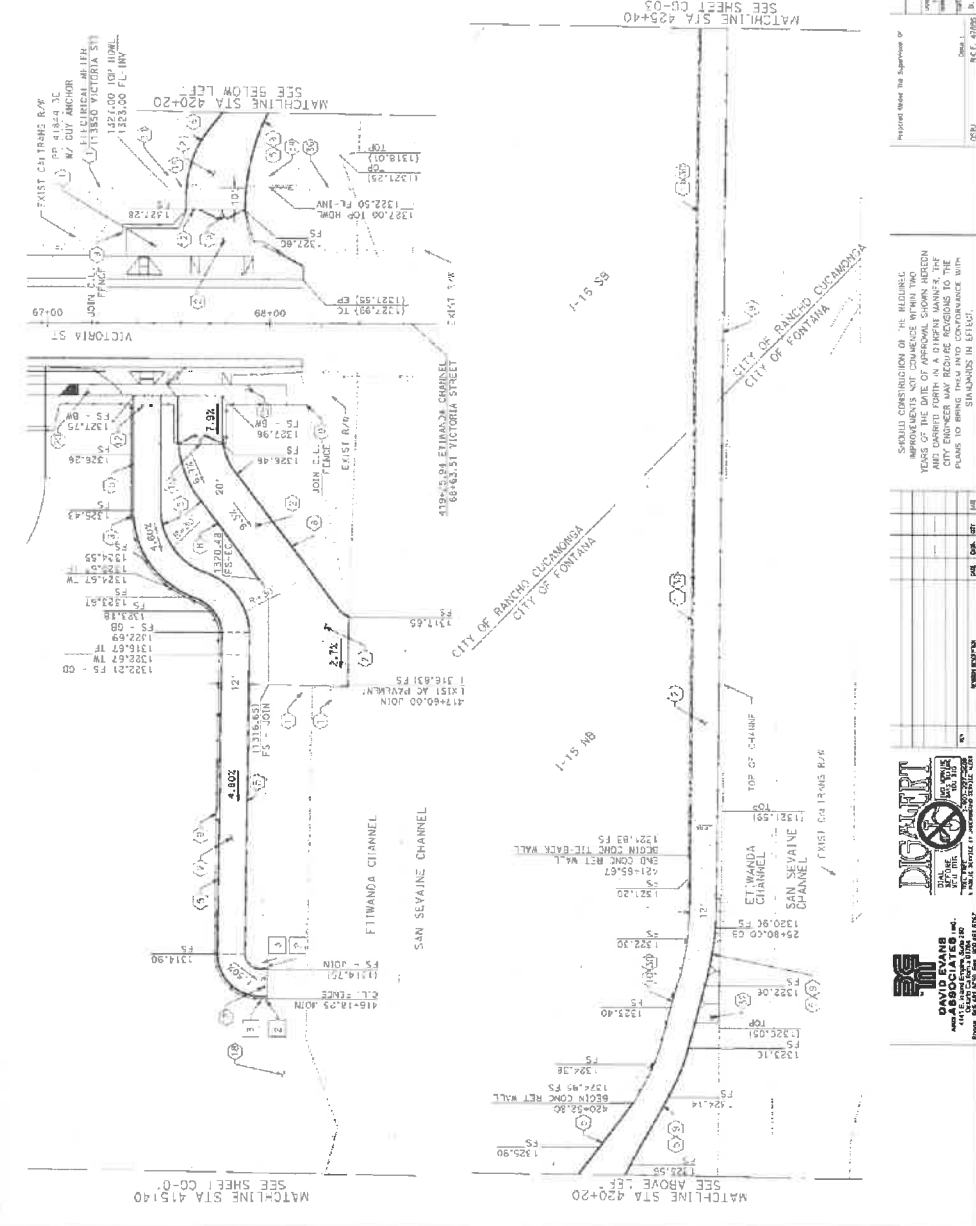

PROJECT NO.	0293
PROJECT NAME	ROAD IMPROVEMENT PLAN
CITY OF	RANCHO CUCUMONGA
DATE	05/20/2009
SCALE	1" = 20'
DATE	05/20/2009
SCALE	1" = 20'

SHALL CONSTRUCTION OF THE BIDDING YEARS OF THE DATE OF AWARD. OWNER AND DARRIED FOR IN A D RIFERS MANE-F, THE CITY ENGINEER MAY REQUIRE REVISIONS TO THE PLANS TO BE MADE IN ACCORDANCE WITH STANDARDS IN EFFECT.

DIGIART

DAVID R. HARRIS
 CIVIL ENGINEER
 1100 S. 11TH ST., SUITE 100
 PLEASANTON, CA 94566
 PH: 925.325.9129
 FAX: 925.325.9127

Printed on 05/20/09 11:28 AM

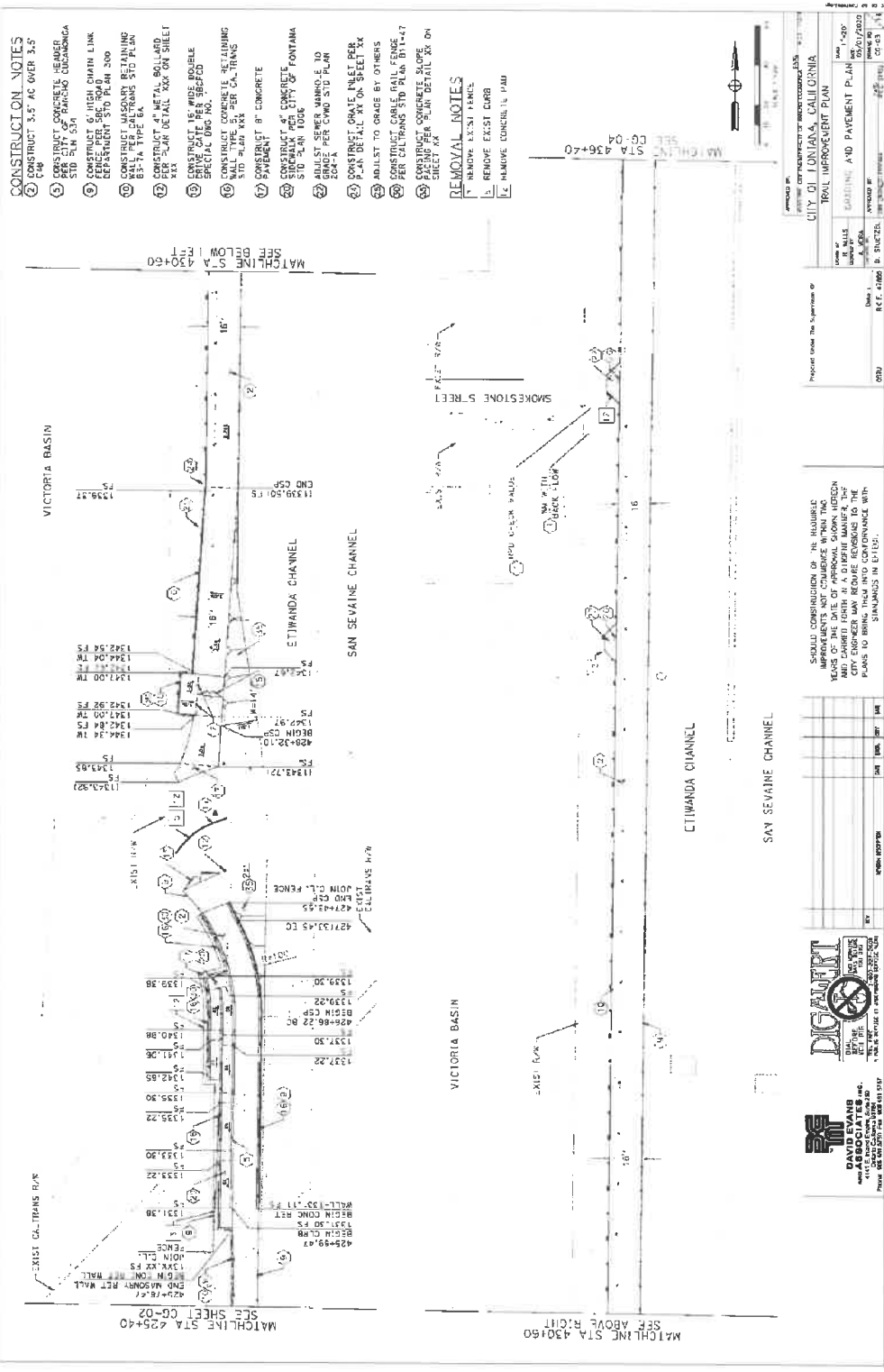

- CONSTRUCTION NOTES**
- 1. CONSTRUCT 3.5" AC OVER 3.5" ASPHALT CONCRETE WEAR SURFACE PER CITY OF FONTANA STANDARD SPECIFICATIONS
 - 2. CONSTRUCT 6" HIGH CHAIN LINK FENCE PER CALTRANS STD PLAN 300
 - 3. CONSTRUCT MASONRY RETAINING WALL PER CALTRANS STD PLAN 300
 - 4. CONSTRUCT METAL GALVANNEAL PER PLAN DETAIL 4X4-04 SHEET 11X
 - 5. CONSTRUCT 16" WIDE DOUBLE SPIRAL CORNER BEEPER PER CALTRANS STD PLAN 300
 - 6. CONSTRUCT CONCRETE RETAINING WALL TYPE 51 PER CALTRANS STD PLAN 300
 - 7. CONSTRUCT 4" CONCRETE CURB PER CITY OF FONTANA STD PLAN 1006
 - 8. ADJUST SLOPE TO 4% TO ADJUST TO 5% SLOPE PER PLAN DETAIL 4X4-04
 - 9. CONSTRUCT ORATE INLET PER PLAN DETAIL 4X4-04
 - 10. ADJUST TO GRADE BY OTHERS
 - 11. CONSTRUCT CABLE RAIL FENCE PER CALTRANS STD PLAN BT-1-47
 - 12. CONSTRUCT CONCRETE SLOPE PER PLAN DETAIL 4X4-04

- REMOVAL NOTES**
- 1. REMOVE EXIST CURB
 - 2. REMOVE EXIST FENCE
 - 3. REMOVE CONCRETE PAD

PROJECT UNDER THE SUPERVISION OF
CITY OF FONTANA, CALIFORNIA
 TRAIL IMPROVEMENT PLAN
 SHEET 11 OF 12
 DATE: 05/20/2008
 DRAWN BY: [Name]
 CHECKED BY: [Name]
 APPROVED BY: [Name]
 TITLE: [Title]

SHOULD CONSTRUCTION OF THE REQUIRED IMPROVEMENTS NOT COME WITHIN THE MANDATED RIGHT OF WAY BOUNDARIES, THE CITY ENGINEER MAY REMOVE BOUNDARIES TO THE PLANS TO BRING THEM INTO CONFORMANCE WITH BOUNDARIES IN EFFECT.

DIG HERE
 BEFORE YOU START ANY WORK
 CALL 811 OR VISIT WWW.CALL811.COM
 TO LOCATE UTILITIES BELOW GROUND.

PROFESSIONAL SEAL
 [Seal Area]
 [Professional Name]
 [Title]
 [Address]
 [Phone]
 [Fax]

CONSTRUCTION NOTES

- 1. CONSTRUCT 3.5' AC OVER 3.5"
- 2. CONSTRUCT CONCRETE WEAR SURFACE PER CITY OF PONTIAC STANDARDS STD. PLAN 534
- 3. CONSTRUCT 5" HIGH CHAIN LINK FENCE PER CITY OF PONTIAC STANDARDS STD. PLAN 300
- 4. CONSTRUCT MASSWALL RETAINING WALL PER CITY OF PONTIAC STANDARDS STD. PLAN R-1
- 5. CONSTRUCT CONCRETE GROUND ANCHOR RETAINING WALL PER STRUCTURAL PLAN R-X
- 6. CONSTRUCT 16" PIPE DOUBLE END CAP PER CITY OF PONTIAC SPECIAL ORD. NO. 1
- 7. CONSTRUCT 4" CONCRETE CURB PER CITY OF PONTIAC STANDARDS STD. PLAN 300
- 8. ADJUST SLOPE HANGABLE TO GRADE PER CIVIL STD. PLAN 204-1
- 9. ADJUST TO GRADE BY OTHERS
- 10. CONSTRUCT CABLE RAIL FENCE PER CALTRANS STD. PLAN BTI-4/
- 11. CONSTRUCT CONCRETE SLOPE PROTECT PER PLAN DETAIL AC ON SHEET AX

REMOVAL NOTES

- 1. REMOVE AC PAVEMENT
- 2. REMOVE EXIST' FENCE
- 3. REMOVE EXIST' RETAINING WALL
- 4. REMOVE CONCRETE PAD

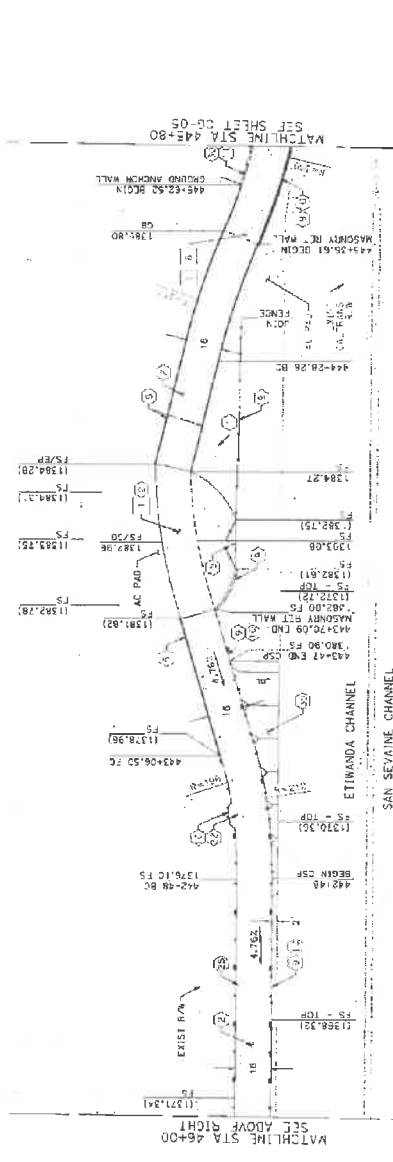
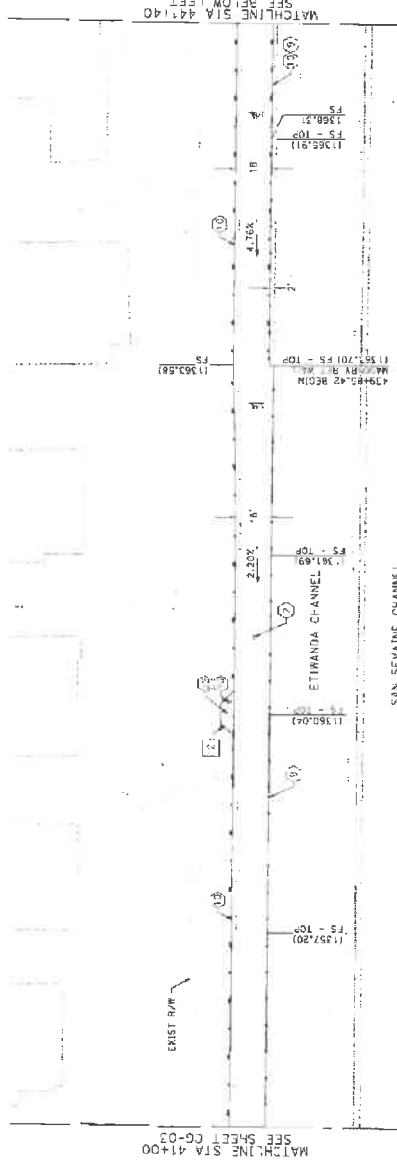

APPROVED BY: [Signature] DATE: 03/27/2020

CITY OF LONTANA, CALIFORNIA

TRAIL IMPROVEMENT PLAN

CRADING AND PAVEMENT PLAN

DATE: 03/27/2020

SCALE: 1" = 20'

PROJECT: [Project Name]

DATE: 03/27/2020

BY: [Designer Name]

DATE: 03/27/2020

PROJECT: [Project Name]

DATE: 03/27/2020

BY: [Designer Name]

DATE: 03/27/2020

PROJECT: [Project Name]

DATE: 03/27/2020

BY: [Designer Name]

DATE: 03/27/2020

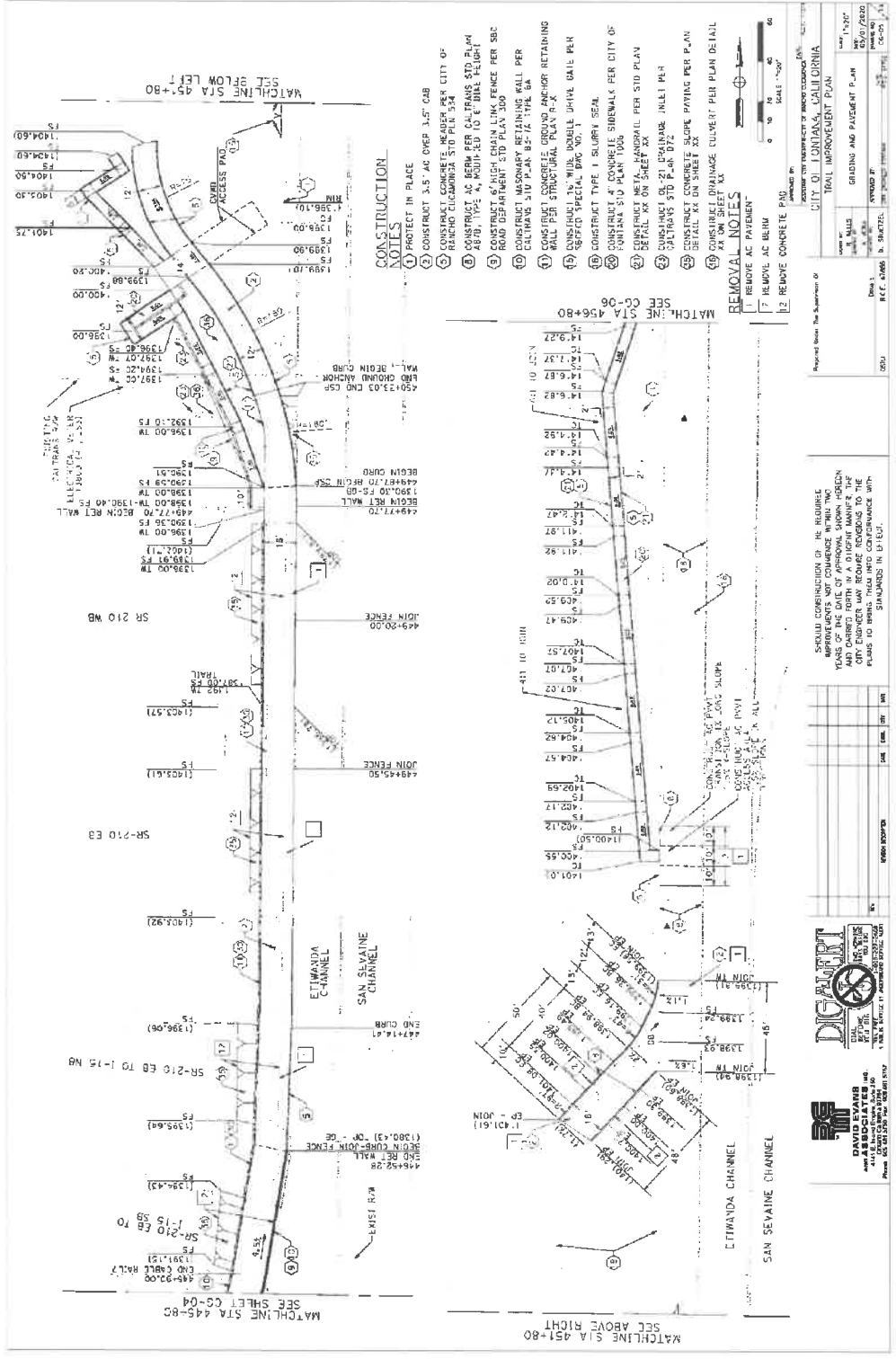

CONSTRUCTION NOTES

1. PROTECT IN PLACE
2. CONSTRUCT 3.5" AC OVER 3.5" GAB
3. CONSTRUCT CONCRETE HEADER PER CITY OF RANCHO CUCUMBERA STD P.LR 334
4. CONSTRUCT AC BEAM PER CALTRANS STD PLAN 1000
5. CONSTRUCT 6" HIGH CONCRETE FENCE PER SBC ROAD DEPARTMENT STD PLAN 1000
6. CONSTRUCT MASONRY RETAINING WALL PER CALTRANS STD P. AN 82-1A THE GA
7. CONSTRUCT CONCRETE GROUND ANCHOR RETAINING WALL PER STRUCTURAL PLAN R-X
8. CONSTRUCT 12" WIDE DOUBLE UPHOLE GATE PER COPPED SPECIAL BRG. NO. 1
9. CONSTRUCT TYPE 1 SLURRY SEAL
10. CONSTRUCT 3" CONCRETE SIDEWALK PER CITY OF RANCHO CUCUMBERA STD PLAN R-X
11. CONSTRUCT METAL MANGROVE INLET PER STD PLAN DETAIL XX ON SHEET XX
12. CONSTRUCT 0L-21 DOWNHOLE INLET PER STD PLAN DETAIL XX ON SHEET XX
13. CONSTRUCT CONCRETE SLOPE PAVING PER P.LR DETAIL XX ON SHEET XX
14. CONSTRUCT DRAINAGE CULVERT PER PLAN DETAIL XX

REMOVAL NOTES

1. REMOVE AC PAVEMENT
2. REMOVE CONCRETE PAVEMENT

Project Name: The Improvement of
 CITY OF FONTANA, CALIFORNIA
 TRAIL IMPROVEMENT PLAN
 Scale: 1"=30'
 Date: 05/07/2020
 Project No: 19-0000
 Sheet No: 18 of 33
 Title: TRAIL IMPROVEMENT PLAN

SHOULD CONSTRUCTION OF THE REQUIRED IMPROVEMENTS NOT COMMENCE WITHIN TWO WEEKS OF THE DATE OF THIS PERMIT, THE PERMIT SHALL BE DEEMED VOID. THE CITY ENGINEER MAY REQUIRE REVISIONS TO THE PLANS TO BE SUBMITTED FOR APPROVAL WITHIN 30 DAYS OF THE DATE OF THIS PERMIT.

DAVID EVANS ENGINEERING
 4110 E. BROADWAY, SUITE 200
 FONTANA, CA 92335
 PHONE: 951.837.2200
 FAX: 951.837.2201
 WWW.DAVIDEVANS-ENG.COM

DISCLAIMER
 THIS DOCUMENT IS THE PROPERTY OF DAVID EVANS ENGINEERING. IT IS TO BE USED ONLY FOR THE PROJECT AND SITE SPECIFICALLY IDENTIFIED HEREIN. IT IS NOT TO BE REPRODUCED, COPIED, OR TRANSMITTED IN ANY FORM OR BY ANY MEANS, WITHOUT THE WRITTEN PERMISSION OF DAVID EVANS ENGINEERING.

- CONSTRUCTION NOTES**
- PROTECT IN PLACE
 - CONSTRUCT 3.5" AC OVER 3.5" SUB
 - CONSTRUCT 3.5" AC OVER 3.5" SUB
 - CONSTRUCT AC BERM PER CITY OF CHANDLER SPECIFICATIONS PER CITY OF CHANDLER SPECIFICATIONS STD PLAN 534
 - CONSTRUCT AC BERM PER CITY OF CHANDLER SPECIFICATIONS PER CITY OF CHANDLER SPECIFICATIONS STD PLAN 534
 - CONSTRUCT AC BERM PER CITY OF CHANDLER SPECIFICATIONS PER CITY OF CHANDLER SPECIFICATIONS STD PLAN 534
 - CONSTRUCT TYPE 1 SUBPRT SEAL
 - REMOVE EXISTING METAL DRAINAGE GRATE AND INSTALL DRAINAGE GRATE PER CITY OF CHANDLER SPECIFICATIONS PER STD PLAN 534
 - CONSTRUCT AC CONCRETE PER CITY OF CHANDLER SPECIFICATIONS PER STD PLAN 534
 - CONSTRUCT METAL RAMP/PAIL PER CITY OF CHANDLER SPECIFICATIONS PER STD PLAN 534

- REMOVAL NOTES**
- REMOVE AC PAVEMENT
 - REMOVE AC BERM

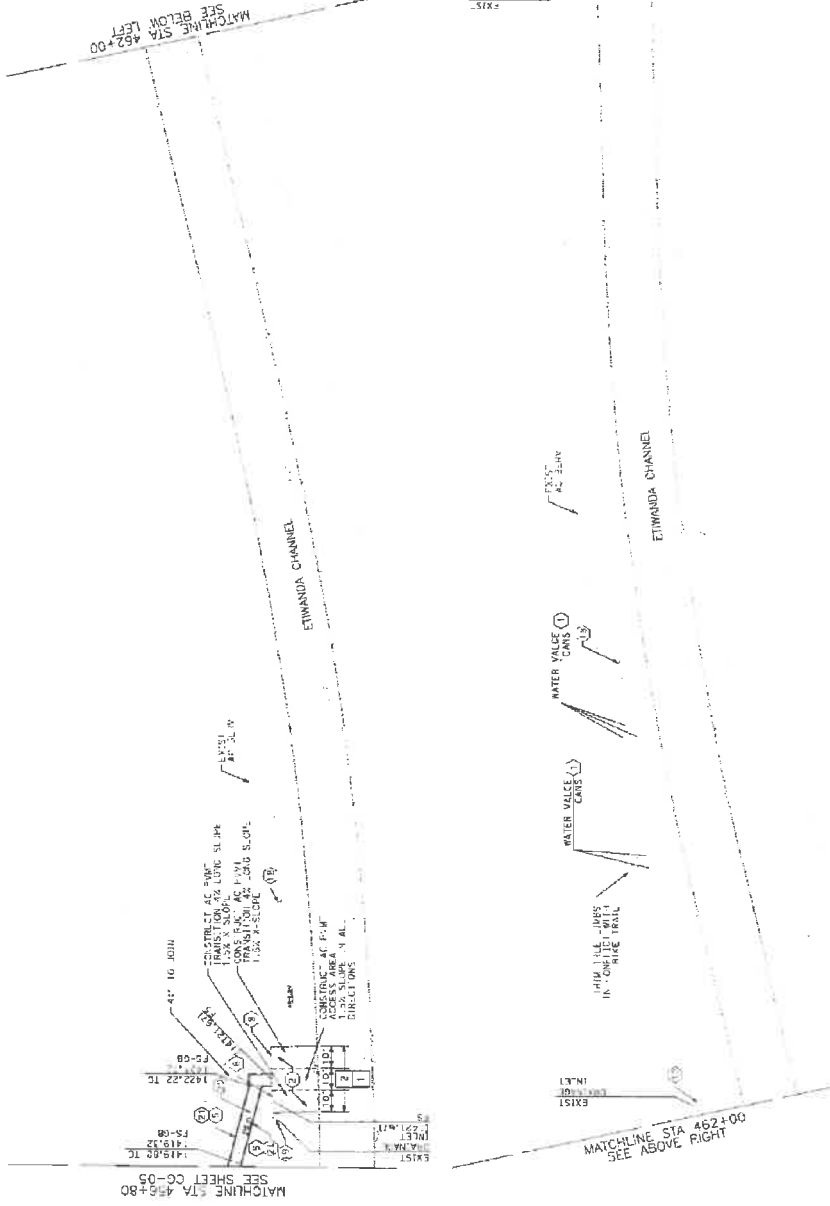

PROJECT NO: 18-001
 CITY OF TONTONA, CALIFORNIA
 TRAIL IMPROVEMENT PLAN
 GRADING AND PAVEMENT PLAN
 SHEET NO: 15/19
 DATE: 05/01/2018

APPROVED BY: [Signature]
 PROJECT NO: 18-001
 CITY OF TONTONA, CALIFORNIA
 TRAIL IMPROVEMENT PLAN
 GRADING AND PAVEMENT PLAN
 SHEET NO: 15/19
 DATE: 05/01/2018

SHOULD CONSIDERATION OF THE REQUIRED IMPROVEMENTS NOT COMPREHENSIVE WITHIN TWO YEARS OF THE DATE OF THIS PLAN. THE CITY ENGINEER MAY REQUIRE REVISIONS TO THE PLANS TO BE MADE IN ACCORDANCE WITH THE STANDARDS IN EFFECT.

NO.	DATE	DESCRIPTION
1	05/01/2018	ISSUED FOR PERMIT

DISCLAIMER

THESE PLANS AND SPECIFICATIONS ARE PREPARED BY THE ENGINEER AND CONTRACTOR FOR THE CITY OF TONTONA, CALIFORNIA. THE ENGINEER AND CONTRACTOR SHALL BE RESPONSIBLE FOR THE ACCURACY OF THE INFORMATION PROVIDED TO THEM BY THE CITY OF TONTONA. THE ENGINEER AND CONTRACTOR SHALL NOT BE RESPONSIBLE FOR ANY ERRORS OR OMISSIONS IN THE PLANS OR SPECIFICATIONS.

- ### REMOVAL NOTES
- (1) REMOVE EXISTING GATE
 - (2) REMOVE AC BERM
 - (3) REMOVE EXIST FENC

- (4) CONSTRUCT 4" METAL BOLLARD PER PLAN DETAIL XX ON SHEET XX
- (5) CONSTRUCT TYPE 1 SILURRY SCAL
- (6) CONSTRUCT 4" CONCRETE SIDEWALK 1555' CITY OF FORHAIN SID PLAN
- (7) CONSTRUCT METAL HORIZONTAL BERM PER PLAN DETAIL XX ON SHEET XX

- ### CONSTRUCTION NOTES
- (1) CONSTRUCT 3.5' AC OVER 3.5' GAB
 - (2) CONSTRUCT CONCRETE HEADWP PER PLAN 004
 - (3) CONSTRUCT CONCRETE SIDEWALK 1555' CITY OF FORHAIN SID PLAN
 - (4) CONSTRUCT AC BERM PER PLAN DETAIL XX ON SHEET XX
 - (5) CONSTRUCT 4" METAL HORIZONTAL BERM PER PLAN DETAIL XX ON SHEET XX

MATCHLINE STA 467+80
SEE SHEET CO-08

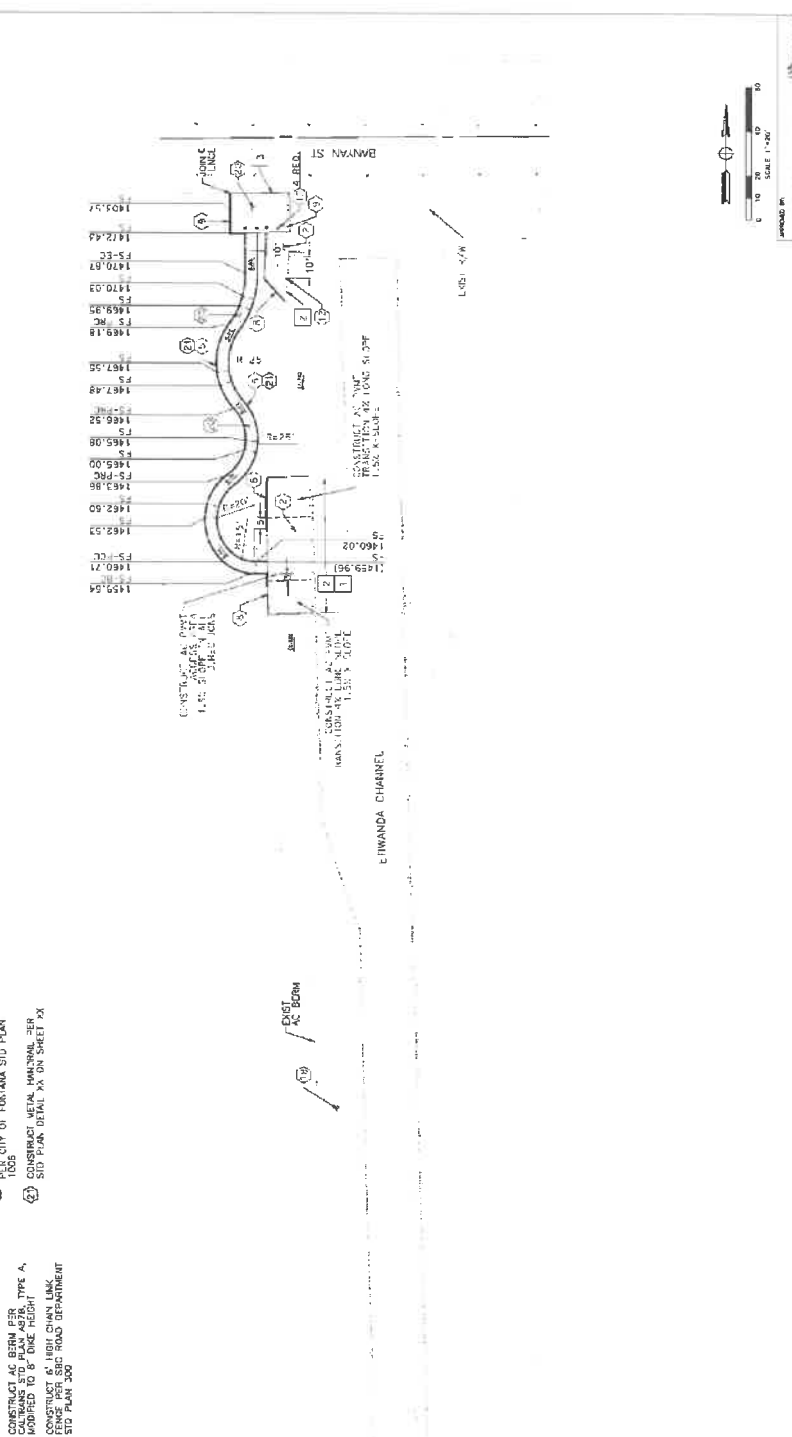

APPROVED BY: DATE: 08/07/2009

PROJECT NAME: **TRAIL IMPROVEMENT PLAN**

CITY OF LUNAWAY, CALI ORINA

PROJECT NO: **CC-07**

ISSUE NO: **01**

DATE: **08/07/2009**

APPROVED BY: DATE: **08/07/2009**

PROJECT NO: **CC-07**

ISSUE NO: **01**

PLEASE REFER TO THE ATTACHED APPROPRIATIONS NOT COMPLETED WITH THE CITY ENGINEER'S REVIEW AND CARRIED FORH IN A DIRECT MANNER THE PLANS TO BEING FORH INTO CONFORMANCE WITH STANDARDS IN USE.

NO.	DATE	BY	CHKD
1			
2			
3			
4			
5			
6			
7			
8			
9			
10			
11			
12			
13			
14			
15			
16			
17			
18			
19			
20			
21			
22			
23			
24			
25			

DIGI-MARK
2575 S. 130th Ave. Suite 101
Lynnwood, WA 98037
Tel: 206.763.1300

LAND-A-RAMA
4115 150th Avenue, Suite 200
Lynnwood, WA 98037
Tel: 206.763.1300

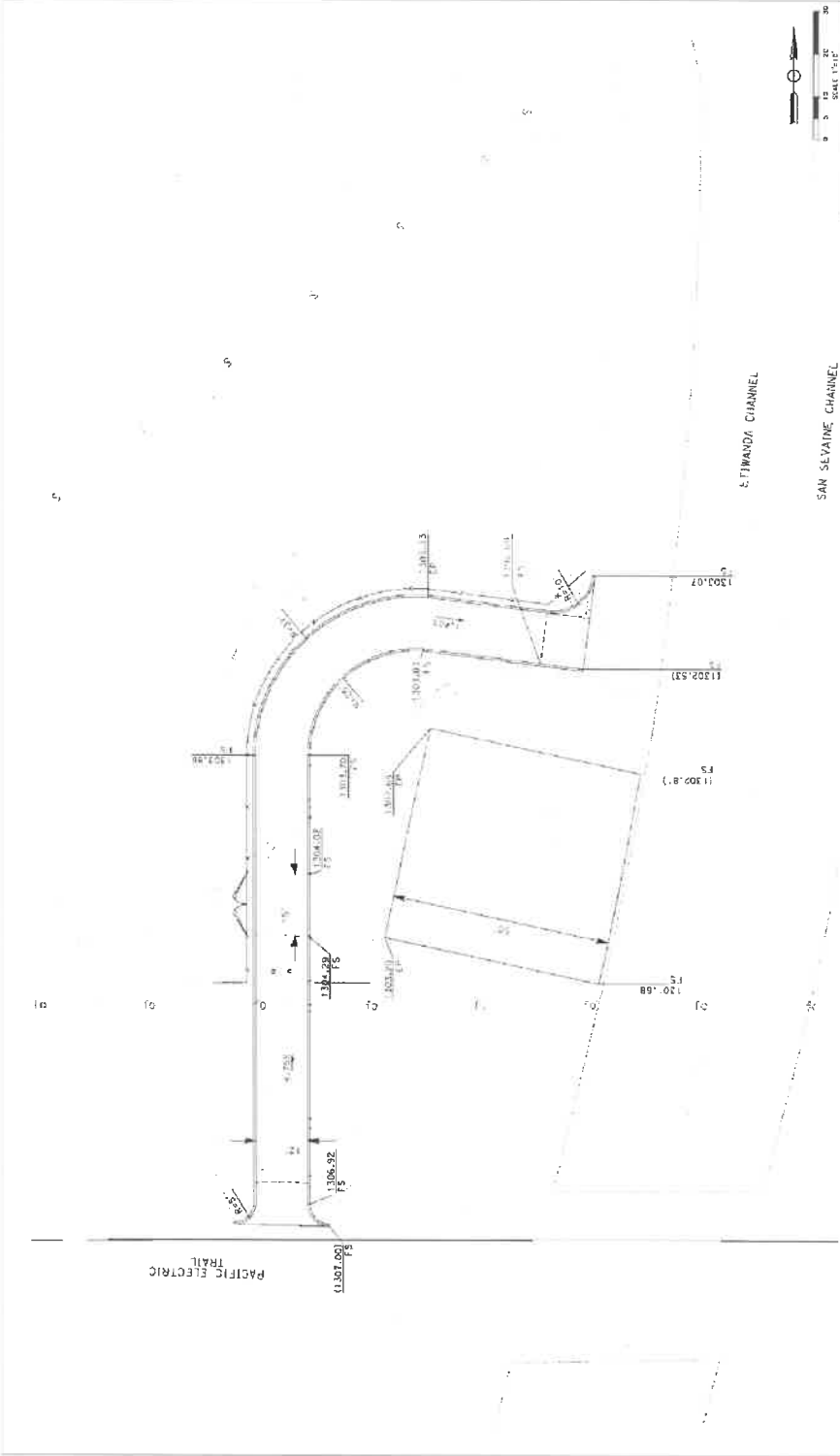

APPROVED BY: [Signature]

REGISTERED PROFESSIONAL ENGINEER (P.E.)

CITY OF SAN JOSE, CALIFORNIA

PROJECT: FIRE IMPROVEMENT POOR

DATE: 05/01/2020

SCALE: 1"=12'

PROJECT UNDER THE SUPERVISION OF:

DATE: []

RECEIVED BY: []

DATE: []

SHOULD CONSTRUCTION OF THE REQUIRED WORK BE COMPLETED WITHIN THE PERIOD OF APPROXIMATELY SEVEN (7) YEARS OF THE DATE OF APPROVAL SHOWN HEREIN AND DASHED FOR IN A DASHED MANNER. THE DASHED LINE SHALL BE USED TO INDICATE THE PERIOD TO BE COMPLETED BY THE CONTRACTOR. SHOWN IN D.P.C.

NO.	DESCRIPTION	DATE	BY	CHK

DAVID EVANS AND ASSOCIATES

1000 CALIFORNIA STREET, SUITE 300
SAN JOSE, CALIFORNIA 95128
PHONE: (408) 434-8800 FAX: (408) 434-8801

DIGALERT

CALL 800-4-A-DIGALERT

FOR A FREE COPY OF THE MANUAL 12702-008

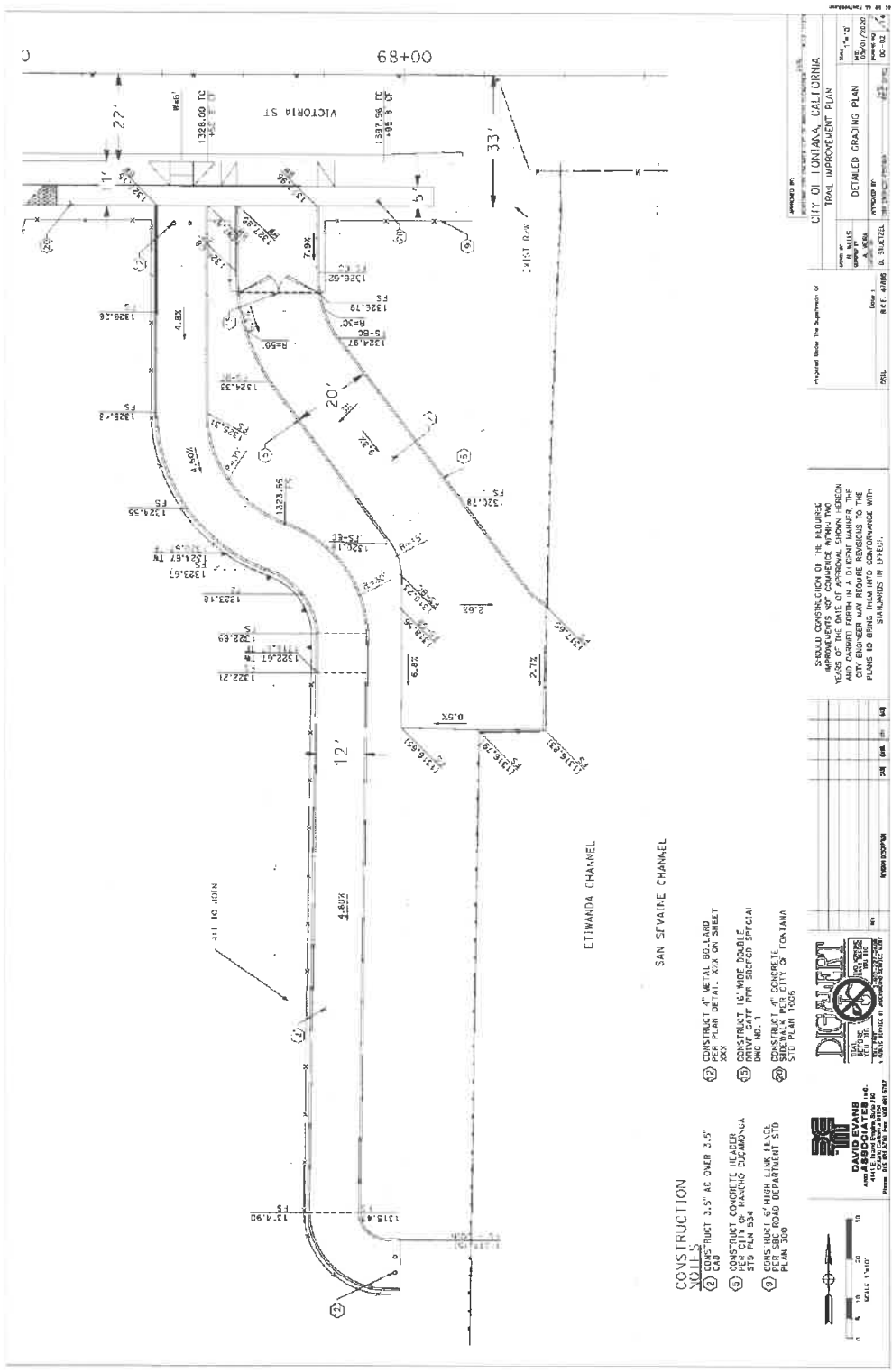

CONSTRUCTION NOTES

- 1. CONSTRUCT 3.5" AC OVER 3.5" JOINTS
- 2. CONSTRUCT CONCRETE HEADER PER PLAN METAL JOINT ON SHEET
- 3. CONSTRUCT 15" RCP DOUBLE END OF CUT FOR 36" RCP SPICAL DMC NO. 1
- 4. CONSTRUCT CONCRETE 60" HIGH LINK 14" X 14" PER SEC ROAD DEPARTMENT STD PLAN 300

SAN SEVAIRE CHANNEL

ETIWANDA CHANNEL

City of Fontana, California
 Department of Public Works
 Sewer Division

Project Name: The Improvement of
 San Sevaire Channel
 Date: 08/15/2019
 Drawn by: J. B. BAKER
 Checked by: J. B. BAKER

Sheet No. 22 of 33
 Project No. 19-001
 Date: 08/15/2019
 Title: DETAILED GRADING PLAN

DCA
 DESIGN CONSULTANTS ASSOCIATES
 4411 CALIFORNIA AVENUE, SUITE 200
 FONTANA, CALIFORNIA 92335
 PHONE: 951.835.7600 FAX: 951.835.7601

Scale: 1" = 10'

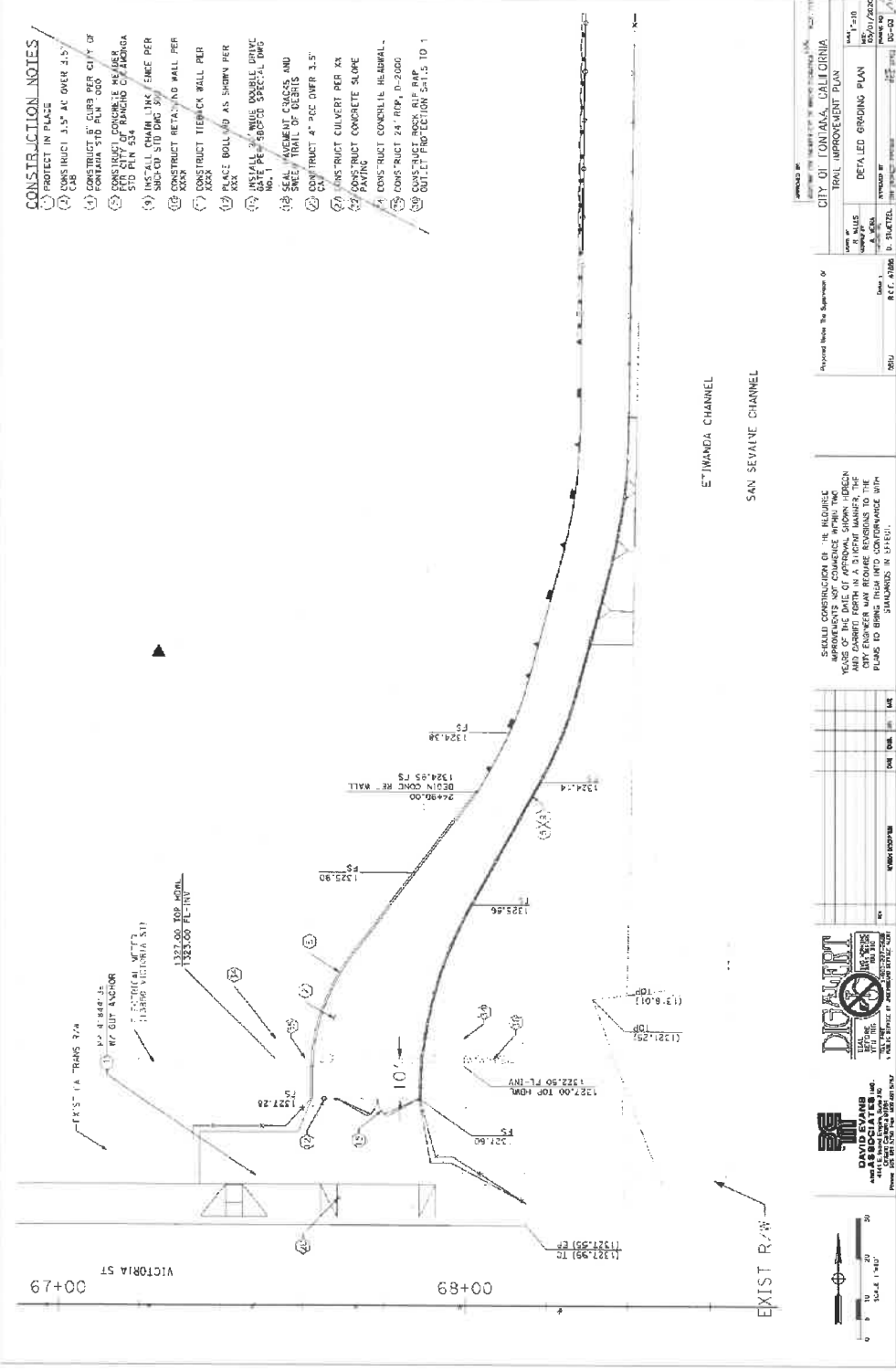

CONSTRUCTION NOTES

- 1) PROTECT IN PLACE
- 2) CONSTRUCT 3.5' AC OVER 3.5' CB
- 3) CONSTRUCT 8' CURBS PER CITY OF LONDON, SD PER 300
- 4) CONSTRUCT 4' RAMP PER CITY OF LONDON, SD PER 300
- 5) INSTALL CHAIN LINK FENCE PER 300-00 STD DWG 37
- 6) CONSTRUCT RETAINING WALL PER XXXX
- 7) CONSTRUCT TIEBACK WALL PER XXXX
- 8) PLACE BOLLARD AS SHOWN PER XXXX
- 9) INSTALL 6" MNU DOUBLE DRIVE NO. 1 PRE-CAST SPECIAL DWG
- 10) SEAL JAVEMENT CURBS AND SKEW / TRAIL OF CURBS
- 11) CONSTRUCT 4' RCC OVER 3.5' CB
- 12) CONSTRUCT CULVERT PER XX
- 13) CONSTRUCT CONCRETE SLOPE PAVING
- 14) CONSTRUCT CONCULTE HEADWALL
- 15) CONSTRUCT 24" R/RP, D-2000
- 16) CURBS, INLET ROCK, R/F RFP
- 17) OUTLET PROTECTION S-1.5 TD 1

APPROVED BY:	DATE:
CITY OF LONDON, CALIFORNIA	7/15/19
PROJECT:	SCALE:
TRAIL IMPROVEMENT PLAN	1" = 20'
DETAILED GRADING PLAN	1" = 20'
DATE:	DATE:
7/15/19	7/15/19
BY:	BY:
R.C.T. 2186	D. STACEL
NO.	NO.
100	100

APPROVED FROM THE SUPERVISOR OF

SHOULD CONSTRUCTION OF THE PROPOSED IMPROVEMENTS NOT COME WITHIN TWO FEET OF ANY EXISTING UTILITY, THE CITY ENGINEER MAY REQUIRE REVISIONS TO THE PLANS TO BRING THEM INTO CONFORMANCE WITH STANDARDS R. 01031.

NO.	DATE	BY	CHK



VICTORIA BASIN

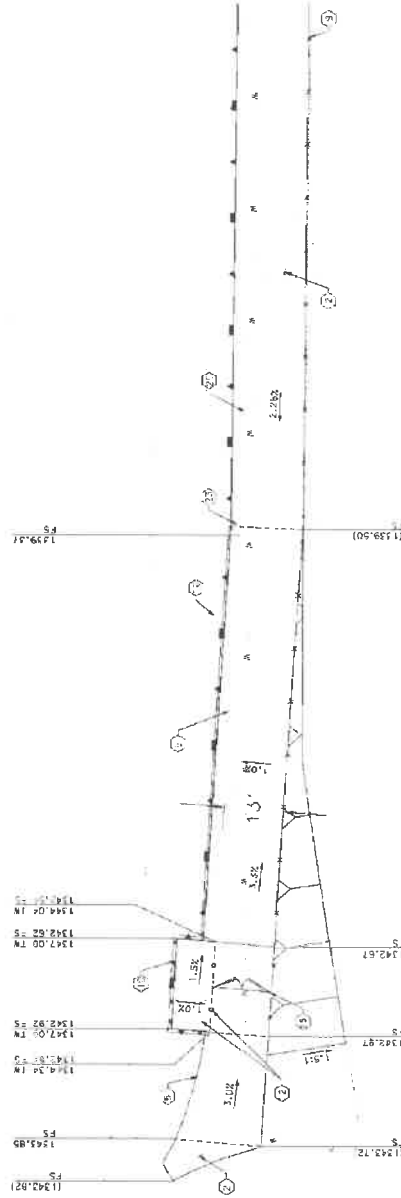

- CONSTRUCTION NOTES**
- (1) CONSTRUCT 3.5' AC OVER A.S. CAB
 - (2) CONSTRUCT CONCRETE HEADRISERS ST. IN S34
 - (3) INSTALL CHAIN LINK FENCE PER SPEC CD 5 TO DIV. 300
 - (4) CONSTRUCT retaining wall per spec with pitching per S34
 - (5) MAKE BOUNDARY AS SHOWN PER PLAN
 - (6) INSTALL 24" WIDE DOUBLE DRINK GATE FOR S34 SPECIAL DRG. NO. 1
 - (7) CONSTRUCT SEWER MANHOLE WITH COVER SET AS SHOWN PER PLAN
 - (8) CONSTRUCT 24" DIA. PVC 4" DIA. 4" DIA. PVC 4" DIA. INLET
 - (9) CONSTRUCT MASONRY SLOUGH WALL

ETIMWANDA CHANNEL

SAN SEVANE CHANNEL

PROJECT NO.	DATE	BY	CHECKED BY
1001	08/21/2019	MSJ	
PROJECT UNDER THE SUPERVISION OF			
CITY OF TURKEY, CALIFORNIA			
TRAIL IMPROVEMENT PLAN			
CITY	DATE	SCALE	
TURKEY, CALIFORNIA	08/21/2019	1"=10'	
DRAWING NO.			
03/01/2019			

SHALL CONSTRUCTION OF THE REQUIRED IMPROVEMENTS BE COMPLETED WITHIN THE PERIOD OF 12 MONTHS FROM THE DATE THE CITY ENGINEER HAS REVIEWED THE PLANS TO BE IN ACCORDANCE WITH THE STANDARDS IN SECTION

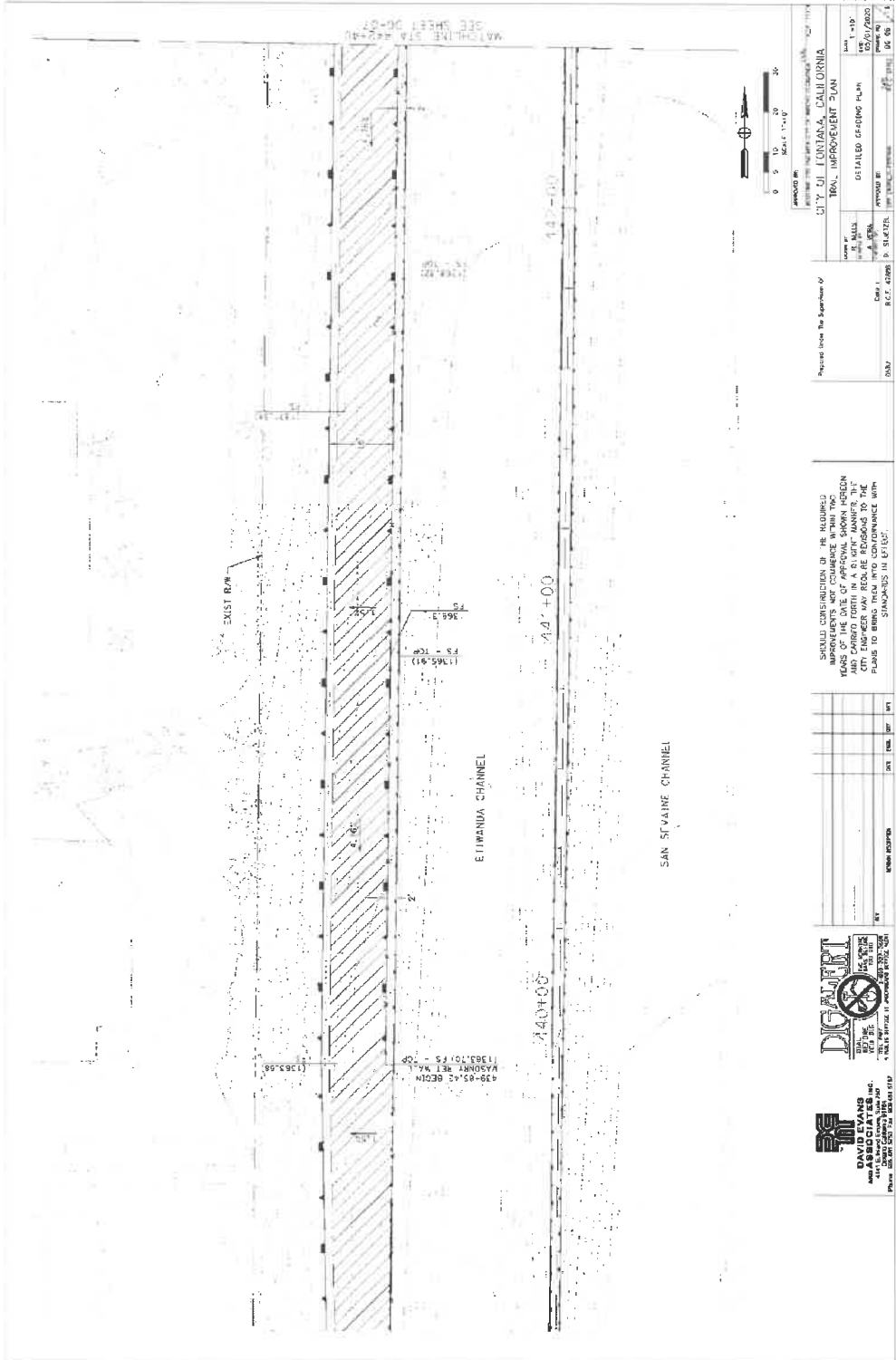

APPROVED BY: [Signature]
 DATE: 11/15/19
 PROJECT NO: 19-00000000
 SHEET NO: 20-03
 TOTAL SHEETS: 20-03

PREPARED BY THE SUPERVISOR OF
 CITY OF TUNAWA, CALIFORNIA
 TRAIL IMPROVEMENT PLAN
 DATE: 11/15/19
 DRAWN BY: [Name]
 CHECKED BY: [Name]

SHOULD CONSTRUCTION OF THE PROPOSED
 IMPROVEMENTS BE CONSIDERED WITH THE
 UNDERSTANDING THAT THE ENGINEER
 HAS NOT CONDUCTED A VISUAL INSPECTION
 AND CANNOT GUARANTEE THE ACCURACY OF THE
 DATA PROVIDED TO HIM. THE ENGINEER
 MAKES NO REPRESENTATION AS TO THE
 ACCURACY OF THE DATA PROVIDED TO HIM.
 STANDARDS IN EFFECT

1/11 1/12 1/13 1/14 1/15
 1/16 1/17 1/18 1/19 1/20
 1/21 1/22 1/23 1/24 1/25
 1/26 1/27 1/28 1/29 1/30
 1/31 1/32 1/33 1/34 1/35
 1/36 1/37 1/38 1/39 1/40
 1/41 1/42 1/43 1/44 1/45
 1/46 1/47 1/48 1/49 1/50
 1/51 1/52 1/53 1/54 1/55
 1/56 1/57 1/58 1/59 1/60

ENGINEERING
INC.
ASSOCIATES
 4141 N. CALIFORNIA BLVD
 SUITE 200
 SAN JOSE, CA 95131
 TEL: (408) 253-1100
 FAX: (408) 253-1101
 WWW: WWW.EIENGINEERING.COM

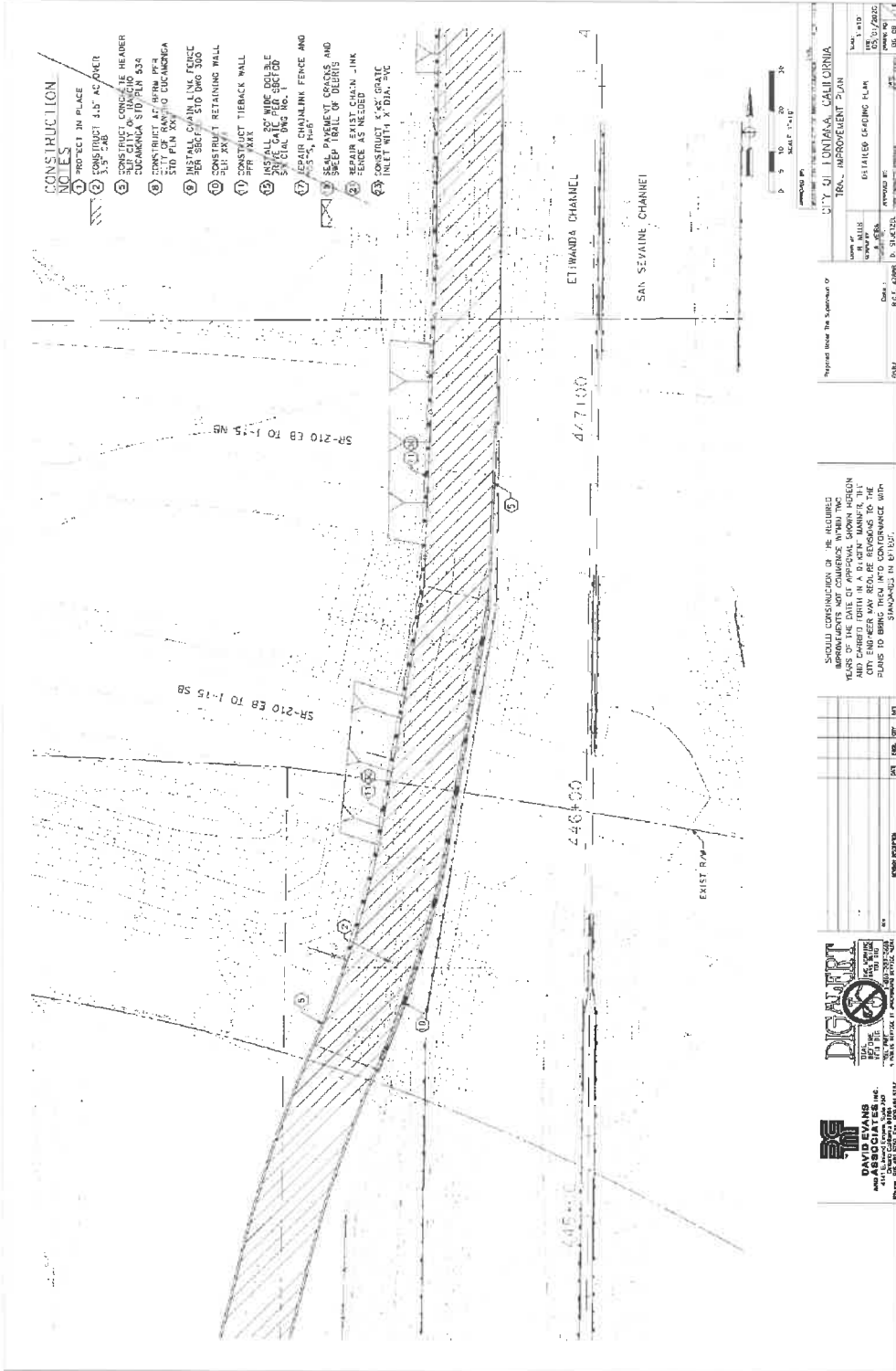

CONSTRUCTION NOTES

1. PROTECT IN PLACE
2. CONSTRUCT 4.5' AC/OVER
3. CONSTRUCT CONCRETE HEADER FOR CITY OF ONTARIO CUCUMBERA STD PLAN 534
4. CONSTRUCT 4.5' BERM PER STD PLAN 534 AND CUCUMBERA STD PLAN 534
5. INSTALL CHAIN LINK FENCE PER S&P STD DWG 300
6. CONSTRUCT RETAINING WALL PER S&P STD DWG 300
7. CONSTRUCT TIEBACK WALL PER S&P STD DWG 300
8. INSTALL 24" WIDE DOUBLE ROW CONCRETE PER S&P STD DWG NO. 1
9. REPAIR CHAINLINK FENCE AND S&P STD DWG NO. 1
10. REPAIR EXIST CHAIN LINK FENCE AS NEEDED
11. REPAIR EXIST CHAIN LINK FENCE AS NEEDED
12. CONSTRUCT 4'x4' GRATE INLET WITH 4" DIA. PVC

DIGI-MART
 THE ORIGINAL SOURCE FOR THE BEST QUALITY PRODUCTS AT THE LOWEST PRICE.
 100% SATISFACTION GUARANTEED.

APPROVED FOR THE SUPERVISOR OF
 CITY OF ONTARIO, CALIFORNIA
 TITLE: IMPROVEMENT PLAN
 DATE: 05/31/2005

SHOULD CONSTRUCTION OF THE REQUIRED WORK BE DELAYED FOR MORE THAN 90 DAYS FROM THE DATE OF APPROVAL, A NEW PERMIT MUST BE OBTAINED AND CARRIED FORTH IN A BACTIN MANNER. THE CITY ENGINEER MAY REQUIRE REVISIONS TO THE PLANS TO BE SUBMITTED IN ADVANCE WITH ANY CHANGES IN 8/10/07.

NO.	DATE	BY	CHK

EMIST R/W

DAVID EVANS AND ASSOCIATES INC.
 4110 EAST 15TH AVENUE, SUITE 200
 DENVER, COLORADO 80202
 PHONE: 303.752.7500 FAX: 303.752.1514

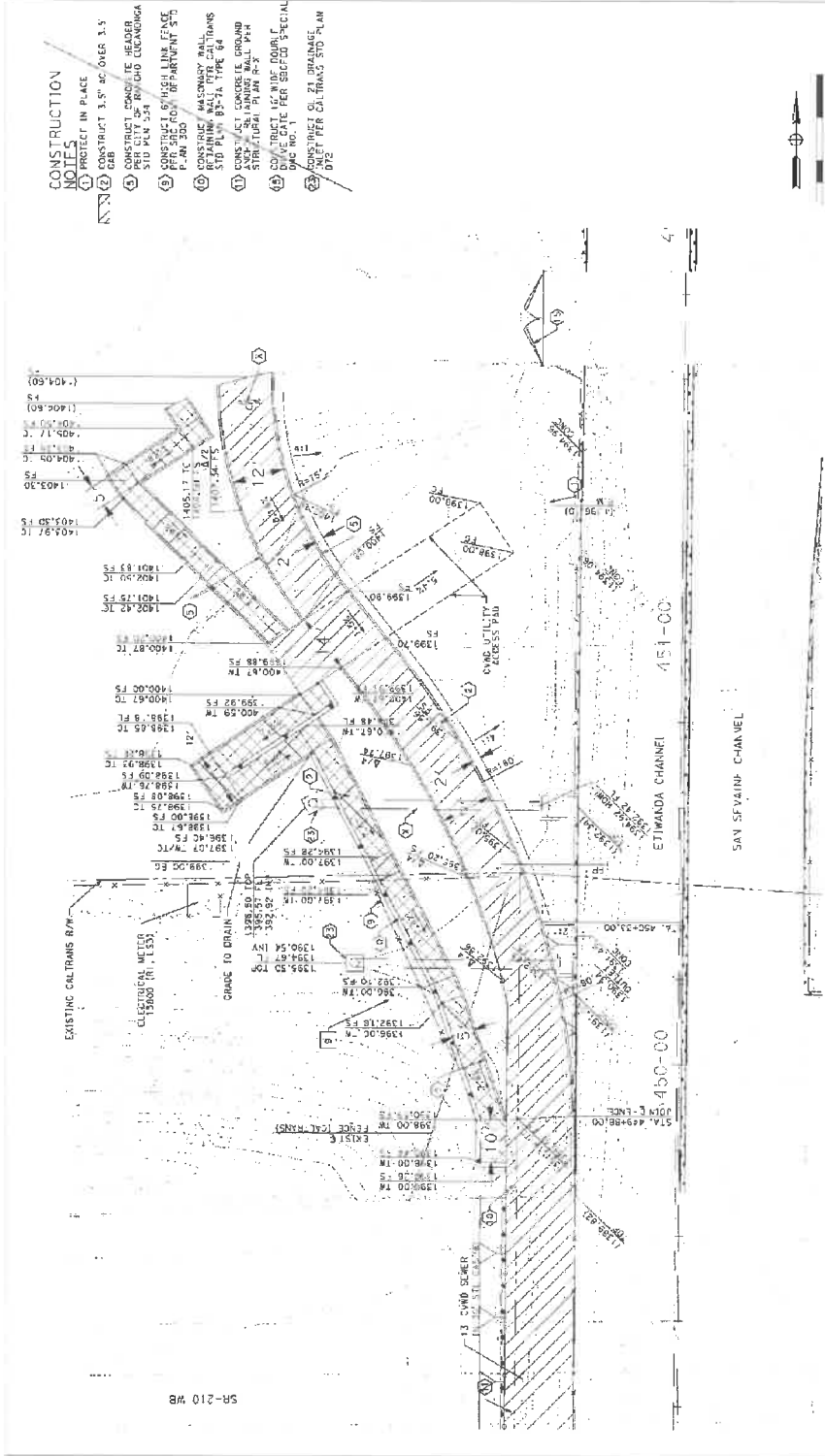

- CONSTRUCTION NOTES**
- 1) PROTECT IN PLACE
 - 2) CONSTRUCT 3.5' AC OVER 3.5'
 - 3) CONSTRUCT CHANNEL WEIR PER CITY OF RANCHO CUCARINGA STD PLAN 334
 - 4) CONSTRUCT 1.6' HIGH LINE 1" V.C. PER CITY OF RANCHO CUCARINGA STD PLAN 335
 - 5) CONSTRUCT MASONRY WALL PER CITY OF RANCHO CUCARINGA STD PLAN 334
 - 6) CONSTRUCT CONCRETE GROUND STRUCTURAL PLAN R-3
 - 7) CONSTRUCT 1.5' WIDE DOUBLE DRAINAGE PER SUECO SPECIAL DWG NO. 1
 - 8) CONSTRUCT 21' DRAINAGE PER CALTRANS STD PLAN

APPROVED BY: [Signature]
 SCALE: 1" = 20'
 DATE: 11/15/19
 PROJECT NO: SR-210 WB
 SHEET NO: 4

APPROVED UNDER THE SUPERVISION OF:
CITY OF OAKLAND, CALIFORNIA
 TRAIL IMPROVEMENT PLAN
 DRAWING NO: 15500 (R), 1550
 DATE: 11/15/19

SHOULD CONSTRUCTION OR THE RELOCATION OF THE CHANNEL BE NECESSARY, THE CONTRACTOR SHALL BE RESPONSIBLE FOR THE PROTECTION AND CARE OF ALL EXISTING UTILITIES AND STRUCTURES. THE CONTRACTOR SHALL BE RESPONSIBLE FOR THE PROTECTION AND CARE OF ALL EXISTING UTILITIES AND STRUCTURES.

NO.	DATE	BY	DESCRIPTION
1			
2			
3			
4			
5			
6			
7			
8			
9			
10			
11			
12			
13			
14			
15			
16			
17			
18			
19			
20			
21			
22			
23			
24			
25			
26			
27			
28			
29			
30			
31			
32			
33			
34			
35			
36			
37			
38			
39			
40			
41			
42			
43			
44			
45			
46			
47			
48			
49			
50			
51			
52			
53			
54			
55			
56			
57			
58			
59			
60			
61			
62			
63			
64			
65			
66			
67			
68			
69			
70			
71			
72			
73			
74			
75			
76			
77			
78			
79			
80			
81			
82			
83			
84			
85			
86			
87			
88			
89			
90			
91			
92			
93			
94			
95			
96			
97			
98			
99			
100			

PROFESSIONAL SEAL
 ENGINEER
 STATE OF CALIFORNIA
 LICENSE NO. 20000
 NAME: [Name]
 FIRM: [Firm Name]

CONSTRUCTION NOTES

- ① CONSTRUCT 3.5' AC OVER 3.5' DIA
- ② CONSTRUCT AC BERM PER CALTRANS STD PLAN AFD 101 TYPE A
- ③ CONSTRUCT 4" METAL BOLLARDS PER PLAN BERM AND OR SHEET PILING PER CITY OF FONTANA STD PLAN 1003
- ④ CONSTRUCT 4" METAL BOLLARDS PER PLAN BERM AND OR SHEET PILING PER CITY OF FONTANA STD PLAN 1003

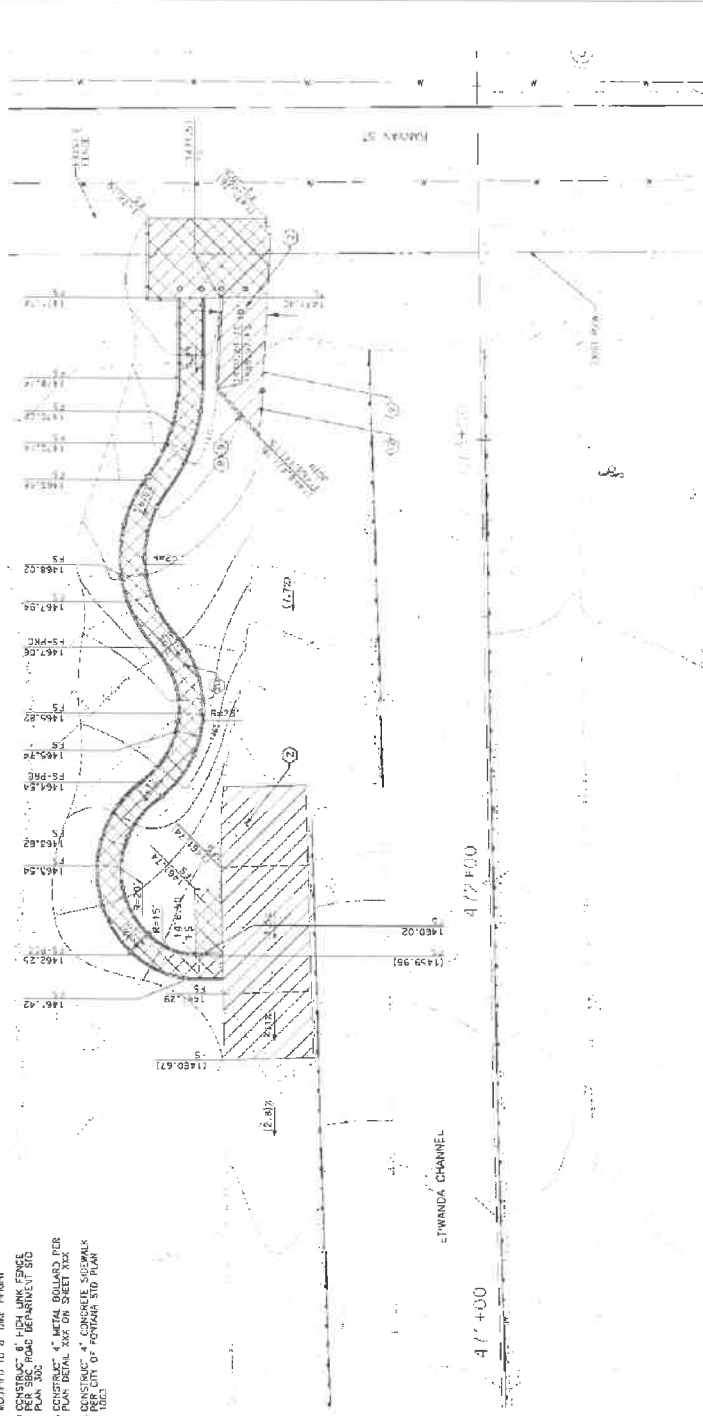

APPROVED BY: [Signature]

CITY OF FONTANA, CALIFORNIA

TITLE: TRAIL IMPROVEMENT PLAN

DATE: 10/20/2023

PROJECT NO: 23-001

DATE: 10/20/2023

SCALE: 1" = 10'

Prepared Under the Supervision of

DATE: 10/20/2023

PROJECT NO: 23-001

SHOULD CONSTRUCTION OF THE PROPOSED IMPROVEMENTS NOT CHANGE WITHIN THE PERMITTED TIME FRAME, THE CITY ENGINEER MAY REQUIRE REVISIONS TO THE PLANS TO REFLECT ANY CHANGES IN CIRCUMSTANCES IN 2024.

NO.	DATE	BY	CHK	APP	REV

PGI ENGINEERING

1700 N. GARDEN ST. SUITE 200, FONTANA, CA 92335

TEL: 951-833-7777 FAX: 951-833-7778

WWW.PGIENGINEERING.COM

PGI ENGINEERING

1700 N. GARDEN ST. SUITE 200, FONTANA, CA 92335

TEL: 951-833-7777 FAX: 951-833-7778

WWW.PGIENGINEERING.COM

DATE COUNTY SHEET TOTAL SHEET TOTAL
 06 SBD 15 7.3/7.5 XX XX



REGISTERED CIVIL ENGINEER 0818
 PLAN APPROVAL DATE
 SAN BERNARDINO COUNTY
 1140 N. GARDEN ST.
 SAN BERNARDINO, CA 92410

CONSTRUCTION NOTES

- ① CONSTRUCT TYPE GA DRAINAGE DRAINAGE
- ② CONSTRUCT CALTRANS STD PLAN 4" CURB
- ③ CONSTRUCT 4" CONCRETE SIDEWALK PER CITY OF FONTANA
- ④ CONSTRUCT 1/4" DEPRESSION 1/4" RPP ON SAND PPH CAN FRAMS
- ⑤ FRENCH DRAIN 1/4" RPP ON SAND PPH CAN FRAMS
- ⑥ TRENCH BLOTTING DETAIL 'A' ON SHEET 'X1'
- ⑦ CONSTRUCT CONCRETE SLOPE PAVING PEE PLAN DETAIL 'X2' ON SHEET 'X1'
- ⑧ COLD PLUME AC PAVEMENT 0.17"
- ⑨ CONSTRUCT 0.17" AC PAVEMENT
- ⑩ CONSTRUCT 0.25" AC OVER 0.15" C&B
- ⑪ CONSTRUCT CURB OPENING INLET CURB PER PLAN DETAIL 'XX' ON SHEET 'X1'
- ⑫ CONSTRUCT 50 MANHOLE PER SFRWG STD PLAN 320-2

- REMOVAL NOTES
- ⑭ REMOVE AC PAVEMENT
 - ⑮ REMOVE EXIST CONC SI OFF PAVEMENT
 - ⑯ REMOVE EXIST SIGN

STREET IMPROVEMENT PLANS

SCALE: Horiz 1" = 20'
 Vert 1" = 4'

PROJECT NUMBER & PHASE
 UNIT: 0000

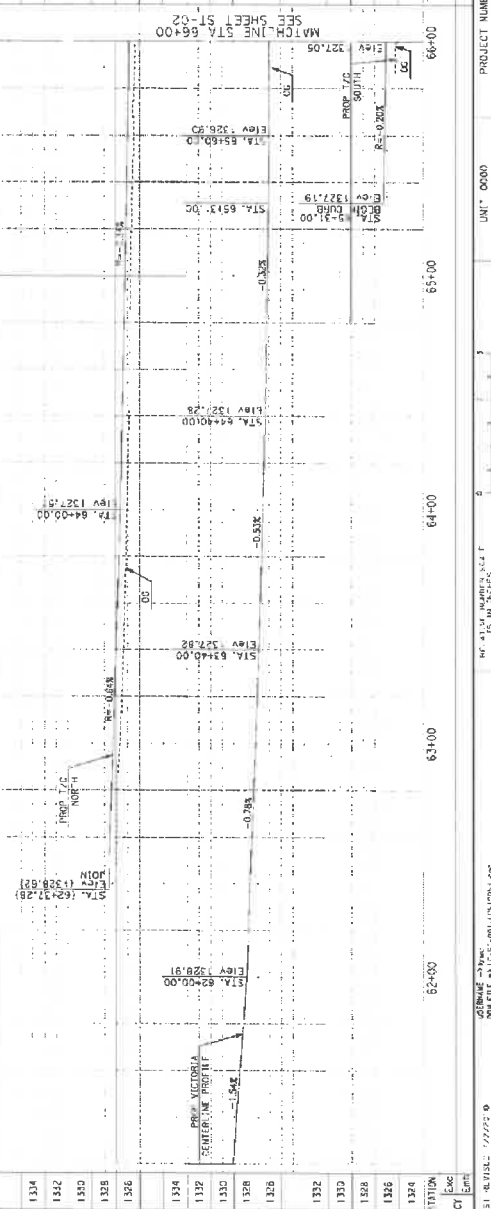
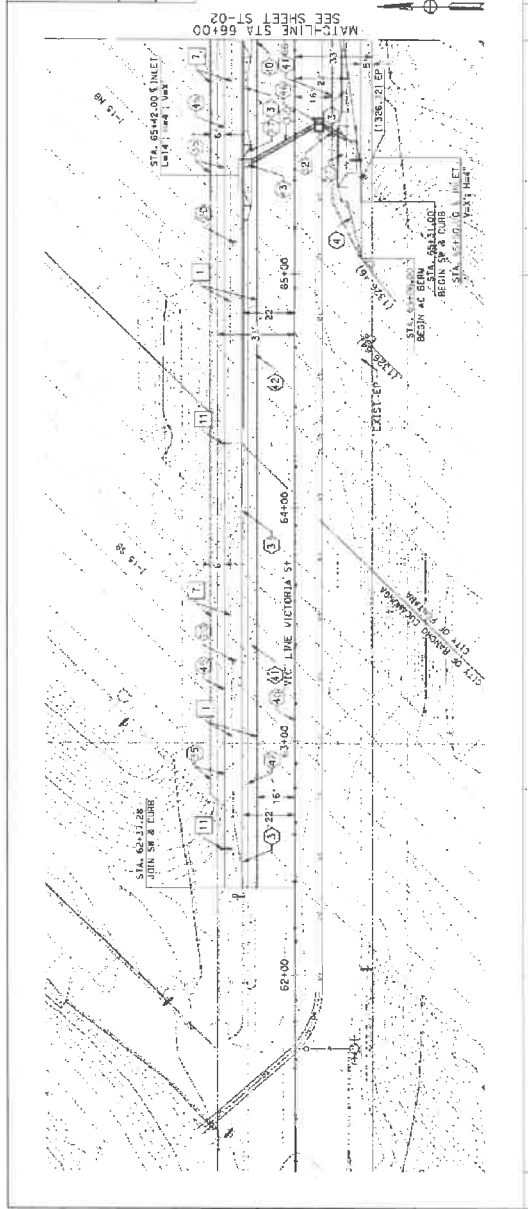

STATION	PROJECT NUMBER & PHASE	UNIT
1324		0000
1328		0000
1332		0000
1336		0000
1340		0000
1344		0000
1348		0000
1352		0000
1356		0000
1360		0000
1364		0000
1368		0000
1372		0000
1376		0000
1380		0000
1384		0000
1388		0000
1392		0000
1396		0000
1400		0000
TOTAL		

UNIT	COUNTY	ROUTE	POST MILES	PROJECT	NO.	DATE
08	SBDO	15	7.2715	XX	XX	XY

REGISTERED CIVIL ENGINEER DATE

PLANS APPROVAL DATE

BY: *[Signature]*
DATE: 07/15/19

FOR: *[Signature]*
DATE: 07/15/19

PROJECT: *[Signature]*
DATE: 07/15/19

CONTRACT NO. 130000000001

SAN BERNARDINO COUNTY
 TRANSPORTATION DIVISION
 315 WEST G ST., SUITE 100
 SAN BERNARDINO, CA 92410

CONSTRUCTION NOTES
 SEE ST-03

CURVE DATA			
NO.	R	Δ	L
①	100.00'	11° 11.01'	19.43' 9.15'
②	100.00'	8° 0' 16.42"	13.97' 7.00'

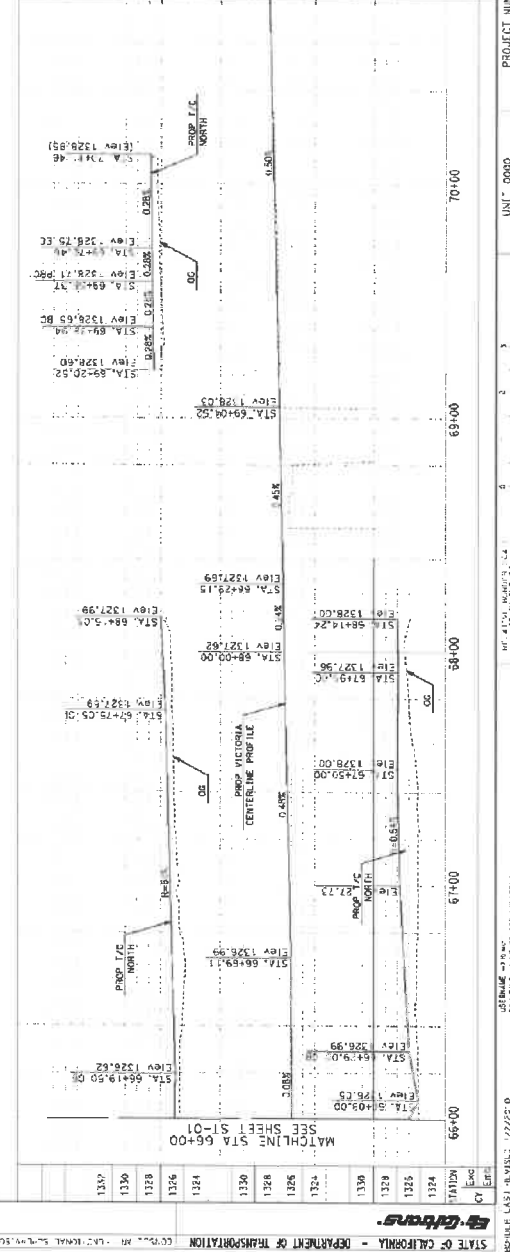
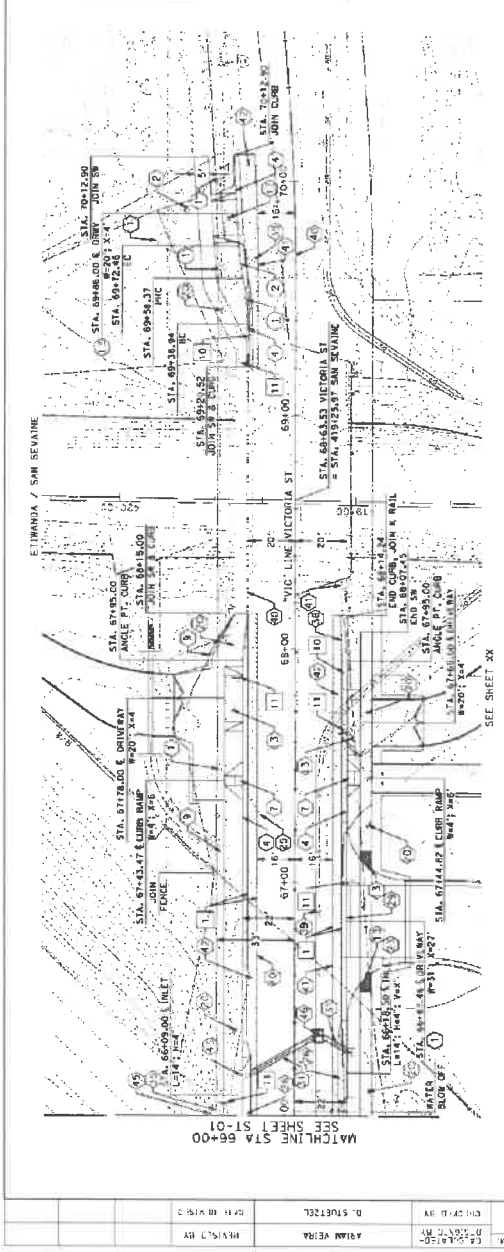

STREET IMPROVEMENT PLANS

SCALE: Horiz 1" = 20'
 Vert 1" = 4'

ST-02

NO.	DESCRIPTION	AMOUNT
1330		
1328		
1326		
1324		
1322		
1320		
1318		
1316		
1314		
1312		
1310		
1308		
1306		
1304		
1302		
1300		
TOTAL		

