

WARNING: ALL INDIVIDUALS INTERESTED IN BIDDING ON THIS PROJECT MUST OBTAIN THE FINAL PLANS AND SPECIFICATIONS FROM THE DEPARTMENT MANAGING THE PROJECT OR AS OTHERWISE STATED IN THE ADVERTISEMENT FOR BIDS FOR THE PROJECT. DO NOT USE THE PLANS AND SPECIFICATIONS POSTED ON THE CLERK OF THE BOARD'S WEBSITE FOR BIDDING ON THIS PROJECT.

SAN BERNARDINO COUNTY DEPARTMENT OF PUBLIC WORKS



TRANSPORTATION PLANS FOR CONSTRUCTION ON 5TH STREET AND PEDLEY ROAD LIMITS INTERSECTION OF PEDLEY ROAD AND 5TH STREET

WORK ORDER NO. H15139 ROAD NO. 349950-016, 646300-010

LENGTH = 0.04 MILES

NOT FOR BIDDING

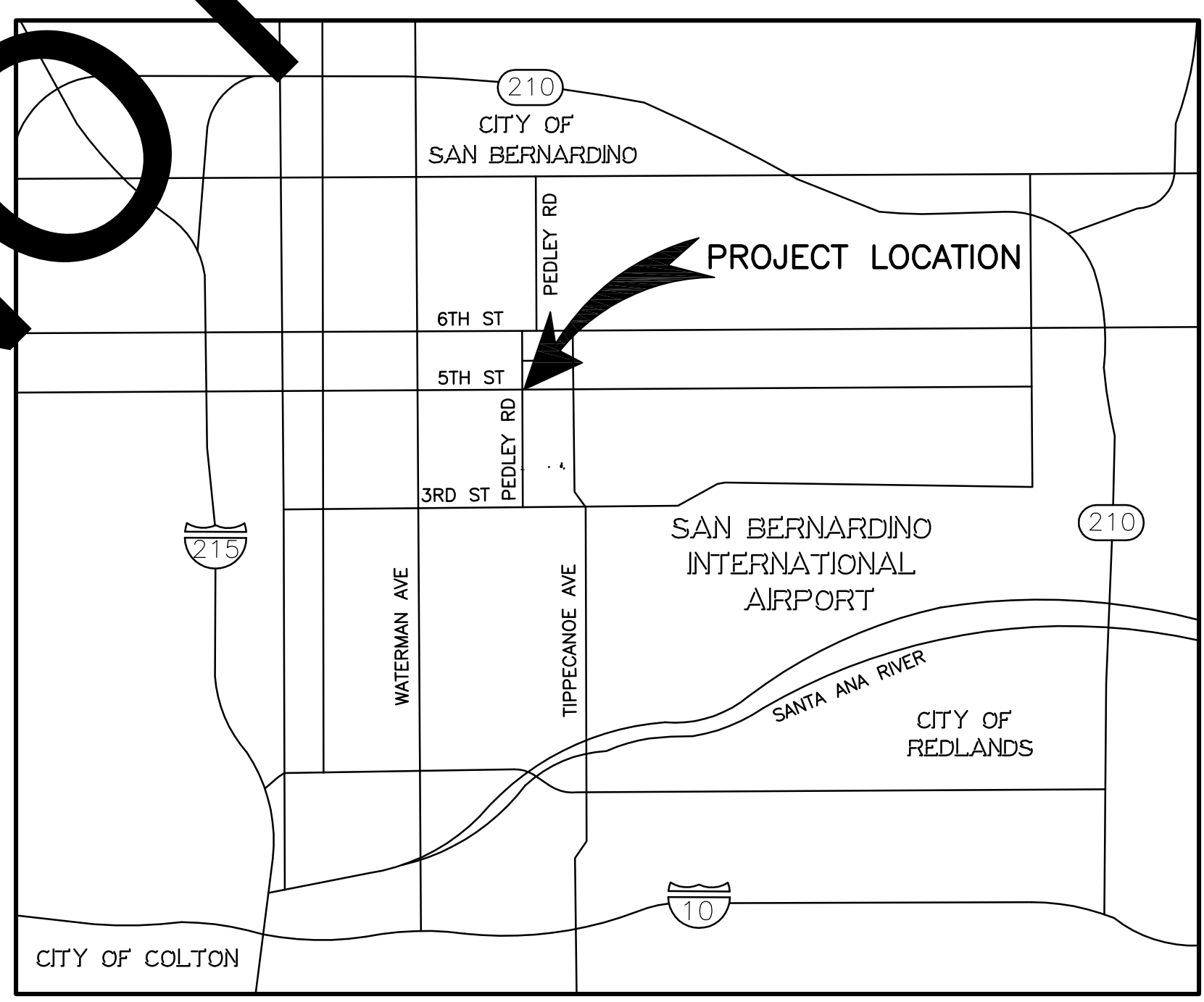

LOCATION MAP
NOT TO SCALE

CITY OF SAN BERNARDINO

APPROVED BY: Daniel Hernandez 8/29/2023
DANIEL HERNANDEZ AGENCY DIRECTOR OF PUBLIC WORKS, OPERATIONS, AND MAINTENANCE DATE

SAN BERNARDINO COUNTY

APPROVED BY: Brendon P. Biggs 8/31/2023
BRENDON P. BIGGS, M.S., P.E., DIRECTOR OF PUBLIC WORKS R.C.E. 57127 DATE
APPROVED BY: Noel Castillo 8/31/23
NOEL CASTILLO, P.E., ASSISTANT DIRECTOR OF PUBLIC WORKS R.C.E. 78044 DATE

MARK	REVISIONS	APPR.	DATE

FILE NO. 349950-016, 646300-010

MARK	CHANGES	RESIDENT ENGINEER	DATE
	NO CHANGES		
FIELD CHANGES		SHT. NO.	TOT. SHT'S.
		1	7

INDEX OF SHEETS

- 1 TITLE SHEET
2 PROJECT NOTES, INDEX MAP, AND LEGENDS
3 TYPICAL SECTIONS AND MISC. DETAILS
4 STREET IMPROVEMENT PLANS-PLAN AND PROFILE
5 CURB RETURN DETAILS
6 TRAFFIC SIGNING AND STRIPING PLAN
7 TRAFFIC SIGNAL AND LIGHTING PLAN
1 X-SECTIONS

THE FOLLOWING SPECIAL DRAWINGS AND COUNTY STANDARDS ARE ATTACHED TO THE SPECIAL PROVISIONS:

- STD 109, TYPE C (MOD) STD 117 STD 119 (MOD)
115 (MOD) 116 (MOD) 303A 303B

TO BE SUPPLEMENTED BY THE FOLLOWING CALTRANS STANDARD PLANS 2018.

- A87A TYPE A1-6 A87A TYPE A1-8 A88A A88B A20A
A20B A20D A24A A24D A24E A24F ES-2C
ES-3B ES-7P

TO BE SUPPLEMENTED BY THE FOLLOWING CITY OF SAN BERNARDINO STANDARD PLANS.

202, CASE A

TO BE SUPPLEMENTED BY THE FOLLOWING CALTRANS STANDARD PLANS 2022.

- ES-1A ES-1B ES-1C ES-5C ES-2E ES-3B ES-4B
ES-5C ES-7A ES-7B ES-7N ES-7R ES-8A ES-8B
T9 T10 T11 T13

TO BE SUPPLEMENTED BY THE FOLLOWING CA MUTCD 2014 REVISION 6.

- FIG 2A-2(CA) FIG 6H-28 FIG 6H-29
SEC 3B.24 SEC 3B.26 SEC 3B.101(CA)
SEC 6D.01 SEC 6D.02 SEC 6D.03

THIS PROJECT REQUIRES A CONTRACTOR'S LICENSE CLASS "A" OR CLASS "C10"

GENERAL NOTES

U. THE FACT THAT ANY UTILITY FACILITY IS SHOWN OR NOT SHOWN UPON THE PLANS SHALL NOT RELIEVE THE CONTRACTOR OF THE RESPONSIBILITY UNDER SECTION 5-1.36 C "NON-HIGHWAY FACILITIES" OF THE CALTRANS STANDARD SPECIFICATIONS.

- 1. ALL STATIONING NOTES ON PLAN REFER TO THE CL IMP 5TH STREET & PEDLEY ROAD OR SIDE STREET.
2. DIMENSIONS ARE SUBJECT TO TOLERANCES SPECIFIED IN THE CALTRANS STANDARD SPECIFICATIONS.
3. ALL PAVEMENT WIDTH DIMENSIONS SHOWN ON THE PLANS ARE TO THE EDGE OF PAVEMENT OR TO THE TOP OF CURB, UNLESS OTHERWISE NOTED.
4. TRANSITIONS AND WARPING SHALL BE AS SHOWN AND AS DETERMINED BY THE ENGINEER.
5. ASPHALT CONCRETE OVERLAYS SHALL BE FEATHERED TO MEET EXISTING AS SHOWN ON THE PLANS OR AS DETERMINED BY THE ENGINEER.
6. ALL TREES & VEGETATION OUTSIDE THE LIMITS OF EXCAVATION AND EMBANKMENT SLOPE LINES, SHALL BE PROTECTED IN PLACE.

BASIS OF BEARINGS:

THE CENTERLINE OF PEDLEY ROAD, FROM 3rd ST TO 4th ST (Pt#1-Pt#7) PER TR.2345, MB 33/52, BEING N00°14'00".

BENCH MARK:

FOUND RR SPIKE IN PP #1420442E, 50' E'LY & 20' N'LY OF INTERSECTION OF PEDLEY RD & LITTLE 3rd ST, PER CSFB 4017/2274 NGVD-29 ELEV=1052.89'

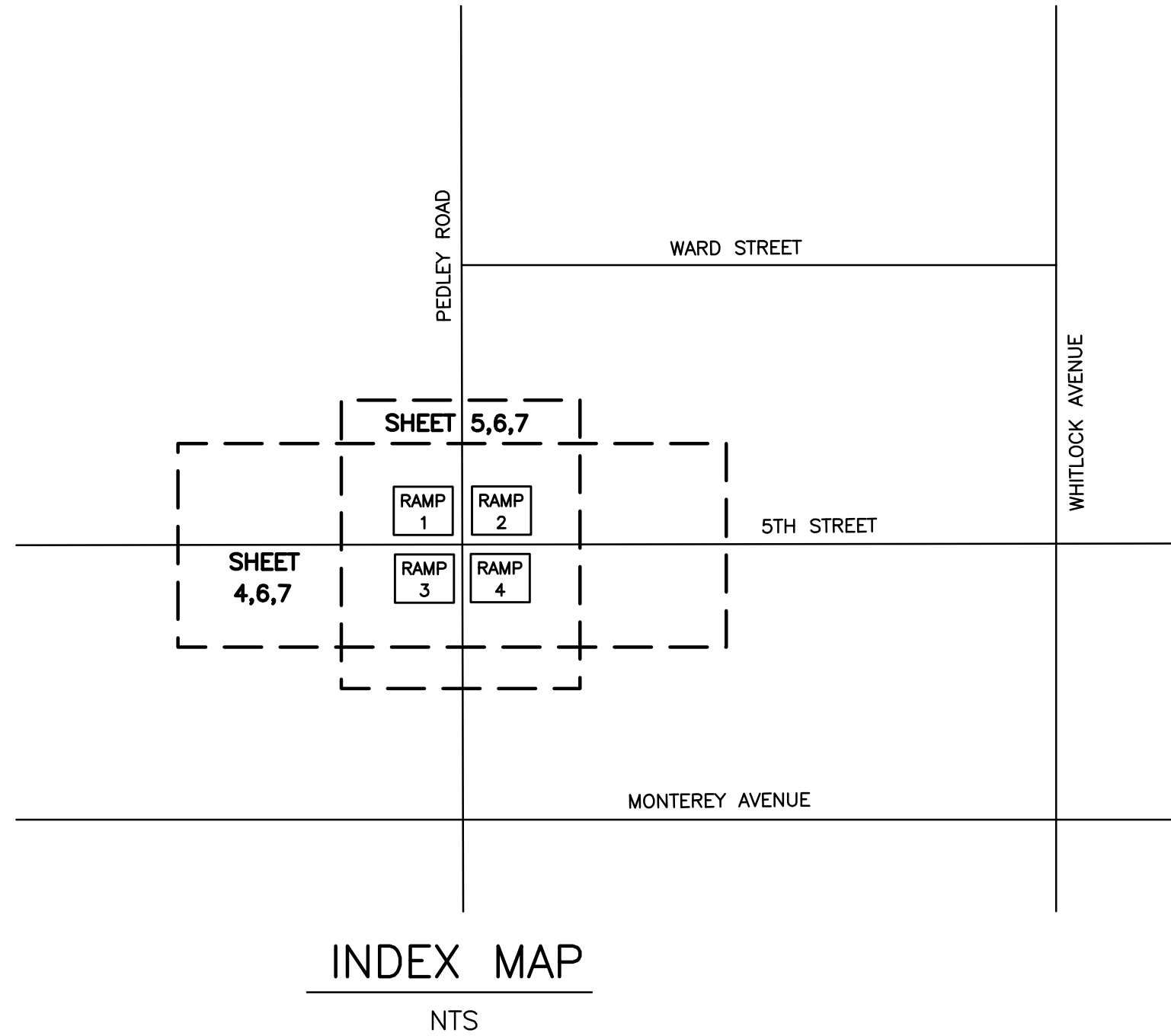

ABBREVIATIONS LEGEND:

- AB = AGGREGATE BASE
AC = ASPHALT CONCRETE
APP = APPROACH
BEG = BEGINNING
BVC = BEGIN VERTICAL CURVE
CL = CENTER LINE
CP# = CONTROL POINT
C&G = CURB & GUTTER
DWY = DRIVEWAY
ELEV = ELEVATION
EP = EDGE OF PAVEMENT
EXIST = EXISTING
EVC = END VERTICAL CURVE
FL = FLOW LINE
GB = GRADE BREAK
GRD = GROUND
IMP = IMPROVEMENT
INV = INVERT
LOC = LENGTH OF CURVE
LT = LEFT
MAX = MAXIMUM
MIN = MINIMUM
NTS = NOT TO SCALE
OG = ORIGINAL GROUND
PCC = PORTLAND CEMENT CONCRETE
PP = PERMIT TO ENTER CONSTRUCTION
PL = PROPERTY LINE
PP = POWER POLE
R/W = RIGHT OF WAY
SUR = SURVEY
SHT = SHEET
STA = STATION
S/O = SOUTH OF
S/W = SIDEWALK
TFC = TOP OF FACE OF CURB
THK = THICK
TYP = TYPICAL
VAR = VARIES
VC = VERTICAL CURVE

CONSTRUCTION & UNDERGROUND UTILITY LEGEND

- ASPHALT CONCRETE PAVEMENT
ASPHALT CONCRETE COLD PLANE AND OVERLAY
PORTLAND CEMENT CONCRETE (SECTION)
AGGREGATE BASE
PROPOSED SLOPE
EXISTING SLOPE
GAS LINE
SEWER MAIN
WATER LINE
ELECTRIC LINE
TELEPHONE LINE
RAMP NUMBER LABEL
CURB RETURN NUMBER

SAN BERNARDINO COUNTY TRAFFIC CONTROL GENERAL NOTES :

- 1- ALL SIGNING, STRIPING AND PAVEMENT MARKINGS SHALL BE IN CONFORMANCE WITH THE CALIFORNIA MUTCD LATEST EDITION.
2- ALL STRIPING AND PAVEMENT MARKINGS SHALL BE PAINTED IN CONFORMANCE WITH THE CALTRANS STANDARD PLANS LATEST EDITION.
3- ALL STRIPING (LONG LINE) AND PAVEMENT MARKINGS SHALL BE THERMOPLASTIC.
4- ALL SIGNS SHALL BE OF HIGH INTENSITY (FHWA TYPE III/IV) RETRO-REFLECTIVE SHEETING EXCEPT:
A. "STOP" SIGNS SHALL BE DIAMOND GRADE (FHWA TYPE VII IN RURAL SETTINGS AND TYPE IX IN URBAN SETTINGS) RETRO-REFLECTIVE SHEETING.
B. "NO PARKING " SIGNS SHALL BE OF SUPER ENGINEERING GRADE (FHWA TYPE I) RETRO-REFLECTIVE SHEETING.
C. SCHOOL SIGNS SHALL BE OF DIAMOND GRADE (FHWA TYPE IX) FLUORESCENT YELLOW-GREEN (FYG) RETRO-REFLECTIVE SHEETING.
D. STREET NAME MARKERS SHALL BE OF DIAMOND GRADE (FHWA TYPE IX) RETRO-REFLECTIVE SHEETING AND CONFORM TO COUNTY STANDARD 303.
E. CONSTRUCTION SIGNS SHALL BE OF DIAMOND GRADE (FHWA TYPE IX) FLUORESCENT ORANGE RETRO-REFLECTIVE SHEETING.
5- ALL DELINEATORS, CHANNELIZERS, AND OBJECT MARKERS SHALL BE OF (FHWA TYPE VII) RETRO-REFLECTIVE SHEETING.
6- SIGNS SHALL BE MOUNTED ON METAL POSTS SIMILAR TO COUNTY STANDARDS 303(a) AND 303(b).
7- ALL CONFLICTING STRIPING AND PAVEMENT MARKINGS SHOWN ON PLANS SHALL BE REMOVED BY THE CONTRACTOR. REMOVAL SHALL BE FIELD BY SANDBLASTING, GRINDING, OR AS DIRECTED BY COUNTY REPRESENTATIVE.
8- ALL CONFLICTING STRIPING AND PAVEMENT MARKINGS TO BE RELOCATED, OR COVERED BY THE CONTRACTOR. RELOCATABLE SIGNS SHALL BE INSTALLED AS SPECIFIED ON THE PLANS OR AS DIRECTED BY COUNTY REPRESENTATIVE.
9- ALL UNPROTECTED LOCATIONS RESULTING IN ISOLATED ABRUPT DEPRESSIONS OR ELEVATED OBJECTS (I.E. CATCH BASINS, HEADWALLS, POWER POLES, END TREATMENT OF ASPHALT DIKES AND CONCRETE CURBS) SHALL BE PROTECTED BY DELINEATORS OR BARRIERS PER THE CALIFORNIA MUTCD LATEST EDITION.
10- ALL EXISTING SIGNING, STRIPING AND PAVEMENT MARKINGS (I.E. CROSS STREET STOP, STOP LIMIT LINE, AND CROSSWALK PAVEMENT MARKINGS) NOT SHOWN ON PLANS, IF REMOVED/OBLITERATED, SHALL BE REPLACED/RESTORED OF SAME KIND, AND IN CONFORMANCE WITH THE CALIFORNIA MUTCD LATEST EDITION.
11- THE CONTRACTOR SHALL NOTIFY COUNTY REPRESENTATIVE TO SCHEDULE A FINAL REVIEW (WALK THROUGH) WITH TRAFFIC DIVISION PERSONNEL FOR APPROVAL OF TRAFFIC CONTROL DEVICES PRIOR TO PROJECT ACCEPTANCE.

CONSTRUCTION NOTES:

- U UTILITIES TO BE RESET BY OTHERS (SEE NOTE U. OF GENERAL NOTES ON THIS SHEET).
P PROTECT IN PLACE.
1 EXCAVATE THE NATIVE MATERIAL TO A DEPTH OF 1.15' BELOW THE TOP FINISHED PAVED ROAD, AND THEN COMPACT.
2 PLACE 0.60' OF CLASS II AGGREGATE BASE OR QUALIFIED PULVERIZED MATERIAL OVER NATIVE AND COMPACT. APPLY PRIME COAT. PLACE 0.35' OF TYPE A, 3/4" AGGREGATE GRADATION, PG 70-10 HOT MIX ASPHALT. APPLY TACK COAT. PLACE 0.20' OF TYPE G, 3/4" AGGREGATE GRADATION, PG 64-16 RUBBERIZED HOT MIX ASPHALT.
3 SAWCUT, REMOVE AND DISPOSE OF EXISTING CONCRETE CURB, GUTTER, SIDEWALK, DRIVEWAY AND RAMP.
4 SAWCUT, REMOVE AND DISPOSE OF EXISTING ASPHALT DIKE AND ASPHALT CONCRETE.
5 CONSTRUCT CURB RAMP PER CALTRANS STD 2018 RSP A88A OR A88B, CASE PER PLAN.
6 PLACE DETECTABLE WARNING SURFACE PER CALTRANS STANDARD PLAN RSP A88A.
7 CONSTRUCT 6" CONC SIDEWALK PER SAN BERNARDINO COUNTY STD 109, TYPE C. (MOD) (4" MIN. CLEARANCE AROUND PP. WIDEN SIDEWALK IF NECESSARY.)
8 CONSTRUCT 8" CURB AND GUTTER PER COUNTY STD 115 (MODIFIED).
9 INSTALL 8" AC DIKE PER COUNTY STD. 117.
10 CONSTRUCT 6" CURB PER CALTRANS STANDARD A87A, TYPE A1-6.
11 REMOVE ROADSIDE SIGN AS SHOWN ON SIGNING AND STRIPING PLANS.
12 ADJUST UTILITY BOX, MANHOLE, AND WATER VALVE TO GRADE.
13 COLD PLANE (0.20" THK) EXISTING ASPHALT CONCRETE PAVEMENT (2' WIDE MIN).
14 PLACE (0.20") HMA, TYPE A 1/2" AGGREGATE GRADATION, PG 64-16, ASPHALT CONCRETE OVERLAY (TACK COAT BETWEEN ALL LAYERS).
15 CONSTRUCT CONCRETE DRIVEWAY (WIDTH, W-PER PLAN) PER SAN BERNARDINO COUNTY SPEC DWG 135b.
16 CONSTRUCT CONCRETE PAD DETAIL "D" AS SHOWN ON SHEET 3.
17 CONSTRUCT CROSS GUTTER AND SPANDREL PER SAN BERNARDINO COUNTY STD. 119 (MOD)
18 CONSTRUCT 6" CURB AND GUTTER PER COUNTY STD 116 (MODIFIED).
19 CONSTRUCT PCC SIDEWALK PER CITY OF SAN BERNARDINO STD. 202, CASE A.

TRAFFIC CONSTRUCTION NOTES:

- P PROTECT IN PLACE.
50 APPLY 12-INCH WIDE, SOLID WHITE LIMIT LINE PER CALTRANS 2022 STANDARD PLAN A24E.
51 APPLY 12-INCH WIDE YELLOW CROSSWALK LINES (LADDER TYPE)(2 FT PAINT, 2FT GAPS) PER CALTRANS 2022 STANDARD PLAN A24F.
52 APPLY DOUBLE 6-INCH WIDE, CENTER LINE STRIPE PER CALTRANS 2022 STANDARD PLAN A20A, DETAIL 22.
53 APPLY DOUBLE 6-INCH WIDE, EDGE LINE STRIPE PER CALTRANS 2022 STANDARD PLAN A20B, DETAIL 27B.
54 APPLY DOUBLE 8-INCH WIDE, CHANNELIZING STRIPE PER CALTRANS 2022 STANDARD PLAN A20D, DETAIL 38.
55 APPLY 6-INCH WIDE, BIKE LANE STRIPE PER CALTRANS 2022 STANDARD PLAN A20D, DETAIL 39.
56 APPLY 6-INCH WIDE, DASHED BIKE LANE STRIPE PER CALTRANS 2022 STANDARD PLAN A20D, DETAIL 39A.
57 APPLY TYPE IV ARROW PER CALTRANS 2022 STANDARD PLAN A24A AS SHOWN ON PLAN.
58 APPLY/REAPPLY PAVEMENT MARKING PER CALTRANS 2022 STANDARD PLAN A24D.
59 APPLY BIKE LANE MARKINGS AND ARROW PER CALTRANS 2022 STANDARD PLAN A24A AND A24D, AND BIKE LANE DETAIL ATTACHED HEREON.
60 INSTALL NEW SIGN AS SHOWN ON PLAN AND PER THE CALIFORNIA MUTCD 2014 FIGURE 2A-2(CA).
61 RESET ROADSIDE SIGNS PER THE CA MUTCD 2014, FIGURE 2A-2(CA).
62 REMOVE EXISTING STRIPING OR PAVEMENT MARKINGS.
63 RELOCATE ROADSIDE SIGNS AS SHOWN ON PLAN PER THE CA MUTCD 2014, FIGURE 2A-2(CA).
64 APPLY 8-INCH WHITE HATCH MARKING AT 45' PER THE CA MUTCD SECTION 3B.24, REMOVE CONFLICTING PORTION OF HATCH MARKINGS WITHIN BIKE LANE.
65 APPLY 6" WHITE DASHED BIKE LANE STRIPES AND GREEN PAINT PER CALTRANS 2022 STANDARD PLAN A20A, DETAIL 39A AND DETAIL HEREON.
66 REMOVE ROADSIDE SIGN.

FILE NO. 349950-016, 646300-010

FILE NO. 349950-016, 646300-010

CITY OF SAN BERNARDINO
APPROVED BY: Daniel Hernandez 8/29/2023
DANIEL HERNANDEZ
AGENCY DIRECTOR OF PUBLIC WORKS, OPERATIONS, AND MAINTENANCE

Table with 2 columns: MARK, CHANGES. Includes a section for FIELD CHANGES.

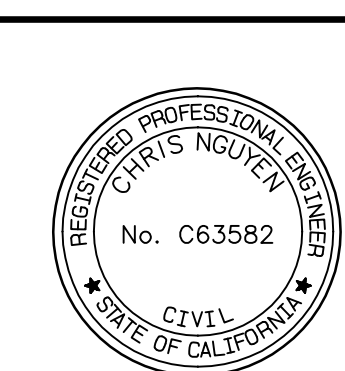

SAN BERNARDINO COUNTY
DEPARTMENT OF PUBLIC WORKS
DESIGNED BY: MDV DRAWN BY: MDV CHECKED BY: DJ
RECOMMENDED BY: Chris Nguyen, P.E.
APPROVED BY: Thomas Bustamonte, P.E. 8/17/23

5TH ST AND PEDLEY RD
PROJECT NOTES, INDEX MAP, AND LEGENDS
SAN BERNARDINO AREA
J.L. REF. W.O. NO. PLAN SCALE SHT. NO. TOT. SHT'S.
J.L.12088 H15189 NTS 2 7

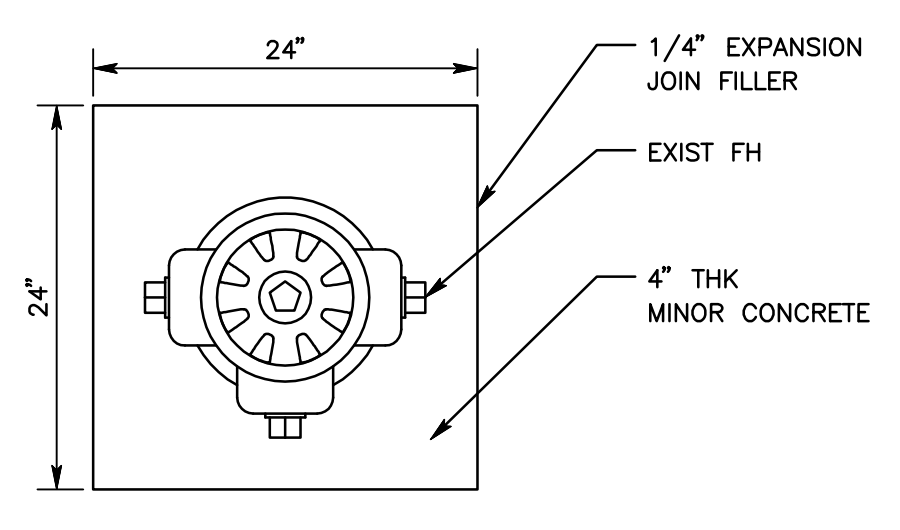
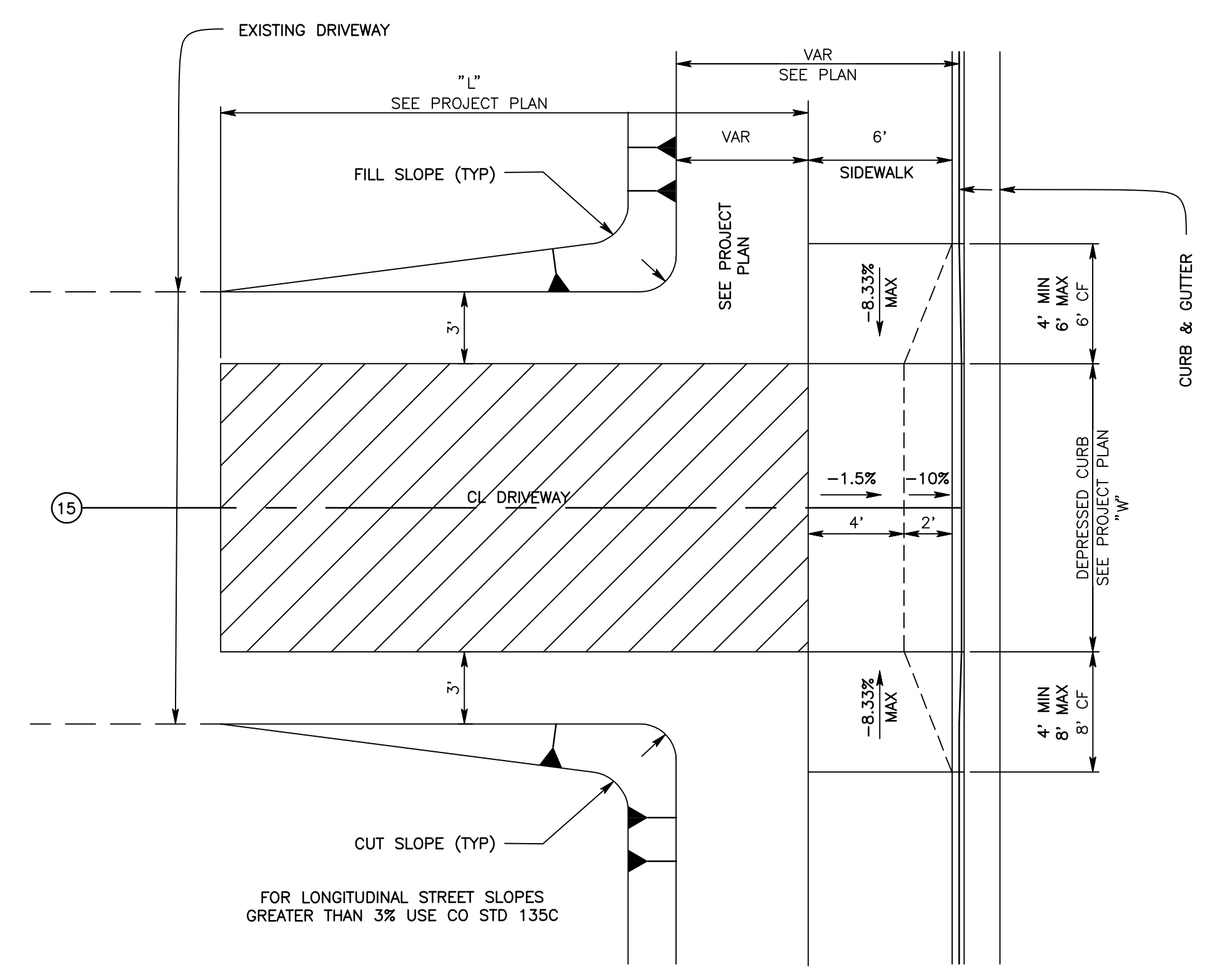
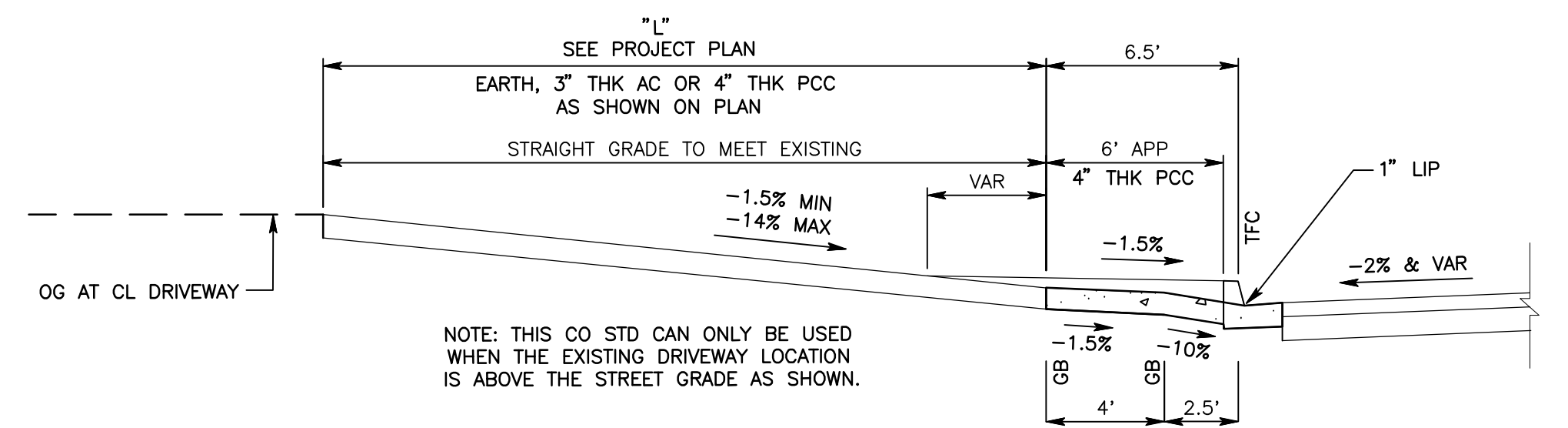
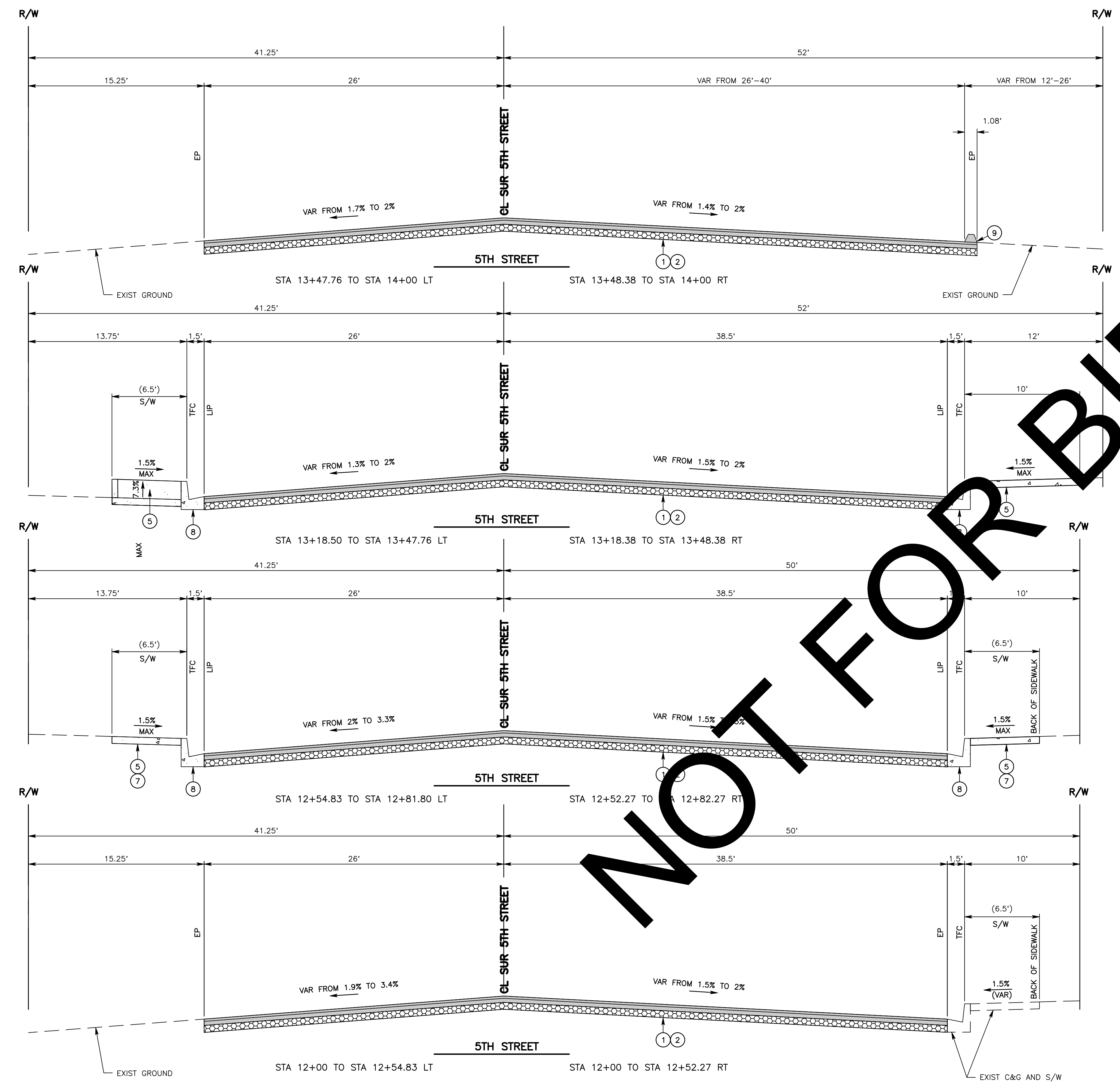

- CONSTRUCTION NOTES:**
- EXCAVATE THE NATIVE MATERIAL TO A DEPTH OF 1.15' BELOW THE TOP FINISHED PAVED ROAD, AND THEN COMPACT.
 - PLACE 0.60' OF CLASS II AGGREGATE BASE OR QUALIFIED PULVERIZED MATERIAL OVER NATIVE AND COMPACT. APPLY PRIME COAT. PLACE 0.35' OF TYPE A, 3/4" AGGREGATE GRADATION, PG 70-10 HOT MIX ASPHALT. APPLY TACK COAT. PLACE 0.20' OF TYPE G, 3/4" AGGREGATE GRADATION, PG 64-16 RUBBERIZED HOT MIX ASPHALT.
 - CONSTRUCT CURB RAMP PER CALTRANS STD 2018 RSP A88A OR A88B, CASE PER PLAN.
 - CONSTRUCT 6" CONC SIDEWALK PER SAN BERNARDINO COUNTY STD 109, TYPE C. (MOD) (4' MIN. CLEARANCE AROUND PP. WIDEN SIDEWALK IF NECESSARY.)
 - CONSTRUCT 8" CURB AND GUTTER PER COUNTY STD 115 (MODIFIED).
 - INSTALL 8" AC DIKE PER COUNTY STD. 117.
 - CONSTRUCT CONCRETE DRIVEWAY (WIDTH, W-PER PLAN) PER SAN BERNARDINO COUNTY SPEC DWG 135b (SEE SHEET 3).
 - CONSTRUCT CONCRETE PAD DETAIL "D" AS SHOWN HEREIN.

CITY OF SAN BERNARDINO
 APPROVED BY: *Daniel Hernandez* 8/29/2023
 DANIEL HERNANDEZ
 AGENCY DIRECTOR OF PUBLIC WORKS, OPERATIONS, AND MAINTENANCE

MARK	CHANGES	RESIDENT ENGINEER	DATE
	NO CHANGES		

FIELD CHANGES



SAN BERNARDINO COUNTY
 DEPARTMENT OF PUBLIC WORKS

DESIGNED BY: MDV DRAWN BY: MDV CHECKED BY: DJ RECOMMENDED BY: *Chris Nguyen*
 THOMAS BUSTAMANTE, P.E. 8/17/23 THOMAS BUSTAMANTE, P.E. SUPERVISING ENGINEER DEPUTY DIRECTOR

5TH ST AND PEDLEY RD
 TYPICAL SECTIONS AND MISC. DETAILS
 SAN BERNARDINO AREA

J.L. REF.	W.O. NO.	PLAN SCALE	SHT. NO.	TOT. SHT'S.
J.L.12078	H15189	AS SHOWN	3	7

FILE NO. 349950-016, 646300-010

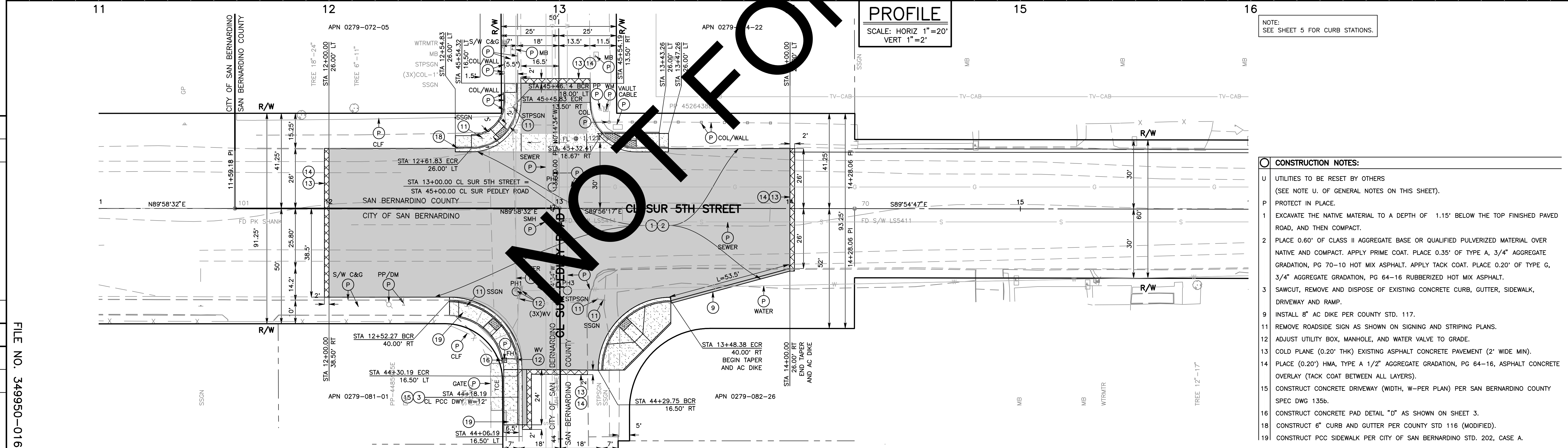
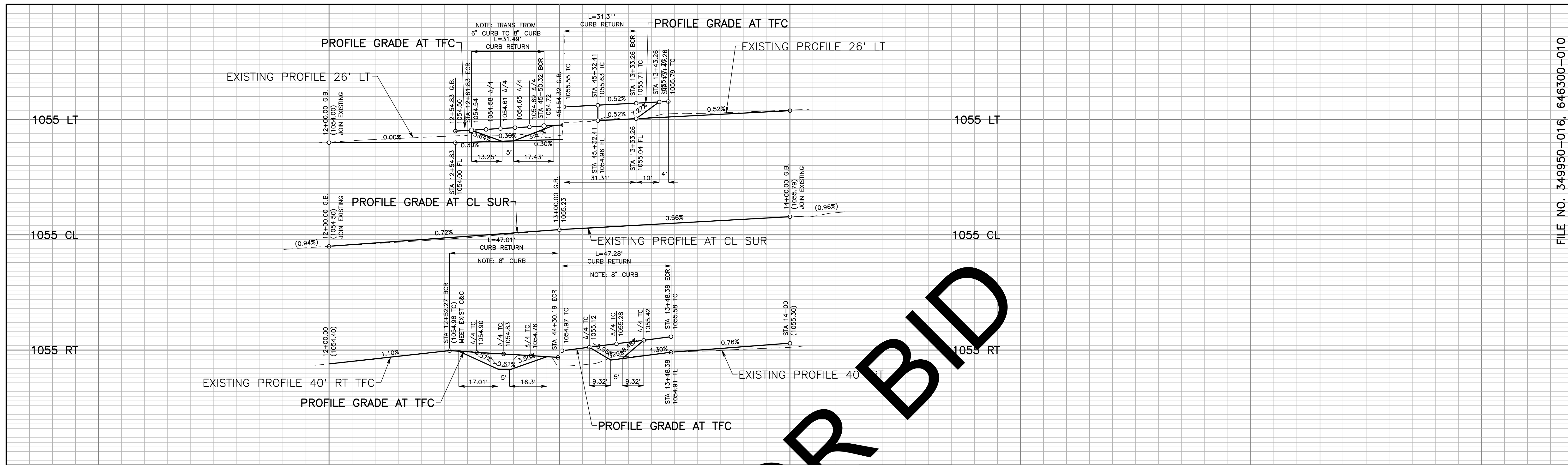

MARK	REVISIONS	APPR.	DATE

MARK	REVISIONS	APPR.	DATE

FILE NO. 349950-016, 646300-010

CITY OF SAN BERNARDINO
 APPROVED BY: *Daniel Hernandez* 8/29/2023
 DANIEL HERNANDEZ
 AGENCY DIRECTOR OF PUBLIC WORKS, OPERATIONS, AND MAINTENANCE

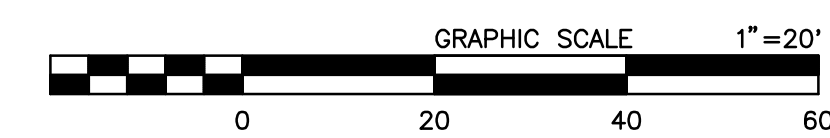

MARK	CHANGES	RESIDENT ENGINEER	DATE
	NO CHANGES		

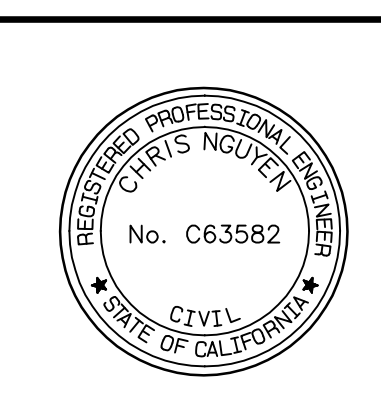

SAN BERNARDINO COUNTY DEPARTMENT OF PUBLIC WORKS			
DESIGNED BY: MDV	DRAWN BY: MDV	CHECKED BY: DJ	RECOMMENDED BY: <i>Chris Nguyen</i>
APPROVED BY: <i>Thomas Bustamante</i>			DATE: 8/17/23
THOMAS BUSTAMANTE, P.E. SUPERVISING ENGINEER			MERVIN N. MARRAL, P.E. DEPUTY DIRECTOR

5TH ST AND PEDLEY RD STREET IMPROVEMENT PLANS PLAN AND PROFILE FROM STA 12+00 TO STA 14+00 SAN BERNARDINO AREA				
J.L. REF.	W.O. NO.	PLAN SCALE	SHT. NO.	TOT. SHT'S.
J.L.12088	H15189	1"=20'	4	7

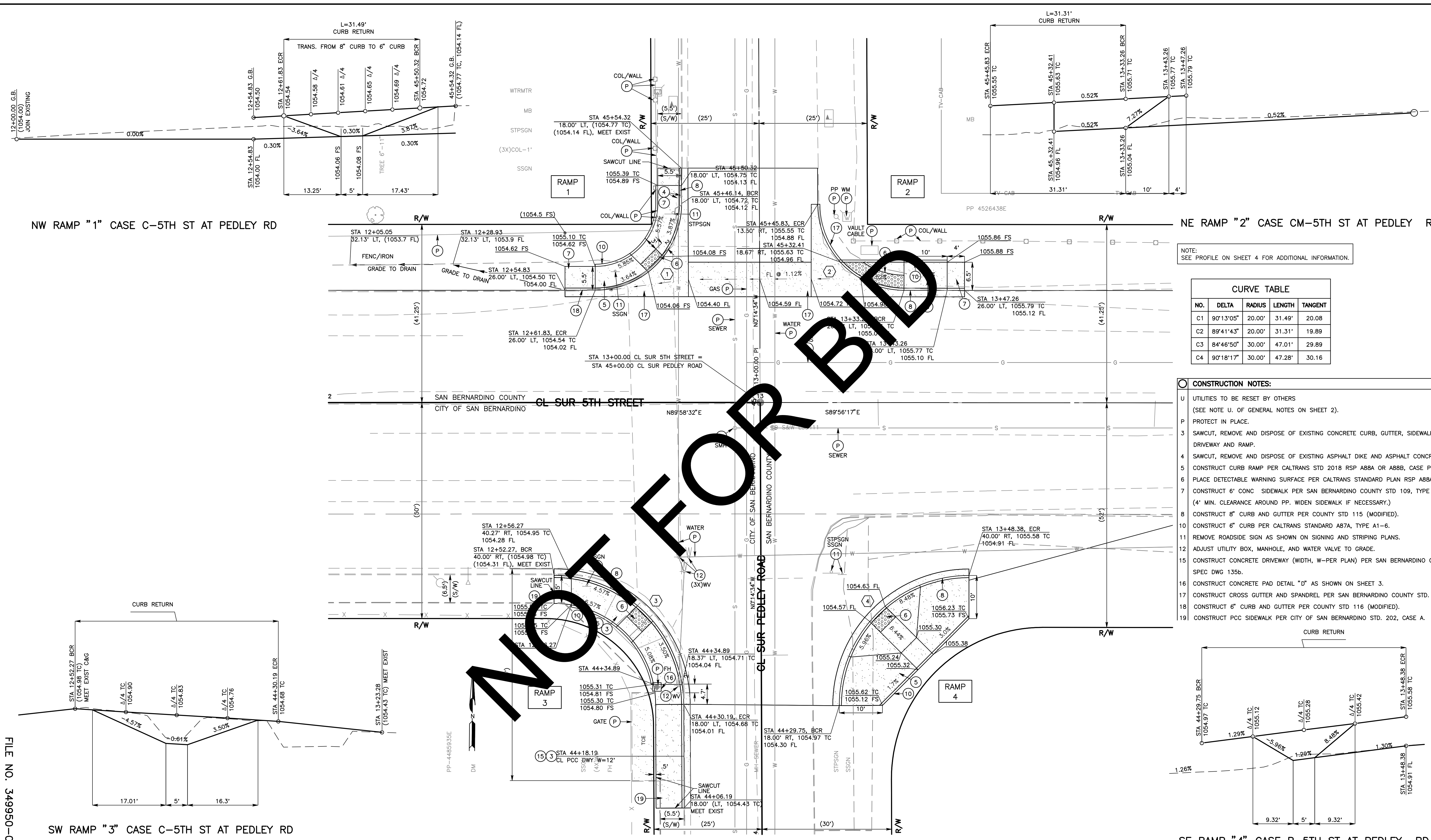

NW RAMP "1" CASE C-5TH ST AT PEDLEY RD

NE RAMP "2" CASE CM-5TH ST AT PEDLEY RD

SW RAMP "3" CASE C-5TH ST AT PEDLEY RD

SE RAMP "4" CASE B-5TH ST AT PEDLEY RD

NOTE: SEE PROFILE ON SHEET 4 FOR ADDITIONAL INFORMATION.

CURVE TABLE			
NO.	DELTA	RADIUS	TANGENT
C1	90°13'05"	20.00'	31.49'
C2	89°41'43"	20.00'	19.89'
C3	84°46'50"	30.00'	47.01'
C4	90°18'17"	30.00'	47.28'

- CONSTRUCTION NOTES:**
- U UTILITIES TO BE RESET BY OTHERS (SEE NOTE U. OF GENERAL NOTES ON SHEET 2).
 - P PROTECT IN PLACE.
 - 3 SAWCUT, REMOVE AND DISPOSE OF EXISTING CONCRETE CURB, GUTTER, SIDEWALK, DRIVEWAY AND RAMP.
 - 4 SAWCUT, REMOVE AND DISPOSE OF EXISTING ASPHALT DIKE AND ASPHALT CONCRETE.
 - 5 CONSTRUCT CURB RAMP PER CALTRANS STD 2018 RSP A88A OR A88B, CASE PER PLAN.
 - 6 PLACE DETECTABLE WARNING SURFACE PER CALTRANS STANDARD PLAN RSP A88A.
 - 7 CONSTRUCT 6" CONC SIDEWALK PER SAN BERNARDINO COUNTY STD 109, TYPE C. (MOD) (4' MIN. CLEARANCE AROUND PP. WIDEN SIDEWALK IF NECESSARY.)
 - 8 CONSTRUCT 8" CURB AND GUTTER PER COUNTY STD 115 (MODIFIED).
 - 10 CONSTRUCT 6" CURB PER CALTRANS STANDARD A87A, TYPE A1-6.
 - 11 REMOVE ROADSIDE SIGN AS SHOWN ON SIGNING AND STRIPING PLANS.
 - 12 ADJUST UTILITY BOX, MANHOLE, AND WATER VALVE TO GRADE.
 - 15 CONSTRUCT CONCRETE DRIVEWAY (WIDTH, W-PER PLAN) PER SAN BERNARDINO COUNTY SPEC DWG 135B.
 - 16 CONSTRUCT CONCRETE PAD DETAIL "D" AS SHOWN ON SHEET 3.
 - 17 CONSTRUCT CROSS GUTTER AND SPANDREL PER SAN BERNARDINO COUNTY STD. 119 (MOD)
 - 18 CONSTRUCT 6" CURB AND GUTTER PER COUNTY STD 116 (MODIFIED).
 - 19 CONSTRUCT PCC SIDEWALK PER CITY OF SAN BERNARDINO STD. 202, CASE A.

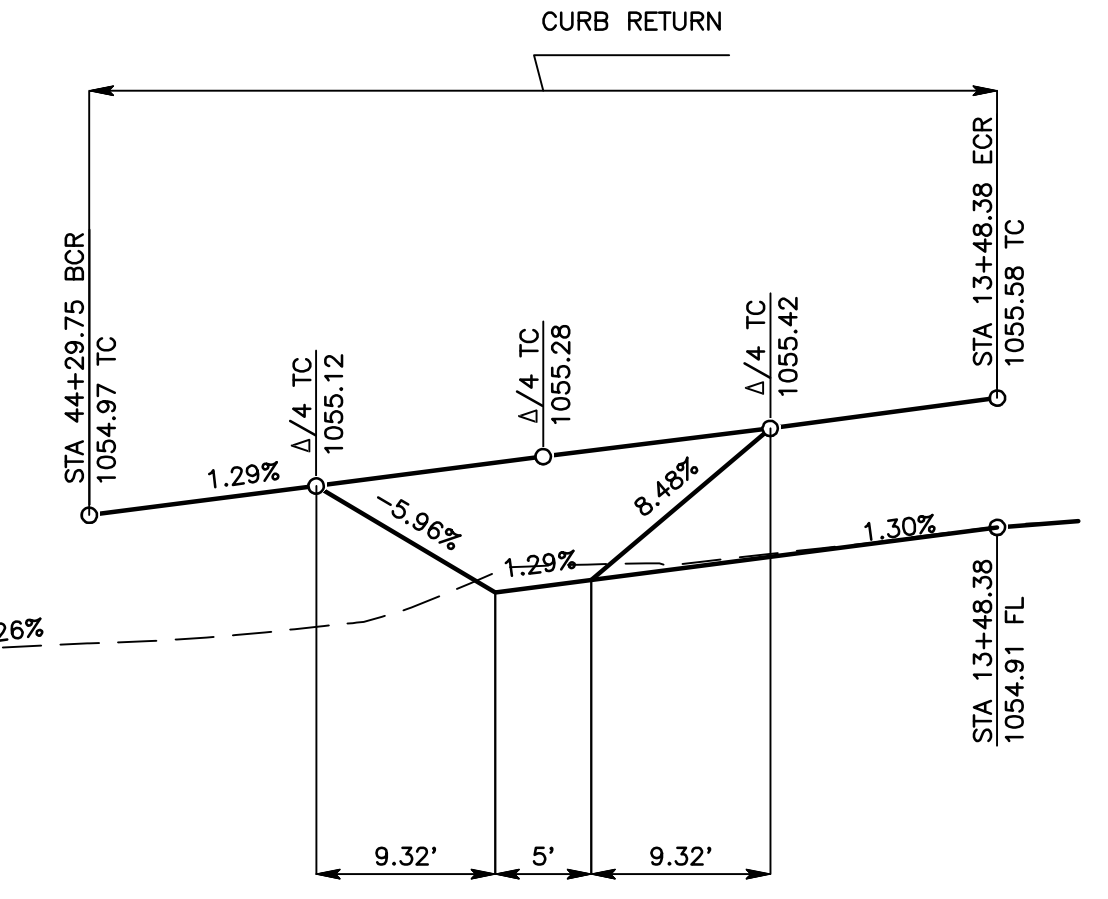

CAUTION:
 ALL STATIONING NOTES ON PLAN REFER TO THE C.L. SUR 5TH STREET OR PEDLEY ROAD. ELEVATIONS SHOWN HAVE BEEN CALCULATED FROM INTERPOLATED POINTS. IT WILL BE THE CONTRACTORS RESPONSIBILITY TO VERIFY ALL CURB RAMPS GRADES, DIMENSIONS, ELEVATIONS AND COMPLY WITH 2018 CALTRANS STANDARD RSP A88A. IF NECESSARY MAKE ADJUSTMENTS AS APPROVED BY THE ENGINEER.

CITY OF SAN BERNARDINO
 APPROVED BY: *Daniel Hernandez* 8/29/2023
 DANIEL HERNANDEZ DATE
 AGENCY DIRECTOR OF PUBLIC WORKS, OPERATIONS, AND MAINTENANCE

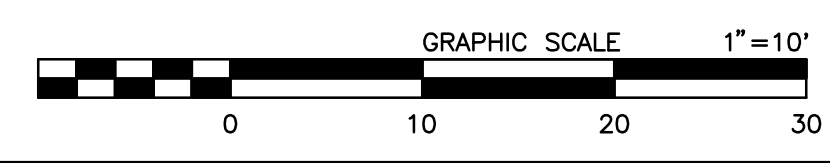

MARK	CHANGES	RESIDENT ENGINEER	DATE
	NO CHANGES		

FIELD CHANGES

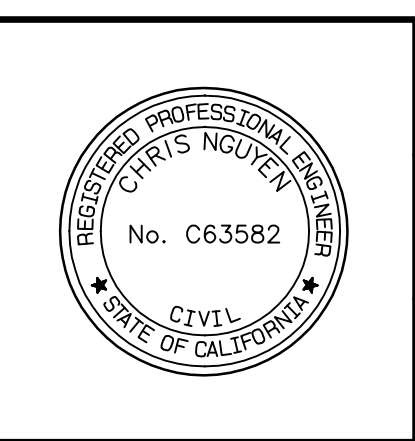

SAN BERNARDINO COUNTY
 DEPARTMENT OF PUBLIC WORKS
 DESIGNED BY: MDV DRAWN BY: MDV CHECKED BY: DJ RECOMMENDED BY: *Chris Nguyen*
 THOMAS BUSTAMANTE 8/17/23 DATE
 SUPERVISING ENGINEER DEPUTY DIRECTOR

5TH ST AND PEDLEY RD
 CURB RETURN DETAILS
 SAN BERNARDINO AREA
 J.L. REF. W.O. NO. PLAN SCALE SHI. NO. TOT. SHI'S
 J.L.12088 H15189 1"=10' 5 7

MARK	REVISIONS	APPR.	DATE

FILE NO. 349950-016, 646300-010

