

NOT FOR BID

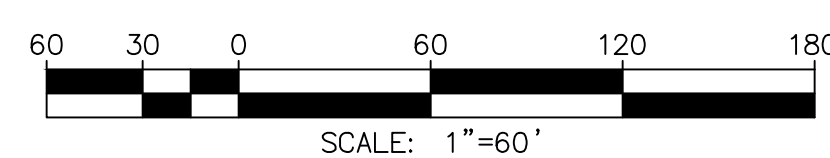
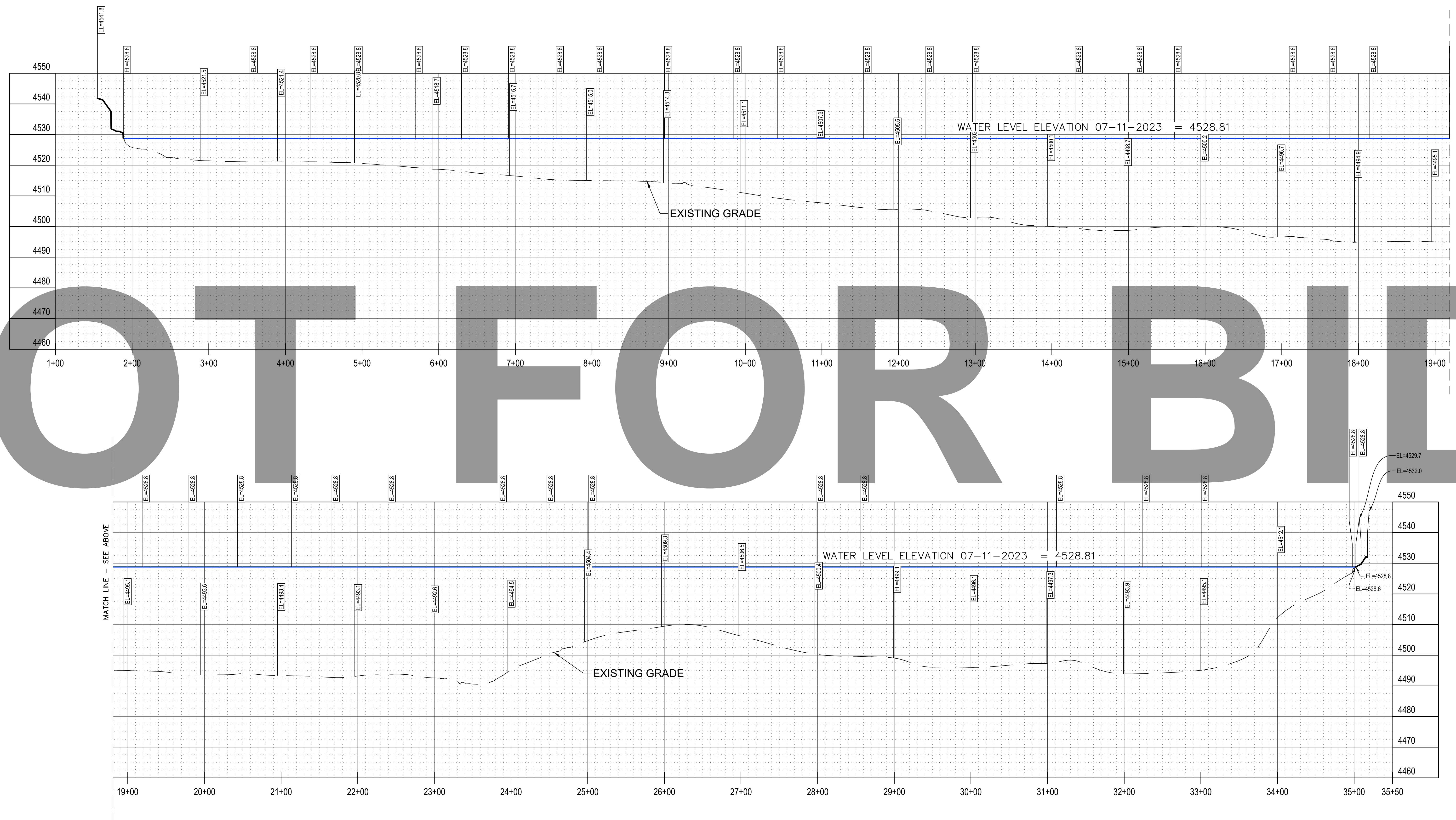

WEST - EAST PROFILE

SCALE: 1" = 60'

UNDERGROUND SERVICE ALERT
 Call: TOLL FREE
 1-800-227-2600
 OR
 811
 TWO WORKING DAYS BEFORE YOU DIG

BENCHMARK:
 ELEVATIONS SHOWN HEREON ARE EXPRESSED IN THE U.S. SURVEY FEET AND ARE REFERENCED TO THE NORTH AMERICA VERTICAL DATUM OF 1988 (NAVD88) AND DEFINED LOCALLY USING THE ORTHOMETRIC HEIGHT FOR CORS STATION EWPP. SITE BENCHMARK AT POINT NO. 7000 DERIVED FROM STATIC OBSERVATIONS. ELEVATION = 4587.05'

BASIS OF BEARINGS:
 BEARINGS SHOWN ON THIS MAP ARE REFERENCED TO THE CALIFORNIA COORDINATE SYSTEM, CCS83 (2011) EPOCH 2010.00, ZONE 05, DEFINED LOCALLY BY NGS PID'S EWPP, PS98, & P470 ACCORDING TO THE GEODETIC POSITIONS AS PUBLISHED BY NGS. ALL DISTANCES AND COORDINATES ARE REFERENCED TO CCS83 ZONE 05 GRID AND ARE EXPRESSED IN US SURVEY FOOT UNITS.

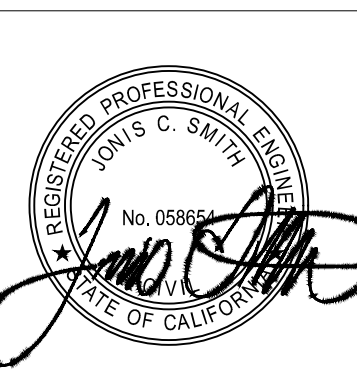

J. SMITH & T. MULI
 33161 Camino Capistrano, Suite D, San Juan Capistrano, CA 92675
 Phone: (949) 329.3639 • JSTMINC.COM
 JONIS C. SMITH 058854 09/08/2023
 PROFESSIONAL ENGINEER R.C.E. No. DATE

MARK	DATE	INITIAL	DESCRIPTION	APPR. DATE

PLANS APPROVED BY:
SAN BERNARDINO COUNTY - PUBLIC WORKS SPECIAL DISTRICTS

ASSISTANT DIRECTOR	DATE
PROJECT MANAGER	INITIAL
OPS. DIVISION MANAGER	DATE
PM. DIVISION MANAGER	

IMPROVEMENT PLANS
 LAKE GREGORY SITEWIDE SEDIMENT MANAGEMENT PROJECT
 SAN BERNARDINO COUNTY REGIONAL PARKS DEPARTMENT
 CRESTLINE, CALIFORNIA
 EXISTING CONDITION: WEST-EAST PROFILE

DWG NO. XX.XX.XXXX
 FILE NO. XXX-XXX
 SHEET 3 OF 17

C:\Users\Mu11\OneDrive - J. Smith & T. Muli, Inc\BKM\Operations\Projects\1025-3R1-3-4_EX_LAKE_GROSS_SECTIONS.dwg 08/07/24 - 3:49pm Mu11 11m

NOT FOR BID

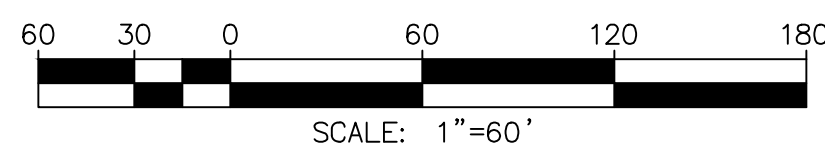
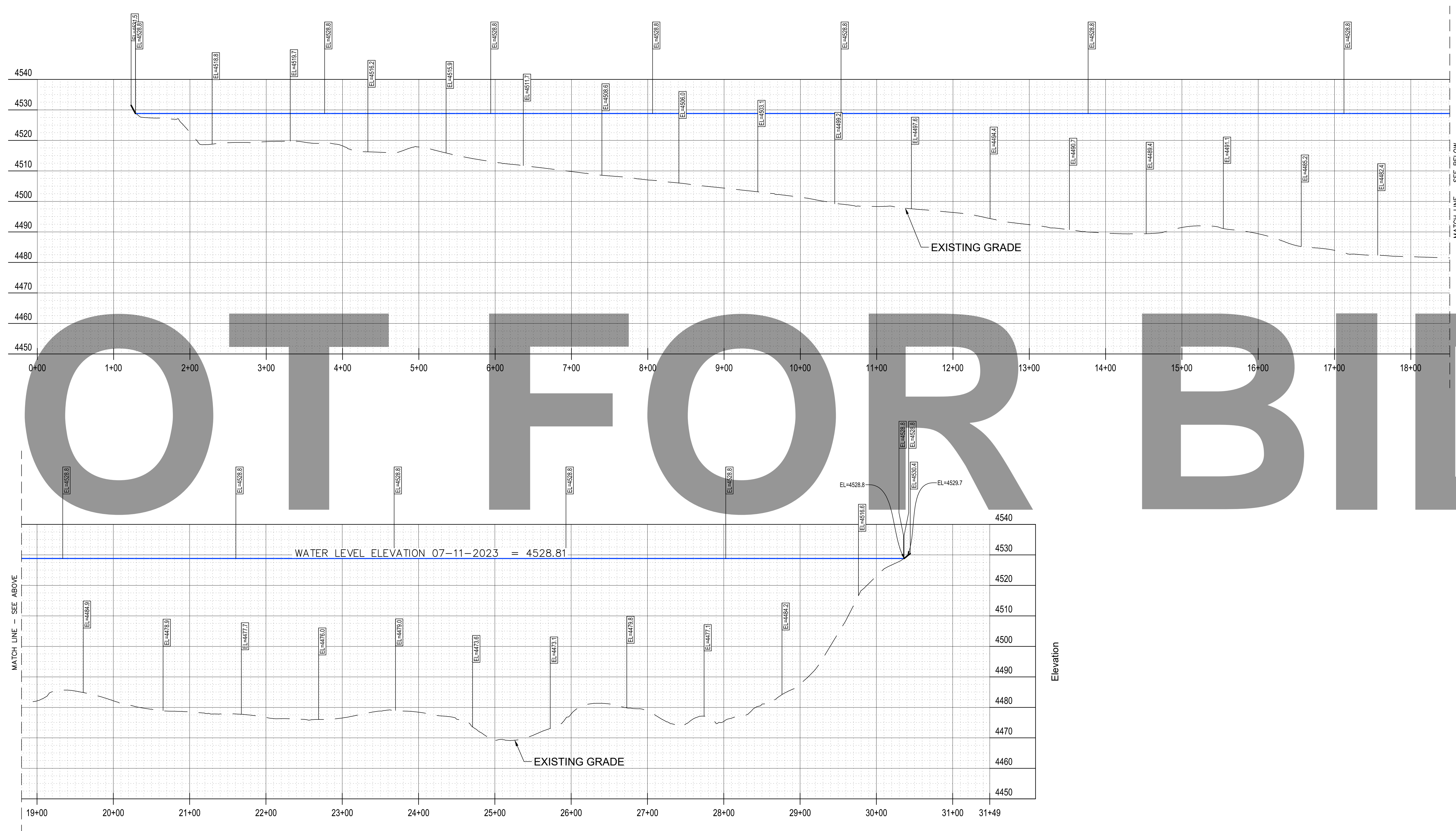

SOUTH - NORTH PROFILE
SCALE: 1" = 60'

UNDERGROUND SERVICE ALERT
Call: TOLL FREE
1-800-227-2600
OR
811
TWO WORKING DAYS BEFORE YOU DIG

BENCHMARK:
ELEVATIONS SHOWN HEREON ARE EXPRESSED IN THE U.S. SURVEY FEET AND ARE REFERENCED TO THE NORTH AMERICA VERTICAL DATUM OF 1988 (NAVD88) AND DEFINED LOCALLY USING THE ORTHOMETRIC HEIGHT FOR CORS STATION EWPP. SITE BENCHMARK AT POINT NO. 7000 DERIVED FROM STATIC OBSERVATIONS. ELEVATION = 4587.05'

BASIS OF BEARINGS:
BEARINGS SHOWN ON THIS MAP ARE REFERENCED TO THE CALIFORNIA COORDINATE SYSTEM, CCS83 (2011) EPOCH 2010.00, ZONE 05, DEFINED LOCALLY BY NGS PID'S EWPP, PS98, & P470 ACCORDING TO THE GEODETIC POSITIONS AS PUBLISHED BY NGS. ALL DISTANCES AND COORDINATES ARE REFERENCED TO CCS83 ZONE 05 GRID AND ARE EXPRESSED IN US SURVEY FOOT UNITS.



JONIS C. SMITH 058654 09/08/2023
PROFESSIONAL ENGINEER R.C.E. No. DATE

MARK	DATE	INITIAL	DESCRIPTION	APPR.	DATE

PLANS APPROVED BY:
SAN BERNARDINO COUNTY - PUBLIC WORKS
SPECIAL DISTRICTS

ASSISTANT DIRECTOR	DATE

APPROVALS

PROJECT MANAGER	INITIAL	DATE
OPS. DIVISION MANAGER		
PM. DIVISION MANAGER		

IMPROVEMENT PLANS
LAKE GREGORY SITEWIDE SEDIMENT MANAGEMENT PROJECT
SAN BERNARDINO COUNTY REGIONAL PARKS DEPARTMENT
CRESTLINE, CALIFORNIA
EXISTING CONDITION: SOUTH-NORTH PROFILE

DWG NO. XX.XX.XXXX
FILE NO. XXX-XXX
SHEET 4 OF 17



- LEGEND:**
- DREDGING BOUNDARY/ DAYLIGHT LINE
 - CUTOFF WALL LOCATION
 - NO SWIM/NO BOAT BOUY LINE
 - NO DIVING SIGN
 - SOIL CEMENT EROSION GAUGE CYLINDER

- CONSTRUCTION NOTES**
- 11 FURNISH AND INSTALL WHITE SAND BEACH FILL MATERIAL PER PLAN AND SPECIFICATIONS
 - 12 CONSTRUCT BEACH CONTAINMENT EMBANKMENT PER PLAN AND DETAIL A ON SHEET 13
 - 13 FURNISH AND INSTALL SIGN PER COUNTY OF SAN BERNARDINO ENVIRONMENTAL HEALTH SCIENCES DEPARTMENT OF PUBLIC HEALTH CONSTRUCTION GUIDE AND DETAIL 13 ON SHT 16
 - 15 WATER PARK GRADING PER PLAN AND DETAIL ON SHEET 13
 - 16 RELOCATE WATER PARK APPARATUS TO LOCATION SHOWN PER DIRECTION OF THE DISTRICT ENGINEER
 - 35 FURNISH AND INSTALL 10-INCH DIAM 4-FOOT CONTROLLED LOW STRENGTH MATERIAL (CLSM) EROSION GAGE CYLINDER PER PLAN PER DETAIL ON SHEET 13

- NOTES:**
1. THE LOCATIONS OF EXISTING UTILITIES AND SURFACE FEATURES ARE APPROXIMATE. CONTRACTOR SHALL FIELD VERIFY AND DOCUMENT THE LOCATIONS OF EXISTING UTILITIES AND SURFACE FEATURES IN THE VICINITY OF THE WORK BEFORE COMMENCING EARTHWORK.
 2. WATER SURFACE ELEVATION SHOWN ON PLANS IS APPROXIMATE. CONTRACTOR SHALL VERIFY WATER SURFACE ELEVATION BEFORE COMMENCING EARTHWORK.
 3. AERIAL IMAGERY SHOWN ON PLANS MAY VARY FROM CURRENT EXISTING CONDITIONS AND TOPOGRAPHIC INFORMATION.
 4. CONTRACTOR SHALL PROTECT IN PLACE ALL EXISTING SURFACE IMPROVEMENTS AND UTILITIES.

MATCHLINE - SEE SHEET 6

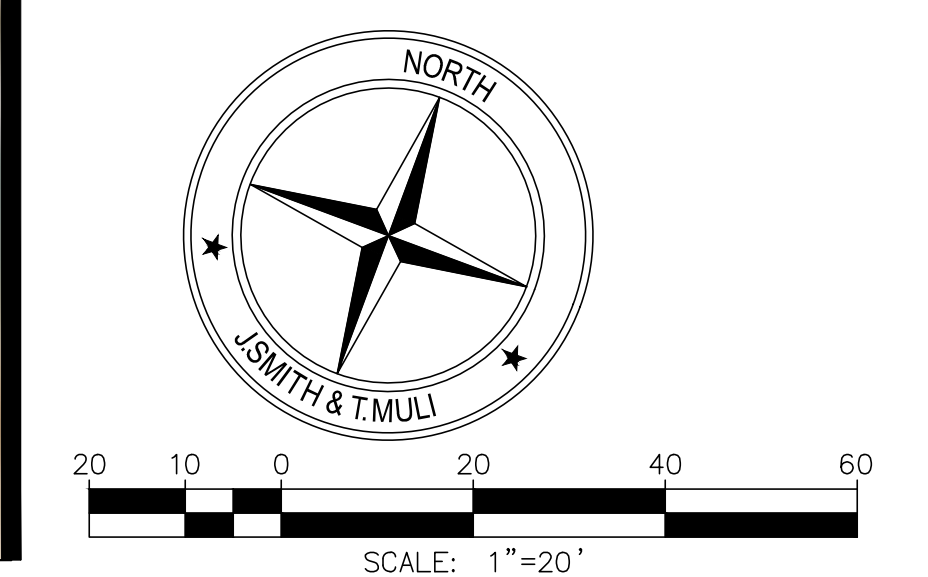

<p>UNDERGROUND SERVICE ALERT</p> <p>TWO WORKING DAYS BEFORE YOU DIG</p>	<p>BENCHMARK:</p> <p>ELEVATIONS SHOWN HEREON ARE EXPRESSED IN THE U.S. SURVEY FEET AND ARE REFERENCED TO THE NORTH AMERICA VERTICAL DATUM OF 1988 (NAVD88) AND DEFINED LOCALLY USING THE ORTHOMETRIC HEIGHT FOR CORS STATION EWPP. SITE BENCHMARK AT POINT NO. 7000 DERIVED FROM STATIC OBSERVATIONS. ELEVATION = 4587.05'</p>	<p>BASIS OF BEARINGS:</p> <p>BEARINGS SHOWN ON THIS MAP ARE REFERENCED TO THE CALIFORNIA COORDINATE SYSTEM, CCS83 (2011) EPOCH 2010.00, ZONE 03, DEFINED LOCALLY BY NGS PID'S EWPP, PS98, & P470 ACCORDING TO THE GEODETIC POSITIONS AS PUBLISHED BY NGS. ALL DISTANCES AND COORDINATES ARE REFERENCED TO CCS83 ZONE 03 GRID AND ARE EXPRESSED IN US SURVEY FOOT UNITS.</p>	<p>J. SMITH & T. MULI PROFESSIONAL ENGINEER</p>	<p>33161 Camino Capistrano, Suite D, San Juan Capistrano, CA 92675 Phone: (949) 329.3639 • JSTMINC.COM</p>	<p>REVISIONS</p> <table border="1" style="width: 100%; border-collapse: collapse;"> <thead> <tr> <th>MARK</th> <th>DATE</th> <th>INITIAL</th> <th>DESCRIPTION</th> <th>APPR. DATE</th> </tr> </thead> <tbody> <tr> <td> </td> <td> </td> <td> </td> <td> </td> <td> </td> </tr> </tbody> </table>	MARK	DATE	INITIAL	DESCRIPTION	APPR. DATE						<p>PLANS APPROVED BY: SAN BERNARDINO COUNTY - PUBLIC WORKS SPECIAL DISTRICTS</p> <table border="1" style="width: 100%; border-collapse: collapse;"> <thead> <tr> <th>ASSISTANT DIRECTOR</th> <th>DATE</th> </tr> </thead> <tbody> <tr> <td> </td> <td> </td> </tr> </tbody> </table>	ASSISTANT DIRECTOR	DATE			<p>IMPROVEMENT PLANS</p> <p>LAKE GREGORY SITEWIDE SEDIMENT MANAGEMENT PROJECT SAN BERNARDINO COUNTY REGIONAL PARKS DEPARTMENT CRESTLINE, CALIFORNIA</p> <p>PROPOSED SWIM BEACH GRADING</p>	<p>DWG NO. XX.XX.XXXX</p> <p>FILE NO. XXX-XXX</p> <p>SHEET 5 OF 17</p>
MARK	DATE	INITIAL	DESCRIPTION	APPR. DATE																		
ASSISTANT DIRECTOR	DATE																					



EARTHWORK QUANTITIES (CUBIC YARDS)	
CUT	23,265
FILL	1,674
NET (CUT)	21,591



LEGEND:

- DREDGING BOUNDARY/ DAYLIGHT LINE
- CUTOFF WALL LOCATION
- NO SWIM/NO BOAT BOUY LINE
- NO DIVING SIGN
- SOIL CEMENT EROSION GAUGE CYLINDER

CONSTRUCTION NOTES

- ① FURNISH AND INSTALL WHITE SAND BEACH FILL MATERIAL PER PLAN AND SPECIFICATIONS
- ② CONSTRUCT BEACH CONTAINMENT EMBANKMENT PER PLAN AND DETAIL A ON SHEET 13
- ④ FURNISH AND INSTALL MARINE RESCUE 3 STRAND 3/4" BLUE/WHITE POLYPRO ROPE BOUY LINE WITH 5"x9" ORANGE/WHITE LLF590 HANDI-LOCK FLOATS AT 5'-7" SPACING. 423 MARKER BOUY EVERY 200 FEET.
- ⑤ WATER PARK GRADING PER PLAN AND DETAIL ON SHEET 13
- ⑥ RELOCATE WATER PARK APPARATUS TO LOCATION SHOWN PER DIRECTION OF THE DISTRICT ENGINEER
- ⑨ FURNISH AND INSTALL BOUY LINE ANCHOR PER DETAIL 30 ON SHEET 15
- ⑩ FURNISH AND INSTALL 10-INCH DIAM 4-FEET CONTROLLED LOW STRENGTH MATERIAL (CLSM) EROSION GAGE CYLINDER PER PLAN PER DETAIL ON SHEET 13

NOTES:

1. THE LOCATIONS OF EXISTING UTILITIES AND SURFACE FEATURES ARE APPROXIMATE. CONTRACTOR SHALL FIELD VERIFY AND DOCUMENT THE LOCATIONS OF EXISTING UTILITIES AND SURFACE FEATURES IN THE VICINITY OF THE WORK BEFORE COMMENCING EARTHWORK.
2. WATER SURFACE ELEVATION SHOWN ON PLANS IS APPROXIMATE. CONTRACTOR SHALL VERIFY WATER SURFACE ELEVATION BEFORE COMMENCING EARTHWORK.
3. AERIAL IMAGERY SHOWN ON PLANS MAY VARY FROM CURRENT EXISTING CONDITIONS AND TOPOGRAPHIC INFORMATION.
4. CONTRACTOR SHALL PROTECT IN PLACE ALL EXISTING SURFACE IMPROVEMENTS AND UTILITIES.
5. ACCESS SHOWN SUBJECT TO CHANGE BASED ON CURRENT WATER SURFACE ELEVATION. CONTRACTOR TO VERIFY.

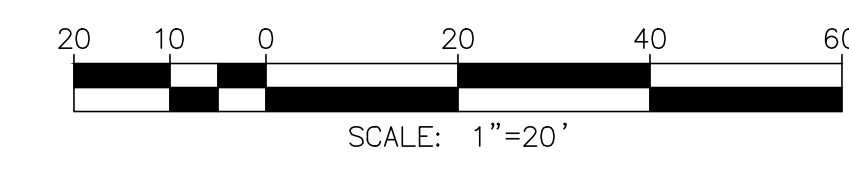
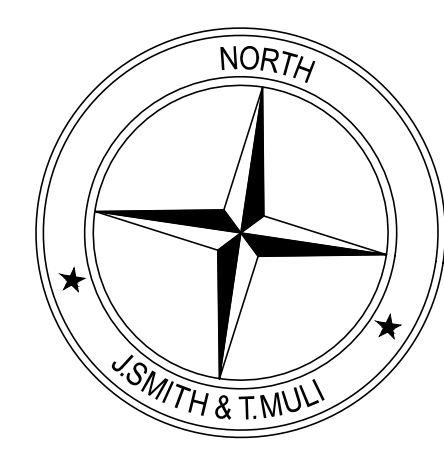

MATCHLINE - SEE SHEET 5

MATCHLINE - SEE RIGHT

MATCHLINE - SEE RIGHT

SWIM BEACH

<p>UNDERGROUND SERVICE ALERT Call: TOLL FREE 1-800-227-2600 OR 811 TWO WORKING DAYS BEFORE YOU DIG</p>	<p>BENCHMARK: ELEVATIONS SHOWN HEREON ARE EXPRESSED IN THE U.S. SURVEY FEET AND ARE REFERENCED TO THE NORTH AMERICA VERTICAL DATUM OF 1988 (NAVD88) AND DEFINED LOCALLY USING THE ORTHOMETRIC HEIGHT FOR CORS STATION EWPP. SITE BENCHMARK AT POINT NO. 7000 DERIVED FROM STATIC OBSERVATIONS. ELEVATION = 4587.05'</p>	<p>BASIS OF BEARINGS: BEARINGS SHOWN ON THIS MAP ARE REFERENCED TO THE CALIFORNIA COORDINATE SYSTEM, CCS83 (2011) EPOCH 2010.00, ZONE 05, DEFINED LOCALLY BY NGS PID'S EWPP, PS98, & P470 ACCORDING TO THE GEODETIC POSITIONS AS PUBLISHED BY NGS. ALL DISTANCES AND COORDINATES ARE REFERENCED TO CCS83 ZONE 05 GRID AND ARE EXPRESSED IN US SURVEY FOOT UNITS.</p>	<p>J. SMITH & T. MULI 33161 Camino Capistrano, Suite D, San Juan Capistrano, CA 92675 Phone: (949) 329.3639 • JSTMINC.COM JONIS C. SMITH 098654 09/08/2023 PROFESSIONAL ENGINEER R.C.E. No. DATE</p>	<p>REVISIONS</p> <table border="1" style="width: 100%; border-collapse: collapse;"> <thead> <tr> <th>MARK</th> <th>DATE</th> <th>INITIAL</th> <th>DESCRIPTION</th> <th>APPR. DATE</th> </tr> </thead> <tbody> <tr> <td> </td> <td> </td> <td> </td> <td> </td> <td> </td> </tr> </tbody> </table>	MARK	DATE	INITIAL	DESCRIPTION	APPR. DATE						<p>PLANS APPROVED BY: SAN BERNARDINO COUNTY - PUBLIC WORKS SPECIAL DISTRICTS</p> <table border="1" style="width: 100%; border-collapse: collapse;"> <thead> <tr> <th>ASSISTANT DIRECTOR</th> <th>DATE</th> </tr> </thead> <tbody> <tr> <td> </td> <td> </td> </tr> </tbody> </table> <p>APPROVALS</p> <table border="1" style="width: 100%; border-collapse: collapse;"> <thead> <tr> <th>PROJECT MANAGER</th> <th>INITIAL</th> <th>DATE</th> </tr> </thead> <tbody> <tr> <td> </td> <td> </td> <td> </td> </tr> <tr> <td>OPS. DIVISION MANAGER</td> <td> </td> <td> </td> </tr> <tr> <td>PM. DIVISION MANAGER</td> <td> </td> <td> </td> </tr> </tbody> </table>	ASSISTANT DIRECTOR	DATE			PROJECT MANAGER	INITIAL	DATE				OPS. DIVISION MANAGER			PM. DIVISION MANAGER			<p>IMPROVEMENT PLANS</p> <p>LAKE GREGORY SITEWIDE SEDIMENT MANAGEMENT PROJECT SAN BERNARDINO COUNTY REGIONAL PARKS DEPARTMENT CRESTLINE, CALIFORNIA</p> <p>PROPOSED SWIM BEACH GRADING</p>	<p>DWG NO. XX.XX.XXXX</p> <p>FILE NO. XXX-XXX</p> <p>SHEET 6 OF 17</p>
MARK	DATE	INITIAL	DESCRIPTION	APPR. DATE																													
ASSISTANT DIRECTOR	DATE																																
PROJECT MANAGER	INITIAL	DATE																															
OPS. DIVISION MANAGER																																	
PM. DIVISION MANAGER																																	

C:\Users\MULTI\OneDrive - J. Smith & T. Muli, Inc\US&TM\Operations\Projects\1025 - Lake Gregory Sitewide Sediment Management - Project\GD\Grading - Plan\1025-SH1-5-6-PR GRADINGS.dwg 08/08/24 - 11:25am MULTI

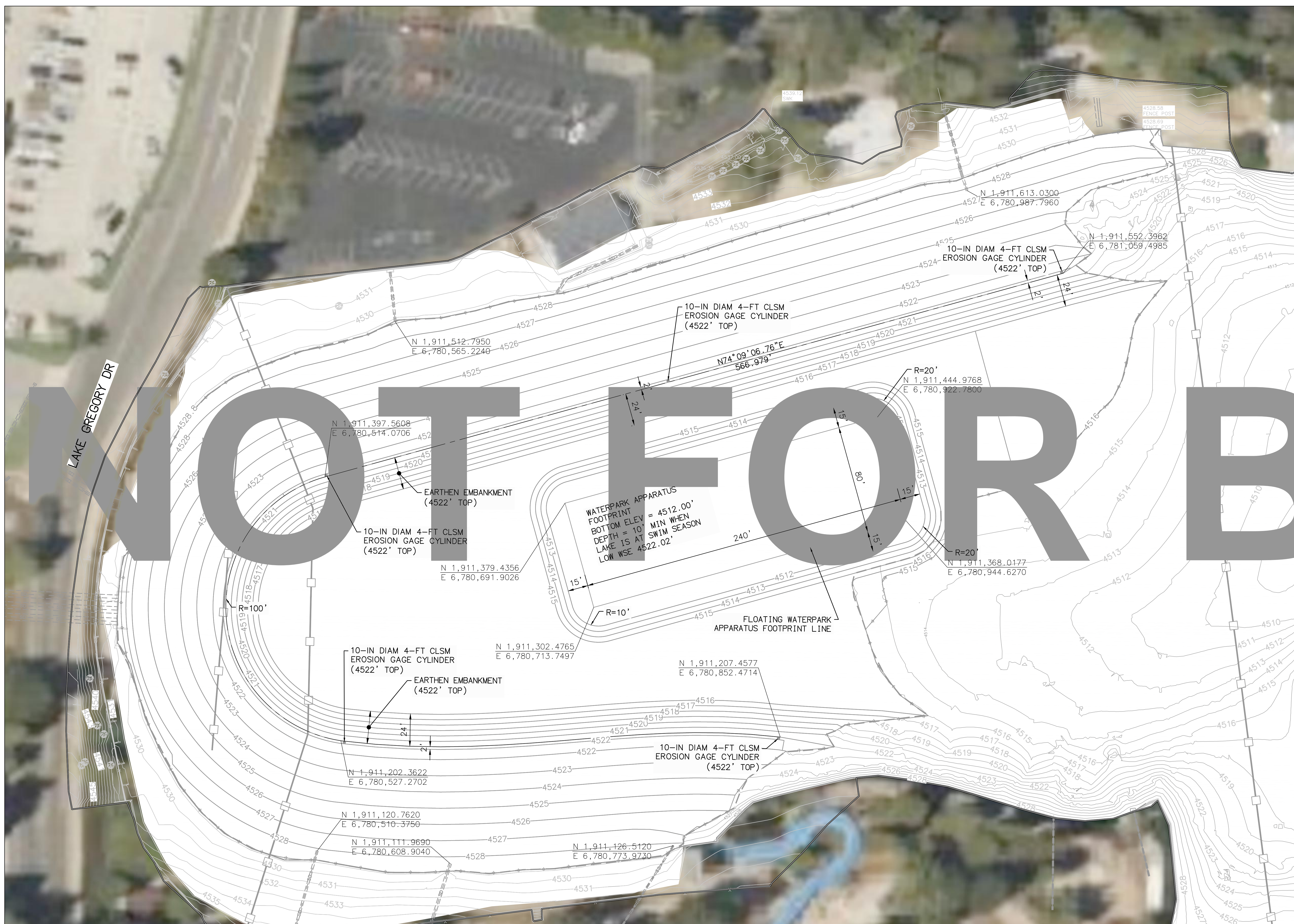

SWIM BEACH - HORIZONTAL CONTROL

SCALE: 1"=30'

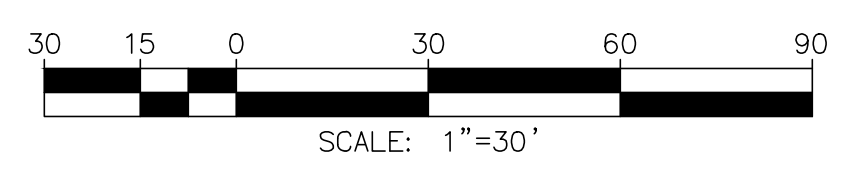
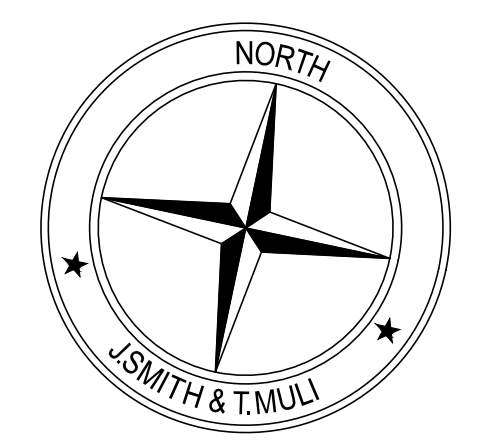

UNDERGROUND SERVICE ALERT
 Call: TOLL FREE
 1-800-227-2600
 OR
 811
 TWO WORKING DAYS BEFORE YOU DIG

BENCHMARK:
 ELEVATIONS SHOWN HEREON ARE EXPRESSED IN THE U.S. SURVEY FEET AND ARE REFERENCED TO THE NORTH AMERICA VERTICAL DATUM OF 1988 (NAVD88) AND DEFINED LOCALLY USING THE ORTHOMETRIC HEIGHT FOR CORS STATION EWPP. SITE BENCHMARK AT POINT NO. 7000 DERIVED FROM STATIC OBSERVATIONS. ELEVATION = 4587.05'

BASIS OF BEARINGS:
 BEARINGS SHOWN ON THIS MAP ARE REFERENCED TO THE CALIFORNIA COORDINATE SYSTEM, CCS83 (2011) EPOCH 2010.00, ZONE 05, DEFINED LOCALLY BY NGS PID'S EWPP, PS98, & P470 ACCORDING TO THE GEODETIC POSITIONS AS PUBLISHED BY NGS. ALL DISTANCES AND COORDINATES ARE REFERENCED TO CCS83 ZONE 05 GRID AND ARE EXPRESSED IN US SURVEY FOOT UNITS.

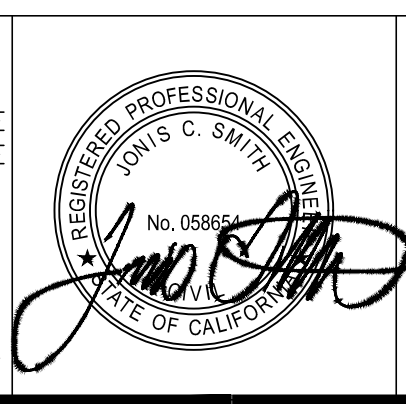

J. SMITH & T. MULI
 33161 Camino Capistrano, Suite D, San Juan Capistrano, CA 92675
 Phone: (949) 329.3639 • JSTMINC.COM
 JONIS C. SMITH 05986 09/08/2023
 PROFESSIONAL ENGINEER R.C.E. No. DATE

REVISIONS			
MARK	DATE	INITIAL	DESCRIPTION

PLANS APPROVED BY: SAN BERNARDINO COUNTY - PUBLIC WORKS SPECIAL DISTRICTS			
ASSISTANT DIRECTOR		DATE	

IMPROVEMENT PLANS
 LAKE GREGORY SITEWIDE SEDIMENT MANAGEMENT PROJECT
 SAN BERNARDINO COUNTY REGIONAL PARKS DEPARTMENT
 CRESTLINE, CALIFORNIA
 PROPOSED SWIM BEACH HORIZONTAL CONTROL

DWG NO.
XX.XX.XXXX
 FILE NO.
XXX-XXX
 SHEET 7 OF 17

C:\Users\WJ11\OneDrive - J. Smith & T. Muli - Inc\BKM\Operations\Projects\1025 - Lake Gregory Sitewide Sediment Management - Project\GD\Grading - Plans\1025-SH17-SWIM BEACH HORIZ CONTROL.dwg 08/08/24 - 11:27am Muli 11