

LICENSE AGREEMENT
ATC Contract No: _____

This LICENSE AGREEMENT ("**Agreement**") is entered into as of the latter signature date hereof ("**Effective Date**") by and between ATC Ponderosa K LLC, a Delaware limited liability company, with a place of business at 10 Presidential Way, Woburn, MA 01801 ("**Licensor**") and San Bernardino County, a political subdivision of the state of California, with a place of business at 385 North Arrowhead Ave, 3rd Floor, San Bernardino, CA 92415 ("**Licensee**").

I. TOWER FACILITY INFORMATION:

Site Name: Barstow Tower #1 P
Site Number: 204144
Address and/or location of Tower Facility: 33328 I Street, Barstow, California 92311-6408
Tower Facility Coordinates: Lat. 34° 51' 21.814" N 34.85605955 Long. 117° 3' 2.656" W-117.05073772

II. NOTICE & EMERGENCY CONTACTS:

- Licensee's local emergency contact (name and number): County ITD Emergency Line, (909) 356-3900.
- Licensor's local emergency contact: Network Operations Communications Center (800) 830-3365.
- Notices to Licensee shall be sent to Licensee's address above to the attention of Brian Reed.
- Notices to Licensor shall be sent to Licensor's address above to the attention of Contracts Manager.
- Licensor's Remittance Address and ACH/Wire: American Towers LLC, 29637 Network Place, Chicago, IL 60673-1296; ABA Routing #: 021000021, Account #: 227723662; all payments shall include a reference to the Site Name and Site Number as identified above in Section I.

III. PERMITTED USE OF TOWER FACILITY BY LICENSEE:

Transmitting and Receiving frequencies: See Exhibit A for specific frequencies.
Antenna mount height on tower: See Exhibit A for specific location.
All other permitted uses of the Tower Facility including Licensee's Approved Equipment, and the Licensed Space are further described in Section 4 of this Agreement and Exhibits A and B attached hereto.

IV. TERM & FEES:

Initial Term: A period of ten (10) years beginning on the Commencement Date. The "**Commencement Date**" shall be the earlier of: (i) the date of Licensor's issuance of a NTP or (ii) June 18, 2025.

Renewal Terms: Three (3) additional periods of five (5) years each.

Monthly License Fee: One Thousand Nine Hundred Fifty and 00/100 Dollars (\$1,950.00), increased by the Annual Escalator on the first anniversary of the Commencement Date of this Agreement and each anniversary of the Commencement Date thereafter during the Term (as defined in Appendix I).

Annual Escalator: Four percent (4%).

The following fees are one-time non-refundable fees that Licensee shall pay on a per Application basis to Licensor:

- ☒ Application Fee: One Thousand and 00/100 Dollars (\$1,000.00) per Application, increased annually on each anniversary of the Commencement Date of this Agreement by the Annual Escalator. The Application Fee becomes due and payable upon submission of Licensee's initial Application and any other Applications submitted or modified pursuant to Section 10. The Application Fee is nonrefundable and is earned in full by Licensor upon receipt of such Application (all references to "**Application**" made herein are to the then-current application form issued by Licensor).

☒ Site Inspection Fee: One Thousand Five Hundred and 00/100 Dollars (\$1,500.00), per Application, increased annually on each anniversary of the Commencement Date of this Agreement by the Annual Escalator. Licensee shall pay the Site Inspection Fee pursuant to the terms of Section 8.

☒ Structural Analysis Fee: Licensee shall pay the Structural Analysis Fee pursuant to the terms of Section 10(c).

Electricity for operation of Approved Equipment is to be provided by (check one):

- ☐ Licensor, with the cost of such electricity to be paid by Licensee at the initial rate of \$N/A per month ("Utility Fee") subject to adjustment pursuant to Subsection 5(b), OR
☒ Licensee, at its sole expense.

V. TERMS & CONDITIONS:

The attached terms and conditions are incorporated herein by this reference.

VI. OTHER PROVISIONS:

Other provisions: (check one): ☐ None ☒ As listed below

A. PCN/PCN Retention Fee/Cross-Default. Licensee, an Affiliate of Licensee or any entity or individual acting on behalf Licensee or an Affiliate of Licensee shall only issue Prior Coordination Notices ("PCNs") for the Permitted Frequencies set forth in Exhibit A and shall not issue PCNs for any other frequencies at this Tower Facility unless Licensee has submitted an Application for use of the subject frequencies to Licensor for which a partially executed License Agreement shall be signed by Licensee and returned to Licensor within (one hundred and twenty (120) days of the submittal of the Application. Licensee shall withdraw PCNs filed for any frequencies which are not licensed to Licensee by Licensor, no more than ten (10) days from the date of Licensee's withdrawal of an Application or Licensor's election to not process a Licensee-submitted Application. Failure to comply with the terms of this Subsection A shall constitute an event of default pursuant to Section 21 hereof (a "PCN Default") for which the cure period is set forth in Section 21. In the event Licensee fails to cure a PCN Default within the cure period set forth in Section 21, then, in addition to all other obligations of Licensee under this Agreement, Licensee shall pay Licensor Twenty Five Thousand and 00/100 Dollars (\$25,000.00) per month as liquidated damages for each tower facility wherein Licensee maintains an active PCN in breach of this Subsection A ("PCN Retention Fee"). Licensor and Licensee acknowledge that holding PCNs in violation of this Subsection A reduces Licensor's opportunity to license space at Licensor's tower facilities and since the actual amount of such lost revenue is difficult to determine, Licensor and Licensee agree that the PCN Retention Fee is a reasonable estimate of the damages that would accrue if a breach occurred. Licensor and Licensee agree that the PCN Retention Fee is fair and reasonable and would not act as a penalty to the breaching Party. The PCN Retention Fee shall be remitted by Licensee within thirty (30) days of Licensor's written notice to Licensee of Licensee's uncured default of this Subsection A and Licensee shall continue to remit payment of the PCN Retention Fee on a monthly basis on or before the first day of each calendar month while such default of this Subsection A remains uncured. In the event that Licensor does not receive the PCN Retention Fee on or before the first day of each month, then Licensor may, at its option, declare a default of this Agreement and all agreements between Licensor and Licensee and the PCN Retention Fee shall continue to be due and payable as set forth herein until the time Licensee withdraws the subject PCNs.

B. Notwithstanding anything to the contrary in this Agreement, the offer expressed to Licensee in this Agreement shall automatically become null and void with no further obligation by either Party hereto if a structural analysis of the Tower Facility completed after the execution of this Agreement by Licensor but before the commencement of the installation of Licensee's Approved Equipment indicates that the Tower Facility is not suitable for Licensee's Approved Equipment unless Licensor and Licensee mutually

agree that structural modifications or repairs shall be made to the Tower Facility on mutually agreeable terms.

C. This Agreement may be executed in any number of counterparts, each of which so executed shall be deemed to be an original, and such counterparts shall together constitute one and the same Agreement. The parties shall be entitled to sign and transmit an electronic signature of this Agreement (whether by facsimile, PDF or other email transmission), which signature shall be binding on the party whose name is contained therein. Each party providing an electronic signature agrees to promptly execute and deliver to the other party an original signed Agreement upon request.

[Signatures appear on next page]

IN WITNESS WHEREOF, each Party in consideration of the mutual covenants contained herein, and for other good and valuable consideration, intending to be legally bound, has caused this Agreement to be executed by its duly authorized representative as of the day and year written below; *provided, however*, that this Agreement shall not become effective as to either Party until executed by both Parties.

LICENSOR:

ATC Ponderosa K LLC, a Delaware limited liability company

LICENSEE:

San Bernardino County, a political subdivision of the state of California

By: _____

By: _____

Name: Nathaniel Ritzenthaler
Senior Counsel

Name: Dawn Rowe

Title: US Tower

Title: Chair, Board of Supervisors

Date: _____

Date: _____

TERMS AND CONDITIONS

1. DEFINITIONS.

Capitalized terms defined in the body of this Agreement are indexed by location in Appendix I attached hereto. Capitalized terms used in Agreement but not defined herein are defined in Appendix I.

2. GRANT OF LICENSE.

Subject to the terms of this Agreement, Licensor hereby grants Licensee a non-exclusive license to install, maintain and operate the Approved Equipment at the Licensed Space. All Approved Equipment shall be and remain Licensee's personal property throughout the Term of this Agreement. Licensor shall maintain the Tower Facility in good order and repair, wear and tear, damage by fire, the elements or other casualty excepted. In no event shall Licensee's license as granted herein include rights to use the air space above the Approved Equipment, and Licensor reserves the right to install, construct and/or operate additional improvements or equipment of Licensor or others above Licensee's Approved Equipment, including Licensee's shelter (commonly referred to as "stacking"), provided that such additional improvements or equipment do not materially and adversely interfere with the access to or operation of the Approved Equipment, including Licensee's shelter. Licensee is not required to utilize a stackable shelter, provided that, if Licensee opts to install a shelter that is not stackable and if Licensor receives an offer to license the air space above Licensee's non-stackable shelter by a proposed subsequent user, Licensor may, at its election, upon thirty (30) days' prior written notice require Licensee to replace such non-stackable shelter with a stackable shelter of a comparable size, provided that the proposed subsequent user agrees in writing to be wholly responsible for the cost of Licensee's shelter replacement. Subject to any limitations contained in the Ground Lease, Licensor grants Licensee a right of access to the Tower Facility twenty-four (24) hours per day, seven (7) days per week during the Term. Licensor grants Licensee a designated location for the installation of Licensee's utilities over, under or across the Tower Facility (collectively, "**Easement**"). Licensee shall be responsible for any and all Damage or loss that results from the installation of any cables or utility wires by Licensee or any company or person retained by Licensee (including a public utility company), including, without limitation, any damage or loss that results from the accidental cutting of utility wires or cables of any other party operating at the Tower Facility. Licensor shall provide Licensee with one set of keys and/or codes to access the Tower Facility. Licensee shall be responsible for ensuring that Licensor has, at all times, a complete and accurate written list of all employees and agents of Licensee who have been provided the keys or access codes to the Tower Facility. Licensor shall have the right to continue to occupy the Tower Facility and to grant rights to others to the Tower Facility in its sole discretion. Licensee shall have no property rights or interest in the Tower Facility or the Easement by virtue of this Agreement. If Licensor's right to license space on the Tower Facility to Licensee is subject to a right of first refusal for the benefit of a third party and if such third party exercises its right of first refusal prior to the Commencement Date, Licensor may terminate this Agreement upon written notice to Licensee.

3. EXHIBITS.

Within forty-five (45) days following the Commencement Date, Licensee shall provide Licensor with as-built or construction drawings showing the Approved Equipment as installed in both hard copy and electronic form ("**Construction Drawings**"); such Construction Drawings shall include the location of any shelters, cabinets, grounding rings, cables, and utility lines associated with Licensee's use of the Tower Facility. Upon receipt, Licensor shall attach the Construction Drawings as Exhibit C hereto. In the event that Licensee fails to deliver the Construction Drawings as required by this Section, Licensor may cause such Construction Drawings to be prepared on behalf of Licensee and Licensor shall assess a fee for such Construction Drawings in an amount equal the actual cost of obtaining the Construction Drawings including in-house labor which upon invoicing shall become immediately due and payable by Licensee. In the event of inconsistency or discrepancy between (a) Exhibit A and Exhibit B hereto, Exhibit A shall govern, and (b) between Exhibit A (with respect to Approved Equipment and antenna locations) together with Exhibit B (with respect to Ground Space installation locations) and Exhibit C hereto, Exhibits A and B shall govern, notwithstanding any approval or signature by Licensor or its agents. Licensee hereby acknowledges and agrees that installation of the Approved Equipment must be in strict accordance with the approved

Construction Drawings and Exhibits A and B. Notwithstanding the forgoing, Licensee shall not infer nor shall acceptance of the Construction Drawings by Licensor be deemed to be a representation by Licensor that (i) such Construction Drawings or the plans and specifications described therein are in compliance with federal, state or local laws, ordinances, rules or regulations, (ii) that such installation shall not cause impermissible or unlawful interference, or (iii) that such installation is consistent with Licensee's permitted installation as specifically set forth in Exhibits A and B hereto.

4. USE.

Subject to the terms of any Ground Lease, Licensee shall be permitted the non-exclusive right to install, maintain, operate, service, modify and/or replace its Approved Equipment at the Licensed Space, which Approved Equipment shall be utilized for the transmission and reception of wireless voice and data communications signals (such transmission and reception to be solely within the Permitted Frequencies, and, if the Permitted Frequencies include licensed spectrum, within the spectrum licensed to Licensee by the FCC). If as of the Effective Date, Licensee's wireless business consists of a one-way network which requires only that signals be transmitted from the Tower Facility, then notwithstanding the foregoing sentence, Licensee's use of the Tower Facility under this Agreement shall be limited to the transmission of wireless voice and data communications signals from the Tower Facility. Licensee's permitted use with respect to the Licensed Space shall be limited solely to that enumerated in this Section, and, except pursuant to a separate agreement with Licensor, no person or entity other than Licensee shall have the right to install, maintain or operate its equipment or transmit or receive communications at, or otherwise use, the Licensed Space.

5. LICENSE FEES; TAXES; ASSESSMENTS.

(a) **Monthly License Fee.** The Monthly License Fee as adjusted by the Annual Escalator, shall be payable in advance on the first day of each calendar month during the Term beginning upon the Commencement Date. If the Commencement Date is not the first day of a calendar month, the Monthly License Fee for any partial month shall be prorated on a daily basis.

(b) **Utilities.**

(i) All utility services installed on the Tower Facility for the use or benefit of Licensee shall be made at the sole cost and expense of Licensee and shall be separately metered from Licensor's utilities. Licensee shall be solely responsible for extending utilities to the Tower Facility as necessary for the operation of the Approved Equipment and for the payment of utility charges including connection charges and security deposits incurred by Licensee. Licensee shall obtain and pay the cost of telephone connections, the installation of which shall be in compliance with the procedures for installation and maintenance of Approved Equipment set forth herein.

(ii) **Interruptions in Service.** Licensor shall not be liable in any respect for damages to either person or property nor shall Licensee be relieved from fulfilling any covenant or agreement hereof as a result of any temporary or permanent interruption of electrical service or of any common heating, ventilation and air conditioning system to the extent provided by Licensor. Licensor shall use reasonable diligence to restore any interruption as promptly as practicable to the extent that Licensor can reasonably effect such restoration, but Licensee shall have no claim for damages, consequential or otherwise, on account of any interruption. Licensor has no obligation or responsibility to provide emergency or "backup" power to Licensee.

(c) **Taxes.**

(i) **Property Taxes.** Licensee shall be responsible for the reporting and payment when due of any tax directly related to Licensee's ownership or operation of the Approved Equipment and such reporting and payment shall be made directly to the appropriate tax authorities. Licensee shall reimburse Licensor in full for any taxes assessed against Licensor but attributed to the

Approved Equipment within thirty (30) days of Licensor's request for such reimbursement. Licensor shall pay all property taxes directly assessed against Licensor's property or for which Licensor is obligated to pay under the Ground Lease, provided, however, Licensee shall reimburse Licensee's pro rata share of such taxes to the extent that Licensee's pro rata share is not exempt from property taxation as a government entity. Unless exempt from property taxation, Licensee's pro rata share shall be determined by dividing such taxes evenly among all users Licensor has permitted to utilize any portion of the Tower Facility. Licensee shall reimburse Licensor for such taxes if applicable within thirty (30) days of Licensor's request for such reimbursement.

(ii) **Sales; Use and Other Taxes.** Licensor shall be responsible for billing, collecting, reporting, and remitting sales, use and other taxes directly related to any Monthly License Fee or other payments received pursuant to this Agreement. Licensee shall be responsible for reimbursing Licensor for all such sales, use and other taxes billed related to any payments received pursuant to this Agreement. Licensor shall add to the Monthly License Fee or any other payment then due and payable any associated sales, use or other tax, which shall be paid by Licensee at the same time and in the same manner as the Monthly License Fee or other payment due and payable under this Agreement.

(d) **Federal Use Fees & Assessments.** In the event that a particular Licensed Space is at a Tower Facility located on property which is owned by the Bureau of Land Management ("BLM") or the United States Forest Service ("USFS"), Licensee shall reimburse Licensor for any and all fees or assessments attributable to this Agreement or Licensee's use of the Licensed Space paid by Licensor to the BLM or USFS related to such Tower Facility within thirty (30) days of Licensor's request for such reimbursement.

(e) **Restrictions on Reimbursement.** Solely for the purposes of determining Licensee's portion of such taxes, fees, assessments or similar expenses as contemplated in this Section 5 or anywhere else in this Agreement, if any such amounts are determined in whole or in part on the income or profits (aside from gross revenues) of any person or entity, Licensor and Licensee shall agree on a fixed amount (subject to the Annual Escalator, which shall be applied in the same manner as it is applied to the Monthly License Fee), that shall be treated as such tax, fee, assessment or similar expense in lieu of the actual amount, which agreed to amount shall be set forth in an amendment to this Agreement.

(f) **Payment Address.** All payments due under this Agreement shall be made to Licensor at Licensor's Remittance Address shown on page 1 of this Agreement or such other address as Licensor may notify Licensee of in writing.

(g) **No Set-Off.** All payments due under this Agreement shall be due without set-off, notice, counterclaim, or demand from Licensor to Licensee.

(h) **Effect of Partial Payment.** No endorsement or statement on any check or letter accompanying a check for payment of any monies due and payable under the terms of this Agreement shall be deemed an accord and satisfaction, and Licensor may accept such check or payment without prejudice to its right to recover the balance of such monies or to pursue any other remedy provided by law or in this Agreement.

6. TERM.

(a) **Initial Term.** The Initial Term of this Agreement shall be as specified on page 1.

(b) **Renewal Term.** The Term of this Agreement may be extended for each of the Renewal Terms as specified on page 1 of this Agreement, provided that at the time of each such renewal, (i) the Ground Lease remains in effect and has not expired or been terminated, (ii) Licensee is not in default hereunder and no condition exists which if left uncured would with the passage of time or the giving of notice result in a default by Licensee hereunder and (iii) the original Licensee identified on page 1 of this Agreement

has not assigned, sublicensed, subleased or otherwise transferred any of its rights hereunder. Provided that the foregoing conditions are satisfied, this Agreement shall automatically renew for each successive Renewal Term unless either Party notifies the other in writing of its intention not to renew this Agreement at least one hundred eighty (180) days prior to the end of the then existing Term.

(c) **Holdover Term.** If Licensee fails to remove the Approved Equipment at the expiration of the Term, such failure shall be deemed to extend the Term of this Agreement on a month-to-month basis under the same terms and conditions herein except that (i) a monthly license fee shall be due on or before the first day of every calendar month during such month-to-month term in an amount equal to one hundred fifty percent (150%) of the Monthly License Fee in effect for the last month of the Term prior to the commencement of such month-to-month term ("**Holdover Fee**"), such Holdover Fee to escalate annually on the anniversary of the Commencement Date by an amount equal to six percent (6%) of the Holdover Fee in effect for the month immediately prior to the month in which such escalation takes place, and (ii) the month-to-month extension shall be terminable upon fifteen (15) days' prior written notice from either Licensor or Licensee to the other; provided, however, nothing contained herein shall grant Licensee the unilateral right to extend the Term of this Agreement after the expiration of the Term. In addition to the monthly license fee payable to Licensor in the event of an extension under this Subsection 6(c), Licensee agrees to indemnify and hold Licensor harmless from any Damages arising out of or in connection with the extension, the operation of the Approved Equipment at the Tower Facility and Licensee's failure to perform all of its obligations under this Agreement at the termination or earlier expiration of this Agreement.

7. COMMON EXPENSES.

Licensee shall reimburse Licensor for Licensee's pro-rata share of all common expenses (the "**Common Expenses**") incurred by Licensor in the installation, operation, maintenance and repair of the Tower Facility, including, but not limited to, the construction, maintenance and repair of a common septic system and field, insurance, common utilities and any and all other costs of operating and maintaining the Tower Facility. Notwithstanding the foregoing, the cost and expenses associated with any Damage which is directly attributable to the acts or omissions of Licensee or Licensee's contractors shall be borne solely by Licensee. Licensee shall not be required to pay any share of costs or expenses incurred to replace the Tower. In the event that Licensee also licenses space within a building or shelter owned by Licensor on the Tower Facility, Licensee shall also reimburse Licensor for its pro-rata share of all Common Expenses incurred for the operation, maintenance, repair and replacement associated with such building or shelter, including, without limitation, the physical structure of the building, HVAC system, and common utility expenses. In the event that Licensee is connected to a generator or back-up power supply owned by Licensor, Licensee shall also reimburse Licensor for its pro-rata share of all expenses incurred for the operation, maintenance, repair and replacement associated with such generator, including, without limitation, fuel expenses. For the purposes of this Section, a "pro-rata share" of costs and expenses shall be determined based on the number of licensees using the Tower Facility (or with respect to a shared shelter or building, the number of licensees using Licensor's shelter or building) on the first day of the month in which an invoice is mailed to Licensee. Licensee shall reimburse Licensor for Common Expenses within thirty (30) days following receipt of an invoice from Licensor.

8. SITE INSPECTION.

Concurrent with Licensee's delivery of a fully executed Agreement to Licensor, and before the date of any subsequent modifications to or installation of additional Approved Equipment, Licensee shall pay Licensor the Site Inspection Fee as defined on page 1 of this Agreement for each Application Licensee submits to install or modify its Approved Equipment. Licensee acknowledges that any site inspection performed by Licensor of Licensee's installation is for the sole purpose and benefit of Licensor and its affiliates, and Licensee shall not infer from or rely on any inspection by Licensor as assuring Licensee's installation complies with any Applicable Laws, that the installation was performed in a good, workmanlike manner or that such installation will not cause impermissible or unlawful interference.

9. LABELING.

Licensee shall identify its Approved Equipment, including its equipment cabinets and coaxial cable (at the top and bottom of the Tower) (unless such cabinet is located in a building or cabinet owned by Licensee) by labels with Licensee's name, contact phone number and date of installation. In the event that Licensee fails to comply with this provision and fails to cure such deficiency within ten (10) days of Licensor's written notice of such failure, Licensor may, but is not obligated to, in addition to any other rights it may have hereunder, label the Approved Equipment and assess against Licensee a fee of One Thousand Five Hundred and 00/100 Dollars (\$1,500) ("**Labeling Fee**") which shall be payable to Licensor upon receipt of an invoice therefor. Licensor shall not be responsible to Licensee for any expenses or Damages incurred by Licensee arising from the interruption of Licensee's service caused by Licensor if Licensor is unable to identify the Approved Equipment as belonging to Licensee as a result of Licensee's failure to label such Approved Equipment.

10. IMPROVEMENTS BY LICENSEE.

(a) **Installation and Approved Vendors.** Prior to the commencement of Licensee's initial installation, and again prior to any installation of any additional equipment, Licensee shall submit to Licensor for review and approval, an Application, including detailed plans and specifications accurately describing all aspects of the proposed Work relating to the construction, installation, relocation, and reconfiguration of Licensee's Approved Equipment on the Tower. Licensee shall provide notice to Licensor no less than five (5) days prior to the date upon which Licensee intends to commence Work at the Tower Facility, together with a construction schedule, so Licensor has the opportunity to be present during any such Work. Licensee shall not commence Work on the Tower Facility until Licensor issues to Licensee a NTP. Licensor shall issue a NTP only upon request from Licensee and receipt of the following complete and accurate documentation: (1) evidence that any contingencies set forth in the approval of Licensee's Application have been satisfied; (2) evidence that Licensee has obtained all required governmental approvals including, but not limited to, zoning approvals, building permits, and any applicable environmental approvals including copies of the same; (3) a copy of the plans and specifications that have been approved by Licensor for the proposed equipment installation; (4) evidence that any party, other than Licensor but including Licensee, that will be performing the Work are on Licensor's approved vendor list, with valid and current worker's compensation and general liability insurance certificates on file with Licensor naming Licensor as an additional insured and which otherwise satisfy the insurance coverage requirements set forth in Subsection 15(d) of this Agreement; and (5) a construction schedule. In no event will a NTP be issued prior to the payment by Licensee of an Application Fee or any other required fees, pursuant to Section 8 and 10 of this Agreement. Notwithstanding anything to the contrary in this Agreement, Licensor reserves the right, in its sole discretion, to refuse to permit any person or company to climb the Tower.

(b) **Structural Analysis/Interference Analysis.** Prior to the commencement of any Work on the Tower Facility by or for the benefit of Licensee, Licensor may, in its reasonable discretion, perform or cause to be performed a structural analysis or require a professional engineer's certified letter to determine the availability of capacity at the Tower Facility for the installation or modification of any Approved Equipment and/or additional equipment at the Licensed Space by Licensee. Licensee agrees to remit payment to Licensor for all reasonable costs and expenses incurred by Licensor for such structural analysis or professional engineer's certified letter ("**Structural Analysis Fee**") within thirty (30) days following receipt of an invoice from Licensor. The foregoing charge shall be at Licensor's prevailing rates for the performance of same or the amount Licensor's vendor is then charging Licensor, as applicable. In the event a structural analysis is performed after the execution of this Agreement but prior to the initial installation of the Approved Equipment, and such analysis indicates that the existing Tower cannot accommodate the proposed installation of Licensee's Approved Equipment thereon, Licensor shall notify Licensee that modification of the Tower is required and inform Licensee of the fee Licensor will charge Licensee to complete such modification (which fee shall be a reasonable estimate of Licensor's actual cost of making such modifications). Such modification shall become part of the Tower Facility and be Licensor's sole property. If Licensee elects not to pay such fee, and Licensee and Licensor do not otherwise reach an agreement regarding the costs of such modification, Licensee may terminate this Agreement upon written notice to Licensor. Prior to the commencement of any initial or subsequent construction or installation on the Tower

Facility by or for the benefit of Licensee and/or the modification of Licensee's Permitted Frequencies propagated from the Licensed Space, Licensor may elect to perform a shared site interference study ("**SSIS**") and Licensee shall pay Licensor One Thousand Six Hundred and 00/100 Dollars (\$1,600.00) per study ("**SSIS Fee**"), increased annually on the anniversary of the Commencement Date by a percentage rate equal to the Annual Escalator. The SSIS Fee shall be payable at the time Licensee pays the Application Fee where required pursuant to Subsection 10(c) of this Agreement, or immediately upon receipt of notice from Licensor that Licensor has determined that a SSIS is required. In the event a SSIS is performed after the execution of this Agreement by Licensor but prior to the installation of Licensee's Approved Equipment, and such SSIS indicates that the proposed installation of Licensee's Approved Equipment on the Tower is acceptable, such an indication in no way relieves Licensee of its obligations under Section 11 herein.

(c) **Equipment; Relocation, Modification, Removal.** Licensor hereby grants Licensee reasonable access to the Licensed Space for the purpose of installing and maintaining the Approved Equipment and its appurtenances. Except as otherwise provided, Licensee shall be responsible for all site Work to be done on the Licensed Space or the Easement pursuant to this Agreement. Licensee shall provide all materials and shall pay for all labor for the construction, installation, operation, maintenance, and repair of the Approved Equipment. Licensee shall not construct, install, or operate any equipment or improvements on the Tower Facility other than those which are described on Exhibit A, alter the Permitted Frequencies, or alter the operation of the Approved Equipment. Licensee shall submit an Application, utilizing Licensor's then current form, to request the right to replace or modify its Approved Equipment, alter the Permitted Frequencies or increase the Ground Space, which Application shall be accompanied by an Application Fee and any other fees applicable to the proposed modifications, as provided for in Sections 8 and 10 of this Agreement. Licensor shall evaluate for approval the feasibility of Licensee's request, which approval shall be in Licensor's sole discretion. Licensee acknowledges that any such relocation or modification of the Approved Equipment may result in an increase in the Monthly License Fee. An amendment to this Agreement shall be prepared to reflect each addition or modification to Licensee's Approved Equipment to which Licensor has given its written consent and the resulting increase in the Monthly License Fee, if any. Licensee shall have the right to remove all Approved Equipment at Licensee's sole expense on or before the expiration or earlier termination of the License provided Licensee repairs any damage to the Tower Facility or the Tower caused by such removal. Within thirty (30) days of the expiration or termination of this Agreement for any reason, Licensee shall: (i) remove the Approved Equipment and any other property of Licensee at the Tower Facility at Licensee's sole risk, cost, and expense; (ii) deliver the Licensed Space in substantially the same and in as good a condition as received (ordinary wear and tear excepted); and (iii) repair any damage caused by the removal of the Approved Equipment within ten (10) days of the occurrence of such damage. If Licensee fails to timely pay the Holdover Fee or does not remove its Approved Equipment within thirty (30) days after the expiration or termination of this Agreement, (i) the Approved Equipment shall be deemed conclusively and absolutely abandoned by Licensee and anyone claiming by, through, or under Licensee except for Hazardous Substances and waste and Approved Equipment containing Hazardous Substances and waste; and (ii) Licensor shall have the right to remove the Approved Equipment at Licensee's sole expense and dispose of such Approved Equipment in any manner Licensor so elects, and Licensee shall reimburse Licensor for its expenses upon demand without off-set.

11. RF INTERFERENCE/ USER PRIORITY.

(a) **Definitions.** For purposes of this Section 11, the following capitalized terms shall have the meanings set forth herein:

(i) **Interference** includes any performance degradation, misinterpretation, or loss of information to a radio communications system caused by unwanted energy emissions, radiations, or inductions, but shall not include permissible interference as defined by the FCC, and in addition, with regard to Unlicensed Frequencies, congestion.

(ii) **Licensed Frequencies** are those certain channels or frequencies of the radio frequency spectrum that are licensed by the FCC in the geographic area where the Tower Facility is located.

(iii) A **Licensed User** is any user of the Tower Facility, including Licensee, which transmits and/or receives Licensed Frequencies at the Tower Facility, but only with respect to such Licensed Frequencies.

(iv) A **Priority User** is any Licensed User of the Tower Facility that holds a priority position in relationship to Licensee for protection from Interference, as determined in this Section 11, which status is subject to change as set forth herein.

(v) A **Subsequent User** is any user of the Tower Facility that holds a subordinate position in relationship to Licensee for protection from Interference, as determined in this Section 11, which status is subject to change as set forth herein.

(vi) **Unlicensed Frequencies** are those certain channels or frequencies of the radio frequency spectrum that are not licensed by the FCC and are available for use by the general public in the geographic area where the Tower Facility is located.

(vii) An **Unlicensed User** is any user of the Tower Facility, including Licensee, which transmits and/or receives Unlicensed Frequencies at the Tower Facility, but only with respect to such Unlicensed Frequencies.

(b) **Information.** Licensee shall cooperate with Licensor and with other lessees, licensees, or occupants of the Tower Facility for purposes of avoiding Interference and/or investigating claims of Interference. Upon request, Licensee, within ten (10) days of Licensor's request, shall provide Licensor with a list of Licensee's transmit and receive frequencies and Approved Equipment specifications necessary to resolve or investigate claims of Interference.

(c) **Unlicensed Frequencies.** Notwithstanding any other provision contained herein, as among Licensor, Licensee and other users of the Tower or Tower Facility, (i) an Unlicensed User shall have no priority with respect to any other FCC Unlicensed Users with respect to Interference; and (ii) an Unlicensed User's rights and obligations with respect to such Interference shall be determined and governed by FCC Rules and Regulations and any other Applicable Law. Licensor expressly disclaims any and all warranties and accepts no responsibility for management, mediation, mitigation or resolution of Interference among FCC Unlicensed Users operating at the Tower Facility and shall have no liability therefor.

(d) **Licensed Frequencies.** Subject to FCC Rules and Regulations and other Applicable Law, the Parties acknowledge and agree that the accepted industry standard for priority protection from Interference between multiple Licensed Users has been based on the priority of occupancy of each user to another user of the Tower or Tower Facility, which priority has been based on the order of submittal of its collocation Application by each user of the Tower or Tower Facility. Should the application of FCC Rules and Regulations and other Applicable Law not resolve any claims of Interference consistent with Subsections 11(e), 11(f) and 11(g) below, as among Licensor, Licensee and other users of the Tower Facility, (i) each Licensed User's priority shall be maintained so long as the Licensed User does not change the equipment and/or frequency that it is entitled to use at the Tower Facility at the time of its initial occupancy; and (ii) Licensee acknowledges and agrees that if Licensee replaces its Approved Equipment or alters the radio frequency of the Approved Equipment to a frequency range other than as described on page 1 of this Agreement, Licensee will lose its priority position for protection from Interference with regard to Approved Equipment operating at the new frequency in its relationship to other Licensed Users which are in place as of the date Licensee replaces its Approved Equipment or alters its radio frequency, consistent with this Section 11.

(e) **Correction.**

(i) **Licensee.** Licensee agrees not to cause Interference with the operations of any other user of the Tower or Tower Facility and to comply with all other terms and provisions of this Section 11 imposed upon Licensee. If Licensor determines, in its reasonable discretion based on

standard and accepted engineering practices, that Licensee's Approved Equipment is causing Interference to the installations of Licensor or a Priority User, Licensee shall, within 48 hours of notification from Licensor, take such actions as are necessary to mitigate or eliminate the Interference, with the exception of ceasing Licensee's operations. If Licensee cannot mitigate or eliminate such Interference within the 48 hour period, Licensor may file a complaint with the FCC (currently the FCC's Enforcement Bureau, Spectrum Enforcement Division) or if such other user of the Tower Facility which is subject to Interference from Licensee's Approved Equipment is a Priority User, then upon the request of such Priority User consistent with Licensor's contractual obligations owed to the Priority User, Licensor may require that Licensee turn off or power down its interfering Approved Equipment and only power up or use such Approved Equipment during off-peak hours specified by Licensor in order to test whether such Interference continues or has been satisfactorily eliminated. If Licensee is unable to resolve or eliminate, to the satisfaction of Licensor, such Interference within thirty (30) days from Licensee's initial notification thereof, Licensee will immediately remove or cease operations of the interfering Approved Equipment.

(ii) **Licensor.** Upon the request of Licensee, Licensor hereby covenants to take commercially reasonable efforts to prohibit a Subsequent User from causing Interference with the operations of Licensee to the extent Licensee is a Priority User pursuant this Section 11. If Licensor determines, in its reasonable discretion based on standard and accepted engineering practices, that a Subsequent User's equipment is causing Interference to the installations of Licensee, upon Licensee's request, Licensor shall, within 48 hours of request, commence such actions as are necessary to mitigate or eliminate the Interference, with the exception of ceasing Subsequent User's operations.

(iii) **Government Users.** Notwithstanding the foregoing, if another user of the Tower or Tower Facility is a governmental entity, Licensor shall give such governmental entity written notice of the Interference within five (5) Business Days of Licensor's determination that such action is reasonably necessary. Licensor shall have the right to give the governmental entity five (5) Business Days, or more as specified in the governmental site or occupancy agreement or as required by Applicable Law, from the receipt of such notice prior to Licensor being required to take any actions required by this Subsection 11(e) to cure such Interference.

(f) **FCC Requirements Regarding Interference.** Nothing herein shall prejudice, limit, or impair Licensee's rights under Applicable Law, including, but not limited to, FCC Rules and Regulations to redress any Interference independently of the terms of this Section 11. Notwithstanding anything herein to the contrary, the provisions set forth in this Section 11 shall be interpreted in a manner so as not to be inconsistent with Applicable Law, including, but not limited to, FCC Rules and Regulations and nothing herein relieves Licensee from complying with all Applicable Laws governing the propagation of radio frequencies and/or radio frequency interference. The Parties acknowledge that currently FCC Rules and Regulations govern the obligations of wireless telecommunication service providers with respect to the operation of equipment and use of frequencies. Consequently, the provisions set forth in this Section 11 are expressly subject to CFR, Title 47, including but not limited to Part 15, et seq, governing Radio Frequency Devices; Part 20, et seq, governing commercial mobile radio services; Part 24, et seq, governing personal communications services; Part 90, et seq, governing private land mobile radio services; and Part 96, et seq, governing Citizens Broadband Radio Service. In addition, in accordance with good engineering practice and standard industry protocols, licensees employ a wide range of techniques and practices, including those involving the use of proper types of equipment as well those related to the adjustment of operating parameters, in a mutually cooperative effort to identify and mitigate sources of Interference. The obligation of Part 20 licensees, including, but not limited to, private paging, specialized mobile radio services, cellular radiotelephone service and personal communications services, to avoid Interference is set forth in 47 CFR Part 90, Subpart N – Operating Requirements, §90.403(e). Claims of Interference are ultimately cognizable before the FCC's Enforcement Bureau, Spectrum Enforcement Division. Licensee shall observe good engineering practice and standard industry protocols, applying such commercially reasonable techniques as constitute best practices among licensees, in the deployment of their frequencies and the operation of the Approved Equipment. If Licensee deploys its frequencies or operates the Approved Equipment in a manner

which prevents any other user of the Tower or Tower Facility from decoding signal imbedded in their licensed frequencies such that the Spectrum Enforcement Division makes a determination that Licensee is the cause of the Interference and Licensee fails or refuses to mitigate or eliminate the Interference within the time and in the manner prescribed by the Spectrum Enforcement Division, Licensee shall be in default of this Agreement and the remedies set forth in Section 22 shall apply.

(g) **Public Safety Interference.** As of the Commencement Date, Licensor and Licensee are aware of the publication of FCC Final Rule, Private Land Mobile Services; 800 MHz Public Safety Interference Proceeding, *Federal Register*: November 22, 2004 (Volume 69, Number 224), Rules and Regulations, Page 67823-67853 ("**Final Rule**"). Claims of Interference made by or against users which are public safety entities shall be in compliance with the Final Rule as and when effective, or otherwise in accordance with FCC Rules and Regulations.

(h) **AM Detuning.** The parties acknowledge that the FCC Rules and Regulations govern the obligations of Licensee with respect to the operation of the Approved Equipment. Consequently, the provisions set forth in this Agreement are expressly subject to the FCC Rules and Regulations, including, but not limited to 47 C.F.R. §§ 27.63, 22.371 and 73.1692. Licensee agrees, at Licensee's sole cost, to comply with the foregoing as well as any and all other FCC Rules, Regulations and public guidance relating to AM detuning as such provisions currently exist or are hereafter modified. Licensee shall be fully responsible for any pre and/or post installation testing for AM interference at the Tower Facility and for the installation of any new detuning apparatus or the adjustment of any existing detuning apparatus that may be necessary to prevent adverse effects on the radiation pattern of any AM station caused by the installation of the Approved Equipment. Licensee shall provide Licensor with written proof of such compliance. In the event that Licensee determines that pre or post-installation testing for AM interference is not required at the Tower Facility, such a determination shall be at Licensee's sole risk. If Licensee or Licensor receives a complaint of interference from an AM broadcast station after the Approved Equipment is added to a Tower or a Tower is modified to accommodate Licensee, Licensee shall eliminate such interference within thirty (30) days of the receipt of such complaint. Licensee's failure to eliminate such interference within such thirty (30) day period shall constitute a default under this Agreement and Licensor shall have the right to eliminate such interference at Licensee's expense. Licensee further agrees to indemnify Licensor in the event that Licensee's failure to comply with the FCC Rules and Regulations prior to installation/modification of the Approved Equipment results in any administrative investigation, proceeding or adjudication with respect to Licensor.

12. SITE RULES AND REGULATIONS.

Licensee agrees to comply with the reasonable rules and regulations established from time to time at the Tower Facility by Licensor, which may be modified by Licensor from time to time upon receipt by Licensee of such revised rules and regulations. Such rules and regulations will not unreasonably interfere with Licensee's use of the Licensed Space under this Agreement.

13. DESTRUCTION; CONDEMNATION.

(a) **Destruction.** If the Tower or other portions of the improvements at the Tower Facility owned by Licensor are destroyed or so damaged as to materially interfere with Licensee's use and benefits from the Licensed Space, Licensor or Licensee shall be entitled to elect to cancel and terminate this Agreement on the date of such casualty and any unearned Monthly License Fee paid in advance of such date shall be refunded by Licensor to Licensee within thirty (30) days of such termination date. Notwithstanding the foregoing, Licensor may elect, in its sole discretion, to restore the damaged improvements, in which case Licensee and Licensor shall remain bound to the terms of this Agreement but Licensee shall be entitled to an abatement of the Monthly License Fee during the loss of use. If the Tower is so damaged that reconstruction or repair cannot reasonably be undertaken without removing the Approved Equipment, then (i) Licensor may, upon giving written notice to Licensee, remove any of the Approved Equipment and interrupt the signal activity of Licensee, (ii) Licensee may, at Licensee's sole cost and expense, install temporary facilities pending such reconstruction or repair, provided such temporary facilities do not interfere with the construction, rebuilding or operation of the Tower, (iii) Licensor agrees to provide

Licensee alternative space, if available, on the Tower or at the Tower Facility during such reconstruction/repair period and (iv) should Licensor not substantially restore or replace the Tower in a fashion sufficient to allow Licensee to resume operations thereon within 6 months of the date of casualty, and Licensee's operation has been materially disrupted for sixty (60) or more consecutive days, then Licensee, upon thirty (30) days' prior written notice to Licensor, may terminate this Agreement.

(b) **Condemnation.** If the whole or any substantial part of the Tower Facility shall be taken by any public authority under the power of eminent domain or in deed or conveyance in lieu of condemnation so as to materially interfere with Licensee's use thereof and benefits from the Licensed Space, then this Agreement shall terminate on the part so taken on the date of possession by such authority of that part, and Licensor or Licensee shall have the right to terminate this Agreement and any unearned Monthly License Fee paid in advance of such termination shall be refunded by Licensor to Licensee within thirty (30) days following such termination. Notwithstanding the foregoing, should Licensor elect to rebuild the Tower or other improvements affected by such condemnation at an alternate location or property owned, leased or managed by Licensor, Licensee and Licensor may elect to remain bound by the terms of this Agreement. Upon such relocation of the Tower or improvements, the Licensed Space shall be modified to include the new Tower or improvements and the property on which the same are located and this Agreement shall be amended accordingly to clarify the rights of Licensor and Licensee with respect to the Licensed Space. Licensee agrees not to make a claim to the condemning authority for any condemnation award to the extent such claim shall diminish or affect the award made to Licensor with regard to such condemnation.

(c) **License Fee Abatement.** The Monthly License Fee with respect to the affected Tower Facility shall be abated during any period that the Tower has not been restored following an event described in Subsections (a) or (b) above so long as Licensee is unable to continue to operate from a temporary location at the Tower Facility during any period of restoration.

14. COMPLIANCE WITH LAWS.

Licensor shall be responsible for compliance with any marking and lighting requirements of the FAA and the FCC applicable to the Tower Facility, provided that if the requirement for compliance results from the presence of the Approved Equipment on the Tower, Licensee shall pay the costs and expenses therefor (including any lighting automated alarm system so required). Licensee has the responsibility of carrying out the terms of Licensee's FCC license with respect to tower light observation and notification to the FAA if those requirements imposed on Licensee are in excess of those required of Licensor. Notwithstanding anything to the contrary in this Agreement, Licensee shall at all times comply with all Applicable Laws and ordinances and all rules and regulations of municipal, state and federal governmental authorities relating to the installation, maintenance, location, use, operation, and removal of the Approved Equipment and other alterations or improvements authorized pursuant to the provisions of this Agreement.

15. INDEMNIFICATION; INSURANCE.

(a) **Mutual Indemnity.** Subject to the mutual waiver of subrogation set forth in Section 27, Licensee and Licensor each indemnifies the other against and holds the other harmless from any and all costs, demands, Damages, suits, expenses, or causes of action (including reasonable attorney's fees and court costs) claimed by a third party which arise out of the use and/or occupancy of the Licensed Space by the Indemnifying Party. This indemnity does not apply to any Claims to the extent arising from the sole gross negligence or intentional misconduct of the Indemnified Party.

(b) **Limits on Indemnification.** Neither Party shall be responsible or liable to any of the foregoing Indemnified Parties for any Damages arising from any claim to the extent attributable to any acts or omissions of other licensees or users occupying the Tower Facility or for any structural or power failures or destruction or damage to the Tower Facility except to the extent caused by the sole, joint, or concurrent gross negligence or willful misconduct of such Party.

(c) **Survival.** The provisions of this Section 15 shall survive the expiration or earlier termination of this Agreement with respect to any events occurring on or before expiration or termination of same whether or not Claims relating thereto are asserted before or after such expiration or termination.

(d) **Insurance.** Licensor and Licensee's contractors and subcontractors shall keep in full force and effect, during the Term of this Agreement, insurance coverage in accordance with Appendix II attached hereto. Licensee is an authorized self-insured public entity for purposes of General Liability and warrants that through its program of self-insurance, it has adequate coverage or resources to protect against liabilities arising out of the performance of the terms, conditions or obligations of this Agreement.

16. LIMITATION OF PARTIES' LIABILITY.

NEITHER LICENSOR NOR LICENSEE SHALL BE RESPONSIBLE FOR, AND HEREBY WAIVES ANY INCIDENTAL OR CONSEQUENTIAL DAMAGES INCURRED RESULTING FROM (i) LICENSEE'S USE OR LICENSEE'S INABILITY TO USE THE TOWER FACILITY, OR (ii) DAMAGE TO THE OTHER'S EQUIPMENT. If Licensor shall fail to perform or observe any term, condition, covenant or obligation required to be performed or observed by it under this Agreement or is charged with an indemnity obligation hereunder, and if Licensee shall, as a consequence thereof, recover a money judgment against Licensor (whether compensatory or punitive in nature), Licensee agrees that it shall look solely to Licensor's right, title and interest in and to the Tower Facility and the Tower for the collection of such judgment, and Licensee further agrees that no other assets of Licensor shall be subject to levy, execution or other process for the satisfaction of Licensee's judgment and that Licensor shall not be personally liable for any deficiency.

17. DISCLAIMER OF WARRANTY.

LICENSOR HEREBY EXPRESSLY DISCLAIMS ALL WARRANTIES OF MERCHANTABILITY AND FITNESS FOR A PARTICULAR PURPOSE ASSOCIATED WITH THE TOWER FACILITY OR THE TOWER. LICENSEE HEREBY ACCEPTS THE TOWER FACILITY "AS IS, WHERE IS, WITH ALL FAULTS."

18. NOTICES.

All notices, demands, approvals, requests and other communications shall be in writing to such Party at the address listed in the introductory paragraph of this Agreement (and in each case, in the event of notice to Licensor, with a copy of such notice to American Towers LLC, 116 Huntington Avenue, Boston, MA 02116, Attention: General Counsel) or at such other address as such Party shall designate by notice to the other Party hereto in accordance with this Section 18 (the "**Notice Address**") and may be personally delivered; mailed, via United States certified mail, return receipt requested; or transmitted by overnight courier for next Business Day delivery, and, if not delivered personally, shall be deemed to be duly given or made two (2) Business Days after deposit with the applicable carrier or courier. Notices will be deemed to have been given upon either receipt or rejection. Notwithstanding the foregoing, (i) any notice that is given by a Party may be given by the attorneys for that Party and shall be deemed effective for all purposes herein, and (iii) only notices, letters, documents, or instruments threatening to declare or declaring such addressee or recipient in default under this Agreement shall be required to be sent to the attorneys representing such addressee or recipient, if the name and address of such attorney is provided for herein.

19. ASSIGNMENT; SUBLEASING.

Licensee may not, directly or indirectly, assign this Agreement as a whole, or any portion of Licensee's rights, title and interests hereunder without Licensor's prior written consent. In no event may Licensee sublet, sublease, or permit any use of the Tower Facility or Licensed Space by any other party. Any permitted assignee shall expressly assume, and become bound by, all of Licensee's obligations under this Agreement. Licensor may freely assign, transfer, or sublease this Agreement and, in such event, Licensor shall be relieved of all of its obligations under this Agreement from and after the date of such assignment or transfer. Licensee shall pay Licensor a fee of Five Hundred and 00/100 Dollars (\$500.00) (which fee

shall increase annually on each anniversary of the Commencement Date by a percentage rate increase equal to the Annual Escalator) in each instance in which Licensee requests Licensor to consent to an assignment of this Agreement or in which Licensee seeks an estoppel certificate, non-disturbance agreement, subordination agreement or other similar agreement to defray the administrative cost incurred by Licensor to process such requests, prepare and process any necessary documentation, and modify its database and other information systems to reflect any such agreement. Such fee is due upon submission of Licensor's request and is hereby deemed fully earned by Licensor upon receipt. Notwithstanding anything to the contrary, Licensor may condition its consent to any assignment, on among other things, (i) requiring that the assignee execute a new form of license agreement so long as the Monthly License Fee and Initial and Renewal Terms of such agreement are consistent with those set forth in this Agreement, and (ii) requiring the assignee to demonstrate that it maintains at the time of such assignment, as evidenced by current financial statements provided to Licensor, a financial position reasonably demonstrating the ability of such assignee to meet and perform the obligations of Licensee hereunder through the unexpired balance of the then current Initial Term or Renewal Term. Any purported assignment in violation of the terms of this Agreement shall be void. This Agreement shall be binding upon the successors and permitted assigns of both Parties.

20. SUBORDINATION TO GROUND LEASE.

The Parties acknowledge and agree that in the event Licensor's rights in the Licensed Space and/or any part of the Tower Facility is derived in whole or part pursuant to an underlying lease, sublease, permit, easement or other right of use agreement (a "**Ground Lease**"), all terms, conditions and covenants contained in this Agreement shall be specifically subject to and subordinate to the terms and conditions of the applicable Ground Lease. In the event that any of the provisions of the Ground Lease are in conflict with any of the provisions of this Agreement (other than those provisions relating to the length of term, termination rights or financial consideration), the terms of the Ground Lease shall control. Further, Licensee agrees to comply with the terms of such Ground Lease as applicable to the access and occupancy of the Licensed Space. Notwithstanding anything contained in this Agreement to the contrary, if the Ground Lease expires or is terminated for any reason, this Agreement shall terminate on the effective date of such termination and Licensor shall have no liability to Licensee as a result of the termination of this Agreement. Licensor is under no obligation to extend the term of or renew the Ground Lease. Licensor shall give Licensee written notice of such termination or expiration of this Agreement as a result of the termination or expiration of the Ground Lease as soon as practicable. Unless prohibited by the terms of such Ground Lease, upon Licensee's written request, Licensor shall provide a copy of any applicable Ground Lease with the economic terms and other terms that Licensor deems reasonably confidential redacted.

21. DEFAULT.

The occurrence of any of the following instances shall be considered to be a default or a breach of this Agreement by Licensee: (i) any failure of Licensee to pay the Monthly License Fee, or any other charge for which Licensee has the responsibility of payment under this Agreement, within ten (10) Business Days of the date following written notice to Licensee from Licensor, or its designee, of such delinquency, it being understood, however, that Licensor is obligated to provide such notice only two times in each calendar year, and the third instance of the failure to pay the Monthly License Fee or any other charge shall be an immediate default without notice to Licensee if not paid within ten (10) Business Days of the date when due; (ii) except for a PCN Default for which the cure period is set forth in clause (iv) below, any failure of Licensee to perform or observe any term, covenant, provision or condition of this Agreement which failure is not corrected or cured by Licensee within thirty (30) days of receipt by Licensee of written notice from Licensor, or its designee, of the existence of such a default; except such thirty (30) day cure period shall be extended as reasonably necessary to permit Licensee to complete a cure so long as Licensee commences the cure within such thirty (30) day cure period and thereafter continuously and diligently pursues and completes such cure; (iii) failure of Licensee to abide by the Interference provisions as set forth in Section 11; (iv) a PCN Default occurs that Licensee fails to cure within ten (10) Business Days of Licensor's written notice to Licensee, or its designee of the existence of such default; (v) Licensee shall become bankrupt, insolvent or file a voluntary petition in bankruptcy, have an involuntary petition in bankruptcy filed against Licensee which cannot be or is not dismissed by Licensee within sixty (60) days of

the date of the filing of the involuntary petition, file for reorganization or arrange for the appointment of a receiver or trustee in bankruptcy or reorganization of all or a substantial portion of Licensee's assets, or Licensee makes an assignment for such purposes for the benefit of creditors; (vi) this Agreement or Licensee's interest herein or Licensee's interest in the Tower Facility are executed upon or attached; (vii) Licensee commits or fails to perform an act which results in a default under or nonconformance with the Ground Lease by Licensor and the same shall not be cured within five (5) Business Days (or such shorter time as permitted under the Ground Lease to cure) of the date following written notice to Licensee from Licensor, or its designee, of such default; or (viii) the imposition of any lien on the Approved Equipment except as may be expressly authorized by this Agreement, or an attempt by Licensee or anyone claiming through Licensee to encumber Licensor's interest in the Tower Facility, and the same shall not be dismissed or otherwise removed within ten (10) Business Days of written notice from Licensor to Licensee.

22. REMEDIES.

In the event of a default or a breach of this Agreement by Licensee and after Licensee's failure to cure the same within the time allowed Licensee to cure such default, if applicable, then Licensor may, in addition to all other rights or remedies Licensor may have hereunder at law or in equity, (i) terminate this Agreement by giving written notice to Licensee, stating the date upon which such termination shall be effective, accelerating and declaring to be immediately due and payable the then present value of all Monthly License Fees and other charges or fees which would have otherwise been due Licensor absent a breach of this Agreement by Licensee, discounted by an annual percentage rate equal to five percent (5%), (ii) terminate electrical power to the Approved Equipment, and/or (iii) remove the Approved Equipment without being deemed liable for trespass or conversion and store the same at Licensee's sole cost and expense for a period of thirty (30) days after which the Approved Equipment, other than Hazardous Substances, will be deemed conclusively abandoned if not claimed by Licensee. Licensee shall pay all reasonable attorney's fees, court costs, removal and storage fees (including any damage caused thereby), and other items of cost reasonably incurred by Licensor in recovering the Monthly License Fee or other fee or charge. Licensee shall not be permitted to claim the Approved Equipment until Licensor has been reimbursed for removal and storage fees. Past due amounts under this Agreement will bear interest from the date upon which the past due amount was due until the date paid at a rate equal to eighteen percent (18%) per annum, or at a lower rate if required by law in the state in which this Agreement is to be performed. In addition, Licensee shall be assessed a late payment fee equal to twenty-five percent (25%) of the then-current Monthly License Fee for any payment or reimbursement due to Licensor under this Agreement which is overdue by ten (10) days or more and such fee shall be assessed for each thirty (30) day period thereafter that any such amount (or portion thereof) remains unpaid.

23. GOVERNMENTAL APPROVALS; PERMITS.

In the event that any governmental permit, approval or authorization required for Licensor's use of, operation of, or right to license space to Licensee at the Tower Facility is terminated or withdrawn by any governmental authority or third party as part of any governmental, regulatory, or legal proceeding, Licensor may terminate this Agreement. Licensee hereby agrees that in the event of a governmental or legal order requiring the removal of the Approved Equipment from the Tower, the modification of the Tower, or the removal of the Tower, Licensee shall remove the Approved Equipment promptly, but in no event later than the date required by such order, at Licensee's sole cost and expense. Licensor shall cooperate with Licensee in Licensee's efforts to obtain any permits or other approvals that may be necessary for Licensee's installation and operation of the Approved Equipment, provided that Licensor shall not be required to expend any funds or undertake any liability or obligation in connection with such cooperation. Licensor may elect to obtain such required approvals or permits on Licensee's behalf, at Licensee's sole cost and expense. In no event may Licensee encourage, suggest, participate in or permit the imposition of any restrictions or additional obligations whatsoever on the Tower Facility or Licensor's current or future use or ability to license space at the Tower Facility as part of or in exchange for obtaining any such approval or permit. In the event that Licensee's shelter or cabinets are installed above a third-party or Licensor-owned shelter or building, Licensee shall be solely responsible for obtaining any required approvals, or permits in connection with such shelter or cabinet installation, excepting the consent of other users at the Tower Facility and/or the ground landlord which shall remain the sole responsibility of Licensor where required.

24. REPLACEMENT OF TOWER/RELOCATION OF APPROVED EQUIPMENT.

(a) **Replacement of Tower.** Licensor may, at its election, replace or rebuild the Tower or a portion thereof. Such replacement will (i) be at Licensor's sole cost and (ii) not result in an interruption of Licensee's communications services beyond that which is necessary to replace the existing Tower. If Licensee, in Licensee's reasonable discretion, cannot operate the Approved Equipment from the existing Tower during such replacement or rebuild of the Tower, Licensee may establish, at Licensee's sole cost, a temporary facility on the Tower Facility to provide such services as Licensee deems necessary during any such construction by Licensor so long as adequate space is then available. The location of such temporary facilities shall be subject to Licensor's approval. The Monthly License Fee due hereunder shall be abated for any period during which Licensee is prevented from broadcasting from the existing Tower due to such replacement or relocation. At the request of either Party, Licensor and Licensee shall enter into an amendment to this Agreement to clarify the rights of Licensor and Licensee to the new Tower Facility.

(b) **INTENTIONALLY OMITTED.** Intentionally omitted.

(c) **Tower Removal:** If during the term of this Agreement Licensor determines based on engineering structural standards generally applied to communications towers that the Tower is or has become structurally unsound such that pursuant to generally accepted industry safety standards the Tower or a portion thereof must be removed, then, upon ninety (90) days' prior written notice to Licensee, Licensor may, in its sole discretion either (i) remove the Tower and terminate this Agreement effective as of the date of such removal, or (ii) modify the Tower and relocate Licensee's Approved Equipment to an alternative location on the modified Tower. If Licensee and Licensor are not able to agree on an alternative location on the modified Tower for the installation of Licensee's Approved Equipment within the foregoing ninety (90) day notice period, then Licensee or Licensor may elect to terminate this Agreement.

25. EMISSIONS.

If antenna power output ("**RF Emissions**") is presently or hereafter becomes subject to any restrictions imposed by the FCC or other governmental agency for RF Emissions standards on Maximum Permissible Exposure ("**MPE**") limits, or if the Tower Facility otherwise becomes subject to federal, state or local rules, regulations, restrictions or ordinances, Licensee shall comply with Licensor's reasonable requests for modifications to the Approved Equipment which are reasonably necessary for Licensor to comply with such limits, rules, regulations, restrictions or ordinances and Licensor shall use commercially reasonable efforts to cause all other licensees of the Tower Facility to promptly comply. If Licensor requires an engineering evaluation or other power density study to be performed to evaluate RF Emissions compliance with MPE Limits, then all reasonable costs of such evaluation or study shall be paid proportionately by Licensee and all other licensees of the Tower within thirty (30) days of Licensor's request therefor. If said study or a study sponsored by any governmental agency indicates that RF Emissions at the Tower Facility do not comply with MPE limits, then Licensee and Licensor, each for itself, shall immediately take any and all steps necessary to ensure that it is individually in compliance with such limits, up to and including cessation of operation, until a maintenance program or other mitigating measures can be implemented to comply with MPE and in addition, Licensor shall use commercially reasonable efforts to cause all other licensees of the Tower to take similar steps necessary to ensure that they are individually in compliance with such limits.

26. ENVIRONMENTAL.

Licensee covenants that it will not use, store, dispose, or release any Hazardous Substances on the Tower Facility in violation of Applicable Law. Licensee agrees to indemnify and save harmless Licensor against any and all Claims, liabilities, causes of action, Damages, orders, judgments, and clean-up costs arising from Licensee's breach of any of the covenants contained in this Section 26. The obligations of Licensee to indemnify Licensor pursuant to this Section 26 shall survive the termination or expiration of this Agreement.\

27. SUBROGATION.

(a) **Waiver.** Licensor and Licensee waive all rights against each other and any of their respective consultants and contractors, agents and employees, for Damages caused by perils to the extent covered by the proceeds of the insurance provided herein, except such rights as they may have to the insurance proceeds. All insurance policies required under this Agreement shall contain a waiver of subrogation provision under the terms of which the insurance carrier of a Party waives all of such carrier's rights to proceed against the other Party. Licensee's insurance policies shall provide such waivers of subrogation by endorsement. Licensee shall require by appropriate agreements, written where legally required for validity, similar waivers from its contractors and subcontractors. A waiver of subrogation shall be effective as to a person or entity even though that person or entity would otherwise have a duty of indemnification, contractual or otherwise, did not pay the insurance premium directly or indirectly, and whether or not the person or entity had an insurable interest in the property damaged.

(b) **Mutual Release.** Notwithstanding anything in this Agreement to the contrary, Licensor and Licensee each release the other and its respective affiliates, employees and representatives from any Claims by them or any one claiming through or under them by way of subrogation or otherwise for Damage to any person or to the Tower Facility and to the fixtures, personal property, improvements and alterations in or on the Tower Facility that are caused by or result from risks insured against under any insurance policy carried by each and required by this Agreement, provided that such releases shall be effective only if and to the extent that the same do not diminish or adversely affect the coverage under such insurance policies and only to the extent of the proceeds received from such policy.

28. GOVERNING LAW.

This Agreement shall be governed by the laws of the state in which the Tower Facility is located, with the exception of its choice of laws provisions. If any provision of this Agreement is found invalid or unenforceable under judicial decree or decision, the remaining provisions of this Agreement shall remain in full force and effect. Any approval, consent, decision, or election to be made or given by a Party may be made or given in such Party's sole judgment and discretion, unless a different standard (such as reasonableness or good faith) is provided for explicitly.

29. MISCELLANEOUS.

Upon Licensor's written request, Licensee shall promptly furnish Licensor with complete and accurate information in response to any reasonable request by Licensor for information about any of the Approved Equipment or utilities utilized by Licensee at the Tower Facility or any of the channels and frequencies utilized by Licensee thereon. In the event that this Agreement is executed by Licensor, its Affiliates or any trade name utilized by Licensor or its Affiliates and such signatory does not hold the real Tower Facility or leasehold interest in the affected Tower Facility, the execution of this Agreement shall be deemed to have been properly executed by Licensor or Licensor's Affiliate which properly holds such interest in the affected Tower Facility. Upon the termination or expiration of this Agreement, Licensee shall immediately upon the request of Licensor deliver a release of any instruments of record evidencing such Agreement. Notwithstanding the expiration or earlier termination of this Agreement, Sections 15, 16, 17, and 26 shall survive the expiration or earlier termination of this Agreement. No waiver of any of the provisions of this Agreement shall constitute a waiver of any other provision herein (whether or not similar), nor shall such waiver constitute a continuing waiver unless expressly agreed to in writing by the affected Party. This Agreement constitutes the entire agreement of the Parties hereto concerning the subject matter herein and shall supersede all prior offers, negotiations and agreements, whether written or oral. No revision of this Agreement shall be valid unless made in writing and signed by authorized representatives of both Parties. This Agreement may be executed in any number of counterparts, each of which shall be an original, but all of which together shall constitute but one instrument..

30. LEVINE ACT CAMPAIGN CONTRIBUTION DISCLOSURE.

Licensor has disclosed to the County using Exhibit "D" – Levine Act Campaign Contribution Disclosure, whether it has made any campaign contributions of more than \$500 to any member of the Board of Supervisors or County elected officer [Sheriff, Assessor-Recorder-Clerk, Auditor-Controller/Treasurer/Tax

Collector and the District Attorney] within the earlier of: (1) the date of the submission of Licensor's proposal to the County, or (2) 12 months before the date this License was approved by the Board of Supervisors. Licensor acknowledges that under Government Code section 84308, Licensor is prohibited from making campaign contributions of more than \$500 to any member of the Board of Supervisors or other County elected officer for 12 months after the County's consideration of the License.

In the event of a proposed amendment to this License, the Licensor will provide the County a written statement disclosing any campaign contribution(s) of more than \$500 to any member of the Board of Supervisors or other County elected officer within the preceding 12 months of the date of the proposed amendment.

Campaign contributions include those made by any agent/person/entity on behalf of the Licensor or by a parent, subsidiary or otherwise related business entity of Licensor.

31. CONFIDENTIALITY.

The Parties Agree and acknowledge the Agreement is subject to the San Bernardino County Sunshine Ordinance, County Code of Ordinances Section 19.0101 et seq., California Government Code 54950 et seq., and California Public Records Act (Government Code Section 7920.000 et seq.).

The submission of this Agreement for examination and negotiation does not constitute an offer to license, or a reservation of, or option for, any portion of the Tower Facility, and Licensee shall have no right to use or occupy any portion of the Tower Facility or any appurtenant easement area hereunder until the execution and delivery of this Agreement by both Licensor and Licensee.

ATTACHED EXHIBITS:

- Exhibit A: List of Approved Equipment and location of the Licensed Space
- Exhibit B: Site Drawings indicating the location of Ground Space for Licensee's equipment shelter or space in Licensor's building (as applicable)
- Exhibit C: As-Built Drawings or Construction Drawings to be attached within forty-five (45) days after the Commencement Date in accordance with Section 3
- Exhibit D: Levine Act Campaign Contribution Disclosure
- Appendix I: Definitions
- Appendix II: Insurance

Exhibit A

List of Approved Equipment and location of the Licensed Space

Exhibit A						
Customer Name: COUNTY OF SAN BERNARDINO		ATC Asset Name: BARSTOW TOWER #1 P			ATC Asset #: 204144	
Customer Site Name: N/A				Customer Site #: N/A		
GROUND SPACE REQUIREMENTS						
Total Lease Area Sq.Ft: 52.00	Primary Contiguous Lease Area	L: 6.00'	W: 2.00'	H: 3.00'	Sq.Ft: 12.00	
	ATC Building	6.00'	2.00'	3.00'	Incl.	
	Outside Primary Lease Area	N/A	N/A	N/A	Sq.Ft: 40.00	
	Generator AREA	4.00'	10.00'	N/A	40.00	
BACKUP POWER REQUIREMENTS						
Generator: Stand Alone	Fuel Tank Size (gal): 50.0	Fuel Type: Diesel	Fuel Tank Setback (radius): N/A			
UTILITY REQUIREMENTS						
Power Provided By: Utility Company Direct						
Telco/Interconnect: N/A						
TRANSMITTER & RECEIVER SPECIFICATIONS						
Type: N/A	Quantity: N/A	TX Power (watts): N/A			ERP Power (watts): N/A	
EQUIPMENT SPECIFICATIONS						
Type	OMNI	OMNI	DISH-HP	N/A	N/A	N/A
Manufacturer	dbSpectra	dbSpectra	Commscope	N/A	N/A	N/A
Model #	DS7C06P36U-D	DS7C06P36U-D	VHLP3-11W/A	N/A	N/A	N/A
Dimensions HxWxD	100.8" x 2.5" x 2.5"	100.8" x 2.5" x 2.5"	3.27" x 3.27" x 1.43"	N/A	N/A	N/A
Weight (lbs.)	29.0	29.0	37.4	N/A	N/A	N/A
Location	Tower	Tower	Tower	N/A	N/A	N/A
RAD Center AGL	140.0'	70.0'	40.0'	N/A	N/A	N/A
Tip Height	144.2'	74.2'	41.6'	N/A	N/A	N/A
Base Height	135.8'	65.8'	38.4'	N/A	N/A	N/A
Mount Type	N/A	N/A	N/A	N/A	N/A	N/A
Quantity	1	1	1	N/A	N/A	N/A
Azimuths/Dir. of Radiation	360	360	4.48	N/A	N/A	N/A
Quant. Per Azimuth/Sector	1	1	1	N/A	N/A	N/A
TX/RX Frequency Units	MHz	MHz	MHz	N/A	N/A	N/A
TX Frequency	764	764	11,200	N/A	N/A	N/A
RX Frequency	869	869	10,700	N/A	N/A	N/A
Using Unlicensed Frequencies?	No	No	No	N/A	N/A	N/A
Antenna Gain	5.9	5.9	39	N/A	N/A	N/A
Total # of Lines	1	1	1	N/A	N/A	N/A
Individual Line Configuration	Qty: 1 Type: Coax Diameter: 7/8" Coax Azimuth/Sector: 1	Qty: 1 Type: Coax Diameter: 7/8" Coax Azimuth/Sector: 1	Qty: 1 Type: Elliptical Diameter: EW90 Azimuth/Sector: 1	N/A	N/A	N/A
Conduit Configuration	N/A	N/A	N/A	N/A	N/A	N/A

Exhibit B

**Site Drawing indicating the location of Ground Space for Licensee's equipment shelter
or space in Licensor's building (as applicable)**

Licensee shall not commence installation until Licensor has approved in writing said drawing and attached it hereto.

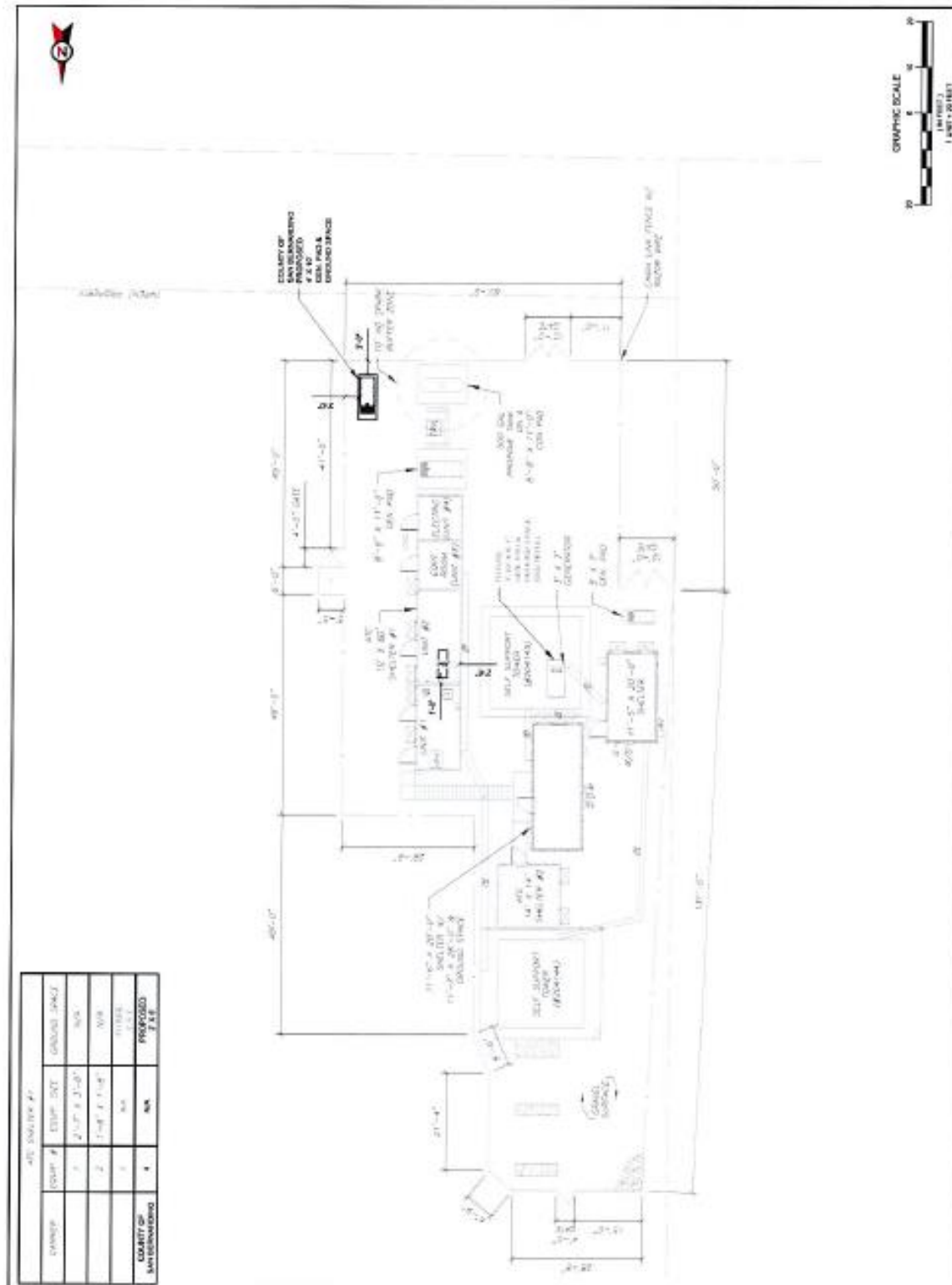

Exhibit C

As Built Drawings or Construction Drawings

To be attached hereto within forty-five (45) days after the Commencement Date.

EXHIBIT "D"



Levine Act Campaign Contribution Disclosure (formerly referred to as Senate Bill 1439)

The following is a list of items that are not covered by the Levine Act. A Campaign Contribution Disclosure Form will not be required for the following:

- Contracts that are competitively bid and awarded as required by law or County policy
- Contracts with labor unions regarding employee salaries and benefits
- Personal employment contracts
- Contracts under \$50,000
- Contracts where no party receives financial compensation
- Contracts between two or more public agencies
- The review or renewal of development agreements unless there is a material modification or amendment to the agreement
- The review or renewal of competitively bid contracts unless there is a material modification or amendment to the agreement that is worth more than 10% of the value of the contract or \$50,000, whichever is less
- Any modification or amendment to a matter listed above, except for competitively bid contracts.

DEFINITIONS

Actively supporting the matter: (a) Communicate directly with a member of the Board of Supervisors or other County elected officer [Sheriff, Assessor-Recorder-Clerk, District Attorney, Auditor-Controller/Treasurer/Tax Collector] for the purpose of influencing the decision on the matter; or (b) testifies or makes an oral statement before the County in a proceeding on the matter for the purpose of influencing the County's decision on the matter; or (c) communicates with County employees, for the purpose of influencing the County's decision on the matter; or (d) when the person/company's agent lobbies in person, testifies in person or otherwise communicates with the Board or County employees for purposes of influencing the County's decision in a matter.

Agent: A third-party individual or firm who, for compensation, is representing a party or a participant in the matter submitted to the Board of Supervisors. If an agent is an employee or member of a third-party law, architectural, engineering or consulting firm, or a similar entity, both the entity and the individual are considered agents.

Otherwise related entity: An otherwise related entity is any for-profit organization/company which does not have a parent-subsidary relationship but meets one of the following criteria:

- (1) One business entity has a controlling ownership interest in the other business entity;
- (2) there is shared management and control between the entities; or
- (3) a controlling owner (50% or greater interest as a shareholder or as a general partner) in one entity also is a controlling owner in the other entity.

For purposes of (2), "shared management and control" can be found when the same person or substantially the same persons own and manage the two entities; there are common or commingled funds or assets; the business entities share the use of the same offices or employees, or otherwise share activities, resources, or personnel on a regular basis; or there is otherwise a regular and close working relationship between the entities.

Parent-Subsidiary Relationship: A parent-subsidiary relationship exists when one corporation has more than 50 percent of the voting power of another corporation.

Licensor must respond to the questions on the following page. If a question does not apply respond N/A or Not Applicable.

1.	Name of Licensor:	California Tower, Inc.	
2.	Is the entity listed in Question No. 1 a non-profit organization under Internal Revenue Code section 501(c)(3)?	No	
	Yes <input type="checkbox"/> If yes, skip Question Nos. 3 - 4 and go to Question No. 5.		
3.	Name of Principal (i.e., CEO/President) of entity listed in Question No. 1, <u>if</u> the individual actively supports the matter <u>and</u> has a financial interest in the decision:	California Tower, Inc. is a wholly owned subsidiary of American Tower Corporation; Steven Vondran is the CEO of American Tower Corporation	
4.	If the entity identified in Question No.1 is a corporation held by 35 or less shareholders, and not publicly traded ("closed corporation"), identify the major shareholder(s):	n/a	
5.	Name of any parent, subsidiary, or otherwise related entity for the entity listed in Question No. 1 (see definitions above):		
	Company Name	Relationship	
	American Tower Corporation	Parent company of California Tower, Inc.	
6.	Name of agent(s) of Licensor:		
	Company Name	Agent(s)	Date Agent Retained (if less than 12 months prior)
	California Tower, Inc., a wholly owned subsidiary of American Tower Corporation	Richard Palermo, Senior Counsel, for American Tower Corporation	
7.	Name of Subcontractor(s) (including Principal and Agent(s)) that will be providing services/work under the awarded contract if the subcontractor (1) actively supports the matter <u>and</u> (2) has a financial interest in the decision <u>and</u> (3) will be possibly identified in the contract with the County or board governed special district:		
	Company Name	Subcontractor(s):	Principal and/or Agent(s):
	n/a		

8. Name of any known individuals/companies who are not listed in Questions 1-7, but who may (1) actively support or oppose the matter submitted to the Board and (2) have a financial interest in the outcome of the decision:

Company Name	Individual(s) Name
n/a	

9. Was a campaign contribution, of more than \$500, made to any member of the San Bernardino County Board of Supervisors or other County elected officer within the prior 12 months, by any of the individuals or entities listed in Question Nos. 1-8?

No ☒ If no, please skip Question No. 10.

Yes ☐ If yes, please continue to complete this form.

10. Name of Board of Supervisor Member or other County elected officer: _____

Name of Contributor: _____

Date(s) of Contribution(s): _____

Amount(s): _____

Please add an additional sheet(s) to identify additional Board Members or other County elected officers to whom anyone listed made campaign contributions.

By signing below, Licensor certifies that the statements made herein are true and correct. Licensor understands that the individuals and entities listed in Question Nos. 1-8 are prohibited from making campaign contributions of more than \$500 to any member of the Board of Supervisors or other County elected officer while this matter is pending and for 12 months after a final decision is made by the County.



Signature

Richard Palermo, Senior Counsel,

Print Name

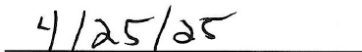

Date

for California Tower, Inc., a wholly owned
subsidiary of American Tower Corporation

Print Entity Name, if applicable

Appendix I

Defined Terms

Affiliate(s): Any corporation, partnership, limited liability company or other entity that (i) is controlled directly or indirectly (through one or more subsidiaries) by Licensee, (ii) is the successor or surviving entity by a merger or consolidation of Licensee pursuant to Applicable Law, or (iii) purchases all or substantially all of the assets of Licensee. For purposes of this definition, “**control**” means the possession of the right the ownership of fifty percent (50%) or more of the shares with voting rights to effectively direct business decisions of the subject entity. Licensee Affiliates include local government agencies, departments and Board-governed special districts, or other local governmental body or corporation, including applicable K-12 schools and community colleges, where Licensee is authorized and empowered to expend public funds for such entity located within San Bernardino County’s applicable jurisdictional and geographical boundaries

Agreement: defined in the introductory paragraph.

Annual Escalator: defined in Section IV.

Applicable Law: All applicable statutes, ordinances, laws, regulations and directives of any federal, state or local governmental unit, authority or agency having jurisdiction over a Licensed Space or affecting the rights and obligations of Licensor or Licensee under this Agreement, including without limitation, the Communications Act of 1934, as amended from time to time, FCC Rules and Regulations, and the rules, regulations and written policies and decisions of the FAA.

Application: defined in Section IV.

Application Fee: defined in Section IV.

Approved Equipment: the communications system, including antennas, radio equipment, cabling and conduits, shelter and/or cabinets and other personal property owned or operated by Licensee at the Licensed Space, as defined in Exhibit A or B to this Agreement.

BLM: defined in Subsection 5(d).

Business Day: a day other than a Saturday, Sunday or legal holiday for commercial banks under the laws of the United States or the state or county in which the Tower Facility is located.

Claims: demands, claims, suits, actions, proceedings or investigations brought against a Party by an unrelated or unaffiliated person or entity.

Commencement Date: defined in Section IV.

Common Expenses: defined in Section 7.

Connection Fee: defined in Section 5(b).

Construction Drawings: defined in Section 3.

County: San Bernardino County

Damages: debts, liabilities, obligations, losses, damages, excluding consequential or punitive damages, costs and expenses, interest (including, without limitation, prejudgment interest), penalties, reasonable legal fees, court costs, disbursements and costs of investigations, deficiencies, levies, duties and imposts.

Easement: defined in Section 2.

Effective Date: defined in the introductory paragraph.

FAA: the United States Federal Aviation Administration or any successor federal agency established for the same or similar purpose.

FCC: the United States Federal Communications Commission or any successor federal agency established for the same or similar purpose.

FCC Rules and Regulations: All of the rules, regulations, public guidance, written policies and decisions governing telecommunications generally and wireless telecommunications specifically as promulgated and administered by the FCC, which on the Effective Date includes, but is not limited to, those administered by the Wireless Telecommunications Bureau of the FCC and more specifically referenced as the Code of Federal Regulations, title 47, parts 0 through 101, as amended.

Final Rule: defined in Subsection 11(g).

Ground Lease: defined in Section 20.

Ground Space: The portion of the Tower Facility licensed for use by Licensee to locate a portion of the Approved Equipment thereon, in the square footage amount depicted on Exhibit B of this Agreement. In no event shall the Ground Space include the air space or rights above the Approved Equipment located in the Ground Space.

Hazardous Substances: Any hazardous material or substance which is or becomes defined as a hazardous substance, pollutant or contaminant subject to reporting, investigation or remediation pursuant to Applicable Law; any substance which is or becomes regulated by any federal, state or local governmental authority; and any oil, petroleum products and their by-products.

Holdover Fee: defined in Subsection 6(c).

Indemnified Party: any person or entity entitled to indemnification under Section 15 hereof.

Indemnifying Party: any person or entity obligated to provide indemnification under Section 15 hereof.

Initial Term: defined in Section IV and referenced in Subsection 6(c).

Interference: defined in Subsection 11(a)(i).

Labeling Fee: defined in Section 9.

Licensed Frequencies: defined in Subsection 11(a)(ii).

Licensed Space: Location of the Approved Equipment on the Tower and at the Ground Space as more specifically described in Exhibits A and B attached hereto.

Licensed User: defined in Subsection 11(a)(iii).

Licensee: defined in the introductory paragraph.

Licensor: defined in the introductory paragraph.

Monthly License Fee: defined in Section IV and referenced in Subsection 5(a).

MPE: defined in Section 25.

Notice Address: defined in Section 18.

NTP (Notice to Proceed): Written notice from Licensor to Licensee acknowledging that all required documentation for the construction and installation of the Approved Equipment has been received and approved by Licensor and Licensee is authorized to commence its installation of the Approved Equipment at the Licensed Space, as more particularly set forth in Subsection 10(a) of this Agreement.

Party(ies): Licensor or Licensee.

PCN Default: defined in Subsection VI.A.

PCN Retention Fee: defined in Subsection VI.A.

PCNs: defined in Subsection VI.A.

Permitted Frequencies: defined in Section III.

Priority User: defined in Subsection 11(a)(iv).

Remittance Address: defined in Section II.

Renewal Term(s): defined in Section IV and referenced in Subsection 6(b).

RF Emissions: defined in Section 25.

Site Inspection Fee: defined in Section IV.

SSIS: defined in Subsection 10(b).

SSIS Fee: defined in Subsection 10(b).

Structural Analysis Fee: defined in Subsection 10(b).

Submeter Installation Fee: defined in Section IV.

Subsequent User: defined in Subsection 11(a)(v).

Term: Initial Term and each Renewal Term which is affected pursuant to Section 6 of this Agreement.

Tower: A communications or broadcast tower owned and operated by Licensor and located at the Tower Facility.

Tower Facility: Certain real property owned, leased, subleased, licensed or managed by Licensor shown on page 1 of this Agreement, on which a Tower owned, leased, licensed or managed by Licensor is located.

Unlicensed Frequencies: defined in Subsection 11(a)(vi).

Unlicensed User: defined in Subsection 11(a)(vii).

Utility Change Event: defined in Subsection 5(b).

Utility Fee: defined in Section IV.

USFS: defined in Section 5(d).

Work: all work relating to the construction, installation, relocation and reconfiguration of Licensee's Approved Equipment at the Tower Facility, including without limitation, construction management, construction of an equipment pad, installation or modification of lines, antennas, shelters and equipment cabinets.

Appendix II

Insurance

A. Licensor shall maintain in full force during the Term of this Agreement the following insurance:

1. Worker's Compensation Insurance with statutory limits in accordance with all applicable state, federal and maritime laws, and Employers' Liability Insurance with minimum limits of Five Hundred Thousand and 00/100 Dollars (\$500,000.00) per accident/occurrence, or in accordance with all applicable state, federal and maritime laws.
2. Commercial General Liability Insurance (Bodily Injury and Tower Facility Damage), the limits of liability of which shall not be less than One Million and 00/100 Dollars (\$1,000,000.00) per occurrence.
3. An umbrella policy of not less than Five Million and 00/100 Dollars (\$5,000,000.00).

The above insurance shall provide that Licensee will receive not less than thirty (30) days written notice prior to any cancellation of, or material change in coverage. The insurance specified in this Item A shall contain a waiver of subrogation against Licensee and shall name Licensee as an additional insured, and shall be primary over any insurance coverage in favor of Licensee but only with respect to and to the extent of the insured liabilities assumed by Licensor under this Agreement and shall contain a standard cross-liability endorsement.

B. Licensee shall maintain in full force during the Term of this Agreement and shall cause all contractors or subcontractors performing Work on any Licensed Space prior to the commencement of any such Work on behalf of Licensee to maintain the following insurance:

1. Worker's Compensation Insurance with statutory limits in accordance with all applicable state, federal and maritime laws, and Employers' Liability Insurance with minimum limits of Five Hundred Thousand and 00/100 Dollars (\$500,000.00) per accident/occurrence, or in accordance with all applicable state, federal and maritime laws.
2. Commercial General Liability Insurance (Bodily Injury and Tower Facility Damage), the limits of liability of which shall not be less than One Million and 00/100 Dollars (\$1,000,000.00) per occurrence.
3. An umbrella policy of not less than Five Million and 00/100 Dollars (\$5,000,000.00).

The above insurance shall provide that Licensor will receive not less than thirty (30) days written notice prior to any cancellation of, or material change in coverage. The insurance specified in this Item B shall contain a waiver of subrogation against Licensor and shall name Licensor as additional insured, and shall be primary over any insurance coverage in favor of Licensor but only with respect to and to the extent of the insured liabilities assumed by Licensee under this Agreement and shall contain a standard cross-liability endorsement.

C. Licensee shall cause all contractors or subcontractors performing Work on any Licensed Space prior to the commencement of any such Work on behalf of Licensee to maintain the following insurance:

1. Worker's Compensation Insurance with statutory limits in accordance with all applicable state, federal and maritime laws, and Employers' Liability Insurance with minimum limits of Five Hundred Thousand and 00/100 Dollars (\$500,000.00) per accident/occurrence, or in accordance with all applicable state, federal and maritime laws.
2. Commercial General Liability Insurance (Bodily Injury and Tower Facility Damage), the limits of liability of which shall not be less than One Million and 00/100 Dollars (\$1,000,000.00) per occurrence.

3. An umbrella policy of not less than Five Million and 00/100 Dollars (\$5,000,000.00).

The above insurance shall provide that Licensor will receive not less than thirty (30) days written notice prior to any cancellation of, or material change in coverage. The insurance specified in this Item C shall contain a waiver of subrogation against Licensor and shall name Licensor as additional insured, and shall be primary over any insurance coverage in favor of Licensor but only with respect to and to the extent of the insured liabilities assumed by Licensee under this Agreement and shall contain a standard cross-liability endorsement.

D. Notwithstanding the foregoing insurance requirements, (a) the insolvency, bankruptcy, or failure of any insurance company carrying insurance for either Party, or failure of any such insurance company to pay Claims accruing, shall not be held to waive any of the provisions of this Agreement or relieve either Party from any obligations under this Agreement, and (b) Licensor reserves the right, from time to time, to increase the required liability limits described above in Items A and/or B in accordance with then-current customary insurance requirements in the tower industry nationally.