

WARNING: ALL INDIVIDUALS INTERESTED IN BIDDING ON THIS PROJECT MUST OBTAIN THE FINAL PLANS AND SPECIFICATIONS FROM THE DEPARTMENT MANAGING THE PROJECT OR AS OTHERWISE STATED IN THE ADVERTISEMENT FOR BIDS FOR THE PROJECT. DO NOT USE THE PLANS AND SPECIFICATIONS POSTED ON THE CLERK OF THE BOARD'S WEBSITE FOR BIDDING ON THIS PROJECT.

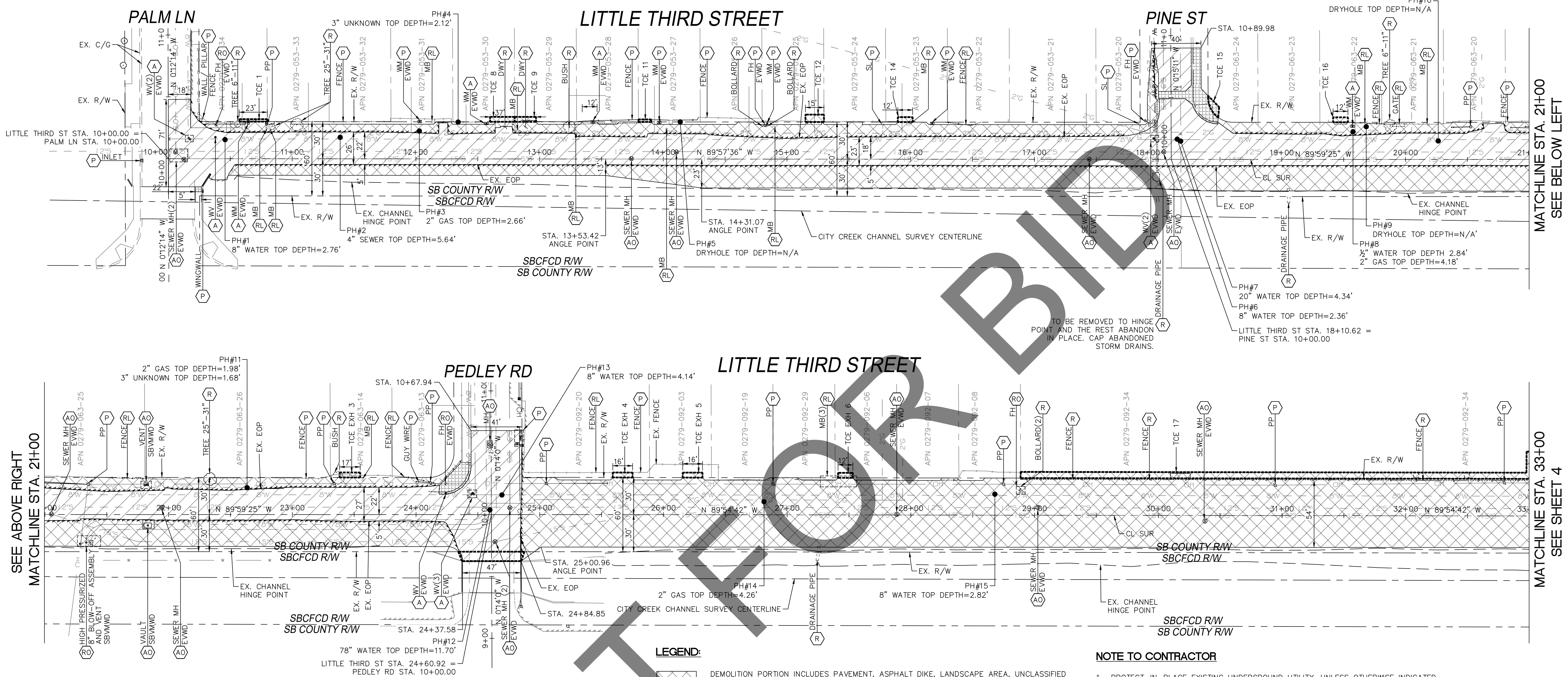

SEE ABOVE RIGHT
MATCHLINE STA. 21+00

MATCHLINE STA. 21+00
SEE BELOW LEFT

MATCHLINE STA. 33+00
SEE SHEET 4

LEGEND:

- DEMOLITION PORTION INCLUDES PAVEMENT, ASPHALT DIKE, LANDSCAPE AREA, UNCLASSIFIED EXCAVATION, BLOCK WALL, FENCE, EXCAVATE NATIVE MATERIAL TO A DEPTH OF 0.80-FT BELOW THE TOP OF PROPOSED FINISHED PAVED ROAD AND AS REQUIRED BELOW PROPOSED PCC OR AS PRACTICAL DESIGN DEPTH ABOVE UTILITY LINES.
- REMOVE AND HAUL EXISTING AC PAVEMENT, SUBGRADE, AND NATIVE 0.40-FT BELOW THE TOP OF PROPOSED PAVED ROAD AND AS REQUIRED BELOW PROPOSED PCC OR AS PRACTICAL DESIGN DEPTH ABOVE UTILITY LINES.
- DEMOLITION CONCRETE CURB & GUTTER, SIDEWALK, DRIVEWAY, CROSS GUTTER, AND CURB RAMP.
- PROTECT
- REMOVE
- RELOCATE
- RELOCATE (BY OTHERS, UTILITY AGENCY NOTED ON PLAN)
- ADJUST TO GRADE (BY OTHERS, UTILITY AGENCY NOTED ON PLAN)
- ADJUST TO GRADE
- ABANDON

NOTE TO CONTRACTOR

1. PROTECT-IN-PLACE EXISTING UNDERGROUND UTILITY, UNLESS OTHERWISE INDICATED.
2. PROTECT-IN-PLACE EXISTING UTILITIES, POLES, VALVES, COVER, FENCE, WALL, WALL PILLAR AND OTHER MISCELLANEOUS FACILITIES, UNLESS OTHERWISE INDICATED.
3. THE CONTRACTOR SHALL NOTIFY THE ENGINEER IN CHARGE AT LEAST 48 HOURS PRIOR TO REMOVAL OF ANY AC OR CONCRETE PAVEMENT.
4. THE CONTRACTOR SHALL VERIFY THE EXACT LOCATION OF SAWCUTTING TO REMOVE AND REPLACE AC OR CONCRETE PAVEMENT WITH THE ENGINEER.
5. ARRANGE FOR HAUL AWAY AND DISPOSAL OF ALL REMOVALS.
6. CUT AND CAP EXISTING IRRIGATION AS NEEDED AND MODIFY IRRIGATION TO MAINTAIN PORTIONS THAT WILL REMAIN.
7. RELOCATE ANY IRRIGATIONS MAINS THAT ARE UNDER PROPOSED SIDEWALKS. SLEEVE IRRIGATION MAINS THAT CROSS UNDER PROPOSED DRIVEWAYS.
8. FOR PAVED AREAS: REMOVE, THE EXISTING ASPHALT. PER DEMOLITION PLAN, AS SHOWN HEREIN.
9. REFER TO SIGNING AND STRIPING PLAN FOR REMOVAL AND RELOCATION OF SIGNS.
10. REFER TO THE SPECIFICATIONS FOR THE POTHOLING REPORT. PER DEMOLITION PLAN, AS SHOWN HEREIN.

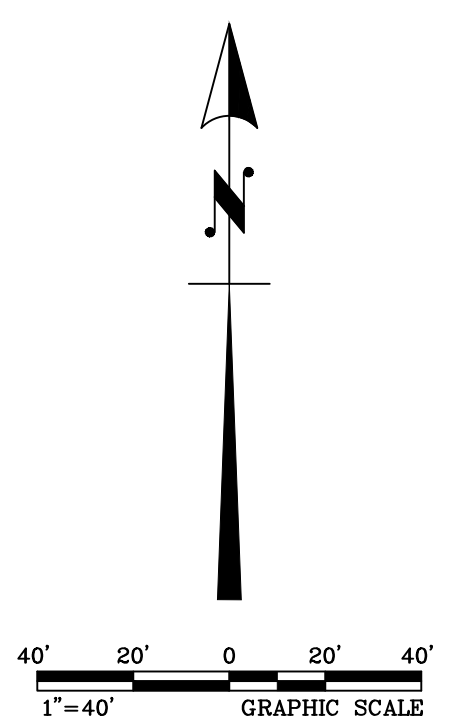

MARK	REVISIONS	APPR.	DATE

MARK	REVISIONS	APPR.	DATE

PLANS PREPARED UNDER THE SUPERVISION OF:

GIUSEPPE S. CANZONIERI
4/15/2024
DATE

MARK	CHANGES	RESIDENT ENGINEER	DATE
	NO CHANGES		

FIELD CHANGES

**SAN BERNARDINO COUNTY
DEPARTMENT OF PUBLIC WORKS**







DESIGNED BY: RP	DRAWN BY: WG	CHECKED BY: AA	RECOMMENDED BY: <i>Chris Nguyen</i> CHRIS NGUYEN ENGINEERING MANAGER 5/16/2024 DATE
APPROVED BY: <i>Eloy Ruvalcaba</i> ELOY RUVALCABA SUPERVISING ENGINEER 5/16/2024 DATE			APPROVED BY: <i>Mervat Mikhail</i> MERVAT MIKHAIL DEPUTY DIRECTOR 5/17/24 DATE

**DEMOLITION PLAN
LITTLE THIRD ST AND LITTLE
TIPPECANOE AVE
SAN BERNARDINO AREA**

J.L. REF. 12034	W.O. NO. H15122	PLAN SCALE 1" = 40'	SHT. NO. 4	TOT. SHT.'S. 15
--------------------	--------------------	------------------------	---------------	--------------------

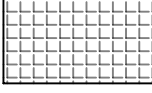
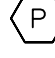
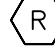
NOT FOR BIDDING

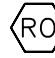
LEGEND:

-  DEMOLITION PORTION INCLUDES PAVEMENT, ASPHALT DIKE, LANDSCAPE AREA, UNCLASSIFIED EXCAVATION, BLOCK WALL, FENCE. EXCAVATE NATIVE MATERIAL TO A DEPTH OF 0.80-FT BELOW THE TOP OF PROPOSED FINISHED PAVED ROAD AND AS REQUIRED BELOW PROPOSED PCC OR AS PRACTICAL DESIGN DEPTH ABOVE UTILITY LINES.
-  REMOVE AND HAUL EXISTING AC PAVEMENT, SUBGRADE, AND NATIVE 0.40-FT BELOW THE TOP OF PROPOSED PAVED ROAD AND AS REQUIRED BELOW PROPOSED PCC OR AS PRACTICAL DESIGN DEPTH ABOVE UTILITY LINES.
-  DEMOLITION CONCRETE CURB & GUTTER, SIDEWALK, DRIVEWAY, CROSS GUTTER, AND CURB RAMP.
-  PROTECT
-  REMOVE
-  RELOCATE
-  RELOCATE (BY OTHERS)
-  ADJUST TO GRADE (BY OTHERS)
-  ADJUST TO GRADE

NOTE TO CONTRACTOR

1. PROTECT-IN-PLACE EXISTING UNDERGROUND UTILITY, UNLESS OTHERWISE INDICATED.
2. PROTECT-IN-PLACE EXISTING UTILITIES, POLES, VALVES, COVER, FENCE, WALL, WALL PILLAR AND OTHER MISCELLANEOUS FACILITIES, UNLESS OTHERWISE INDICATED.
3. THE CONTRACTOR SHALL NOTIFY THE ENGINEER IN CHARGE AT LEAST 48 HOURS PRIOR TO REMOVAL OF ANY AC OR CONCRETE PAVEMENT.
4. THE CONTRACTOR SHALL VERIFY THE EXACT LOCATION OF SAWCUTTING TO REMOVE AND REPLACE AC OR CONCRETE PAVEMENT WITH THE ENGINEER.
5. ARRANGE FOR HAUL AWAY AND DISPOSAL OF ALL REMOVALS.
6. CUT AND CAP EXISTING IRRIGATION AS NEEDED AND MODIFY IRRIGATION TO MAINTAIN PORTIONS THAT WILL REMAIN.
7. RELOCATE ANY IRRIGATIONS MAINS THAT ARE UNDER PROPOSED SIDEWALKS. SLEEVE IRRIGATION MAINS THAT CROSS UNDER PROPOSED DRIVEWAYS.
8. FOR PAVED AREAS: REMOVE, THE EXISTING ASPHALT. PER DEMOLITION PLAN, AS SHOWN HEREIN.
9. REFER TO SIGNING AND STRIPING PLAN FOR REMOVAL AND RELOCATION OF SIGNS.
10. REFER TO THE SPECIFICATIONS FOR THE POTHOLING REPORT. PER DEMOLITION PLAN, AS SHOWN HEREIN.

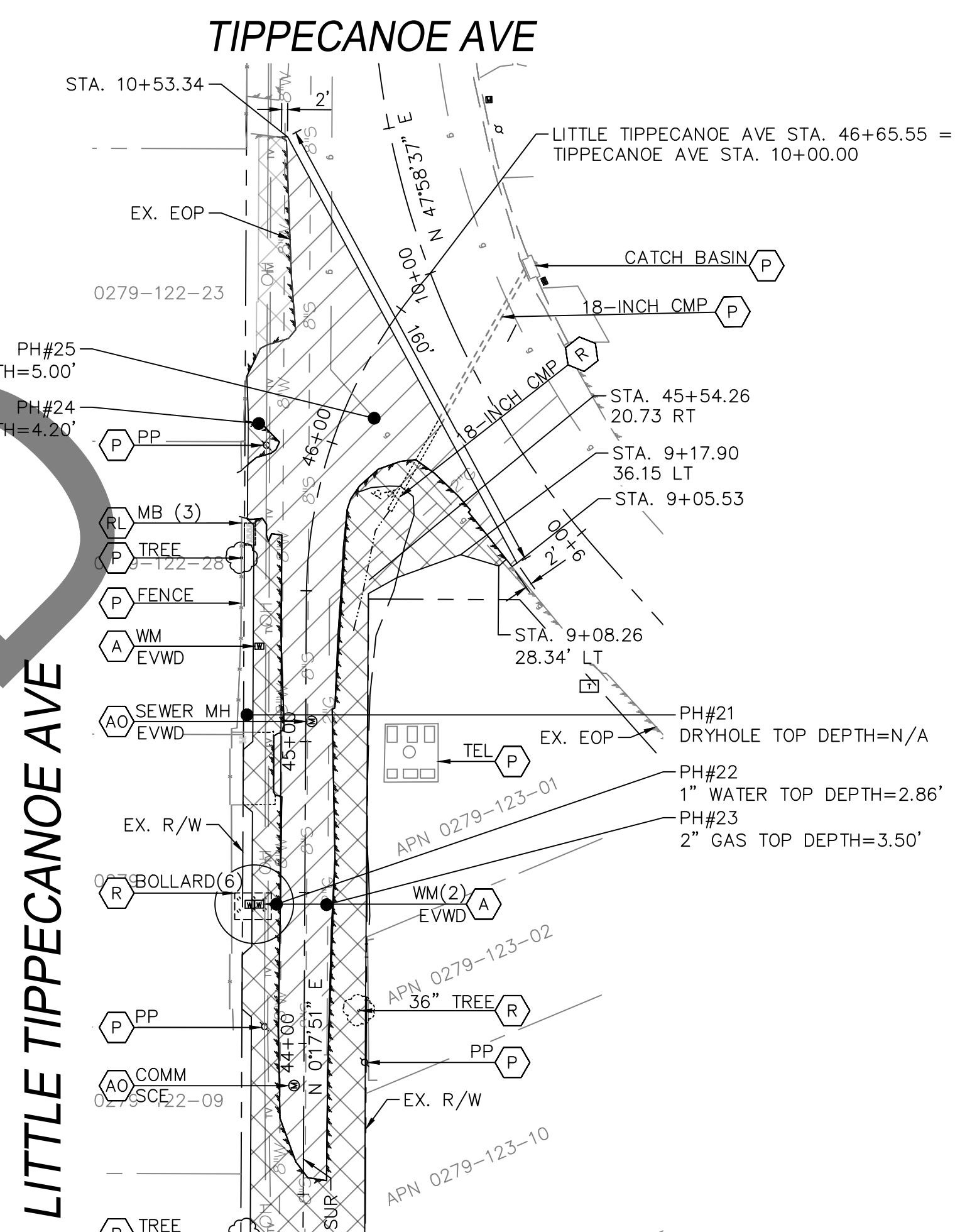
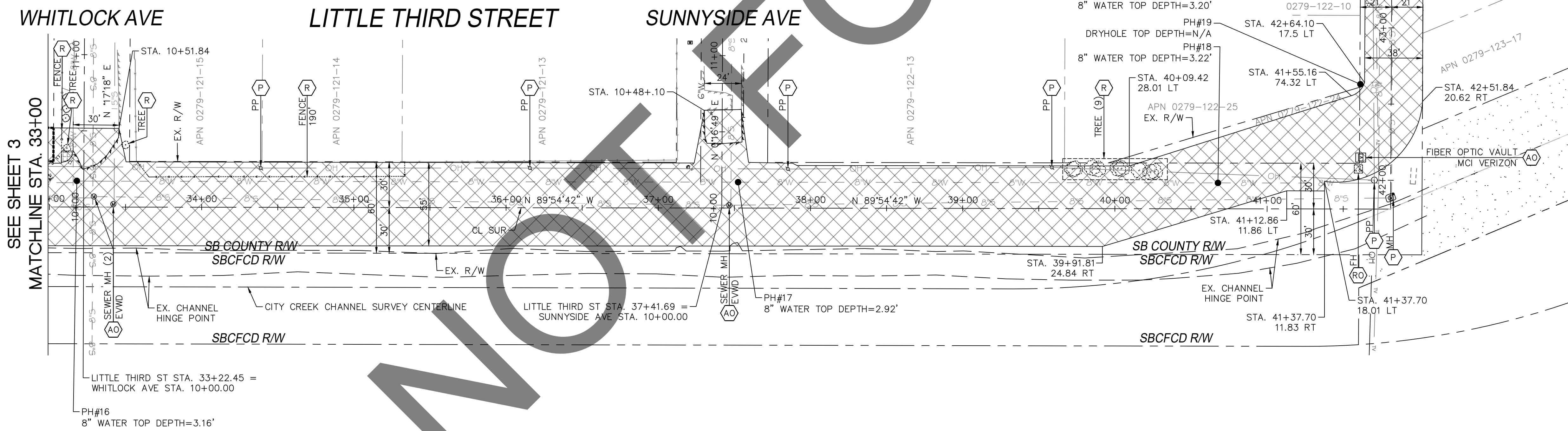

MARK	REVISIONS	APPR.	DATE

MARK	REVISIONS	APPR.	DATE

FILE NO. 497700-010 & 497850-010

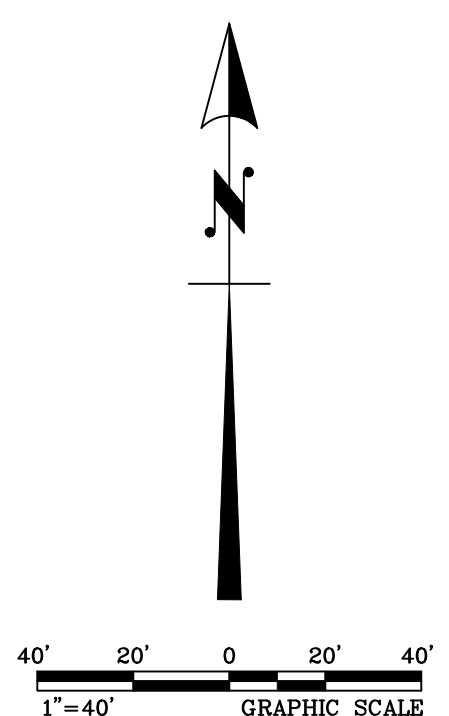

PLANS PREPARED UNDER THE SUPERVISION OF:



KOA
A LOCHNER COMPANY
3190 C. Shelby Street
Ontario, California 91764
Tel: (909) 890-9693 Fax: (909) 890-9694

GIUSEPPE S. CANZONIERI
4/15/2024
DATE



REGISTERED PROFESSIONAL ENGINEER
GIUSEPPE S. CANZONIERI
No. C79006
CIVIL
STATE OF CALIFORNIA

MARK	CHANGES	RESIDENT ENGINEER	DATE

FIELD CHANGES

SAN BERNARDINO COUNTY
DEPARTMENT OF PUBLIC WORKS

DESIGNED BY: RP	DRAWN BY: WG	CHECKED BY: AA	RECOMMENDED BY: CHRIS NGUYEN ENGINEERING MANAGER	5/16/2024 DATE
APPROVED BY: mervat + mikhael			5/17/24 DATE	

ELOY RUVALCABA
SUPERVISING ENGINEER

DEMOLITION PLAN
LITTLE THIRD ST AND LITTLE TIPPECANOE AVE
SAN BERNARDINO AREA

J.L. REF. 12034	W.O. NO. H15122	PLAN SCALE 1" = 40'	SHT. NO. 5	TOT. SHT'S. 15
--------------------	--------------------	------------------------	---------------	-------------------

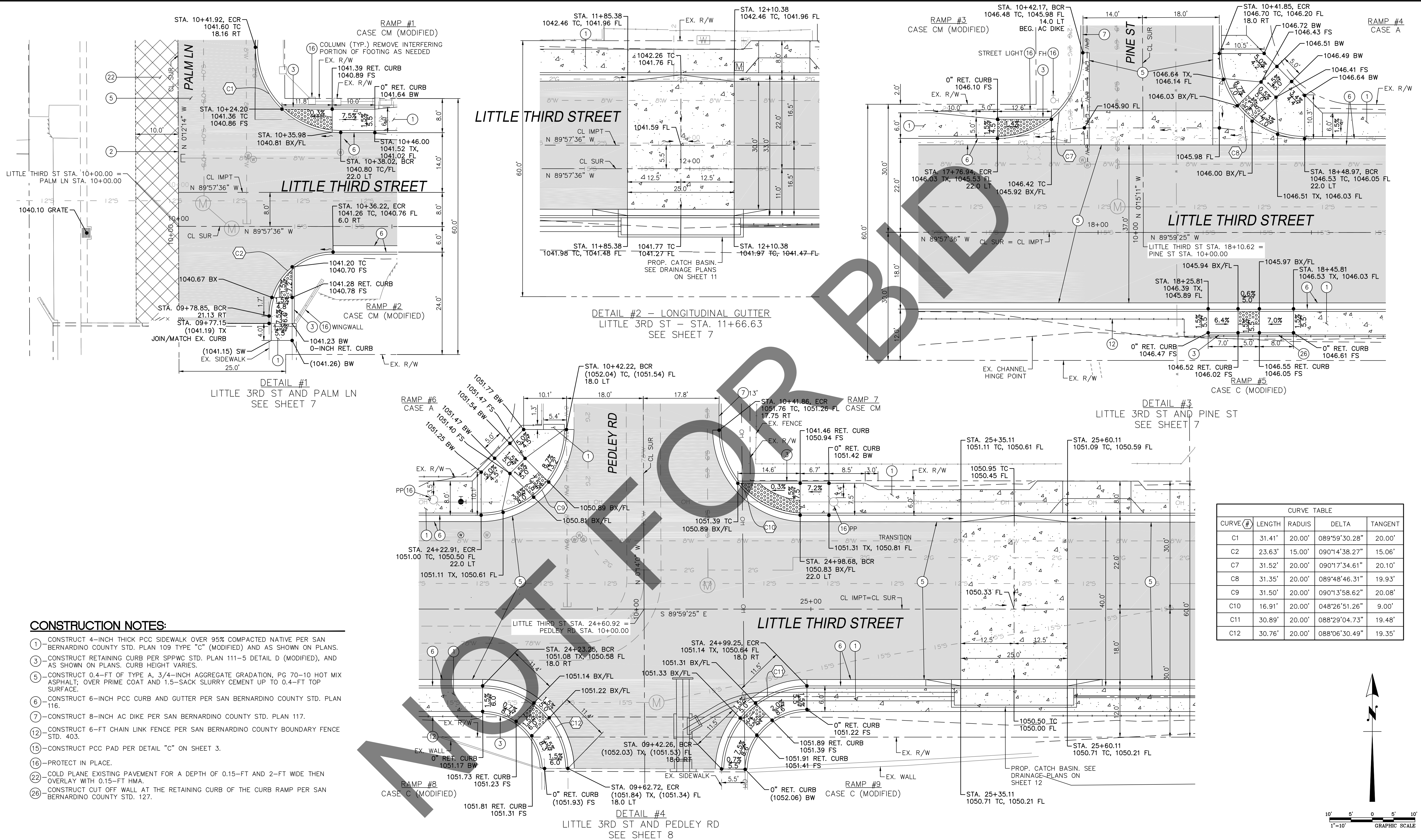

DETAIL #1
LITTLE 3RD ST AND PALM LN
SEE SHEET 7

DETAIL #2 - LONGITUDINAL GUTTER
LITTLE 3RD ST - STA. 11+66.63
SEE SHEET 7

DETAIL #3
LITTLE 3RD ST AND PINE ST
SEE SHEET 7

DETAIL #4
LITTLE 3RD ST AND PEDLEY RD
SEE SHEET 8

CURVE TABLE				
CURVE #	LENGTH	RADIUS	DELTA	TANGENT
C1	31.41'	20.00'	089°59'30.28"	20.00'
C2	23.63'	15.00'	090°14'38.27"	15.06'
C7	31.52'	20.00'	090°17'34.61"	20.10'
C8	31.35'	20.00'	089°48'46.31"	19.93'
C9	31.50'	20.00'	090°13'58.62"	20.08'
C10	16.91'	20.00'	048°26'51.26"	9.00'
C11	30.89'	20.00'	088°29'04.73"	19.48'
C12	30.76'	20.00'	088°06'30.49"	19.35'

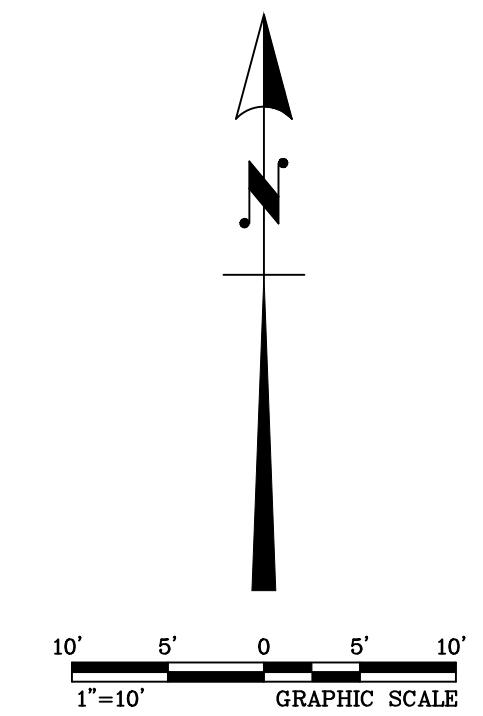

CONSTRUCTION NOTES:

- 1 - CONSTRUCT 4-INCH THICK PCC SIDEWALK OVER 95% COMPACTED NATIVE PER SAN BERNARDINO COUNTY STD. PLAN 109 TYPE "C" (MODIFIED) AND AS SHOWN ON PLANS.
- 3 - CONSTRUCT RETAINING CURB PER SPPWC STD. PLAN 111-5 DETAIL D (MODIFIED), AND AS SHOWN ON PLANS. CURB HEIGHT VARIES.
- 5 - CONSTRUCT 0.4-FT OF TYPE A, 3/4-INCH AGGREGATE GRADATION, PG 70-10 HOT MIX ASPHALT; OVER PRIME COAT AND 1.5-SACK SLURRY CEMENT UP TO 0.4-FT TOP SURFACE.
- 6 - CONSTRUCT 6-INCH PCC CURB AND GUTTER PER SAN BERNARDINO COUNTY STD. PLAN 116.
- 7 - CONSTRUCT 8-INCH AC DIKE PER SAN BERNARDINO COUNTY STD. PLAN 117.
- 12 - CONSTRUCT 6-FT CHAIN LINK FENCE PER SAN BERNARDINO COUNTY BOUNDARY FENCE STD. 403.
- 15 - CONSTRUCT PCC PAD PER DETAIL "C" ON SHEET 3.
- 16 - PROTECT IN PLACE.
- 22 - COLD PLANE EXISTING PAVEMENT FOR A DEPTH OF 0.15-FT AND 2-FT WIDE THEN OVERLAY WITH 0.15-FT HMA.
- 26 - CONSTRUCT CUT OFF WALL AT THE RETAINING CURB OF THE CURB RAMP PER SAN BERNARDINO COUNTY STD. 127.

LEGEND:

- CONSTRUCT PCC SIDEWALK & DRIVEWAY
- CONSTRUCT A.C. PAVEMENT
- COLD PLANE AND OVERLAY

PLANS PREPARED UNDER THE SUPERVISION OF:

GIUSEPPE S. CANZONIERI
4/15/2024
DATE



FIELD CHANGES		
MARK	CHANGES	RESIDENT ENGINEER DATE
	NO CHANGES	

SAN BERNARDINO COUNTY
DEPARTMENT OF PUBLIC WORKS

DESIGNED BY: RP	DRAWN BY: WG	CHECKED BY: AA	RECOMMENDED BY: Chris Nguyen ENGINEERING MANAGER 5/16/2024 DATE
APPROVED BY: Eloy Ruvalcaba SUPERVISING ENGINEER 5/16/2024 DATE			APPROVED BY: Mervat Mikhail DEPUTY DIRECTOR 5/17/24 DATE

ADA CURB RAMP / CROSS GUTTER DETAILS				
LITTLE THIRD ST AND LITTLE TIPPECANOE AVE				
SAN BERNARDINO AREA				
J.L. REF. 12034	W.O. NO. H15122	PLAN SCALE	SHT. NO. 6	TOT. SHT.'S. 15

MARK	REVISIONS	DATE

MARK	REVISIONS	DATE

FILE NO. 497700-010 & 497850-010

HORIZ. SCALE 1"=40'
VERT. SCALE 1"=8'

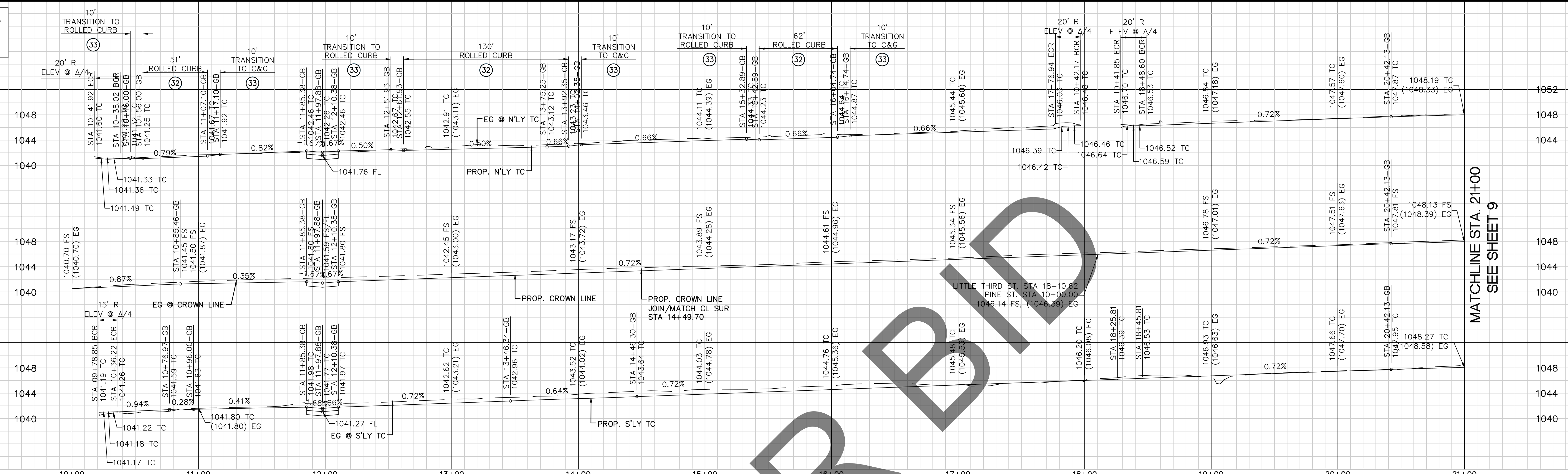

PALM LN

LITTLE THIRD STREET

PINE ST

MATCHLINE STA. 21+00
SEE SHEET 9

MATCHLINE STA. 21+00
SEE SHEET 8

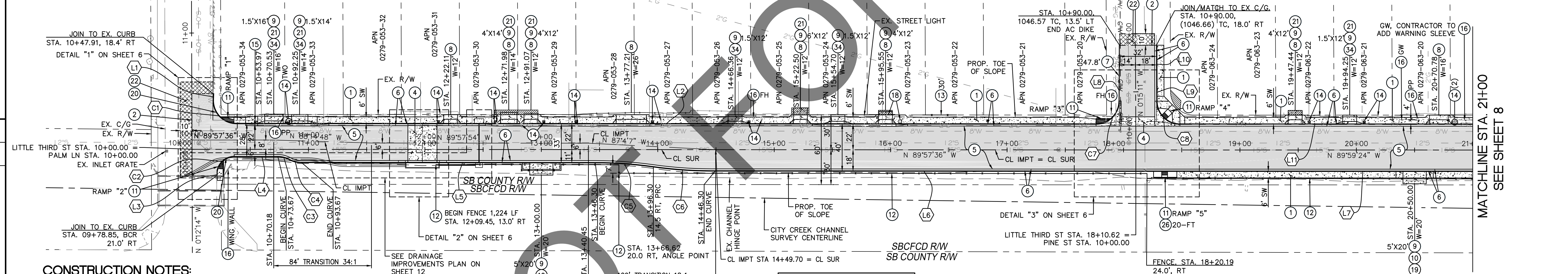

CONSTRUCTION NOTES:

- 1) CONSTRUCT 4-INCH THICK PCC SIDEWALK OVER 95% COMPACTED NATIVE PER SAN BERNARDINO COUNTY STD. PLAN 109 TYPE "C" (MODIFIED) AND AS SHOWN ON PLANS.
- 2) REMOVAL LIMIT. SAWCUT CONCRETE, ASPHALT AND OTHER HARDSCAPE SURFACE AND REMOVE TO THE LIMITS SHOWN ON THIS PLAN.
- 4) CONSTRUCT 8-INCH THICK PCC 8-FT CROSS GUTTER PER SAN BERNARDINO COUNTY STD. PLAN 119 AND AS SHOWN ON PLANS.
- 5) CONSTRUCT 0.4-FT OF TYPE A, 3/4-INCH AGGREGATE GRADATION, PG 70-10 HOT MIX ASPHALT; OVER PRIME COAT AND 1.5-SACK SLURRY CEMENT UP TO 0.4-FT TOP SURFACE.
- 6) CONSTRUCT 6-INCH PCC CURB AND GUTTER PER SAN BERNARDINO COUNTY STD. PLAN 116.
- 7) CONSTRUCT 8-INCH AC DIKE PER SAN BERNARDINO COUNTY STD. PLAN 117.
- 8) CONSTRUCT 4-INCH THICK PCC DRIVEWAY PER SAN BERNARDINO COUNTY STD. PLAN 128. (MODIFIED) SEE DETAIL "B" ON SHEET 3.
- 9) CONSTRUCT 4-INCH THICK PCC DRIVEWAY TRANSITION.
- 10) CONSTRUCT 4-INCH THICK PCC DEPRESSED DRIVEWAY PER DETAIL "A" ON SHEET 3.
- 11) CONSTRUCT PCC CURB RAMP PER CALTRANS STD PLAN A88A AND AS SHOWN ON PLANS.
- 12) CONSTRUCT 6-FT CHAIN LINK FENCE PER SAN BERNARDINO COUNTY BOUNDARY FENCE STD. 403.
- 13) CONSTRUCT 4-FT CHAIN LINK FENCE (TYPE CL-4) PER CALTRANS STD. PLAN A85 AND A85A.
- 14) RELOCATE MAILBOX PER SAN BERNARDINO COUNTY STD. PLAN 312.
- 15) CONSTRUCT PCC PAD PER DETAIL "C" ON SHEET 3.
- 16) PROTECT IN PLACE.
- 17) CONSTRUCT 4-INCH THICK A.C. DRIVEWAY TRANSITION.
- 18) INSTALL NEW SINGLE MAILBOX FOR ADDRESS 24576 LITTLE 3RD ST, SAN BERNARDINO, CA 92410 (APN 0279-053-23).
- 19) CONSTRUCT 6-FT DOUBLE DRIVE CHAIN LINK GATE PER SAN BERNARDINO COUNTY BOUNDARY FENCE STD. 403.
- 20) CONSTRUCT TYPE A1-6 PCC CURB PER CALTRANS STD. A87A.
- 21) REMOVE ROLLING GATE/FENCE TEMPORARILY FOR DRIVEWAY/CURB RAMP TRANSITION AND REINSTALL ALL DOUBLE DRIVE GATES CLF REQUIRE RECONSTRUCTION OF PLUNGER, WHEREAS, ROLLING GATES REQUIRE HEIGHT ADJUSTMENT AND REPLACEMENT OF ROLLING GATE GUIDE IN-KIND ANCHORED CONCRETE DWY AS DIRECTED BY THE ENGINEER.
- 26) CONSTRUCT CUT OFF WALL AT THE RETAINING CURB OF THE CURB RAMP PER SAN BERNARDINO COUNTY STD. 127.
- 32) CONSTRUCTION ROLLED CURB PER DETAIL "D" ON SHEET 3.
- 33) CONSTRUCTION TRANSITION FROM ROLLED CURB TO 6-INCH CURB AND GUTTER PER DETAIL "D" ON SHEET 3.
- 34) CONSTRUCT 4-INCH THICK PCC DRIVEWAY PER SAN BERNARDINO COUNTY STD. PLAN 128A. (MODIFIED) SEE DETAIL "E" ON SHEET 3.

LINE #	LENGTH	DIRECTION
L1	6.01'	N01° 49' 51.06"E
L2	738.42'	N89° 57' 36.13"W
L3	1.67'	N00° 12' 14.40"W
L4	37.45'	S89° 57' 36.13"E
L6	364.33'	S89° 57' 36.13"E
L7	612.45'	S89° 59' 24.57"E
L8	47.82'	N00° 18' 12.76"E
L9	15.29'	S00° 11' 48.62"E
L10	32.85'	S00° 15' 03.50"E
L11	574.31'	S89° 59' 24.57"E

CURVE #	LENGTH	RADIUS	DELTA	TANGENT
C1	31.41'	20.00'	089°59'30.28"	20.00'
C2	23.63'	15.00'	090°14'38.27"	15.06'
C3	10.41'	21.25'	028°04'20.95"	5.31'
C4	10.41'	21.25'	028°04'20.95"	5.31'
C5	50.16'	358.91'	008°00'29.41"	25.12'
C6	50.16'	358.91'	008°00'29.41"	25.12'
C7	31.52'	20.00'	090°17'34.61"	20.10'
C8	31.35'	20.00'	089°48'46.31"	19.93'

LEGEND:

- CONSTRUCT PCC SIDEWALK & DRIVEWAY
- CONSTRUCT A.C. PAVEMENT
- COLD PLANE AND OVERLAY
- TEMPORARY CONSTRUCTION EASEMENT AREA

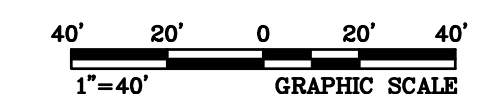

FILE NO. 497700-010 & 497850-010

REVISIONS	DATE	MARK

REVISIONS	DATE	MARK

PLANS PREPARED UNDER THE SUPERVISION OF:

3190 C. Shelby Street
Ontario, California 91764
Tel: (909) 890-9693 Fax: (909) 890-9694

GIUSEPPE S. CANZONIERI 4/15/2024 DATE



MARK	CHANGES	RESIDENT ENGINEER	DATE
	NO CHANGES		

FIELD CHANGES

SAN BERNARDINO COUNTY
DEPARTMENT OF PUBLIC WORKS

DESIGNED BY: RP DRAWN BY: WG CHECKED BY: AA RECOMMENDED BY: Chris Nguyen 5/16/2024 DATE

APPROVED BY: Mervat Mikhail 5/17/24 DATE
ELOY RUIVALCABA SUPERVISING ENGINEER MERVAT MIKHAIL DEPUTY DIRECTOR

STREET IMPROVEMENT PLAN
LITTLE THIRD ST AND LITTLE TIPPECANOE AVE
STA. 10+00.00 TO STA. 21+00.00
SAN BERNARDINO AREA

J.L. REF. 12034	W.O. NO. H15122	PLAN SCALE 1" = 40'	SHT. NO. 8	TOT. SHT'S. 15
-----------------	-----------------	---------------------	------------	----------------

HORIZ. SCALE 1"=40'
VERT. SCALE 1"=8'

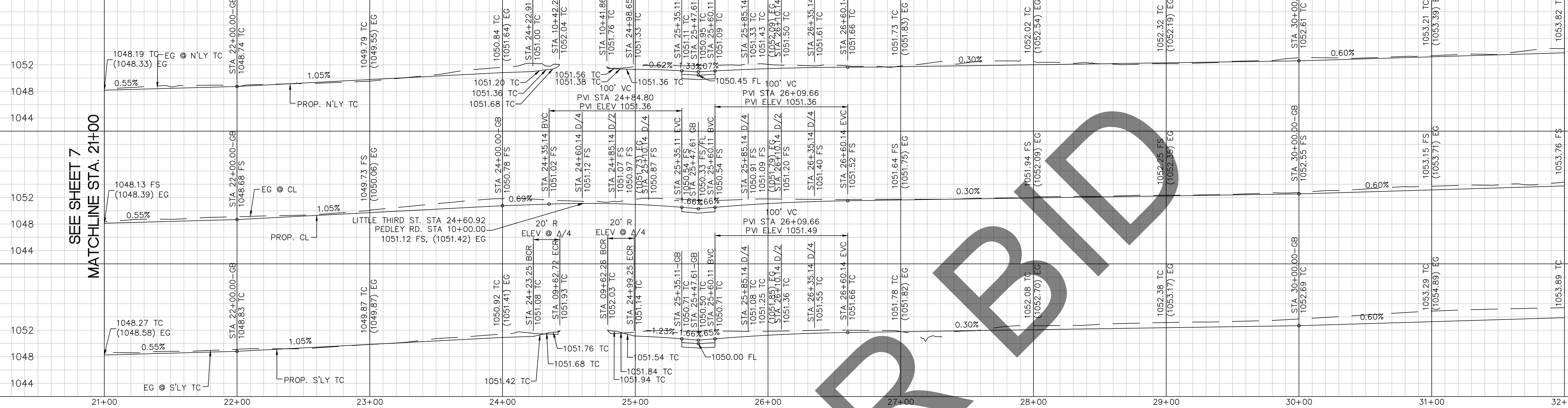

SEE SHEET 7
MATCHLINE STA. 21+00

MATCHLINE STA. 32+00
SEE SHEET 9

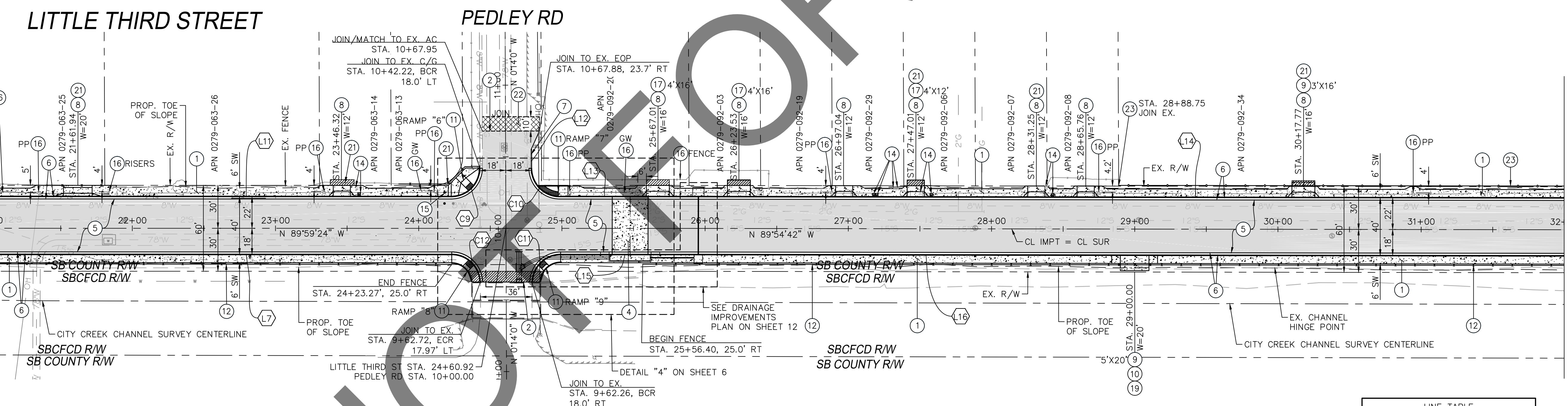

SEE SHEET 7
MATCHLINE STA. 21+00

MATCHLINE STA. 32+00
SEE SHEET 9

- CONSTRUCTION NOTES:**
- CONSTRUCT 4-INCH THICK PCC SIDEWALK OVER 95% COMPACTED NATIVE PER SAN BERNARDINO COUNTY STD. PLAN 109 TYPE "C" (MODIFIED) AND AS SHOWN ON PLANS.
 - REMOVAL LIMIT, SAWCUT CONCRETE, ASPHALT AND OTHER HARDSCAPE SURFACE AND REMOVE TO THE LIMITS SHOWN ON THIS PLAN.
 - CONSTRUCT 8-INCH THICK PCC 8'-FT CROSS GUTTER PER SAN BERNARDINO COUNTY STD. PLAN 119 AND AS SHOWN ON PLANS.
 - CONSTRUCT 0.4'-FT OF TYPE A, 3/4-INCH AGGREGATE GRADATION, PG 70-10 HOT MIX ASPHALT; OVER PRIME COAT AND 1.5-SACK SLURRY CEMENT UP TO 0.4'-FT TOP SURFACE.
 - CONSTRUCT 6-INCH PCC CURB AND GUTTER PER SAN BERNARDINO COUNTY STD. PLAN 116.
 - CONSTRUCT 8-INCH AC DIKE PER SAN BERNARDINO COUNTY STD. PLAN 117.
 - CONSTRUCT 4-INCH THICK PCC DRIVEWAY PER SAN BERNARDINO COUNTY STD. PLAN 128. (MODIFIED) SEE DETAIL "B" ON SHEET 3.
 - CONSTRUCT 4-INCH THICK PCC DRIVEWAY TRANSITION.
 - CONSTRUCT 4-INCH THICK PCC DEPRESSED DRIVEWAY PER DETAIL "A" ON SHEET 3.
 - CONSTRUCT PCC CURB RAMP PER CALTRANS STD PLAN A88A AND AS SHOWN ON PLANS.
 - CONSTRUCT 6'-FT CHAIN LINK FENCE PER SAN BERNARDINO COUNTY BOUNDARY FENCE STD. 403.
 - RELOCATE MAILBOX PER SAN BERNARDINO COUNTY STD. PLAN 312.

- PROTECT IN PLACE.
- CONSTRUCT 4-INCH THICK A.G. DRIVEWAY TRANSITION.
- CONSTRUCT 6'-FT DOUBLE DRIVE CHAIN LINK GATE PER SAN BERNARDINO COUNTY BOUNDARY FENCE STD. 403.
- REMOVE ROLLING GATE/FENCE TEMPORARILY FOR DRIVEWAY/CURB RAMP TRANSITION AND REINSTALL. ALL DOUBLE DRIVE GATES CLF REQUIRE RECONSTRUCTION OF PLUNGER, WHEREAS, ROLLING GATES REQUIRE HEIGHT ADJUSTMENT AND REPLACEMENT OF ROLLING GATE GUIDE IN-KIND ANCHORED CONCRETE DWY AS DIRECTED BY THE ENGINEER.
- COLD PLANE EXISTING PAVEMENT FOR A DEPTH OF 0.15'-FT AND 2'-FT WIDE THEN OVERLAY WITH 0.15'-FT HMA.

LEGEND:

- CONSTRUCT PCC SIDEWALK & DRIVEWAY
- CONSTRUCT A.C. PAVEMENT
- COLD PLANE AND OVERLAY
- TEMPORARY CONSTRUCTION EASEMENT

CURVE TABLE

CURVE #	LENGTH	RADIUS	DELTA	TANGENT
C9	31.50'	20.00'	090°13'58.62"	20.08'
C10	16.91'	20.00'	048°26'51.26"	9.00'
C11	30.89'	20.00'	088°29'04.73"	19.48'
C12	30.76'	20.00'	088°06'30.49"	19.35'

LINE TABLE

LINE #	LENGTH	DIRECTION
L7	612.45'	S89° 59' 24.57"E
L11	574.31'	S89° 59' 24.57"E
L12	13.01'	S00° 10' 11.74"E
L13	90.63'	S89° 59' 24.57"E
L14	706.38'	S89° 54' 41.65"E
L15	90.01'	N89° 59' 24.57"W
L16	1288.28'	N89° 54' 41.65"W

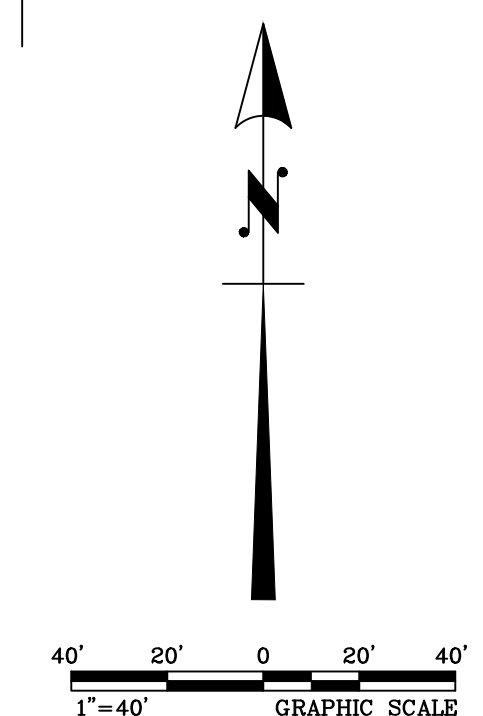

MARK	REVISIONS	APPR.	DATE

FILE NO. 497700-010 & 497850-010

PLANS PREPARED UNDER THE SUPERVISION OF:

KOA
LOCHNER COMPANY
3190 C. Shelby Street
Ontario, California 91764
Tel: (909) 890-9693 Fax: (909) 890-9694

GIUSEPPE S. CANZONERI
4/15/2024
DATE

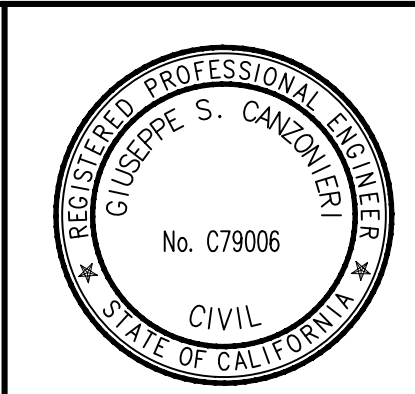

FIELD CHANGES

MARK	CHANGES	RESIDENT ENGINEER	DATE
	NO CHANGES		

**SAN BERNARDINO COUNTY
DEPARTMENT OF PUBLIC WORKS**

DESIGNED BY: RP
DRAWN BY: WG
CHECKED BY: AA
RECOMMENDED BY: Chris Nguyen
5/16/2024
DATE

APPROVED BY: Mervat Mikhail
5/17/24
DATE

ELOY RUVALCABA
SUPERVISING ENGINEER

MERVAT MIKHAIL
DEPUTY DIRECTOR

STREET IMPROVEMENT PLAN

**LITTLE THIRD ST AND LITTLE
TIPPECANOE AVE**
STA. 21+00.00 TO STA. 32+00.00
SAN BERNARDINO AREA

J.L. REF.	W.O. NO.	PLAN SCALE	SHT. NO.	TOT. SHT'S.
12034	H15122	1" = 40'	9	15