

DEMOLITION NOTES

- 1 PROTECT-IN-PLACE ITEM NOTED PER PLAN.
- 2 REMOVE EXISTING PAVEMENT AND BASE MATERIAL, FULL DEPTH.

LEGEND

- EXISTING ASPHALT TO BE REMOVED
- LIMITS OF DEMOLITION
- SAWCUT LINE

SHEET NOTES

1. FOR GENERAL NOTES, LEGEND, AND ABBREVIATIONS, SEE SHEET 1.
2. FOR NEW LOCATION OF RELOCATED ITEMS AND COORDINATION OF DEMOLITION, SEE PAVING PLANS, SHEETS 12 TO 21.
3. PROTECT-IN-PLACE ALL EXISTING UTILITIES UNLESS NOTED OTHERWISE.
4. COORDINATE EXISTING LIGHT POLES WITH ELECTRICAL DRAWINGS.
5. PROTECT-IN-PLACE, RELOCATE OR RESET AS NECESSARY ALL EXISTING PORTABLE TRAFFIC CONTROL DEVICES THAT MAY OR WILL BE IMPACTED BY THE WORK UNLESS NOTED OTHERWISE.

NOTE

KINDER MORGAN'S CALNEV PIPELINE HAS AN EXISTING 8" HIGH PRESSURE FUEL LINE TRAVERSING THE SITE. CONTRACTOR SHALL HAVE A COPY OF THE "GUIDELINES FOR DESIGN AND CONSTRUCTION NEAR KINDER MORGAN OPERATED FACILITIES". DOCUMENT AND NOTIFY KINDER MORGAN FOR COORDINATION OF REQUIREMENTS PRIOR TO CONSTRUCTION. LINE SHALL BE CLEARLY INDICATED IN THE FIELD AND NO EXCAVATION SHALL OCCUR WITHIN 30 FEET OF THE PIPELINE WITHOUT A KINDER MORGAN INSPECTOR PRESENT.

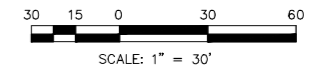

Underground Service Alert

 Call: TOLL FREE
 1-800-227-2600
 TWO WORKING DAYS BEFORE YOU DIG

BENCHMARK
 NATIONAL GEODETIC SURVEY BENCHMARK
 DESIGNATION: RF 51
 POINT: EV9108
 DATUM: NAVD 83
 ELEVATION: 1064.3 FEET
 DESCRIPTION: 0.6 KM SOUTHWEST ALONG PALM AVENUE FROM ITS JUNCTION WITH INTERSTATE HIGHWAY 215 AND HIGHWAY 206. THENCE 0.2 KM SOUTHWESTERLY ALONG INSTITUTION ROAD 23.5 M (77.1 FT) N OF THE CENTERLINE OF THE ROAD 62 M (203 FT) E OF THE CENTER OF A TRUCK ROAD 1.8 M (5.9 FT) W OF A UTILITY POLE NUMBER 1891621E 0.4 M (1.3 FT) S OF A WITNESS POST 0.3 M (1.0 FT) ABOVE THE ROAD 0.2 M (0.7 FT) BELOW THE GROUND SURFACE.

PREPARED BY:

 801 VIA PIEMONTE SUITE 800
 OAKLAND, CA 94764
 PROJECT # 2200639400
 PH 909.477.6915
 FAX 909.477.6916
 www.imeg.com
 JOHN M. THOMPSON
 RCE NAME
 C82557
 RCE NO.
 11/07/23
 DATE



MARK	REVISIONS	APPR	DATE

SAN BERNARDINO COUNTY
PROJECT AND FACILITIES MANAGEMENT DEPARTMENT
 RECOMMENDED BY: _____
 APPROVED BY: _____
 ELSY BANKS
 PROJECT MANAGER III
 DATE: _____

SAN BERNARDINO COUNTY
SHERIFF'S DEPARTMENT
EMERGENCY VEHICLE OPERATIONS CENTER
 ASPHALT & LIGHTING REPLACEMENT
 PROJECT NO. 10.10.1222
DEMOLITION PLAN

ROAD NO.
FILE NO.
SHEET 2 OF 44

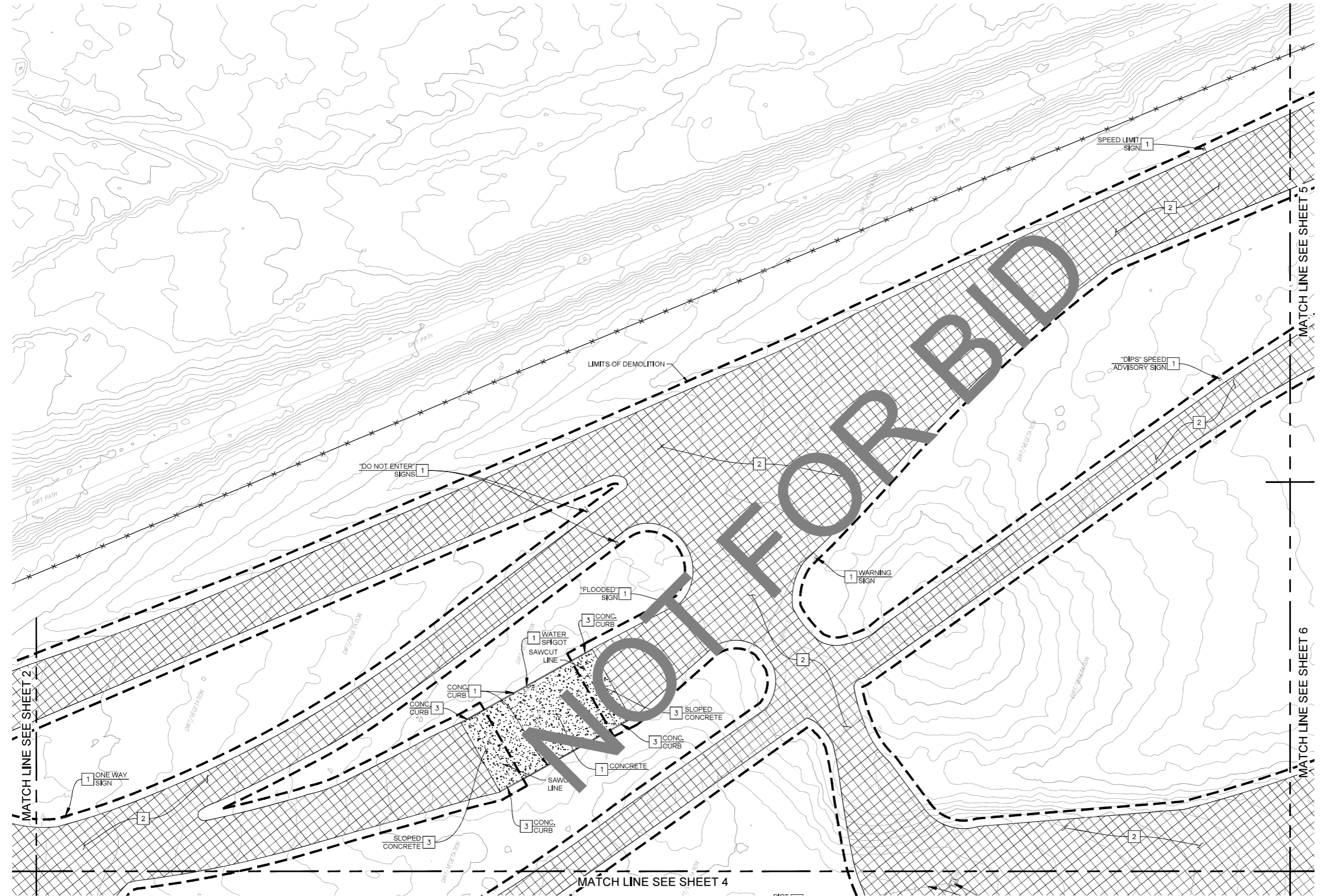

DEMOLITION NOTES

- 1 PROTECT-IN-PLACE ITEM NOTED PER PLAN.
- 2 REMOVE EXISTING PAVEMENT AND BASE MATERIAL, FULL DEPTH.
- 3 REMOVE ITEM NOTED PER PLAN.

LEGEND

- EXISTING ASPHALT TO BE REMOVED
- EXISTING CONCRETE TO REMAIN
- EXISTING CONCRETE TO BE REMOVED
- LIMITS OF DEMOLITION
- SAWCUT LINE

SHEET NOTES

1. FOR GENERAL NOTES, LEGEND, AND ABBREVIATIONS, SEE SHEET 1.
2. FOR NEW LOCATION OF RELOCATED ITEMS AND COORDINATION OF DEMOLITION, SEE PAVING PLANS, SHEETS 12 TO 21.
3. PROTECT-IN-PLACE ALL EXISTING UTILITIES UNLESS NOTED OTHERWISE.
4. PROTECT-IN-PLACE, RELOCATE OR RESET AS NECESSARY ALL EXISTING PORTABLE TRAFFIC CONTROL DEVICES THAT MAY OR WILL BE IMPACTED BY THE WORK UNLESS NOTED OTHERWISE.

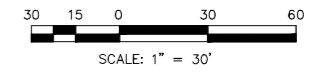

Underground Service Alert

 Call: TOLL FREE
 1-800-227-2600
 TWO WORKING DAYS BEFORE YOU DIG

BENCHMARK
 NATIONAL GEODETIC SURVEY BENCHMARK
 DESIGNATION: RF 51
 DATE: NOV 98
 ELEVATION: 1064.3 FEET
 DESCRIPTION: 0.4 KM SOUTHWEST ALONG PALM AVENUE FROM ITS JUNCTION WITH INTERSTATE HIGHWAY 215 AND HIGHWAY 205. THENCE 0.2 KM SOUTHWESTERLY ALONG INTERSTATE ROAD 235.5 M (771 FT) N OF THE CENTERLINE OF THE ROAD 0.2 M (0.7 FT) E OF THE CENTER OF A TRUCK ROAD 1.8 M (5.9 FT) W OF A UTILITY POLE. NUMBER 1891621E 0.4 M (1.3 FT) S OF A WITNESS POST 0.3 M (1.0 FT) ABOVE THE ROAD 0.2 M (0.7 FT) BELOW THE GROUND SURFACE.

PREPARED BY:

 801 VIA PIEMONTE SUITE 800 OAKLAND, CA 94764 PROJECT # 2200639400
 PH 908.477.6915 FAX 908.477.6916 www.imegcorp.com
 JOHN M. THOMPSON RCE NAME C82557 RCE No. 11/07/23 DATE



MARK	REVISIONS	APPR	DATE

SAN BERNARDINO COUNTY
 PROJECT AND FACILITIES MANAGEMENT DEPARTMENT
 RECOMMENDED BY: _____
 APPROVED BY: _____
 ELSY BANKS PROJECT MANAGER III DATE _____

SAN BERNARDINO COUNTY
 SHERIFF'S DEPARTMENT
 EMERGENCY VEHICLE OPERATIONS CENTER
 ASPHALT & LIGHTING REPLACEMENT
 PROJECT NO. 10.10.1222
 DEMOLITION PLAN

ROAD NO. _____
 FILE NO. _____
 SHEET 3 OF 44

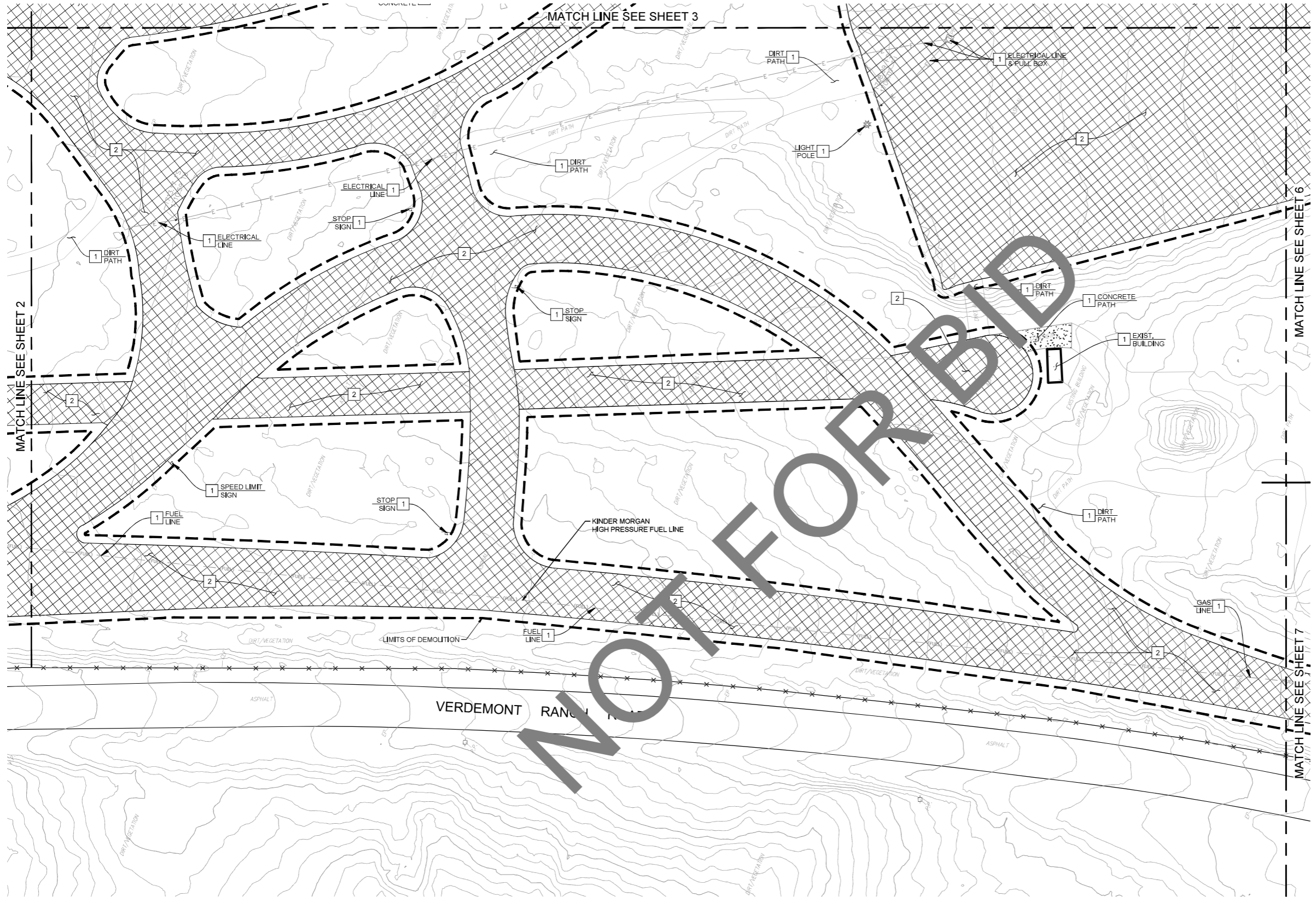

- DEMOLITION NOTES**
- 1 PROTECT-IN-PLACE ITEM NOTED PER PLAN.
 - 2 REMOVE EXISTING PAVEMENT AND BASE MATERIAL, FULL DEPTH.

- LEGEND**
- EXISTING ASPHALT TO BE REMOVED
 - LIMITS OF DEMOLITION
 - SAWCUT LINE

- SHEET NOTES**
1. FOR GENERAL NOTES, LEGEND, AND ABBREVIATIONS, SEE SHEET 1.
 2. FOR NEW LOCATION OF RELOCATED ITEMS AND COORDINATION OF DEMOLITION, SEE PAVING PLANS, SHEETS 12 TO 21.
 3. PROTECT-IN-PLACE ALL EXISTING UTILITIES UNLESS NOTED OTHERWISE.
 4. COORDINATE EXISTING LIGHT POLES WITH ELECTRICAL DRAWINGS.
 5. PROTECT-IN-PLACE, RELOCATE OR RESET AS NECESSARY ALL EXISTING PORTABLE TRAFFIC CONTROL DEVICES THAT MAY OR WILL BE IMPACTED BY THE WORK UNLESS NOTED OTHERWISE.

NOTE

KINDER MORGAN'S CALNEV PIPELINE HAS AN EXISTING 8" HIGH PRESSURE FUEL LINE TRAVERSING THE SITE. CONTRACTOR SHALL HAVE A COPY OF THE "GUIDELINES FOR DESIGN AND CONSTRUCTION NEAR KINDER MORGAN OPERATED FACILITIES", DOCUMENT AND NOTIFY KINDER MORGAN FOR COORDINATION OF REQUIREMENTS PRIOR TO CONSTRUCTION. LINE SHALL BE CLEARLY INDICATED IN THE FIELD AND NO EXCAVATION SHALL OCCUR WITHIN 30 FEET OF THE PIPELINE WITHOUT A KINDER MORGAN INSPECTOR PRESENT.

NOT FOR BID

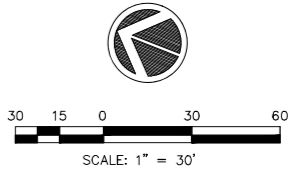

Underground Service Alert

Call: TOLL FREE
1-800-227-2600

TWO WORKING DAYS BEFORE YOU DIG

BENCHMARK

NATIONAL GEODETIC SURVEY BENCHMARK

DESIGNATION: RF 51
 PD: EV9108
 DATUM: NAVD 83
 ELEVATION: 1064.3 FEET

DESCRIPTION: 0.6 KM SOUTHWEST ALONG PALM AVENUE FROM ITS JUNCTION WITH INTERSTATE HIGHWAY 215 AND HIGHWAY 205. THENCE 0.2 KM SOUTHWESTERLY ALONG INSTITUTION ROAD 23.5 M (77.1 FT) N OF THE CENTERLINE OF THE ROAD 6.0 M (19.7 FT) E OF THE CENTER OF A TRUCK ROAD 1.8 M (5.9 FT) W OF A UTILITY POLE. NUMBER 1891621E (0.3 M (0.9 FT) S OF A WITNESS POST 0.3 M (1.0 FT) ABOVE THE ROAD 0.2 M (0.7 FT) BELOW THE GROUND SURFACE.

PREPARED BY:

801 VIA PIEMONTE SUITE 800
 OAKLAND, CA 94764
 PROJECT # 2200639400

PH: 909.477.8915
 FAX: 909.477.8916
 www.imeg.com

JOHN M. THOMPSON
 RCE NAME

C82557
 RCE NO.

11/07/23
 DATE



MARK	REVISIONS	APPR	DATE

SAN BERNARDINO COUNTY
 PROJECT AND FACILITIES MANAGEMENT DEPARTMENT

RECOMMENDED BY: _____

APPROVED BY: _____

ELBY BANKS
 PROJECT MANAGER III

DATE: _____

SAN BERNARDINO COUNTY
 SHERIFF'S DEPARTMENT

EMERGENCY VEHICLE OPERATIONS CENTER
 ASPHALT & LIGHTING REPLACEMENT
 PROJECT NO. 10.10.1222

DEMOLITION PLAN

ROAD NO. _____

FILE NO. _____

SHEET 4 OF 44

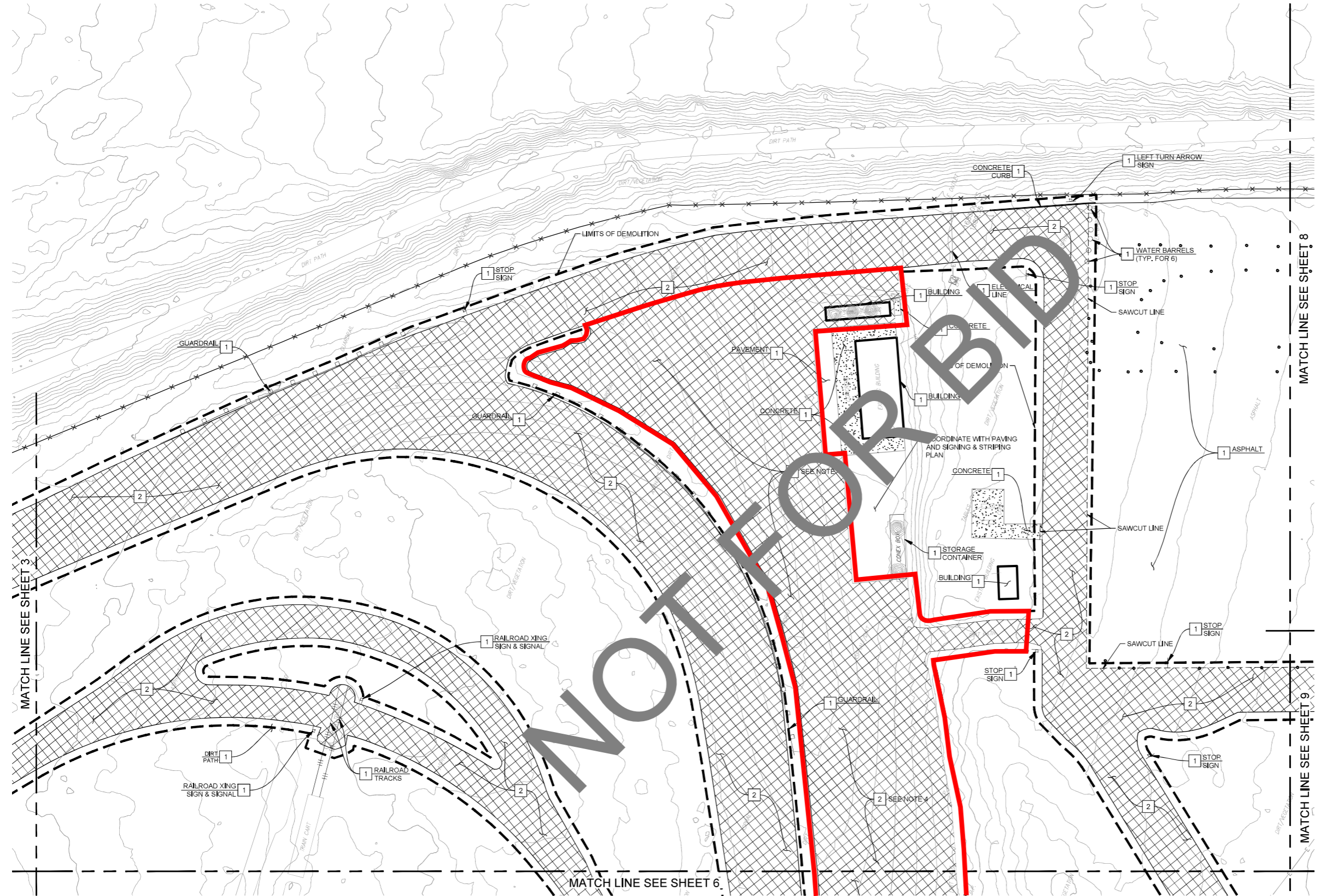

- ### DEMOLITION NOTES
- 1 PROTECT-IN-PLACE ITEM NOTED PER PLAN.
 - 2 REMOVE EXISTING PAVEMENT AND BASE MATERIAL, FULL DEPTH.

- ### LEGEND
- EXISTING ASPHALT TO BE REMOVED
 - EXISTING CONCRETE TO REMAIN
 - LIMITS OF DEMOLITION
 - SAWCUT LINE
 - ADD-ALTERNATE #1 LIMITS OF WORK

- ### SHEET NOTES
1. FOR GENERAL NOTES, LEGEND, AND ABBREVIATIONS, SEE SHEET 1.
 2. FOR NEW LOCATION OF RELOCATED ITEMS AND COORDINATION OF DEMOLITION, SEE PAVING PLANS, SHEETS 12 TO 21.
 3. PROTECT-IN-PLACE ALL EXISTING UTILITIES UNLESS NOTED OTHERWISE.
 4. CONTRACTOR TO INCLUDE DEMOLITION OF THIS PARKING LOT AS AN ADD ALTERNATE IN THE BID DOCUMENTS.
 5. COORDINATE EXISTING LIGHT POLES WITH ELECTRICAL DRAWINGS.
 6. PROTECT-IN-PLACE, RELOCATE OR RESET AS NECESSARY ALL EXISTING PORTABLE TRAFFIC CONTROL DEVICES THAT MAY OR WILL BE IMPACTED BY THE WORK UNLESS NOTED OTHERWISE.

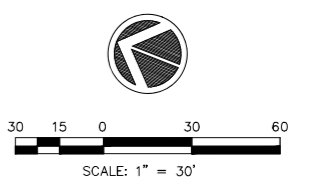

Underground Service Alert

 Call: TOLL FREE
 1-800-227-2600
 TWO WORKING DAYS BEFORE YOU DIG

BENCHMARK
 NATIONAL GEODETIC SURVEY BENCHMARK
 DESIGNATION: RF 51
 ID: EV9108
 DATUM: NAVD 88
 ELEVATION: 1064.3 FEET
 DESCRIPTION: 0.4 KM SOUTHWEST ALONG PALM AVENUE FROM ITS JUNCTION WITH INTERSTATE HIGHWAY 215 AND HIGHWAY 206, THENCE 0.2 KM SOUTHWESTERLY ALONG INSTITUTION ROAD 23.5 M (77.1 FT) N OF THE CENTERLINE OF THE ROAD 62 M (203 FT) E OF THE CENTER OF A TRACK ROAD 1.8 M (5.9 FT) W OF A UTILITY POLE NUMBER 1891621E 0.3 M (1.0 FT) S OF A WITNESS POST 0.3 M (1.0 FT) ABOVE THE ROAD 0.2 M (0.7 FT) BELOW THE GROUND SURFACE.

PREPARED BY:

 801 VIA PIEMONTE SUITE 800
 CANTON, CA 91764
 PROJECT # 2200639400
 PH: 909.477.8915
 FAX: 909.477.8916
 www.imeg.com
 JOHN M. THOMPSON
 RCE NAME
 C82557
 RCE NO.
 11/07/23
 DATE



MARK	REVISIONS	APPR	DATE

SAN BERNARDINO COUNTY
PROJECT AND FACILITIES MANAGEMENT DEPARTMENT
 RECOMMENDED BY: _____
 APPROVED BY: _____
 ELSY BANKS
 PROJECT MANAGER III
 DATE: _____

SAN BERNARDINO COUNTY
SHERIFF'S DEPARTMENT
EMERGENCY VEHICLE OPERATIONS CENTER
 ASPHALT & LIGHTING REPLACEMENT
 PROJECT NO. 10.10.1222
DEMOLITION PLAN

ROAD NO.
FILE NO.
SHEET 5 OF 44