

GENERAL NOTES

DIMENSIONS: ALL DIMENSIONS ARE TO FACE OF STUD, CENTER OF STUD, COLUMN GRID LINES, OR FACE OF CONCRETE AND CURB WALLS UNLESS INDICATED OTHERWISE. NOTED, UNLESS OTHERWISE NOTED, ALL CURB DIMENSIONS MUST BE MAINTAINED.

DOOR LOCATION: ALL DOORS, UNLESS OTHERWISE NOTED, SHALL BE LOCATED 5' FROM ADJACENT PERPENDICULAR WALL, U.O.N.

ALIGNMENT: WHERE NEW PARTITIONS ARE TO ALIGN WITH EXISTING PARTITIONS, REMOVE EXISTING CORNER BRACKETS, ALIGN, TAPE, AND SPACKLE WITH NEW PARTITION.

WALL BUCKING: BUCKING OR BACKING SHALL BE REQUIRED IN PARTITIONS AS REQUIRED FOR WALLS TO BE BUILT ON EXISTING PARTITIONS. BUCKING SHALL BE INSTALLED IN ACCORDANCE WITH ASTM E 814 OR UL 1479 AND SHALL HAVE AN RATING AND A T RATING AT FLOORS ONLY IF NOT LESS THAN THE ACoustical WALLS FOR PARTS, DUCTS, AND OUTLETS SHALL BE SEALED WITH AN ACoustical SEALANT.

PENETRATIONS: PENETRATIONS OF FIRE-RESISTIVE WALLS, FLOOR CEILINGS, AND ROOF-CEILINGS SHALL BE INSTALLED IN ACCORDANCE WITH ASTM E 814 OR UL 1479 AND SHALL HAVE AN RATING AND A T RATING AT FLOORS ONLY IF NOT LESS THAN THE ACoustical WALLS FOR PARTS, DUCTS, AND OUTLETS SHALL BE SEALED WITH AN ACoustical SEALANT.

WALL & CEILING ACCESS PANELS: PROVIDE ACCESS PANELS AS REQUIRED PER APPLICABLE CODES FOR MAINTENANCE ACCESS TO UNINSTALLED MEP EQUIPMENT. PROVIDE STAINLESS STEEL ACCESS PANELS IN THE LOCATIONS.

FIRE PROTECTION AT COLUMNS: PROVIDE FIRE PROTECTION AT COLUMNS WITH 1-HOUR FIRE RATED ASSEMBLY PER UL DESIGN 1208.

KEYNOTES

- FP01 PLASTIC LAMINATE UPPER CABINET
FP02 PLASTIC LAMINATE BASE CABINET WITH SOLID SURFACE COUNTERTOP
FP03 DECORATIVE PLASTIC RESIN PANEL
FP04 CURTAIN TRACK ABOVE, REFER TO REFLECTED CEILING PLAN
FP05 PLASTIC LAMINATE ACCESSIBLE SINK APRON WITH SOLID SURFACE COUNTERTOP
FP06 EXISTING GYPSUM BOARD FLOORING TO REMAIN, PROTECT IN PLACE
FP07 PLASTIC LAMINATE RECEPTION COUNTER WITH SOLID SURFACE COUNTERTOP
FP08 PROVIDE NEW GYPSUM BOARD COLUMN FLOORING, REFER TO GENERAL NOTES ON THIS SHEET FOR MORE INFORMATION
FP09 SLIDING PLASTIC RESIN DIVIDER PANELS
FP10 PLASTIC LAMINATE WARDROBE
FP11 LOW WALL WITH PLASTIC LAMINATE END CAP
FP12 CENTERLINE OF INFUSION BAYS
FP13 PATCH AND REPAIR EXISTING CARPET DAMAGED DURING DEMOLITION AS REQUIRED TO MATCH EXISTING
FP14 FLOORING TRANSITION
FP15 FLOOR DRAIN, REFER TO PLUMBING DRAWINGS
FP16 PATIENT TV, SEE DETAIL 35301
FP17 WARNING CABINET, SEE DETAIL 95301
FP18 REFRIGERATOR, SEE DETAIL 75301
FP19 ERGOTON COMPUTER WALL BRACKET, SEE DETAIL 95301
FP20 LARGE GREEN MONITOR, SEE DETAIL 45301
FP21 PATCH CERAMIC TILE FLOOR & WALL TO MATCH
FP22 ICE MACHINE
FP23 EXAM LIGHT OVERHEAD, SEE DETAIL 115301

LEGEND

- EXISTING NON RATED WALL
EXISTING CONCRETE WALL
EXISTING 1-HOUR RATED WALL
NON RATED WALL
1-HOUR RATED WALL
WALL REFERENCE, SEE 4801
EXISTING VISION GLASS SPANDREL PANEL
CORNER GUARD

KEY PLAN

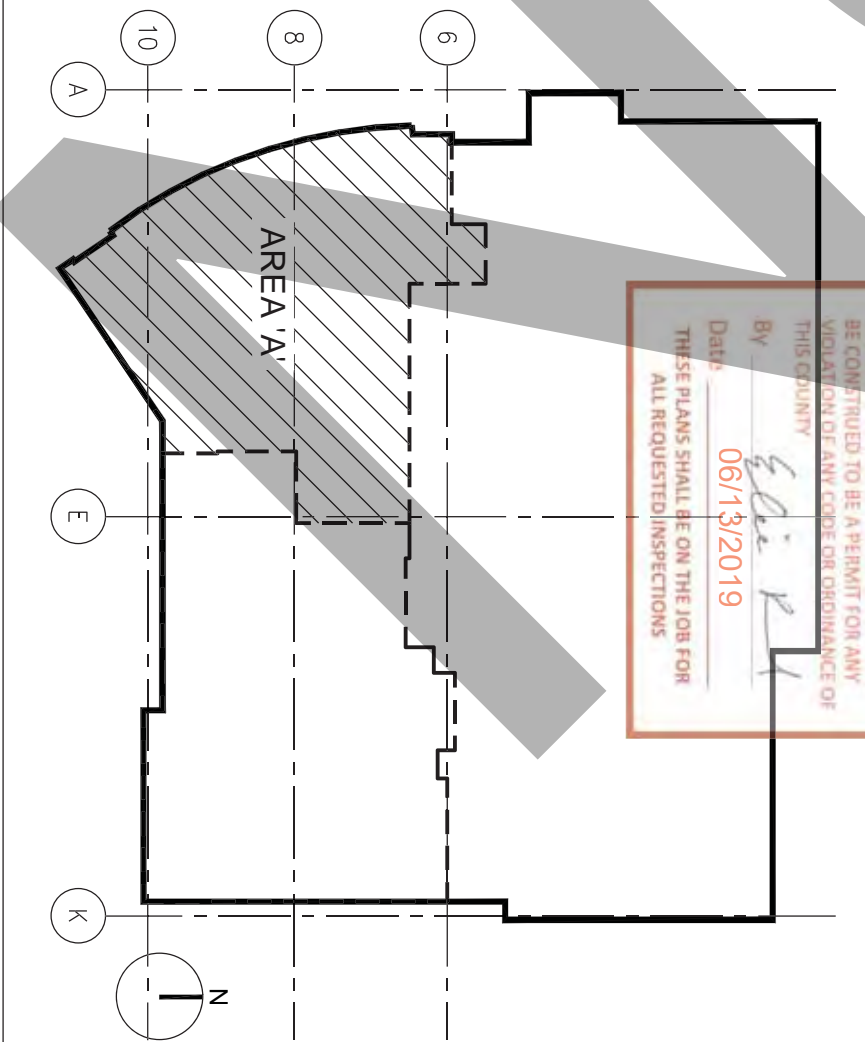

A4 PARTIAL FLOOR PLAN - AREA 'A'

SCALE: 1/4"=1'-0"

