

Recording Requested By:

CITY CLERK
CITY OF HIGHLAND
27215 BASE LINE
HIGHLAND, CA 92346

**When recorded mail document
and tax statement to:**

SAME AS ABOVE

Record without fee subject to
Gov't Code 6103 and 27383

Project: City Creek
System No.: 2.600
Parcel No.: 341
Dept. Code: 11600

GRANT DEED

D.P. No.: 2.600/35C

APN: 1201-331-01(ptn), 1201-341-09(ptn)
1201-341-01(ptn), 1201-341-08

Date: November 25, 2019

The undersigned grantor(s) declare(s):

DOCUMENTARY TRANSFER TAX \$0.00 Conveyance to Government Entity. R&T 11922

☐ computed on full value of property conveyed, or

☐ computed on full value less liens and encumbrances remaining at the time of sale

☐ Unincorporated Area ☒ _____ City of Highland

FOR A VALUABLE CONSIDERATION, receipt of which is hereby acknowledged, the **SAN BERNARDINO COUNTY FLOOD CONTROL DISTRICT**, a body corporate and politic of the State of California,

does hereby grant to the **CITY OF HIGHLAND**, a Municipal Corporation, the following described **real property** in the City of Highland, County of San Bernardino, State of California, described as follows:

See **EXHIBIT "A"**, legal description, and plat,
attached hereto and made a part hereof.

**SAN BERNARDINO COUNTY
FLOOD CONTROL DISTRICT**

Dated: _____

By: _____

Name: Curt Hagman

Title: Chairman, Board of Supervisors

Exhibit "A"

page 1 of 3

Legal Description

That portion of those parcels of land located in the Southeast quarter of Section 4, Township 1 South, Range 3 West, San Bernardino Meridian, said parcels conveyed to the San Bernardino Flood Control District by document recorded May 6, 1942 in Book 1530, page 352 and by document recorded May 21, 1959 in Book 4824, page 494 and by document recorded in January 22, 1960 in Book 5038, page 137 and by document recorded October 10, 1942 in Book 1559, page 137, all of Official Records of San Bernardino County, said portion being all of said parcels described as follows:

Commencing at the intersection of the Northerly line of Greenspot Road (formerly 5th Street), having a half width of 50.00 feet, with the Westerly line of the Easterly 1452.00 feet of said Southeast quarter;

Thence North 00°24'36" East, 495.82 feet along said Westerly line to the most Southerly corner of said parcel of land described in document recorded in said Book 4824, page 494 Official Records;

Thence North 37°20'27" East, 19.53 feet along the Southeasterly line of said parcel to the **Point of Beginning**;

Thence continuing North 37°20'27" East, 178.27 feet along the Southeasterly line of said parcel to its most Northeasterly corner on the Northerly line of that parcel of land conveyed to Louis and Helen Rozema by document recorded June 26, 1952 in Book 2974, page 580, Official Records of said County;

Thence North 89°35'24" West, 2.63 feet along said Northerly line to the most Southeasterly corner of said parcel of land described in document recorded in Book 5038, page 137 Official Records;

Thence North 37°22'23" East, 1121.76 feet along the Southeasterly line of said parcel to its most Northeasterly point in the Southwest corner of the North half of the Northeast quarter of the Northeast quarter of the Southeast quarter of said Section 4;

Thence South 89°49'23" West, 86.83 feet along the North line of the South half, of the Northwest quarter, of the Northeast quarter, of the Southeast quarter of said Section 4;

Thence South 50°52'15" West, 76.50 feet;

Thence South 56°55'50" West, 137.00 feet;

Thence South 57°52'54" West, 207.87 feet;

Thence South 58°42'16" West, 145.17 feet;

Thence South 58°56'19" West, 272.32 feet;

CITY CREEK
PAR 341
APN 1201-331-01 (Ptn)
APN 1201-341-09 (Ptn)
APN 1201-341-08
APN 1201-341-01 (Ptn)

Exhibit "A"

page 2 of 3

Legal Description

Thence South 53°23'52" West, 235.56 feet to the beginning of a tangent curve concave Northwesterly having a radius of 700.00 feet;

Thence Southwesterly along said curve through a central angle of 7°39'03", an arc distance of 93.47 feet;

Thence leaving said curve, South 04°01'24" East, a distance of 410.84 feet;

Thence North 85°58'36" East, a distance of 247.36 feet to the **Point of Beginning**.

Containing 8.61 Acres, more or less.

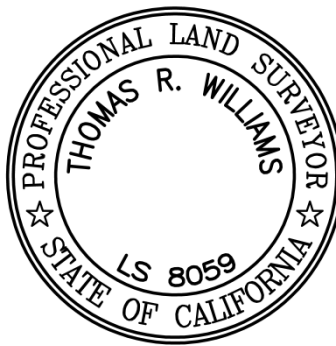

Job No.
962602-2A
Prepared by:
T.R.W.

This legal description was prepared by me or under my direction.

By: Thomas R. Williams
Thomas R. Williams, P.L.S. # 8059
Date: 11/25/19

CITY CREEK
PAR 341
APN 1201-331-01 (Ptn)
APN 1201-341-09 (Ptn)
APN 1201-341-08
APN 1201-341-01 (Ptn)

Page 3 of 3



SAN BERNARDINO COUNTY FLOOD CONTROL DISTRICT		
REVISIONS	DWN BY	DATE
	JL/CB	11/26/19
	FILE NO.	
	D.P. 2.600/35C	