



SECTION G-2

CONTRACT DRAWINGS

Signing and Stripping

SNOWDROP ROAD PROJECT

FOR

**Assessment District 2018-1
UNINCOPORATED RANCHO CUCAMONGA, CALIFORNIA**

PROJECT NO.: 30.30.0009



COUNTY OF SAN BERNARDINO
SPECIAL DISTRICTS DEPARTMENT

SIGNING AND STRIPING FOR AD 2018-1
SNOW DROP ROAD IMPROVEMENTS PROJECT
SNOWDROP ROAD, SANTINA DRIVE,
ARCHIBALD AVENUE, AND HAVEN AVENUE

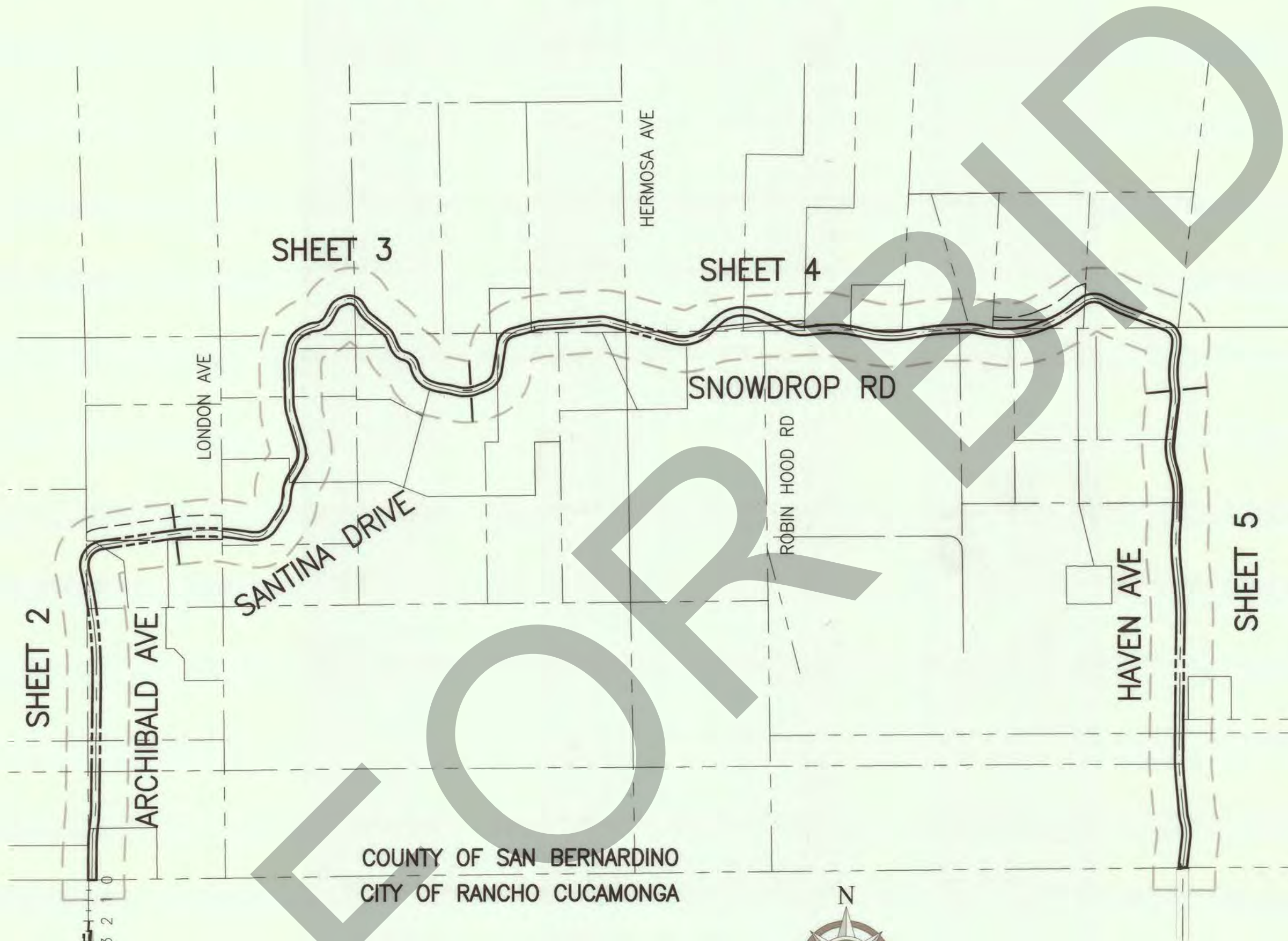
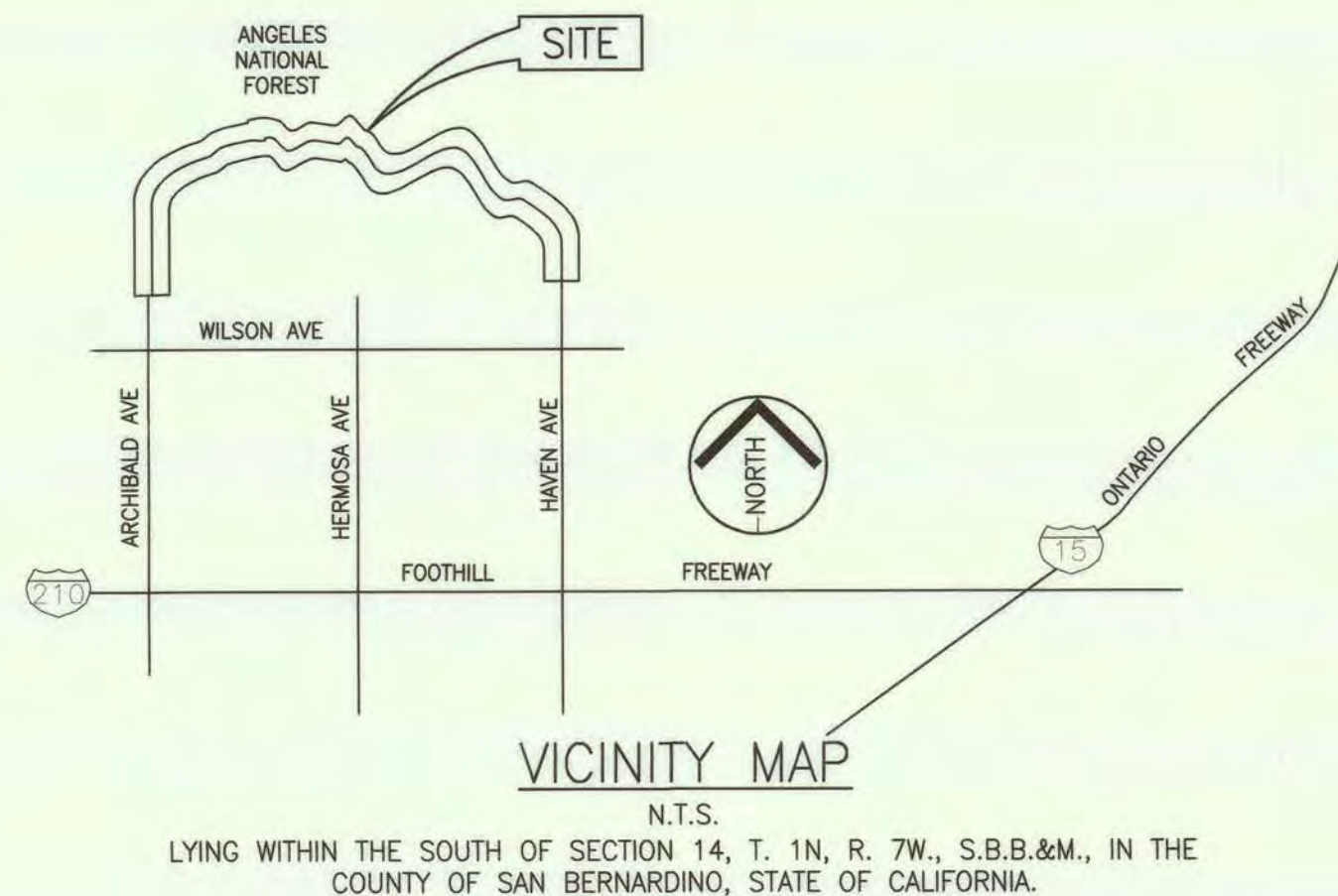

GENERAL SIGNING AND STRIPING NOTES:

1. ALL MATERIAL AND WORK SHALL CONFORM TO 2014 CALIFORNIA MANUAL ON UNIFORM TRAFFIC CONTROL DEVICES, 2015 CALTRANS STANDARD PLANS AND STANDARD SPECIFICATIONS, AND THE LATEST EDITION OF COUNTY OF SAN BERNARDINO STANDARDS.
2. ALL TRAFFIC STRIPES, PAVEMENT MARKINGS, AND SIGNS SHALL BE REFLECTORIZED. ALL STRIPING AND MARKIN SHALL MATCH CALTRANS STANDARD PLANS DETAILS INCLUDING THE STENCILS FOR MARKING.
3. ALL PAVEMENT MARKINGS INCLUDING CROSSWALKS, LIMIT LINES, AND STOP BARS SHALL BE APPLIED WITH THERMOPLASTIC MATERIAL. ALL OTHER TRAFFIC STRIPES SHALL BE PAINTED IN TWO COATS.
4. ALL CROSSWALKS SHALL HAVE 10 FEET IN BETWEEN THE 12-INCH WIDE WHITE OR YELLOW STRIPES.
5. ALL DOUBLE YELLOW STRIPES SHALL HAVE 3-INCH PAINTED BLACK STRIPE SEPARATING THE YELLOW STRIPES.
6. CONTRACTOR SHALL NOTIFY UNDERGROUND SERVICE ALERT (811) AND ALL CONCERNED UTILITY COMPANIES AT LEAST TWO WORKING DAYS PRIOR TO EXCAVATION. CONTRACTOR SHALL BE RESPONSIBLE FOR DAMAGING UTILITIES DURING CONSTRUCTION.
7. CONTRACTOR SHALL CONTROL DUST AND OTHER NUISANCES, AND KEEP COUNTY RIGHT-OF-WAY CLEAN OF DEBRIS AT ALL TIME.
8. CONTRACTOR SHALL REMOVE ALL CONFLICTING STRIPES, PAVEMENT MARKINGS, AND RAISED PAVEMENT MARKERS IN ACCORDANCE WITH THE PLANS AND AS DIRECTED BY THE ENGINEER. WORD OR SYMBOL PAVEMENT MARKINGS SHALL BE REMOVED BY SANDBLASTING OR GRINDING A RECTANGULAR AREA COVERING THE WHOLE MARKING.
9. THE CONTRACTOR SHALL LAYOUT (CAT-TRACK) THE PROPOSED SIGNING, STRIPING, AND PAVEMENT MARKINGS IN ACCORDANCE WITH THE PLANS AND OBTAIN THE ENGINEER'S APPROVAL PRIOR TO ACTUAL INSTALLATION.
10. CONTRACTOR SHALL APPLY ASPHALT EMULSION TO ALL SURFACE THAT WERE SANDBLASTED OR GRINDED PRIOR TO RESTRIPIING AND REAPPLYING THERMOPLASTIC MATERIAL.
11. CONTRACTOR SHALL FURNISH AND INSTALL ALL TRAFFIC STRIPES, RAISED PAVEMENT MARKERS (RPMs), PAVEMENT MARKINGS AND SIGNS IN ACCORDANCE WITH THE PLANS AND AS DIRECTED BY THE ENGINEER.
12. CONTRACTOR SHALL INSTALL ALL RPMs WITHIN SEVEN WORKING DAYS OF ROADWAY STRIPING. ALL EXISTING RPMs WITHIN THE PROJECT AREA SHALL BE REPLACED IN KIND OR REMOVED IN ACCORDANCE WITH THE PLANS OR AS DIRECTED BY THE ENGINEER.
13. CONTRACTOR SHALL REPLACE ALL SIGNING AND STRIPING DAMAGED DURING CONSTRUCTION.
14. CONTRACTOR SHALL REMOVE SIGNS IN ACCORDANCE WITH THE PLANS AND AS DIRECTED BY THE ENGINEER. THE CONTRACTOR SHALL DELIVER REMOVED SIGNS TO THE COUNTY YARD OR AS DIRECTED BY THE ENGINEER.

NOTICE TO CONTRACTORS

CONTRACTOR AGREES THAT HE SHALL ASSUME COMPLETE AND SOLE RESPONSIBILITY FOR JOB SITE CONDITIONS DURING THE COURSE OF CONSTRUCTION, INCLUDING SAFETY OF ALL PERSONS AND PROPERTY; THAT THIS REQUIREMENT SHALL CONTINUOUSLY AND NOT BE LIMITED TO NORMAL WORKING HOURS; AND THAT THE CONTRACTOR SHALL DEFEND, INDEMNIFY AND HOLD THE OWNER AND ENGINEER HARMLESS FROM ANY AND ALL LIABILITY, REAL OR ALLEGED, IN CONNECTION WITH THE PERFORMANCE OF WORK ON THIS PROJECT, EXCEPTING FROM LIABILITY ARISING FROM THE SOLE NEGLIGENCE OF THE OWNER OR ENGINEER.

THE EXISTENCE AND LOCATION OF ANY UNDERGROUND UTILITY PIPES OR STRUCTURES SHOWN ON THESE PLANS WERE OBTAINED BY A SEARCH OF AVAILABLE RECORDS. THESE LOCATIONS ARE APPROXIMATE AND SHALL BE CONFIRMED IN FIELD BY THE CONTRACTOR, SO THAT ANY NECESSARY ADJUSTMENT CAN BE MADE IN ALIGNMENT AND/OR GRADE OF THE PROPOSED IMPROVEMENT. THE CONTRACTOR IS REQUIRED TO TAKE DUE PRECAUTIONARY MEASURES TO PROTECT ANY UTILITY LINES SHOWN AND ANY OTHER LINES NOT SHOWN ON THESE PLANS.

MAJOR ITEMS TO BE REMOVED HAVE BEEN NOTED ON THESE PLANS, HOWEVER THE CONTRACTOR IS TO WALK THE SITE FOR VERIFICATION OF ADDITIONAL SURFACE FEATURES REQUIRING REMOVAL. THE CONTRACTOR IS RESPONSIBLE TO REMOVE ALL OBJECTS AND MATERIALS (AC, CONCRETE, TREES, BUSHES, FENCING, ETC.) THAT ARE IN CONFLICT WITH THE NEW PROPOSED IMPROVEMENTS WHETHER CALLE-OUT OR NOT ON THE PLANS AND DISPOSE OF LEGALLY. CONTRACTOR IS TO BACKFILL ACCORDINGLY AND LEAVE SITE IN A RELATIVELY LEVEL CONDITION.

SIGN LEGEND

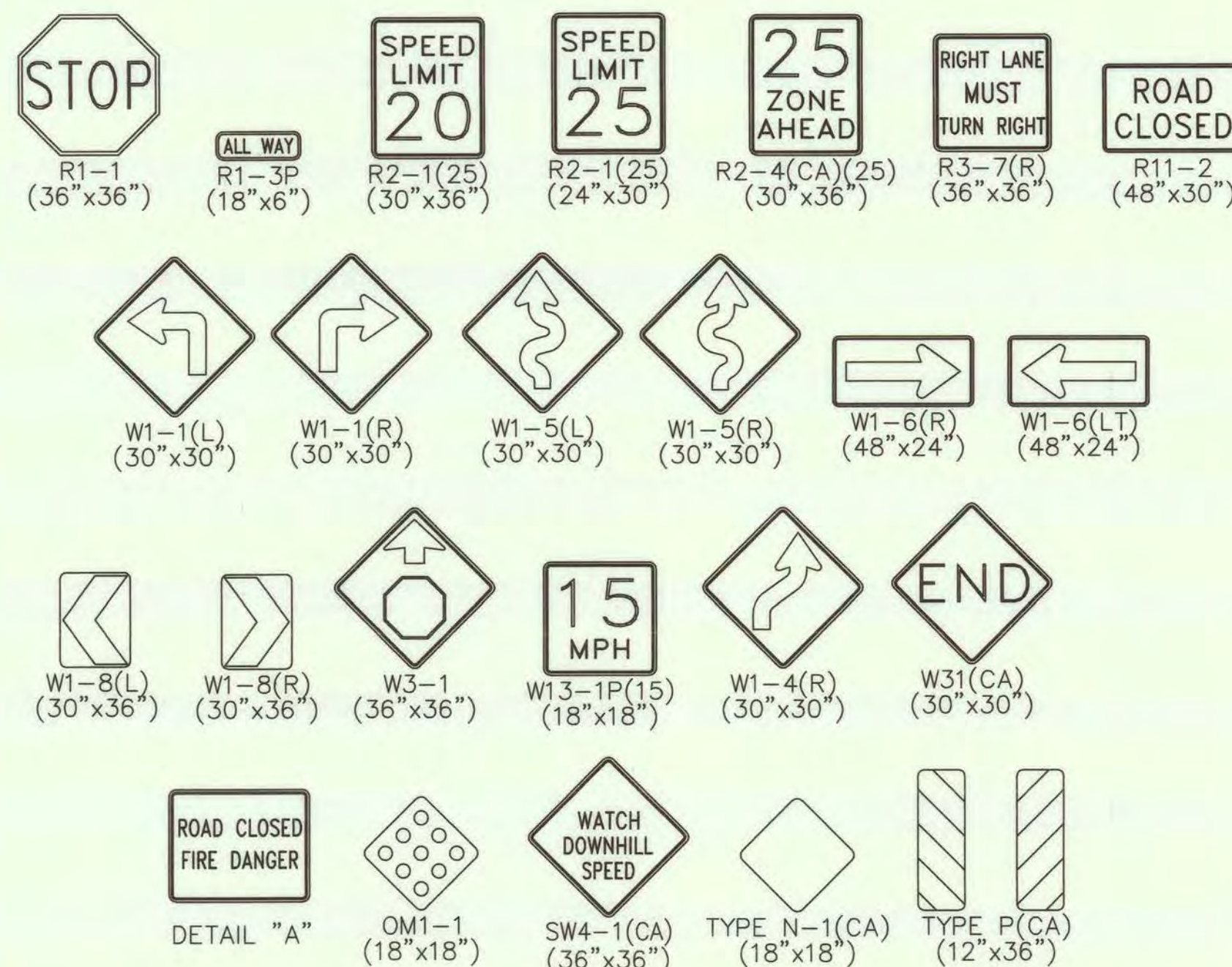

SIGNING & STRIPING CONSTRUCTION NOTES:

1. PROTECT EXISTING STRIPING, MARKING, OR SIGN IN PLACE.
2. INSTALL SIGN (STANDARD SIZE OR AS INDICATED) PER CA-MUTCD.
3. PAINT 4"/4" DOUBLE SOLID YELLOW STRIPE PER CALTRANS STANDARD PLANS, PLAN NO. A20A, DETAIL 22.
4. PAINT 4" WHITE RIGHT EDGE LINE PER CALTRANS STANDARD PLANS, PLAN NO. A20B, DETAIL 27B.
5. REMOVE AND SALVAGE EXISTING SIGN TO CITY YARD.
6. INSTALL FLEXIBLE MGS DELINEATORS @ 25' SPACING PER CALTRANS STANDARD PLANS, PLAN A77N4.
7. INSTALL SOLAR-POWERED FLASHING BEACON AND STANDARD SIZE SIGN ON NEW POST PER CA-MUTCD. BEACON SHALL BE YELLOW FOR W3-1 INSTALLATION. BEACON SHALL BE RED FOR R1-1 INSTALLATION.
8. RELOCATE SIGN AS INDICATED.
9. WET-SANDBLAST EXISTING STRIPING AS SHOWN ON PLAN.
10. INSTALL THERMOPLASTIC WHITE PAVEMENT MARKING PER CALTRANS STANDARD PLANS, PLAN NO. A24E.
11. PAINT 12" WHITE LIMIT LINE PER CALTRANS STANDARD PLAN NO. A24G.
12. INSTALL THERMOPLASTIC WHITE TYPE IV ARROW PAVEMENT MARKING PER CALTRANS STANDARD PLAN NO. A24A.
13. APPLY THERMOPLASTIC 4"/4" MEDIAN ISLAND PER CALTRANS STANDARD PLANS NO. A20B, DETAIL 29.
14. APPLY THERMOPLASTIC 8" WHITE CHANNELIZING LINE PER CALTRANS STANDARD PLANS, PLAN NO. A20D, DETAIL 38.
15. PAINT 6" YELLOW CENTER LINE EXTENSION PER CALTRANS STANDARD PLANS, PLAN NO. A20D, DETAIL 41.

SHEET INDEX

SHEET 1 TITLE SHEET
SHEET 2-5 SIGNING AND STRIPING PLANS

Underground Service Alert



Call: TOLL FREE

811

WWW.call811.com

TWO WORKING DAYS BEFORE YOU DIG

BENCHMARK

No. 10105 (RANCHO CUCAMONGA)

CITY OF RANCHO CUCAMONGA BENCH MARK F.D. 2" BRASS DISK
"CITY OF RC BENCH MARK 10105 (1894.77)"

ELEVATION:1894.77

SEAL - ENGINEER



ALBERT A.

WEBB
ASSOCIATES

PROJECT ENGINEER

ENGINEERING CONSULTANTS

3788 MCCRAY STREET
RIVERSIDE CA. 92506
PH. (951) 686-1070
FAX (951) 788-1256

C65078

R.C.E. NO.

FIELD BOOK REF.

MARK	REVISIONS	APPR	DATE

COUNTY OF SAN BERNARDINO - SPECIAL DISTRICTS DEPARTMENT

ASSESSMENT DISTRICT 2018-1

APPROVED BY:

SPECIAL DISTRICT DEPARTMENT

DATE

ASSESSMENT DISTRICT 2018-1

RANCHO CUCAMONGA, CALIFORNIA

SNOWDROP STREET
SIGNING AND STRIPING PLAN
TITLE SHEET

SCALE:

HORIZ: AS SHOWN

VERT: N/A

W.O. NO.:

16-3008

ROAD NO.:

FILE NO.

SHEET 1 OF 5

NOVEMBER 6, 2019

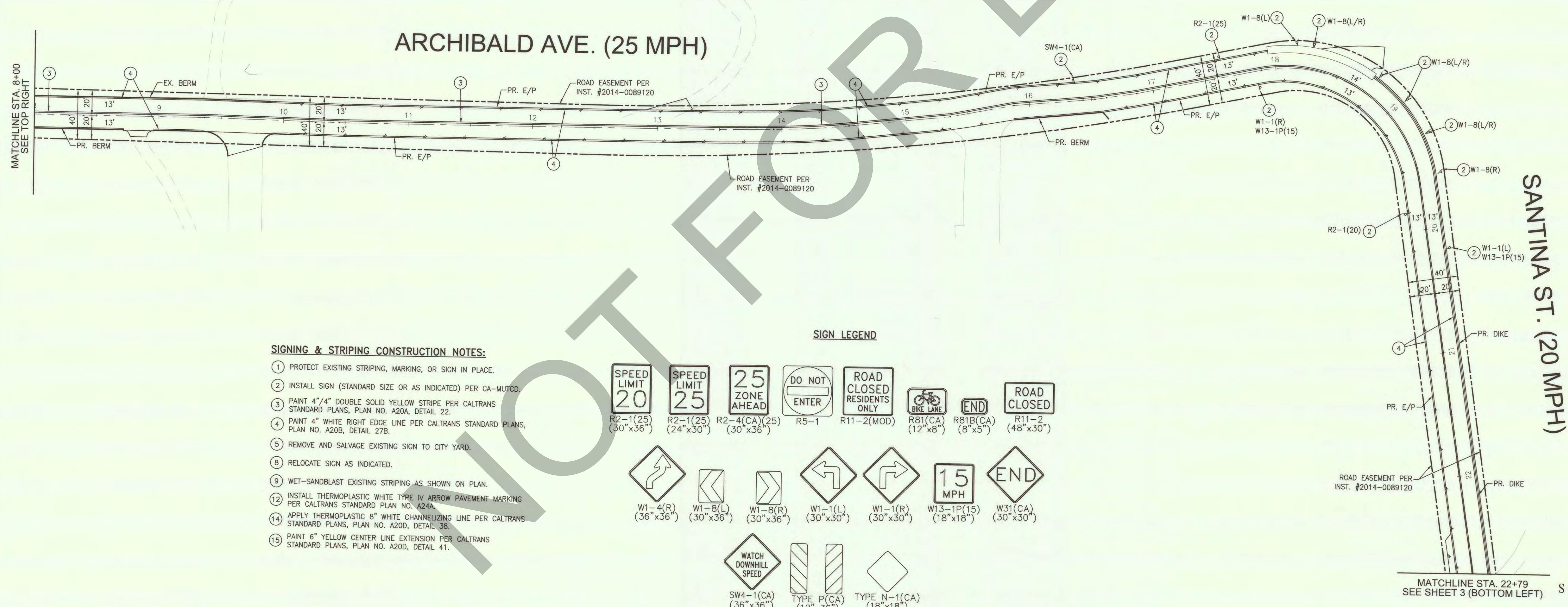
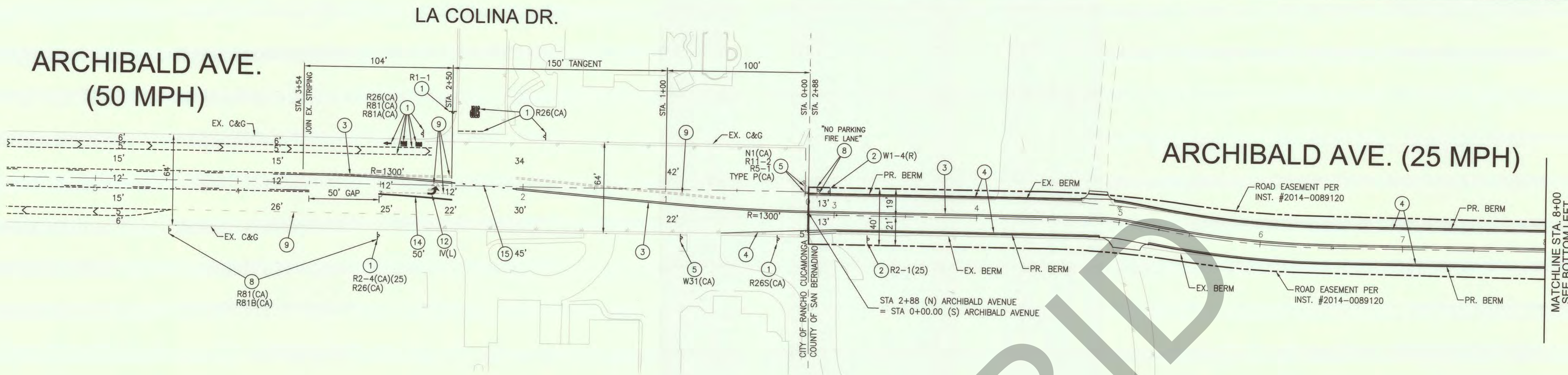

SIGNING & STRIPING CONSTRUCTION NOTES:

- PROTECT EXISTING STRIPING, MARKING, OR SIGN IN PLACE.
- INSTALL SIGN (STANDARD SIZE OR AS INDICATED) PER CA-MUTCD.
- PAINT 4" / 4" DOUBLE SOLID YELLOW STRIPE PER CALTRANS STANDARD PLANS, PLAN NO. A20A, DETAIL 22.
- PAINT 4" WHITE RIGHT EDGE LINE PER CALTRANS STANDARD PLANS, PLAN NO. A20B, DETAIL 27B.
- REMOVE AND SALVAGE EXISTING SIGN TO CITY YARD.
- RELOCATE SIGN AS INDICATED.
- WET-SANDBLAST EXISTING STRIPING AS SHOWN ON PLAN.
- INSTALL THERMOPLASTIC WHITE TYPE IV ARROW PAVEMENT MARKING PER CALTRANS STANDARD PLAN NO. A24A.
- APPLY THERMOPLASTIC 8" WHITE CHANNELIZING LINE PER CALTRANS STANDARD PLANS, PLAN NO. A20D, DETAIL 38.
- PAINT 6" YELLOW CENTER LINE EXTENSION PER CALTRANS STANDARD PLANS, PLAN NO. A20D, DETAIL 41.

SIGN LEGEND

Legend for signs and markings:

- SPEED LIMIT 20** (R2-1(25) (30"x36"))
- SPEED LIMIT 25** (R2-1(25) (24"x30"))
- 25 ZONE AHEAD** (R2-4(CA)(25) (30"x36"))
- DO NOT ENTER** (R5-1)
- ROAD CLOSED RESIDENTS ONLY** (R11-2(MOD))
- BIKE LANE** (R81(CA) (12"x8"))
- END** (R81B(CA) (8"x5"))
- ROAD CLOSED** (R11-2 (48"x30"))
- W1-4(R)** (36"x36")
- W1-8(L)** (30"x36")
- W1-8(R)** (30"x36")
- W1-1(L)** (30"x30")
- W1-1(R)** (30"x30")
- W13-1P(15)** (18"x18")
- W31(CA)** (30"x30")
- WATCH DOWNHILL SPEED** (SW4-1(CA) (36"x36"))
- TYPE P(CA)** (12"x36")
- TYPE N-1(CA)** (18"x18")

Underground Service Alert Call: TOLL FREE 811 WWW.call811.com TWO WORKING DAYS BEFORE YOU DIG	BENCHMARK No. 10105 (RANCHO CUCAMONGA) CITY OF RANCHO CUCAMONGA BENCH MARK F.D. 2" BRASS DISK "CITY OF RC BENCH MARK 10105 (1894.77)" ELEVATION: 1894.77	SEAL - ENGINEER ALBERT A. WEBB ASSOCIATES PROJECT ENGINEER C65078 R.C.E. NO.	ENGINEERING CONSULTANTS 3788 McCRAV STREET RIVERSIDE CA. 92506 PH. (951) 686-1070 FAX (951) 788-1256 C65078 R.C.E. NO.	FIELD BOOK REF.	COUNTY OF SAN BERNARDINO - SPECIAL DISTRICTS DEPARTMENT ASSESSMENT DISTRICT 2018-1 APPROVED BY: _____ SPECIAL DISTRICT DEPARTMENT _____ DATE _____	ASSESSMENT DISTRICT 2018-1 RANCHO CUCAMONGA, CALIFORNIA SNOWDROP STREET SIGNING AND STRIPING PLAN SCALE: HORIZ: AS SHOWN VERT: N/A	W.O. NO.: 16-3008 ROAD NO.: _____ FILE NO.: _____ SHEET 2 OF 5	

NOVEMBER 6, 2019
G:\2016\16-3008\DRAWINGS\PLAN SHEETS\16-3008 SSD.DWG 11/5/2019 11:16:09 AM

SIGNING & STRIPING CONSTRUCTION NOTES:

- 2 INSTALL SIGN (STANDARD SIZE OR AS INDICATED) PER CA-MUTCD.
- 3 PAINT 4" / 4" DOUBLE SOLID YELLOW STRIPE PER CALTRANS STANDARD PLANS, PLAN NO. A20A, DETAIL 22.
- 4 PAINT 4" WHITE RIGHT EDGE LINE PER CALTRANS STANDARD PLANS, PLAN NO. A20B, DETAIL 27B.
- 6 INSTALL FLEXIBLE MGS DELINEATORS @ 25' SPACING PER CALTRANS STANDARD PLANS, PLAN A77N4.

SIGN LEGEND

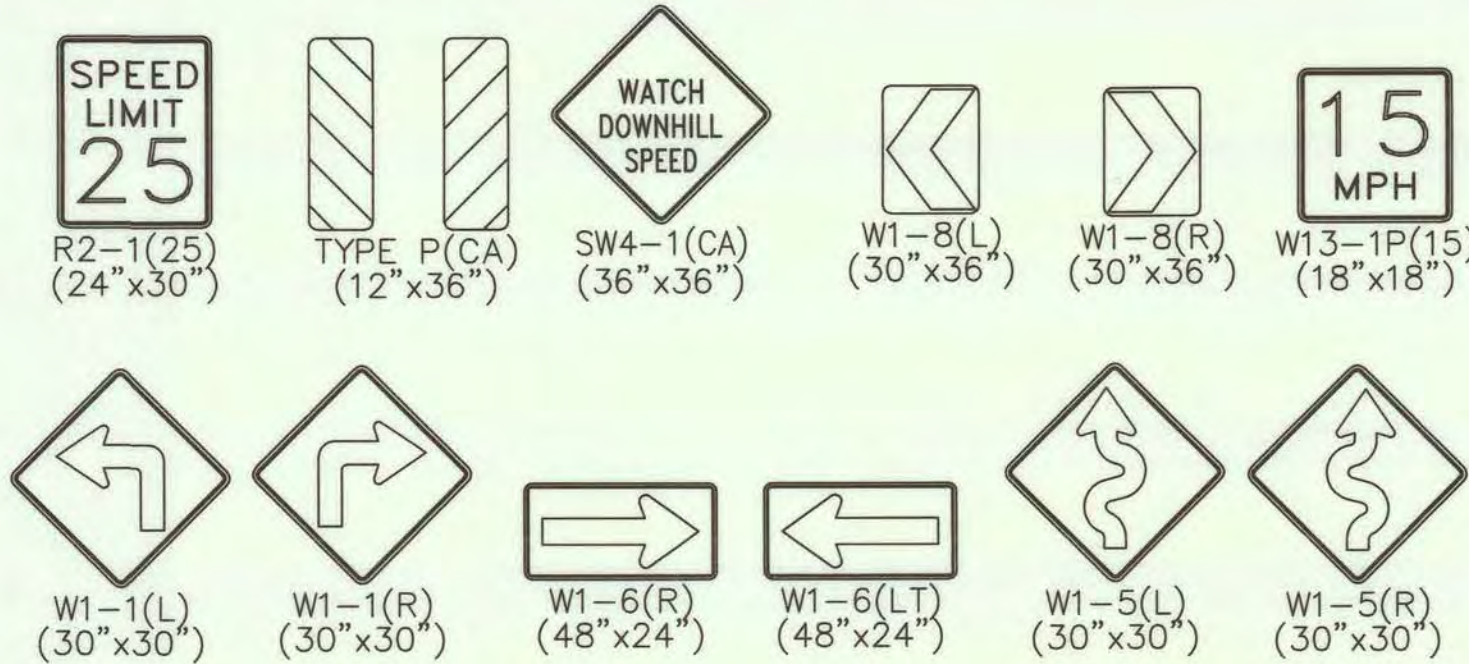

Underground Service Alert
Call: TOLL FREE
811
WWW.call811.com
TWO WORKING DAYS BEFORE YOU DIG

BENCHMARK
No. 10105 (RANCHO CUCAMONGA)
CITY OF RANCHO CUCAMONGA BENCH MARK F.D. 2" BRASS DISK
"CITY OF RC BENCH MARK 10105 (1894.77)"
ELEVATION: 1894.77

SEAL - ENGINEER
REGISTERED PROFESSIONAL ENGINEER
DILESA R. SHEPHERD
No. C65078
CIVIL
STATE OF CALIFORNIA

ALBERT A. WEBB ASSOCIATES
ENGINEERING CONSULTANTS
3788 MCCRAY STREET
RIVERSIDE, CA. 92506
PH. (951) 686-1070
FAX (951) 788-1256
C65078
R.C.E. NO.

MARK	REVISIONS	APPR	DATE

COUNTY OF SAN BERNARDINO - SPECIAL DISTRICTS DEPARTMENT
ASSESSMENT DISTRICT 2018-1
APPROVED BY: _____
SPECIAL DISTRICT DEPARTMENT _____ DATE _____

ASSESSMENT DISTRICT 2018-1
RANCHO CUCAMONGA, CALIFORNIA
SNOWDROP STREET
SIGNING AND STRIPING PLAN
SCALE: HORIZ: AS SHOWN VERT: N/A

W.O. NO.: 16-3008
ROAD NO.:
FILE NO.:
SHEET 3 OF 5

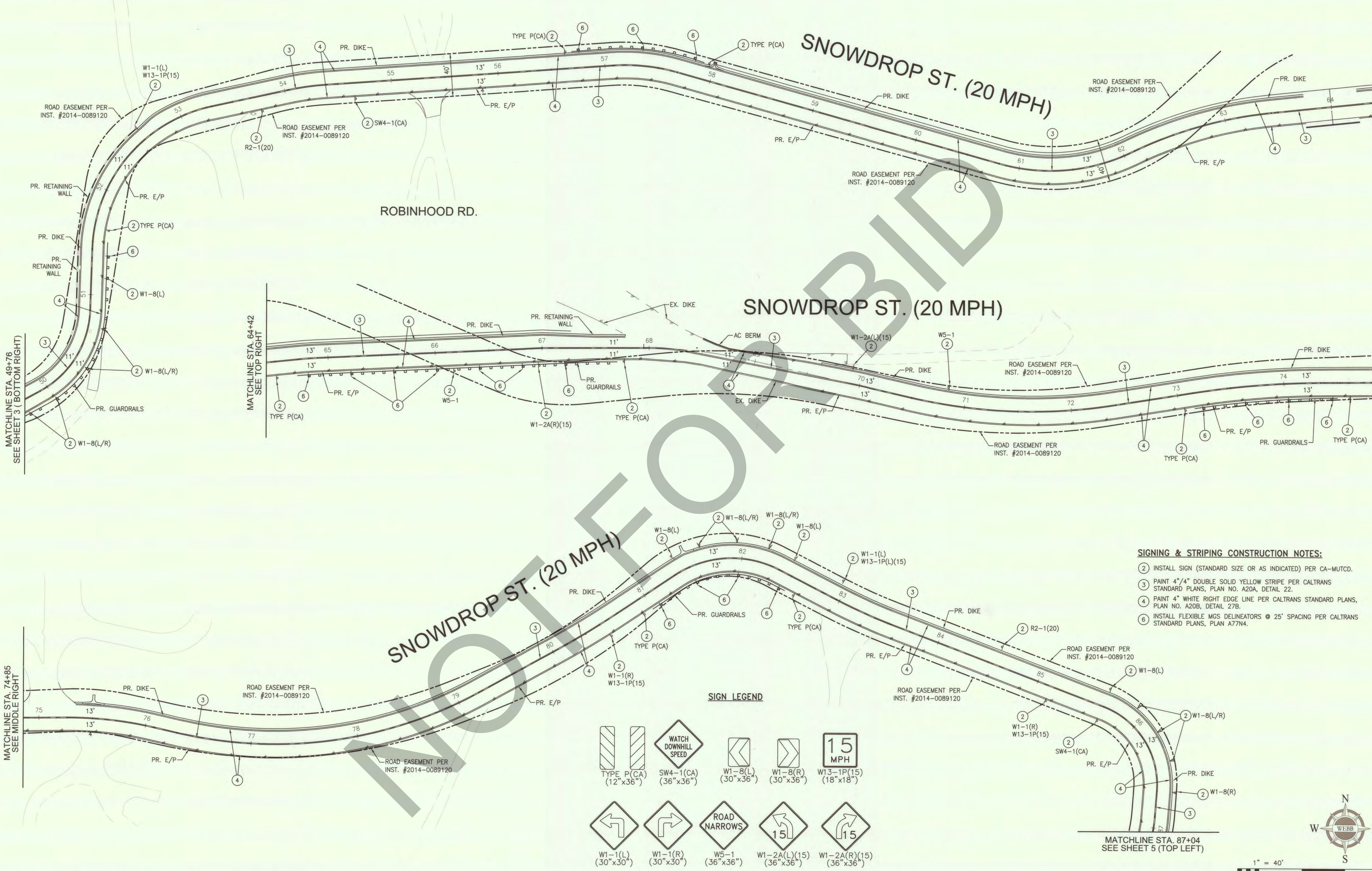

- SIGNING & STRIPING CONSTRUCTION NOTES:**
- ② INSTALL SIGN (STANDARD SIZE OR AS INDICATED) PER CA-MUTCD.
 - ③ PAINT 4"/4" DOUBLE SOLID YELLOW STRIPE PER CALTRANS STANDARD PLANS, PLAN NO. A20A, DETAIL 22.
 - ④ PAINT 4" WHITE RIGHT EDGE LINE PER CALTRANS STANDARD PLANS, PLAN NO. A20B, DETAIL 27B.
 - ⑥ INSTALL FLEXIBLE MGS DELINEATORS @ 25' SPACING PER CALTRANS STANDARD PLANS, PLAN A77N4.

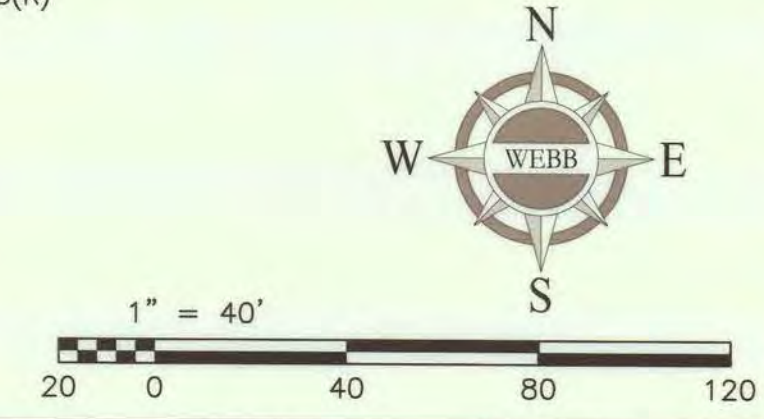
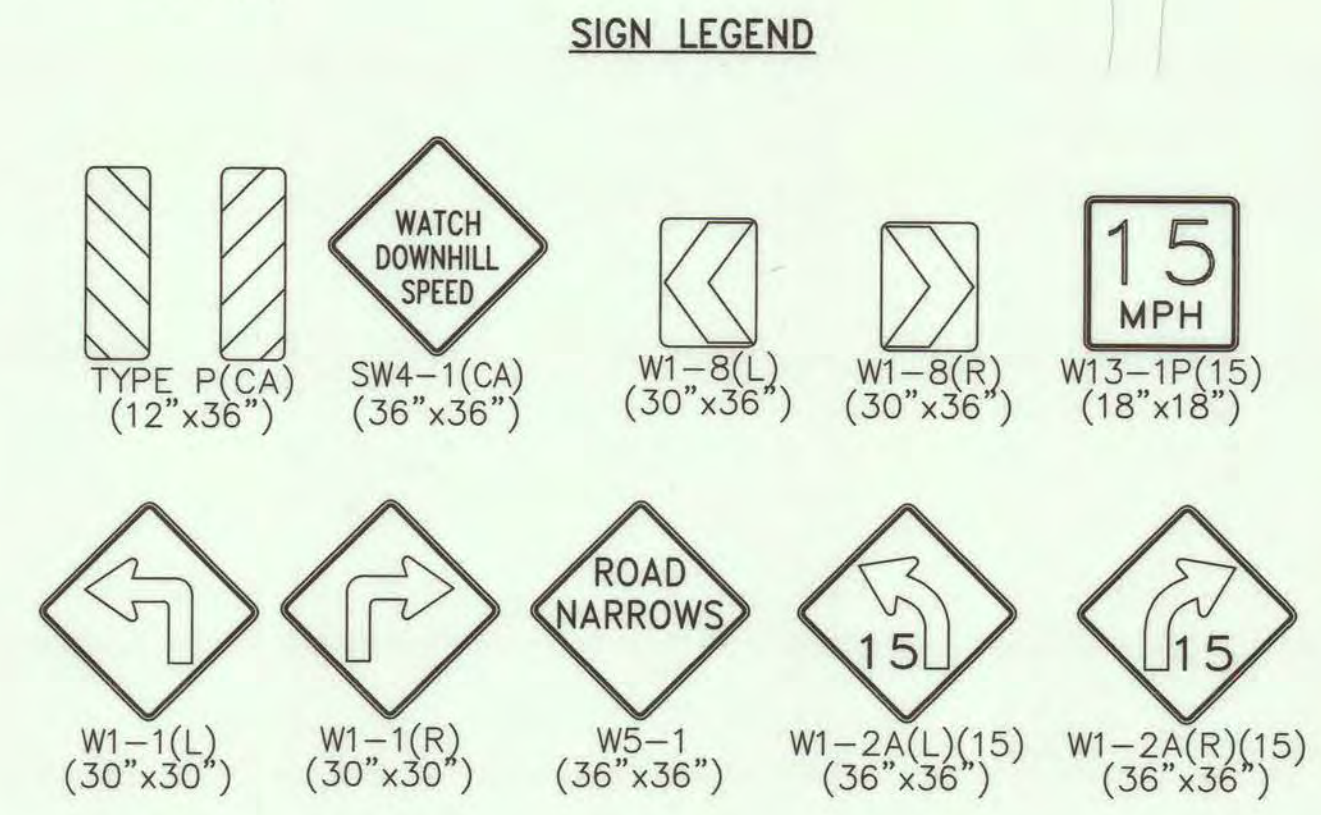

Underground Service Alert Call: TOLL FREE 811 WWW.call811.com TWO WORKING DAYS BEFORE YOU DIG	BENCHMARK No. 10105 (RANCHO CUCAMONGA) CITY OF RANCHO CUCAMONGA BENCH MARK F.D. 2" BRASS DISK "CITY OF RC BENCH MARK 10105 (1894.77)" ELEVATION: 1894.77	SEAL - ENGINEER DILISH R. SHEA No. C65078 CIVIL STATE OF CALIFORNIA	ALBERT A. WEBB ASSOCIATES ENGINEERING CONSULTANTS 3788 McCRAV STREET RIVERSIDE CA. 92506 PH. (951) 686-1070 FAX (951) 788-1256 PROJECT ENGINEER: <i>Albert Webb</i> C65078 R.C.E. NO.	FIELD BOOK REF.	MARK	REVISIONS	APPR	DATE	COUNTY OF SAN BERNARDINO - SPECIAL DISTRICTS DEPARTMENT ASSESSMENT DISTRICT 2018-1 APPROVED BY: _____ SPECIAL DISTRICT DEPARTMENT _____ DATE _____	ASSESSMENT DISTRICT 2018-1 RANCHO CUCAMONGA, CALIFORNIA SNOWDROP STREET SIGNING AND STRIPING PLAN SCALE: HORIZ: AS SHOWN VERT: N/A	W.O. NO.: 16-3008
											ROAD NO.: SNOWDROP STREET
										FILE NO.	SHEET 4 OF 5

NOVEMBER 6, 2019
CA\2018\16-3008\DRAWINGS\PLAN SHEETS\16-3008 SS.DWG 11/5/2019 11:16:09 AM

